

Copyright: All rights reserved. This drawing must not be reproduced without permission.

Only the original drawing should be relied upon. Contractors, subcontractors and suppliers must verify all dimensions on site before commencing any work or making any shop drawings.

All shop drawings to be submitted to the architect for comment prior to fabrication.

This drawing is to be read in conjunction with the Architect's specification, bills of quantities / schedules, structural, mechanical & electrical drawings and all discrepancies are to be reported to the architect.

Do not scale from this drawing. Dimensions are in millimetres unless otherwise stated.

revision / date / amendments	
- / 26/01/18 /	- First Issue
A / 02/02/18 /	- WC indicated under Dome.
B / 01/03/18 /	- Windows numbers updated in line with window schedule.
C / 23/03/18 /	1. Tender Addendum (1), Indication of 4 post truss fixed at stage level for integrated automatic retractable acoustic baffles and integrated lighting rig. 2. Tender Addendum (2), New AHU + Attenuator over stage to be hung to existing relocated secondary beams in Flytower.
D / 09/04/18 /	- Alterations to 3rd floor ID layout
E / 12/04/18 /	- Window and door numbers updated
F / 01/06/18 /	Listed Building Application 1. Indication of 4 post truss fixed at stage level for integrated automatic retractable acoustic baffles and integrated lighting rig. 2. New AHU + Attenuator over stage to be hung to existing relocated secondary beams in Flytower.

LEGEND

- Proposed Works
- Existing Building Fabric KOKO née Camden Palace Theatre (1900)
- Existing Building Fabric Hope & Anchor (approx. 1850)
- Existing Building Fabric Bayham Place (from 1875)
- Existing Modern Building Fabric Bayham Place (from 2006)
- Building Fabric to be demolished
- Demolition of Flooring / Elevation / Wall
- Proposed Excavation
- Remove and retain in alternate location
- Retain and protect existing
- Retain, make good, ease and adjusted
- Means of escape Route
- Private Members Route
- Koko Customer Route
- Public Route
- Artist Route
- Proposed Riser
- Proposed Risers Above
- RM.4-06 Room Number
- D4-02 Door Number
- W4-05 Window Number
- Hope & Anchor Demise
- Koko Demise
- 1 Bayham Street & 65 Bayham Place Demise
- Blue Roof

01.06.18

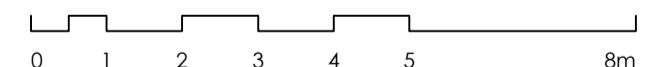
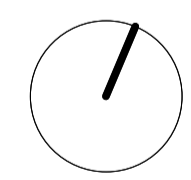

STAGE 4

Archer Humphries Architects

Basement
Central House
142 Central Street
London, United Kingdom
EC1V 8AR
T: +44 (0) 20 7251 8555

project title		KOKO + Hope & Anchor + Bayham Place Camden, London	
drawing title	scale	date	
Proposed Third Floor Plan	1:100 @ A1	13.04.17	
drawing number	drawn / checked	revision	
AHA/KCC/GA/103	FR/PC/DA	F	

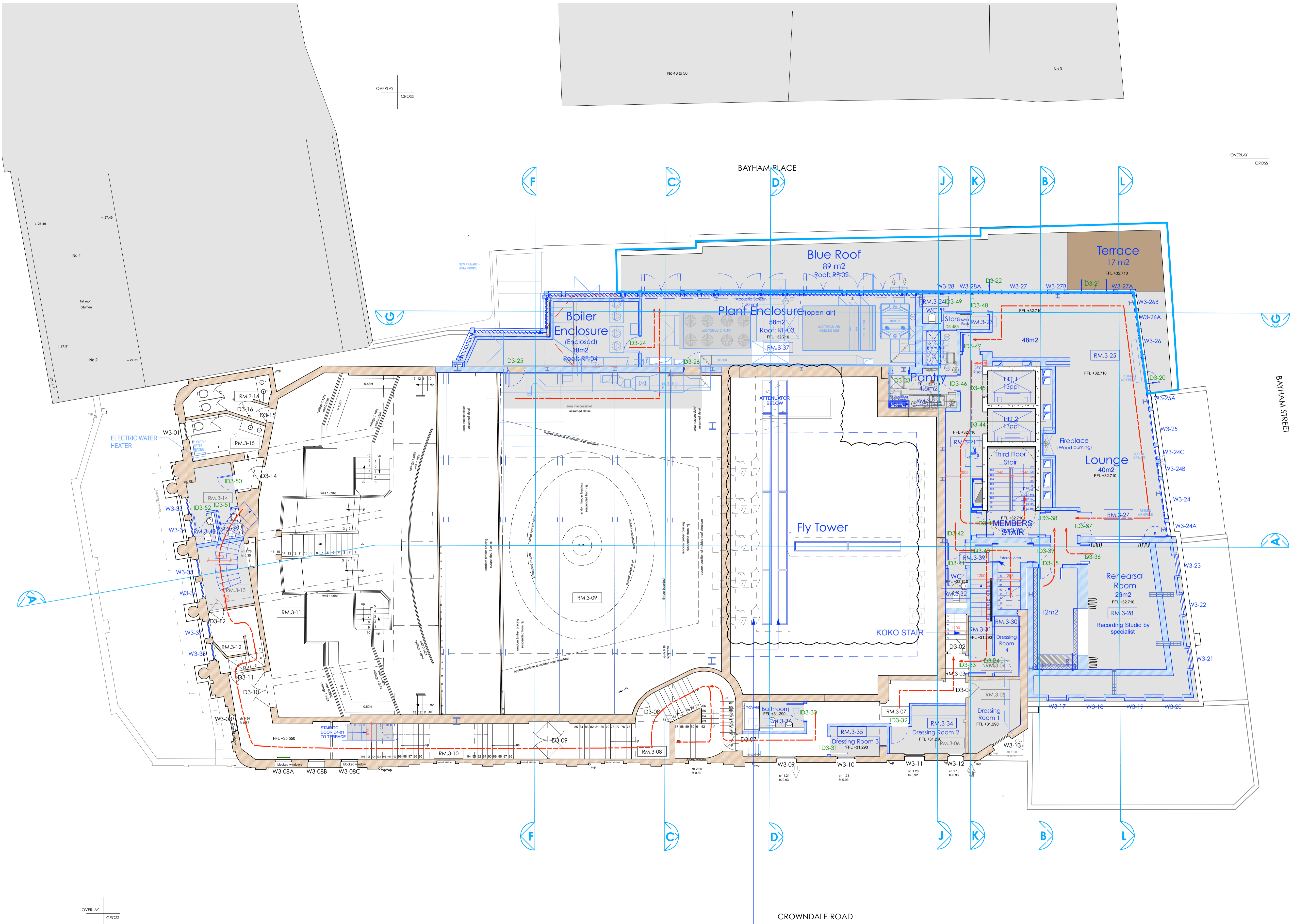

BELOW - NEW AHU + ATTENUATOR OVER STAGE SUPPLYING VENTILATION TO STAGE AND TO AUDITORIUM. MEP UNITS TO BE FIXED TO SPACE FRAME AND HUNG TO FLYTOWER USING EXISTING RELOCATED SECONDARY STEEL BEAMS. REFER TO STRUCTURAL ENGINEER'S DETAILS. FLYTOWER TIMBER REPORT BY SPECIALIST AND DETAILS FROM EXTREME RIGGING.

NB: ATTENUATOR AND MEP EQUIPMENT WILL HANG ABOVE NEW 4-POST TRUSS. REFER TO AHA DRAWING AHA/KCC/DET/615 AND AHA/KCC/PR/303

OVERLAY
CROSS

OVERLAY
CROSS

OVERLAY
CROSS