

NOTES:

This drawing is issued for information only.

All dimensions to be checked on site and any discrepancies are to be raised with the drawing issuer for clarification. Dimensions are not to be scaled from this drawing. The information shown on this drawing is subject to measured surveys and structural engineer's designs. No building work is to be carried out on the basis of this drawing, without the written consent of Amos Goldreich Architecture.

Print with page scaling set to none.

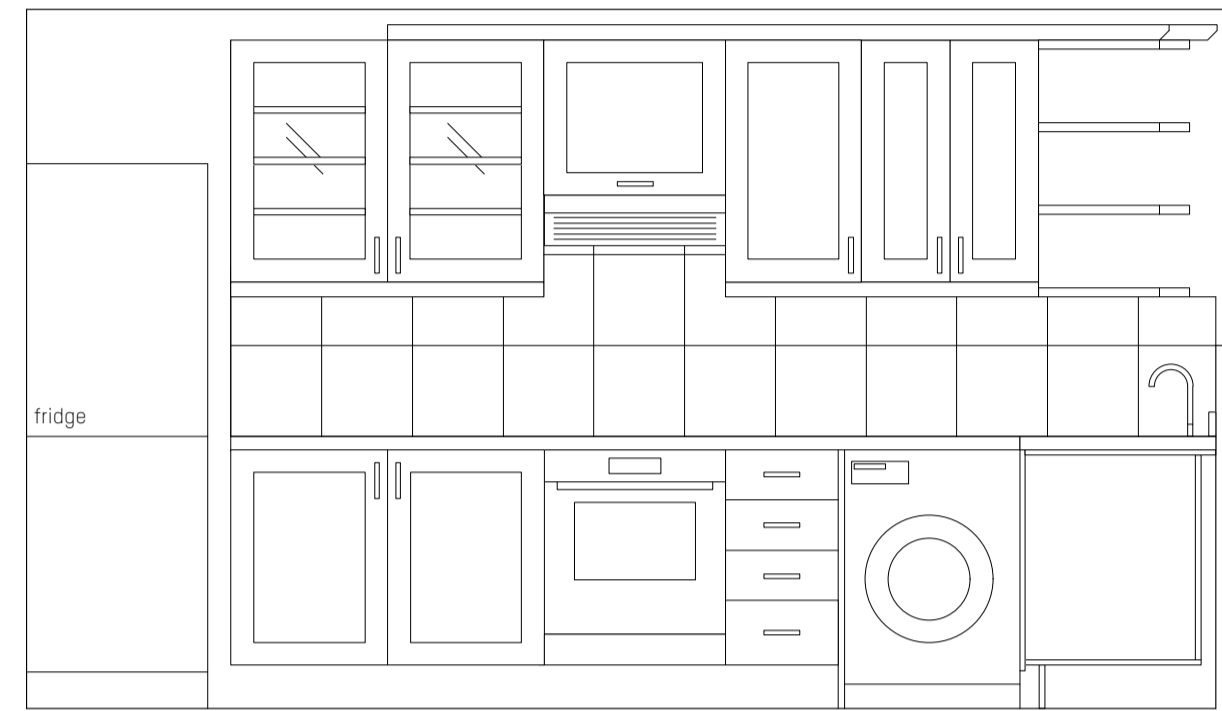

1 Section 1/201 - existing
201 Scale: 1:25

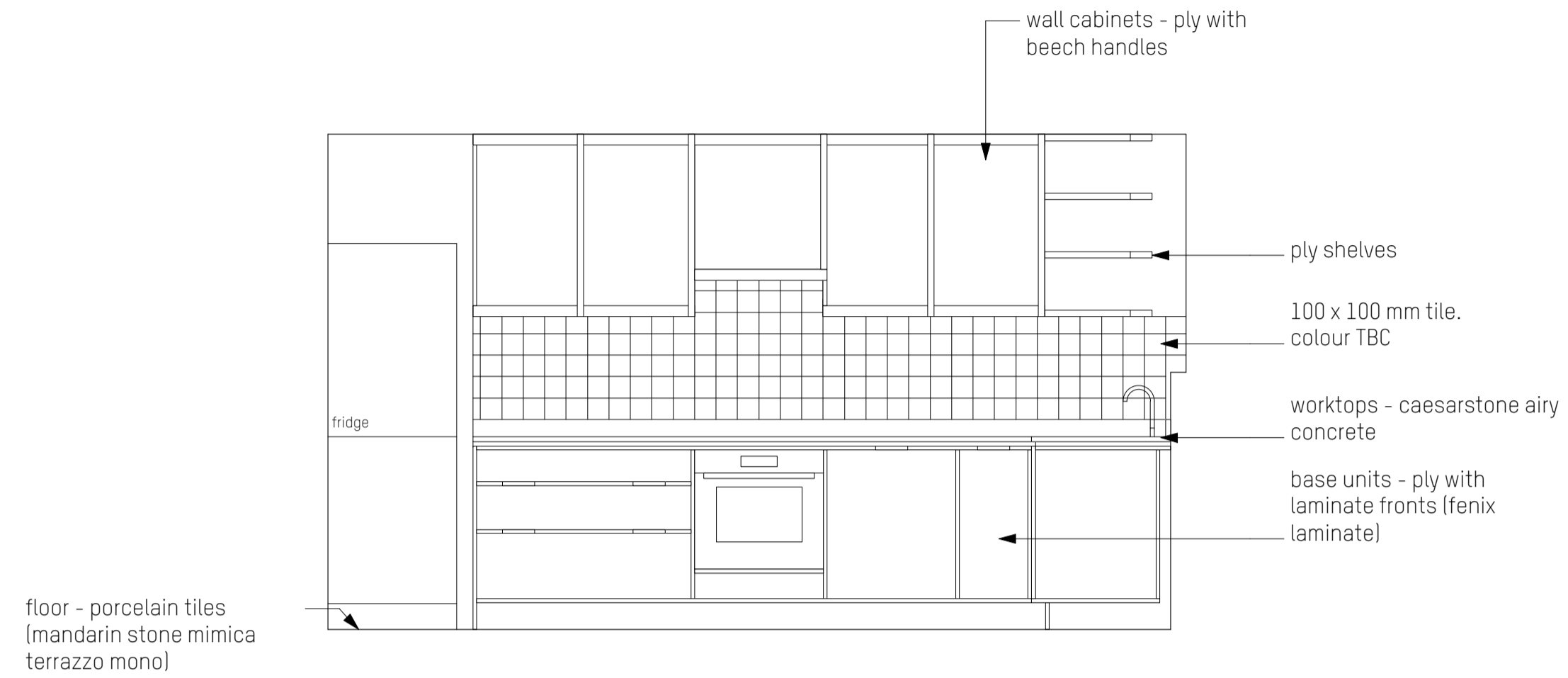

3 Section 3/201 - proposed
201 Scale: 1:25

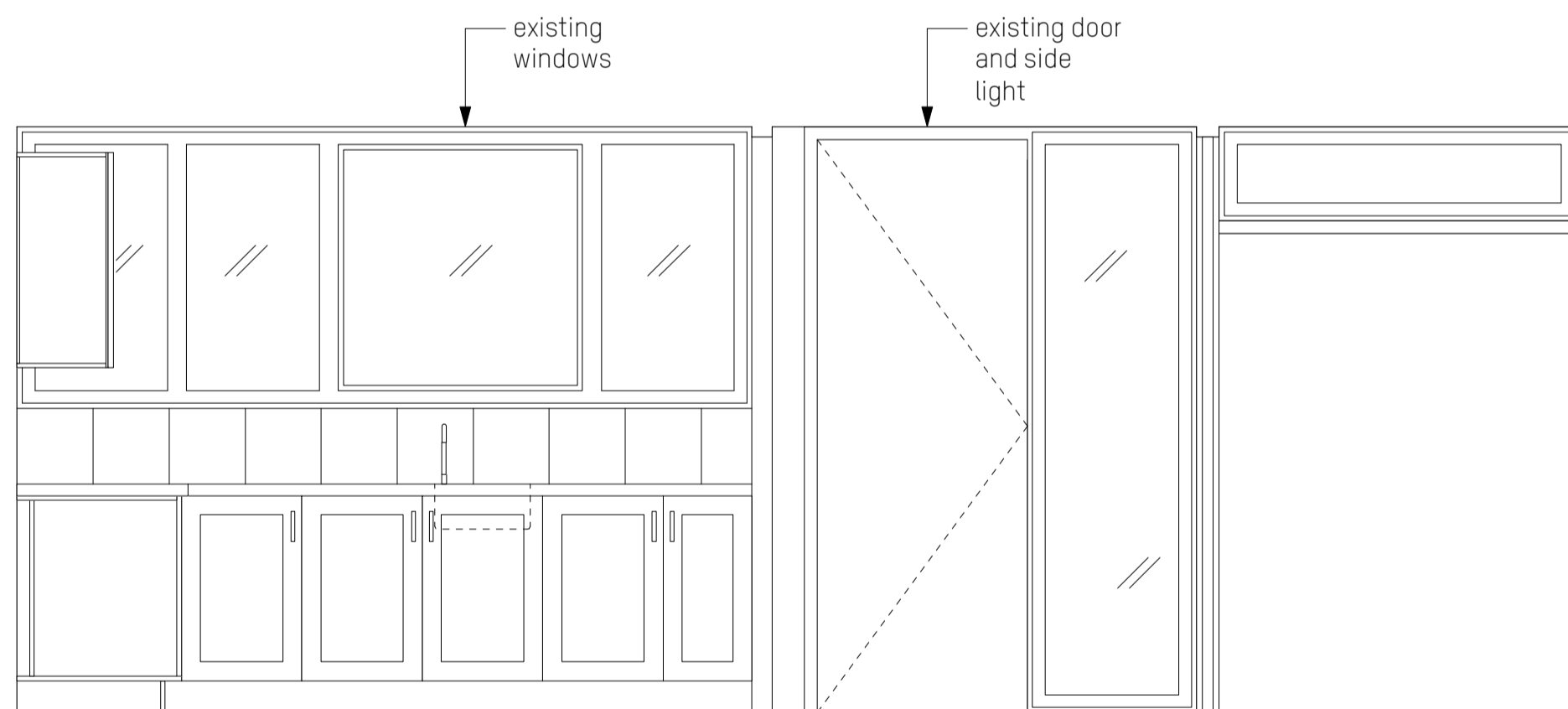

2 Section 2/201 - existing
201 Scale: 1:25

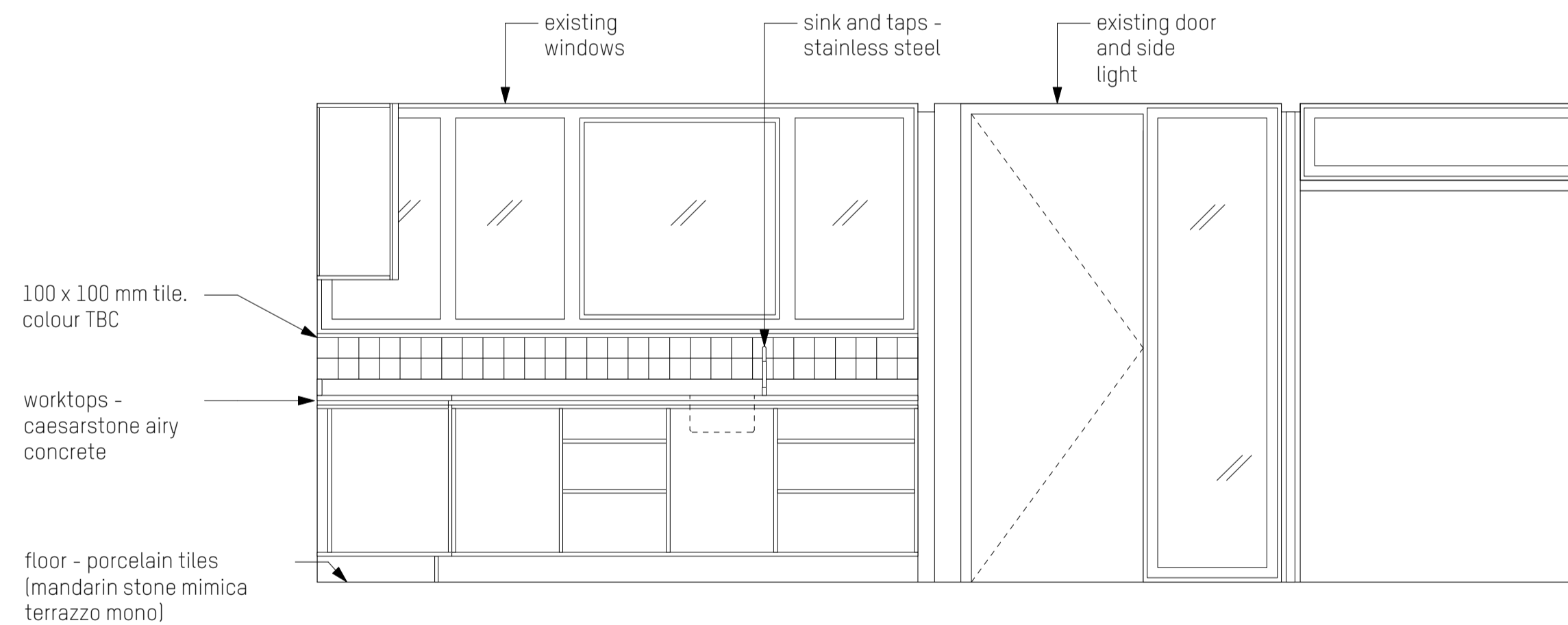

4 Section 4/201 - proposed
201 Scale: 1:25

rev	date	initials	description

location

Amos Goldreich Studio 32 T +44(0)207272 6592
Architecture Bickerton House E info@agarchitecture.net
25 Bickerton Road www.agarchitecture.net
London N19 5JT

project
45 Dunboyne Road

drawing title
Existing and Proposed Sections

drawn JB	scale @ A1 1:25	status LB Consent
date March 2019	project number 205	rev. -