

- PROPOSED GARAGE AT 20 REDINGTON ROAD - NW3 -

LONDON BOROUGH OF CAMDEN
 PLANNING AND TRANSPORT
 DEPARTMENT
 30 SEP 1988
 RECEIVED

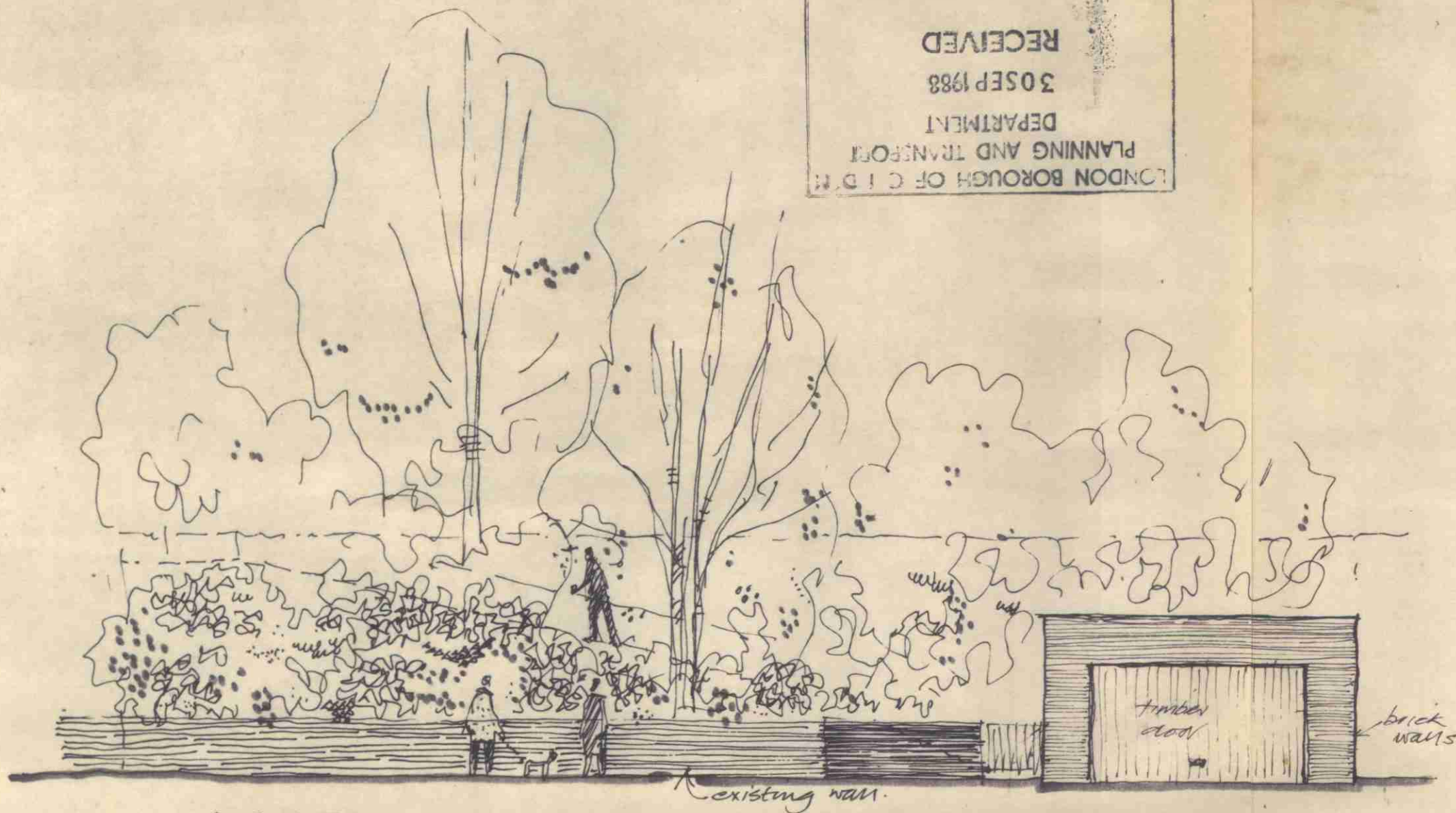

- ELEVATION -

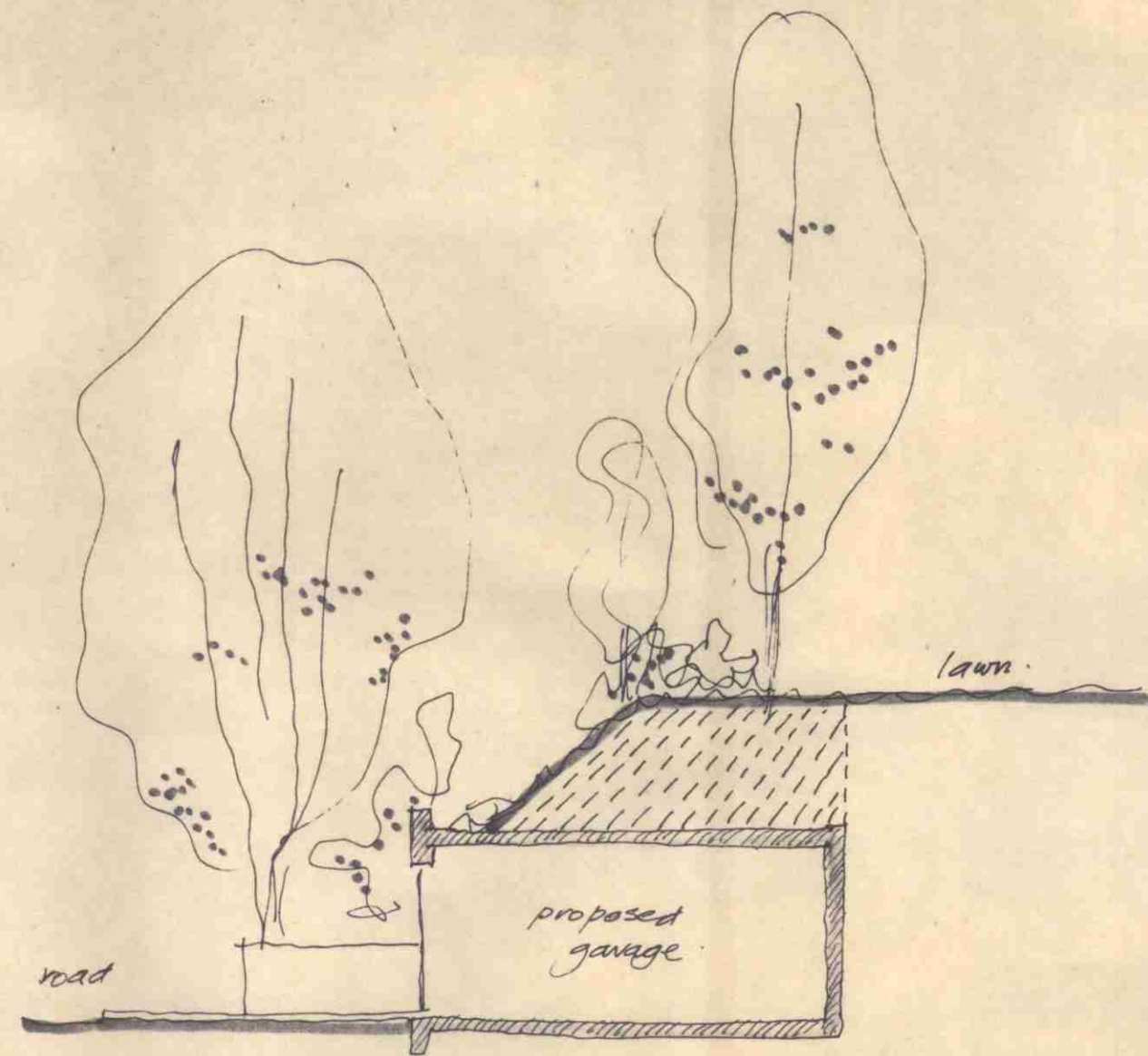

- SECTION -

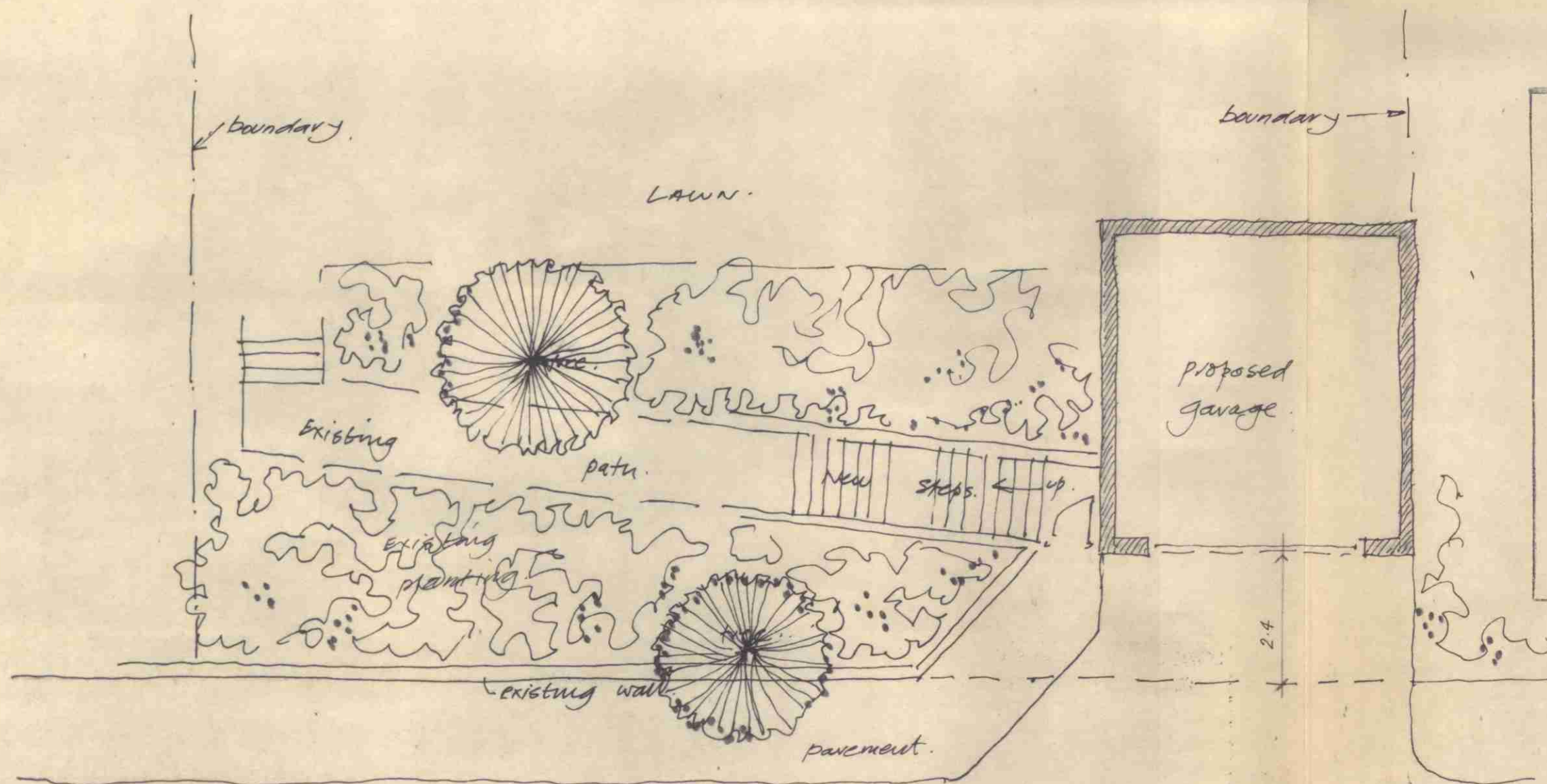

- PLAN -

CTP/8804458

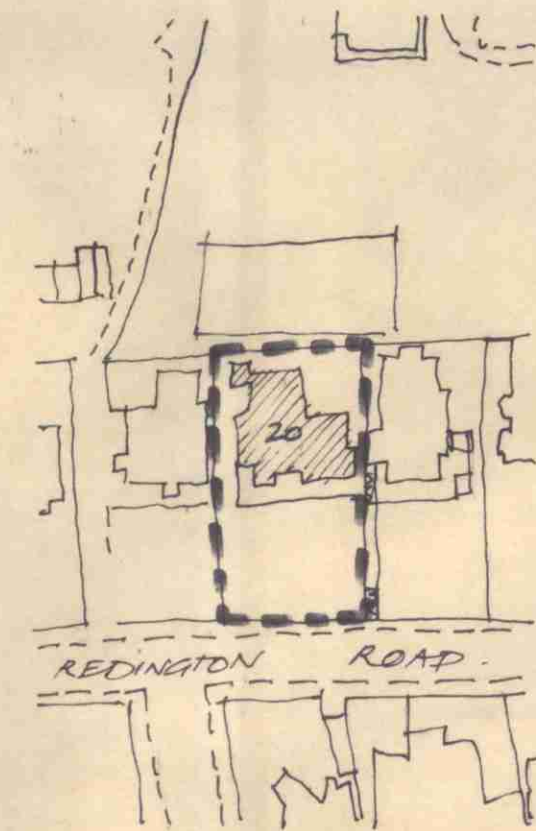

- LOCATION PLAN - scale 1/1250

LONDON BOROUGH OF CAMDEN
 PLANNING AND TRANSPORT
 DEPARTMENT
 30 SEP 1988
 RECEIVED

ALDEN ASSOCIATES ARCHITECTS & PLANNERS 8 CHESTERFORD GARDENS LONDON NW3 7DE TELEPHONE (01) 435 1692		
SCALE 1: 100	DATE SEPT 88	DRWG. No. 762/1