

Notes:

Drawings are based on survey data and may not accurately represent what is physically present.

All dimensions are to be verified on site before proceeding with the work.

All dimensions are in millimeters unless noted otherwise.

Purcell shall be notified in writing of any discrepancies.

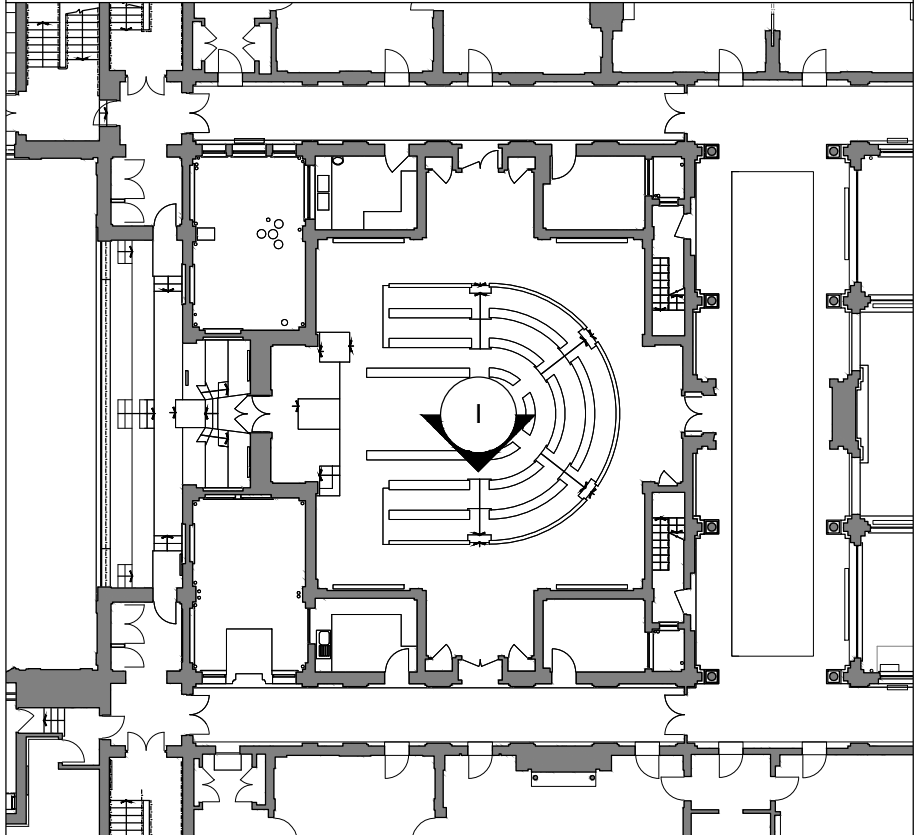

Internal Repairs & Conservation Key

Drawings to be read in conjunction with Outline Conservation Strategy - Key Areas **CTH-PUR-MP-00-SP-A-00005**

For internal Repairs and Conservation Strategy Schedule of Works, refer to drawing **CTH-PUR-MB-XX-SH-A-93000**

- Existing room with modern finishes
- Floor Box - Indicative location of proposed floor box. Cabling to be fed from below; openings located on site. Floor boxes to include bespoke joinery lid to allow for integration into heritage floor finishes
- Area of structural opening - refer to (91)000 series drawings for dimensions
- Section of timber panelling to be carefully removed for installation of electrical cabling from below. To be kept secure during works and reinstated following electrical installation. Maximum extents of removal shown - on site confirmation of panel division required
- Item of removal - Original Fabric
- Item of removal - Non-Original Fabric
- Existing undercut to doors used for exhaust air transfer to corridors
- Overhead - 300mm wide opening to ceiling for high level concealed cable distribution - make good after installation
- Overhead - Whole bay of vaulted ceiling to be removed for cabling distribution and reinstated
- High level opening in wall for services distribution
- Area of panelling/skirting removed for new grille installation for supply/return air flow. Extent of opening to services engineer's requirement.
- Area of severe damage

1:25 Scale

0 500mm 1m 1.5m 2m 2.5 m

SS P00 18 Apr 2019 OB NS

ISSUE	DATE	DRAWN	CHECKED	DESCRIPTION
DRAWING TITLE	Int Elevations - EI.34 Proposed Internal Conservation Repairs			
DRAWING NO.	CTH-PUR-MB-01-DR-A-93343			
REVISION	SS P00			
SIZE & SCALE	A1L 1:25			
DRAWING STATUS	SS SUITABLE FOR PLANNING			

CLIENT Lendlease

PROJECT Camden Town Hall

JOB NUMBER 238664

