

I

91200

SECTION A-A PROPOSED DEMOLITIONS AND STRIP OUT

1:200 @ A1

1. Existing section of slab to be demolished to introduce new lowered slab to align with external level.
2. Existing gallery raked seating removed. Existing structure retained
3. Roof lanterns and stair cores to south east terrace to be demolished. Existing structural columns to be retained.
4. All non-original suspended ceilings and proprietary fixings to be removed.

Notes:

Drawings are based on survey data and may not accurately represent what is physically present.

All dimensions are to be verified on site before proceeding with the work.

All dimensions are in millimeters unless noted otherwise.

Purcell shall be notified in writing of any discrepancies.

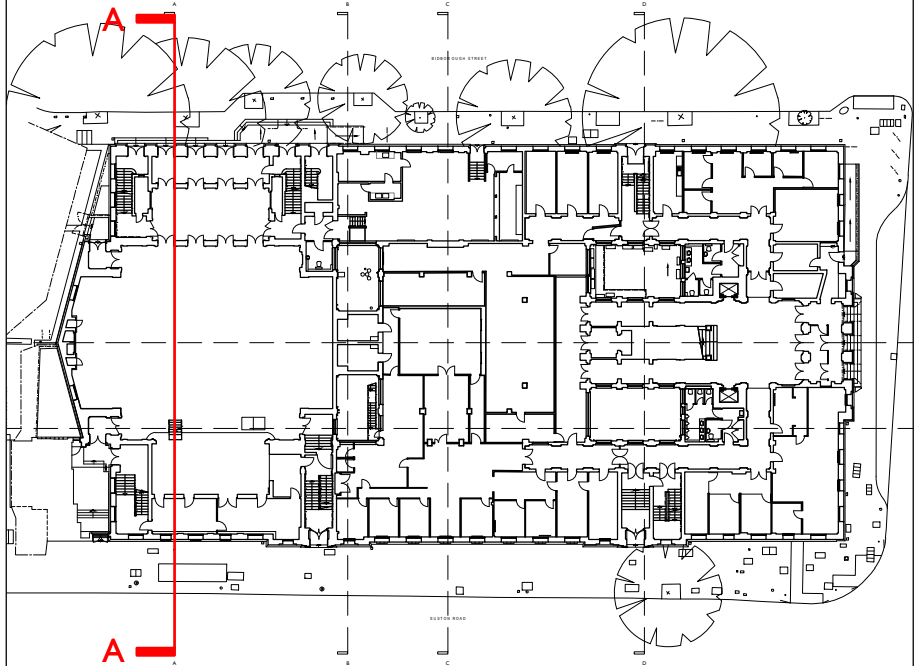

Demolitions & Alterations Key

Original fabric defined as that documented in Archive Drawings. Where date of fabric is unknown, it is assumed as original.

- Original Fabric: Section of Wall/Slab to be Demolished
- Original Fabric: Item to be Demolished
- Overhead - 300mm wide opening to ceiling for high level concealed cable distribution - make good after installation
- Overhead: Whole bay of vaulted ceiling to be removed for cabling distribution and reinstated
- Original Fabric: High level opening in wall for services distribution
- Floor trenches in slab for cable distribution
- Manhole: Opening in slab
- Non-Original Fabric: Section of Wall to be Demolished
- Non-Original Fabric: Item to be Demolished

Window Number

Door Number

Annotation Item

Drawings to be read in conjunction with:

Internal Repairs & Builder's Works drawing series (93)000 for key spaces
Conservation Strategy Report: CTH-PUR-MP-00-SP-A-00005

1:200 Scale

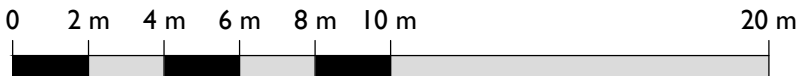

S5 P00 18 Apr 2019 OB NS

ISSUE	DATE	DRAWN	CHECKED	DESCRIPTION
DRAWING TITLE	GA PROPOSED DEMOLITIONS AND STRIP OUT SECTION A-A			
DRAWING NO.	CTH-PUR-MP-ZZ-DR-A-91200			
REVISION	S5 P00			
SIZE & SCALE	A1L 1:200			
DRAWING STATUS	S5 SUITABLE FOR PLANNING			

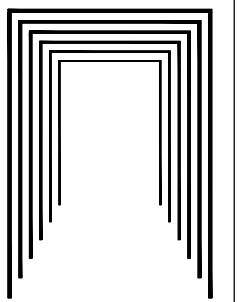
CLIENT	Lendlease	 PURCELL
PROJECT	Camden Town Hall	
JOB NUMBER	238664	