

1. New toilets to use existing drainage routes. Allowance to be made for opening up works to new drainage outlets;
2. Structural openings to lightwell wall at L/L for air supply to the underside of seat structure. Refer to propose architectural drawings for repair/upgrade and reinstatement scope of works.

Notes:

Drawings are based on survey data and may not accurately represent what is physically present.

All dimensions are to be verified on site before proceeding with the work.

All dimensions are in millimeters unless noted otherwise.

Purcell shall be notified in writing of any discrepancies.

Demolitions & Alterations Key

Original fabric defined as that documented in Archive Drawings. Where date of fabric is unknown, it is assumed as original.

- Original Fabric: Section of Wall/Slab to be Demolished
- Original Fabric: Item to be Demolished
- Overhead - 300mm wide opening to ceiling for high level concealed cable distribution - make good after installation
- Overhead: Whole bay of vaulted ceiling to be removed for cabling distribution and reinstated
- Original Fabric: High level opening in wall for services distribution
- Floor trenches in slab for cable distribution
- Manhole: Opening in slab
- Non-Original Fabric: Section of Wall to be Demolished
- Non-Original Fabric: Item to be Demolished

- Window Number
- Door Number
- Annotation Item

Drawings to be read in conjunction with:

Internal Repairs & Builder's Works drawing series (93)000 for key spaces
Conservation Strategy Report: CTH-PUR-MP-00-SP-A-00005

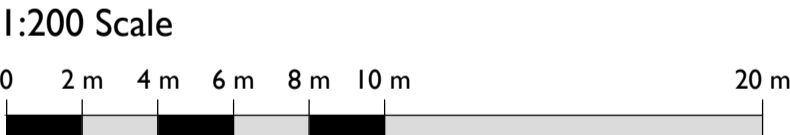

SS P00 18 Apr 2019 OB NS

ISSUE	DATE	DRAWN	CHECKED	DESCRIPTION
DRAWING TITLE	GA PROPOSED DEMOLITIONS AND STRIP OUT FIRST FLOOR MEZZANINE LEVEL PLAN			
DRAWING NO.	CTH-PUR-MP-M1-DR-A-91003			
REVISION	SS P00			
SIZE & SCALE	A1L	1:200		
DRAWING STATUS	SS SUITABLE FOR PLANNING			

CLIENT	Lendlease	
PROJECT	Camden Town Hall	
JOB NUMBER	238664	

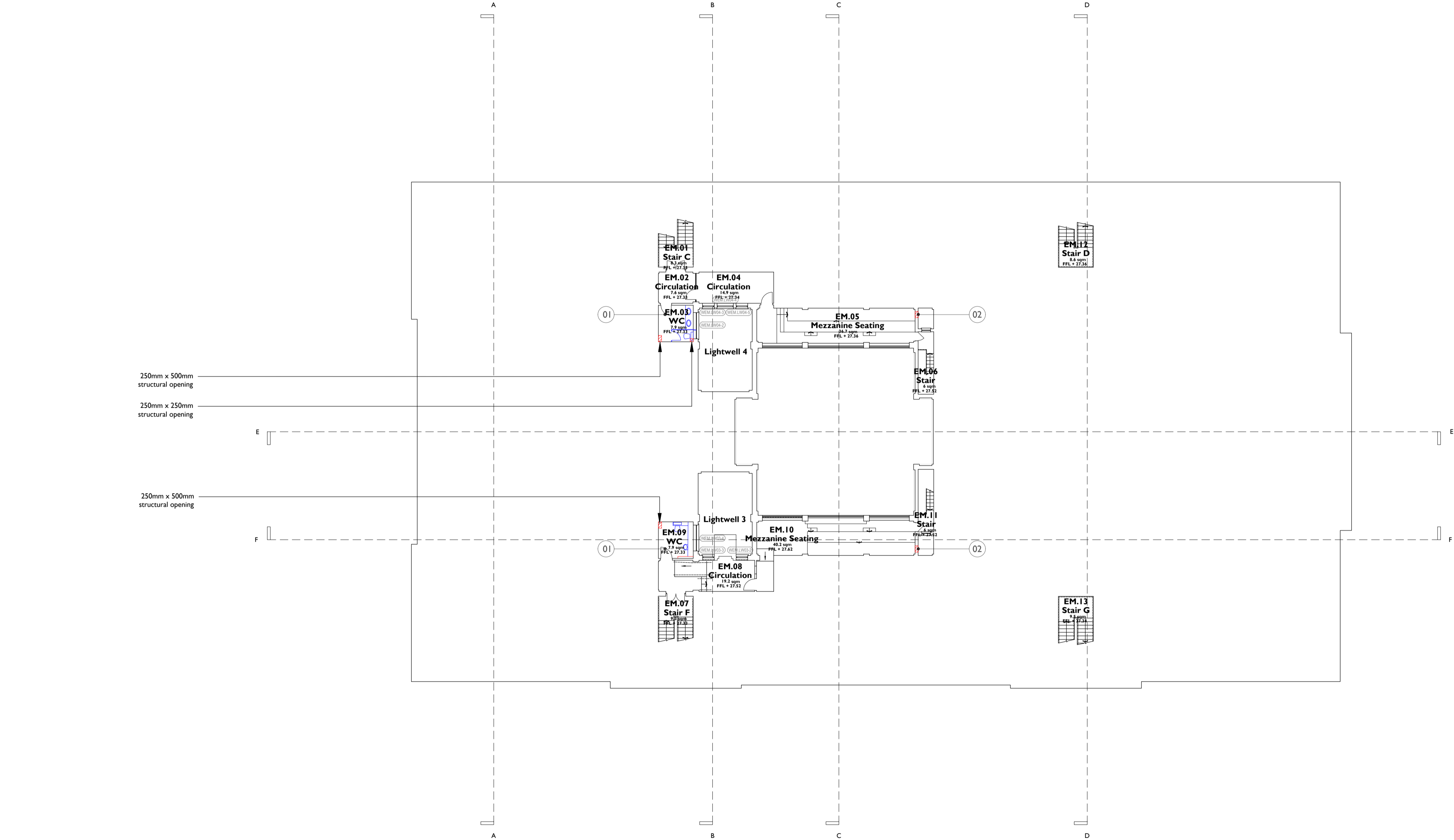

I
91003

FIRST FLOOR MEZZANINE LEVEL PLAN PROPOSED DEMOLITIONS AND STRIP OUT
1:200 @ A1