

0 1 2 3 4 5 6 7 8 9 10 M

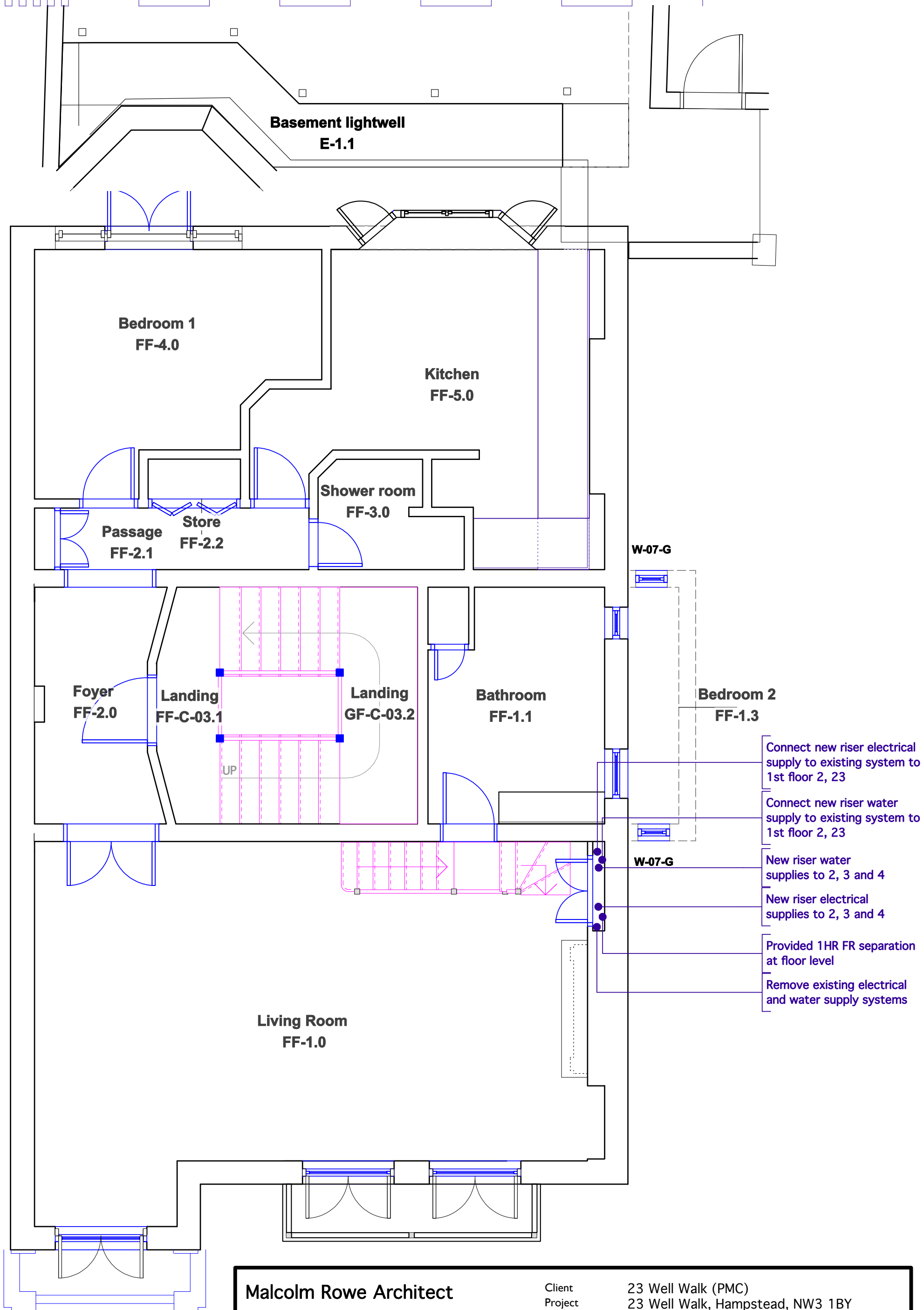

- Connect new riser electrical supply to existing system to 1st floor 2, 23
- Connect new riser water supply to existing system to 1st floor 2, 23
- New riser water supplies to 2, 3 and 4
- New riser electrical supplies to 2, 3 and 4
- Provided 1HR FR separation at floor level
- Remove existing electrical and water supply systems

Malcolm Rowe Architect		Client	23 Well Walk (PMC)
92 Dover House, Bolton Road, London N18 1HR		Project	23 Well Walk, Hampstead, NW3 1BY
Tel 0208 884 4476 Fax 0208 884 4476		Drawing Title	First Floor Flat: Proposed
Email malcolm.rowe@mac.com		Scale	1:50 @A3
© Malcolm Rowe 2018		Date	Aug 2018 Drawing No P 002
			Rev -

DO NOT SCALE FROM DRAWINGS
 Contractors must verify all dimensions on site before commencing any work or making any shop drawings.
 Materials & workmanship are to meet the requirements of current Building Regulations.
 This drawing is copyright © Malcolm Rowe 2018.

Date: **26 Nov, 2018**
 File name: **(171114) 000.vwx**