

DO NOT SCALE FROM THIS DRAWING. THE AUTHOR OF THIS DRAWING TAKES NO RESPONSIBILITY FOR ANY DIMENSIONS OBTAINED BY MEASURING OR SCALING FROM THIS DRAWING AND NO RELIANCE MAY BE PLACED ON SUCH DIMENSIONS. ALL DIMENSIONS MUST BE CHECKED AND VERIFIED ON SITE BY THE CONTRACTOR BEFORE COMMENCING ANY WORK OR PRODUCING DRAWINGS. RML ARCHITECTURE MUST BE NOTIFIED IMMEDIATELY OF ANY ERRORS OR DISCREPANCIES PRIOR TO THE COMMENCEMENT OF WORK.

THIS DRAWING AND ALL INFORMATION CONTAINED WITHIN IS THE SOLE PROPERTY OF RML ARCHITECTURE LTD AND MAY NOT BE REPRODUCED IN WHOLE OR PART WITHOUT WRITTEN PERMISSION FROM RML ARCHITECTURE LTD.

REV	DESCRIPTION	DATE	BY
A	Updated to omit rear column; Soil stack position confirm; Water feed added	28-01-19	LFC

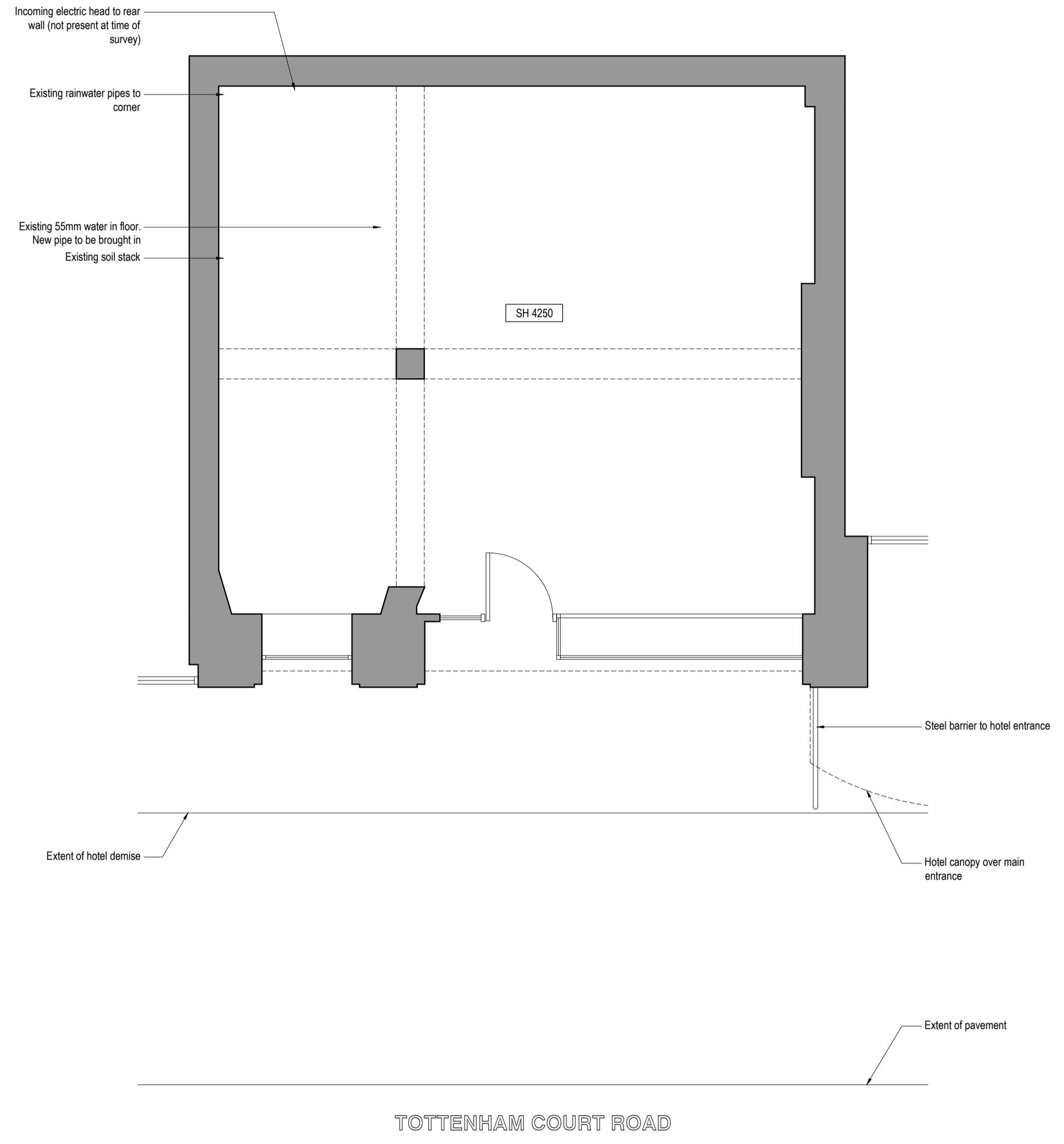

Existing General Arrangement Plan

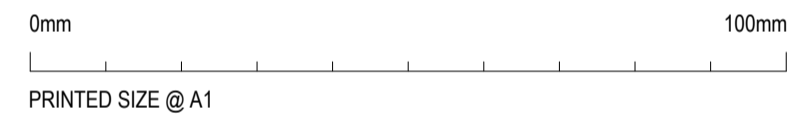

CLIENT

PAUL

PROJECT
 PAUL TOTTENHAM COURT ROAD
 127A TOTTENHAM COURT ROAD
 LONDON
 W1T 5AS

DRAWING TITLE
 EXISTING GENERAL ARRANGEMENT PLAN

PROJECT No.	DRAWN BY
2534	RML
SCALE	DATE
1:50 @ A1 / 1:100 @ A3	DEC '18
DRAWING NO.	REVISION
2534-E-01	A

DRAWING STATUS
 APPROVAL

RMLArchitecture
 12 Albion Street Brighton BN2 9NE