



**1 STREET ELEVATION**

MATHESON WHITELEY  
 Unit 2, Culford House,  
 1-7 Orsman Road  
 London N1 5RA  
 T: +44 (0) 207 033 3589  
 studio@mathesonwhiteley.com

- Notes:
- All dimensions are from structure-to-structure unless indicated otherwise.
  - Elements of structure and services are indicated for coordination purposes. For full structural and services layouts refer to Structural and Services Engineer's drawings.
  - Do not scale directly from drawing. All dimensions to be checked on site prior to construction or fabrication of any elements.
  - Any discrepancies between figured dimensions to be reported to architect for clarification prior to commencing work.

© Copyright reserved.

- Revision:
- 19.12.18  
Issued as planning application
  - 11.03.19  
Changes during planning

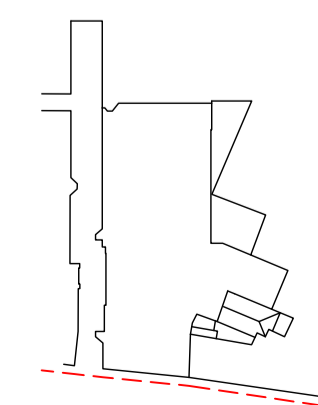

Client:	GSN Warner LLP	Scale:	1:125 @ A1 / 1:250 @A3	Drw:	RD
		Issue date:	NOV 2018	Chk:	DM
Project:	108 8-10 WARNER STREET	Title:	PROPOSED ELEVATION - STREET		
		Drawing no:	220	Rev:	A
Status:	TENDER				



**1 NORTH ELEVATION**

MATHESON WHITELEY  
 Unit 2, Culford House,  
 1-7 Orsman Road  
 London N1 5RA  
 T: +44 (0) 207 033 3589  
 studio@mathesonwhiteley.com

Notes:  
 - All dimensions are from structure-to-structure unless indicated otherwise.  
 - Elements of structure and services are indicated for coordination purposes. For full structural and services layouts refer to Structural and Services Engineer's drawings.  
 - Do not scale directly from drawing. All dimensions to be checked on site prior to construction or fabrication of any elements.  
 - Any discrepancies between figured dimensions to be reported to architect for clarification prior to commencing work.

Revision:	
1	19.12.18 Issued as planning application
A	11.03.19 Changes during planning
B	28.03.19 Changes during planning
C	04.04.19 Changes during planning

Client:	GSN Warner LLP	Scale:	1:50 @ A1 / 1:100 @ A3	Drw:	RD
Project:	108 8-10 WARNER STREET	Issue date:	NOV 2018	Chk:	DM
Status:	TENDER	Title:	PROPOSED ELEVATION - NORTH	Rev:	C
		Drawing no:	<b>221</b>		



MATHESON WHITELEY  
 Unit 2, Culford House,  
 1-7 Orsman Road  
 London N1 5RA  
 T: +44 (0) 207 033 3589  
 studio@mathesonwhiteley.com

Notes:  
 - All dimensions are from structure-to-structure unless indicated otherwise.  
 - Elements of structure and services are indicated for coordination purposes. For full structural and services layouts refer to Structural and Services Engineer's drawings.  
 - Do not scale directly from drawing. All dimensions to be checked on site prior to construction or fabrication of any elements.  
 - Any discrepancies between figured dimensions to be reported to architect for clarification prior to commencing work.

© Copyright reserved.

Revision:	19.12.18 Issued as planning application
	11.03.19 Changes during planning

Client:	GSN Warner LLP	Scale:	1:50 @ A1 / 1:100 @ A3	Drw:	RD
Project:	108 8-10 WARNER STREET	Issue date:	OCT 2018	Chk:	DM
Status:	TENDER	Title:	PROPOSED FIRST FLOOR PLAN	Drawing no:	111
				Rev:	A

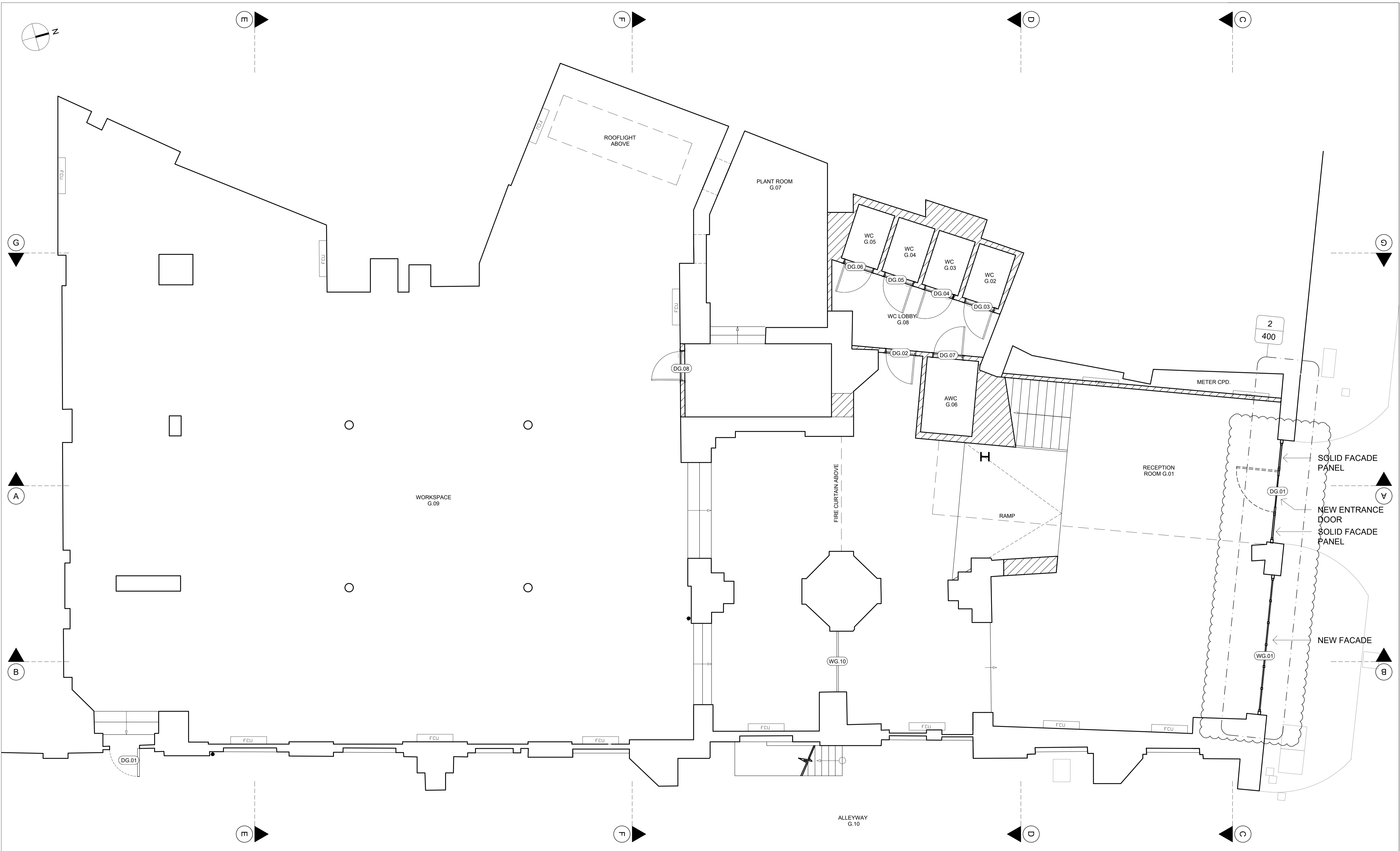

MATHESON WHITELEY  
 Unit 2, Culford House,  
 1-7 Orsman Road  
 London N1 5RA  
 T: +44 (0) 207 033 3589  
 studio@mathesonwhiteley.com

Notes:  
 - All dimensions are from structure-to-structure unless indicated otherwise.  
 - Elements of structure and services are indicated for coordination purposes. For full structural and services layouts refer to Structural and Services Engineer's drawings.  
 - Do not scale directly from drawing. All dimensions to be checked on site prior to construction or fabrication of any elements.  
 - Any discrepancies between figured dimensions to be reported to architect for clarification prior to commencing work.

© Copyright reserved.

Revision:	19.12.18 Issued as planning application
	11.03.19 Changes during planning

Client:	GSN Warner LLP
Project:	108 8-10 WARNER STREET
Status:	TENDER

Scale:	1:50 @ A1 / 1:100 @ A3	Drw:	RD
Issue date:	OCT 2018	Chk:	DM
Title:	PROPOSED GROUND FLOOR PLAN		
Drawing no:	110	Rev:	A