

J131.29



**PROPOSED PERMEABLE BLOCK PAVING**  
Product: Tobermore Hydropave Tegula  
Sizes: 208x173x60mm  
173x173x60mm  
Colour: Bracken



**PROPOSED PEDESTRIAN PERMEABLE BLOCK PAVING**  
Product: Tobermore Hydropave Tegula  
Sizes: 208x173x60mm  
Colour: Natural



**PROPOSED CAR PARKING DEMARCATIO**  
Product: Tobermore Hydropave Tegula  
Sizes: 208x173x60mm  
Colour: Charcoal



**PROPOSED KERBSTONE**  
Product: Tobermore Country Kerb  
Size: 255x125x915mm  
Colour: Granite



**PROPOSED BIN STORE**  
Product: Prestige Slatted Bin Store  
Size: 1290x800x900mm  
Colour: Radiata Pine with a teak stain finish



**PROPOSED CYCLE STORAGE**  
Product: Double Bike Locker  
Size: Width 900mm Depth 1900mm Height 1205mm  
Finish: Green with a left-hinged handle.  
Storage Capacity: 2 Cycles Total Storage 4 Cycles

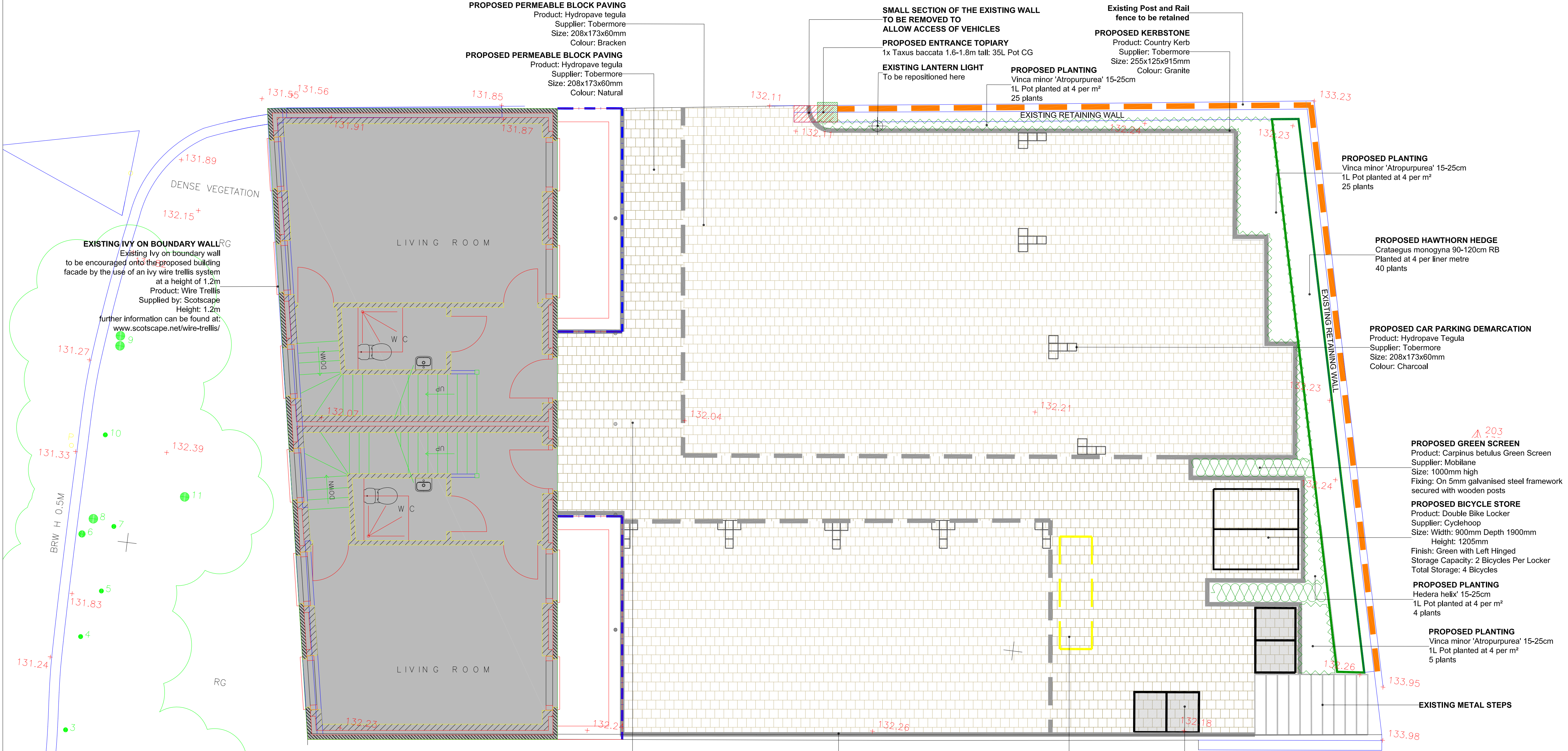

**DIFFERENCES IN THE COLOUR OF THE PERMEABLE BLOCK USED WILL BE SIMILAR (AS SHOWN IN THE IMAGES ABOVE) TO AVOID CONFUSION FOR DRIVERS BUT CLEARLY DEMARKED BY THE KERBSTONE**

**PROPOSED KERBSTONE**  
Product: Country Kerb  
Supplier: Tobermore  
Size: 255x125x915mm  
Colour: Granite

**INDICATIVE AREA FOR THE STORAGE OF THE EXISTING BINS FOR JACK STRAWS CASTLE**

**PROPOSED BIN STORE**  
Product: Prestige slatted bin store  
Supplier: Garden Trellis Co.  
Size: 1290x2180x900mm  
Colour: Radiata Pine finish with a teak stain

#### OUTLINE SPECIFICATION

**TREE PROTECTION**  
Existing trees and shrubs to be retained shall be protected in accordance with the current British Standard 'Trees in relation to construction', generally fencing shall be a 1.2m high cleft chestnut or 1.8m 'Heras' type fencing secured and maintained in position for the duration of construction.

#### GENERAL

All planting work & plants shall be in accordance with all approved current/relevant horticultural & British Standard specifications including 'Nursery stock', 'Landscape Operations', 'Trees in relation to Design, Demolition & Construction', 'Tree Work' and the latest National Building Specification, National Plant Specification & HTA 'Handling & Establishing Landscape Plants, Herbicides, pesticides and other chemicals may only be used with the approval of the CA. Use of chemicals shall be in accordance with all relevant guidelines and the manufacturers recommendations. Imported topsoil shall be a minimum specification of General purpose grade, unless otherwise instructed. 1 cum approved compost/organic material/soil amendment per 20 sq m shall be cultivated into topsoil before planting. Peat shall not be used. Following planting all shrub beds shall be treated with an approved granular fertiliser at rates recommended by the manufacturer. All ornamental planting beds shall be mulched with 50mm depth medium grade ornamental bark mulch. All hedge and native planting shall be mulched with 75mm depth mushroom compost.

#### TOPSOIL

Existing topsoil should be stripped before building works begin. Imported topsoil shall be a minimum specification to current British Standard Multi purpose grade from an approved source in accordance to the above specification, unless otherwise instructed.

#### MAINTENANCE

The defects liability period for planting shall be 12 months from completion of the works, maintenance works to the current British Standard. During this period, any plant which is found to be dead, dying or otherwise defective shall be replaced at the expense of the contractor during the next planting season. The contractor shall make maintenance visits as required to ensure the successful establishment of the planting and maintain all shrub areas in a weed free condition. Regular visits (minimum 8 No.) required, to maintain all planted areas in a weed and litter free condition using a combination of chemical spray and hand weeding to be agreed with the Landscape Architect. Maintenance to include watering, pruning, pest and disease control and re-mulching as required to current British Standard. Final visit to be immediately prior to handing over and to include a fertiliser treatment of Enmag (6:20:10) at 100g/m2 and 25mm depth bark mulch top up to all planted area. Grass mowing at two week intervals during growing season. Maintenance to be carried out in years 2-5 to be agreed.

#### PLANT SCHEDULE

Specimen Shrubs - Planted into 450mm depth topsoil.  
Hedge Planting - 500mm depth topsoil

#### PLANT MATERIAL TREATMENT

NB: All to be British grown stock and fully hardened off.  
Root Dip - Proprietary Root Dip applied to all bare rooted stock (1) at time of lifting at nursery and (2) prior to planting.  
Anti-Dessicant - Proprietary anti-dessicant to be applied to foliage of all containerised / root balled material in leaf, specimen conifers and evergreen etc., (1) prior to transportation and (2) during any delay in planting.  
Pruning - Allow for pruning of all shrubs by 1/3rd following planting at Landscape Architects instruction or as indicated in the planting schedule.

#### Planting Schedule

Species	Size	Density	Number
Carpinus betulus Green Screen	As supplied 1000m high	As Supplied	5.5m
Crataegus monogyna	90-120cm RB	4 per linear m	40
Hedera helix	15-25cm 1L Pot	8 per m²	4
Vinca minor 'Atropurpurea'	15-25cm 1L Pot	4m²	30
Taxus baccata cone	1.6-1.8m tall CG 35L Pot	AS DWG	1

#### SUPPLIER INFORMATION

**Paving**  
Tobermore  
T: 02879642411  
W: www.tobermore.co.uk

**Green Screen**  
Mobilane  
T: 0203 741 8049  
W: www.mobilane.co.uk

**Hawthorn Hedge**  
Hedges Direct  
T: 01257 263873  
W: www.hedgesdirect.co.uk  
Backfill material to include tree planting compost and slow release fertilizer.

**Yew Topiary**  
Hedges Direct  
T: 01257 263873  
W: www.hedgesdirect.co.uk

**Bin Store**  
The Garden Trellis Co.  
T: 01255 688361  
W: www.gardentrellis.co.uk

**Bike Locker**  
Cyclehoop  
T: 02086991338  
W: www.cyclehoop.com

**Ivy Trellis System**  
Scotscape  
T: 02082545000  
W: www.scotscape.net

Note:  
The material contained in this document has been reproduced from an Ordnance Survey map with permission of the Controller of Her Majesty's Stationery Office. Crown Copyright Licence number AL100035542

#### Key

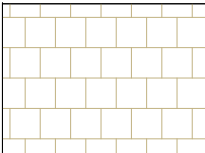

**PROPOSED PERMEABLE BLOCK PAVING**  
Product: Hydropave Tegula  
Supplier: Tobermore  
Size: 208x173x60mm  
Colour: Bracken  
Or similar approved

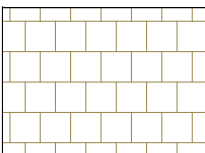

**PROPOSED PEDESTRIAN PERMEABLE BLOCK PAVING**  
Product: Hydropave Tegula  
Supplier: Tobermore  
Size: 208x173x60mm  
Colour: Natural  
Or similar approved

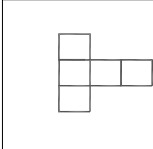

**PROPOSED CAR PARKING DEMARCATIO**  
Product: Hydropave Tegula  
Supplier: Tobermore  
Size: 208x173x60mm  
Colour: Charcoal  
Or similar approved

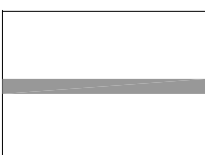

**PROPOSED KERB EDGING**  
Product: Country Kerb  
Supplier: Tobermore  
Size: 255x125x915mm  
Colour: Granite  
Or similar approved

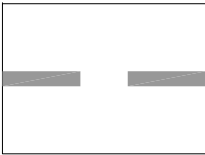

**PROPOSED FLUSH KERB EDGING**  
Product: Country Kerb  
Supplier: Tobermore  
Size: 255x125x915mm  
Colour: Granite  
Or similar approved



**PROPOSED RAILINGS**  
To architects details

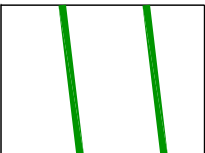

**PROPOSED HAWTHORN HEDGE**  
Crataegus monogyna 90-120cm RB  
planted at 4 per linear metre  
into irrigated troughs  
available from Hedges Direct

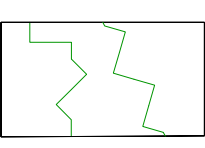

**PROPOSED PLANTING**  
Vinca minor 'Atropurpurea' 15-25cm 1L Pot  
planted at 4 per m²

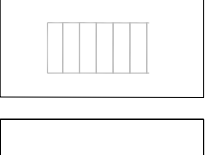

**EXISTING METAL STEPS**  
To be retained

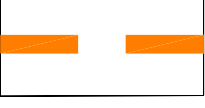

**EXISTING POST AND RAIL FENCE**  
To be retained

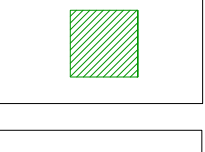

**PROPOSED ENTRANCE TOPIARY**  
Taxus baccata cone  
1.6m - 1.8m tall 35L Pot CG

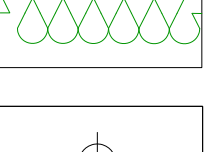

**PROPOSED GREEN SCREEN**  
Carpinus betulus Green Screen  
1000mm high

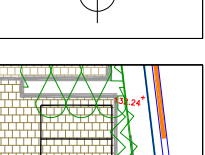

**EXISTING LANTERN LIGHT**  
To be repositioned on site

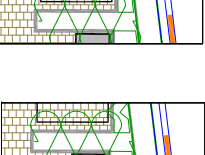

**PROPOSED CYCLE STAND**  
Product: Double Bike Locker  
Supplier: cyclehoop  
Size: Width: 900mm Height 1205mm Depth: 1900mm  
Finish: Green with left hinged  
Total of 2 Storage Lockers of a total of 4 bicycle spaces

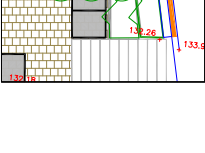

**PROPOSED BIN STORE**  
Product: Prestige slatted bin store  
Supplier: Garden Trellis Co.  
Size: 1290x2180x900mm  
Colour: In a Radiata Pine finish with a teak stain  
To fit a 140l wheelite bin, a free standing Kitchen caddy and a free-standing receptacle for the storage of refuse  
Or similar approved

REV M, 26.04.2018, Light wells increased & Car Park amended

REV L, 06.04.2018, Minor amendment to the Ivy Trellis System

REV K, 03.04.2018, Amendments to cycle store & minor amendments

REV J, 29.06.2017, Amendments to proposed hedge & green roof

REV I, 08.08.2017, Minor amendments

revision / date / description / drawn

Gloucester House

399 Silbury Boulevard

Milton Keynes

MK9 2AH

T 01908 303701

F 01908 303701

W www.enplan.net

**enplan**  
incorporating vista

client

**Albany Group**

project scale

**Jack Straws Castle** 1:100 @ A3

date

26.04.2018

title drawn

**Hard and Soft** S.J.S

**Landscape Proposals** checked

drawing number revision

**06-681-200-01** M

DO NOT SCALE FROM THIS DWG | DRAWING SUBJECT TO COPYRIGHT