



**GENERAL NOTES**  
 DO NOT SCALE OFF THIS DRAWING. ALL DIMENSIONS MUST BE CHECKED ON SITE INFORM THE ARCHITECT OF ANY DISCREPANCIES PRIOR TO CONSTRUCTION. THIS DRAWING IS COPYRIGHT & MAY NOT BE OTHERWISE USED OR COPIED. READ IN CONJUNCTION WITH M.E.P. S.E. AND CIVIL ENGINEER'S DRAWINGS.  
 CDM REGULATIONS 2015  
 ALL CURRENT DRAWINGS AND SPECIFICATIONS FOR THE PROJECT MUST BE READ IN CONJUNCTION WITH THE DESIGNER'S HAZARD AND ENVIRONMENTAL ASSESSMENT RECORD

**Key**

-  Existing
-  Proposed

**Note:**  
 Please read in conjunction with:  
 - Reflected Ceiling Plans  
 - Wall, Ceiling and Floor Type typical details  
 - Compartmentation Drawings  
 - Door and Window Schedules  
 - Sanitaryware Schedule  
 - Ironmongery Schedule  
 - Delta Light lighting layouts and specifications  
 - M.E.P and S.E tender drawings

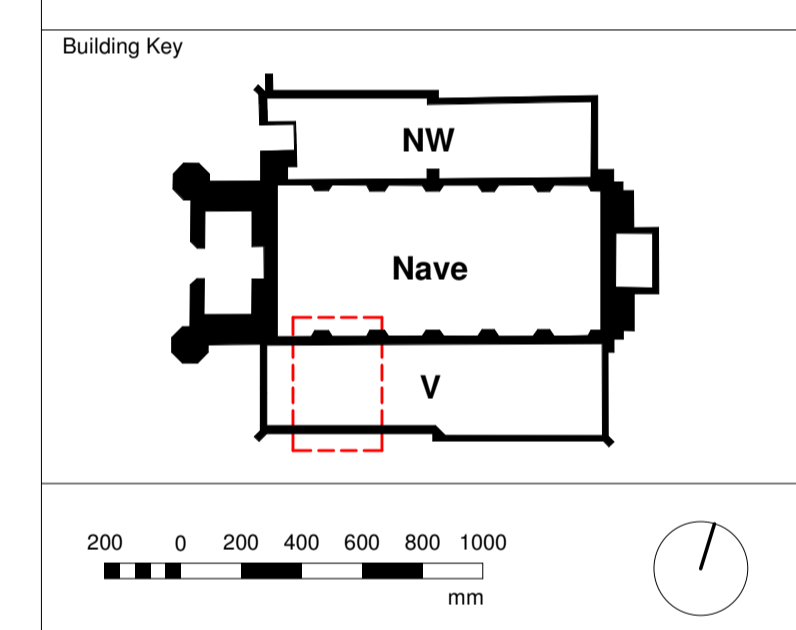
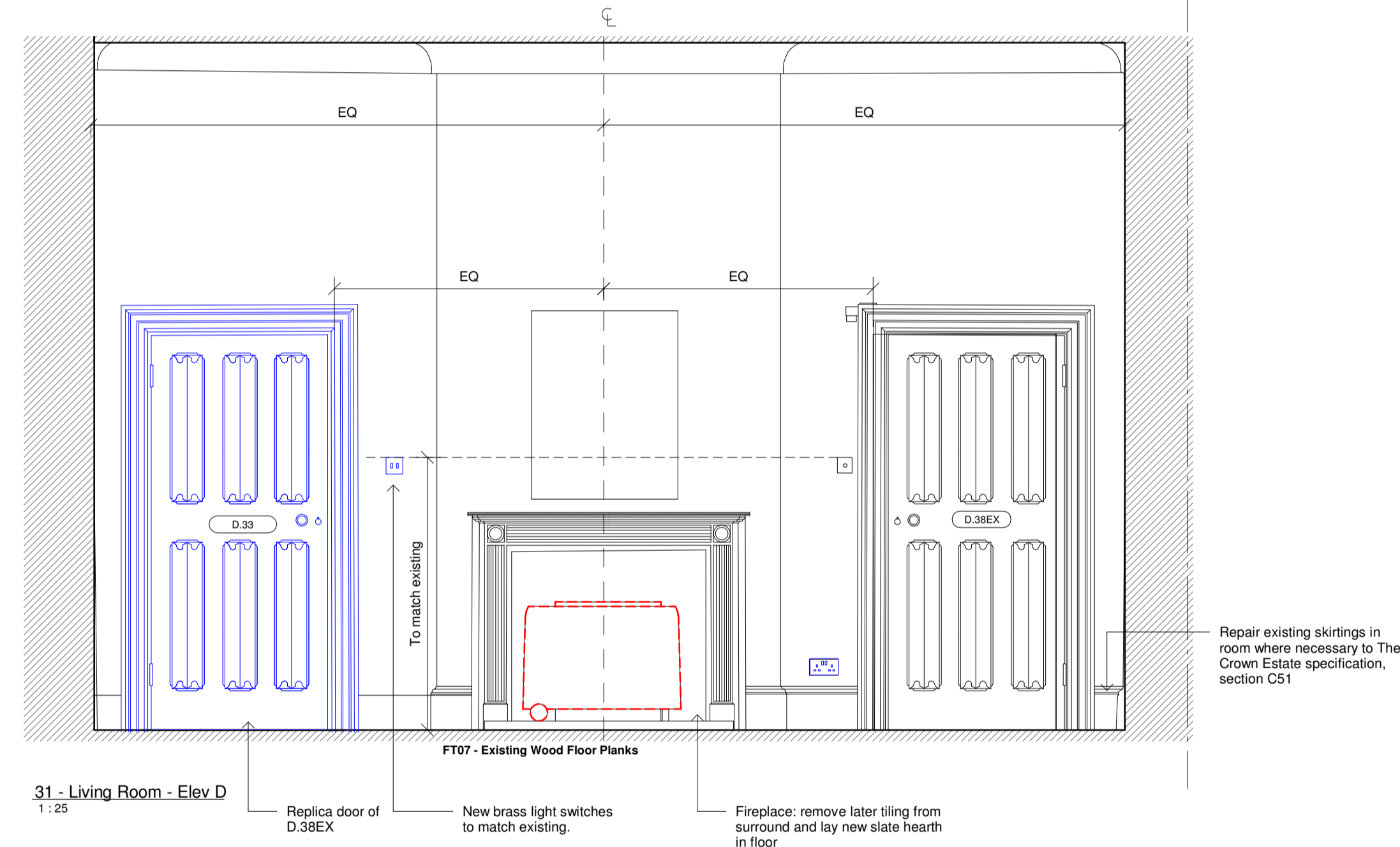
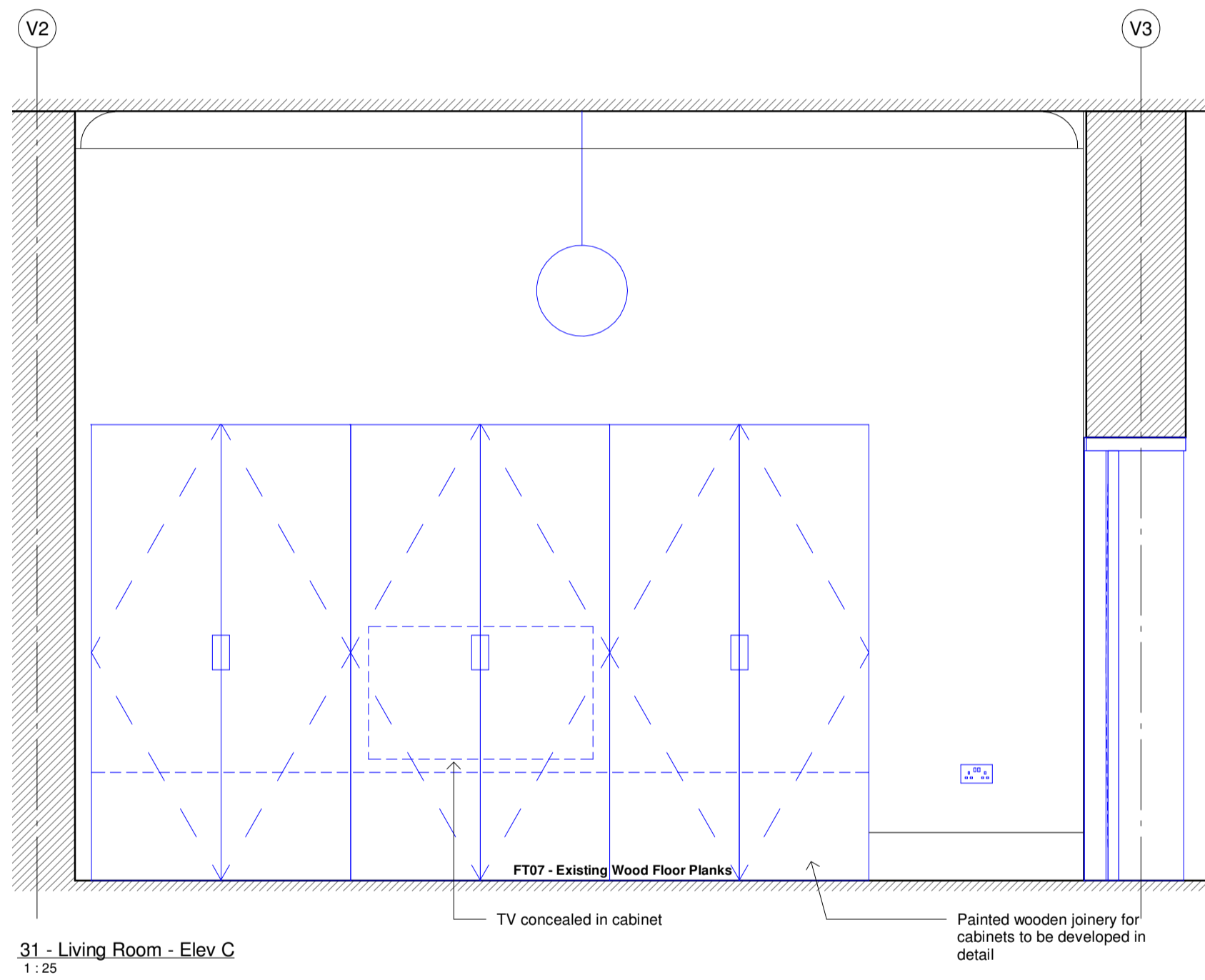
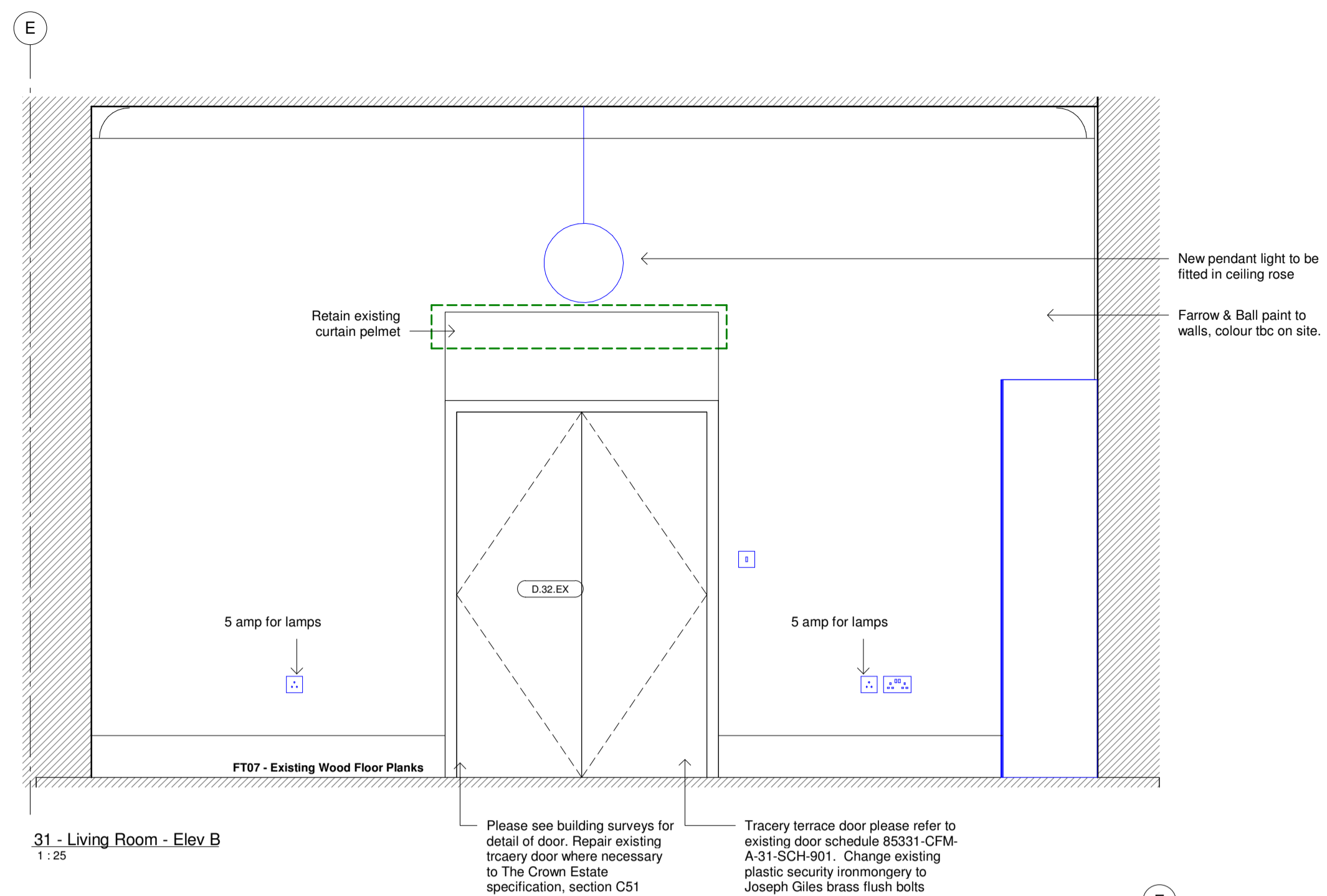
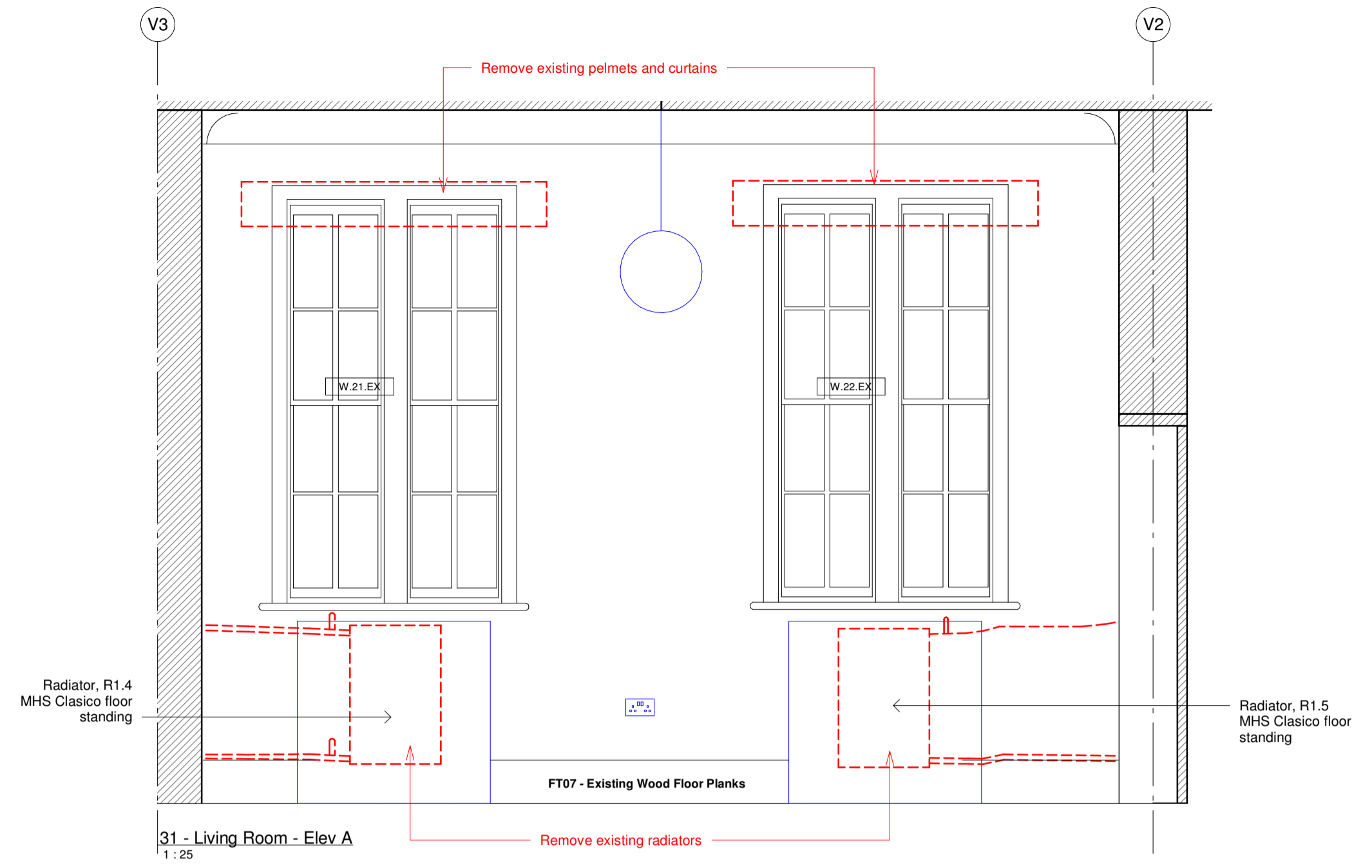

The Danish Church  
 4 St Katharine's Precinct  
 London NW1 4HH

**C.F. Møller**  
 Telephone House, 69-77 Paul Street  
 London, EC2A 4NW  
 United Kingdom  
 Tel.: +44 020 7427 1530  
 london@cfmoller.com  
 Europaplads 2, 11  
 8000 Aarhus C  
 Denmark  
 Tel.: +45 8730 5300  
 www.cfmoller.com

| Rev | Description  | By  | Chk | Date     |
|-----|--------------|-----|-----|----------|
| A   | Tender Issue | HBA | RN  | 08/02/19 |

Project  
**The Danish Church**  
 Title  
**The Vicarage - Room Data Sheet**  
**31 - Living Room**

Project No.  
**85331**  
 Status  
**Stage 4 - TENDER**  
 Scale @ A1  
 As indicated  
 Date  
 08/02/19  
 Revision  
 A  
 Drawing Number  
**85331-CFM-26-831**

