

NW - D.03 - Ele.
1:10

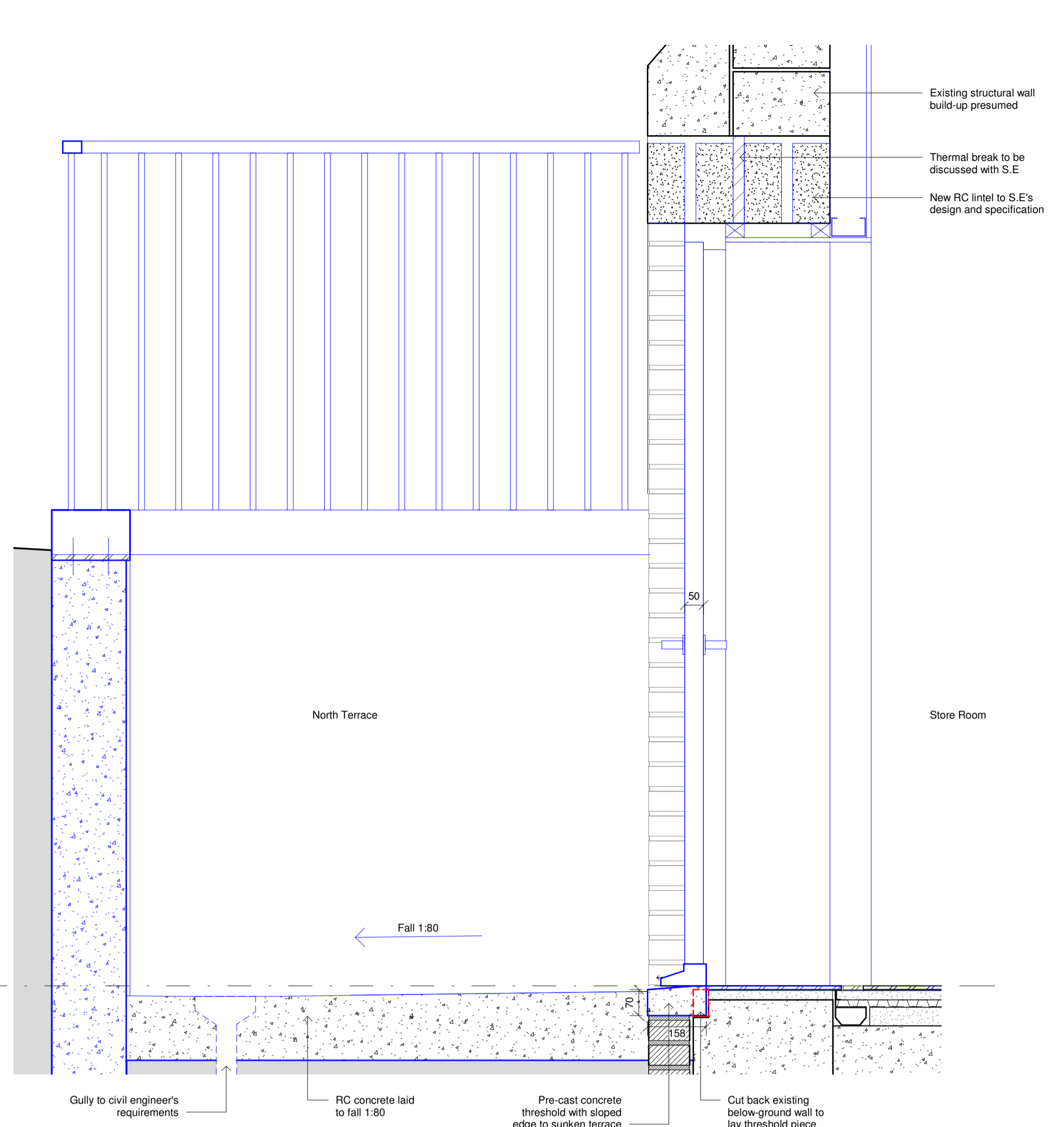

NW - D.03 - Sec
1:10

GENERAL NOTES
DO NOT SCALE OFF THIS DRAWING.
ALL DIMENSIONS MUST BE CHECKED ON SITE INFORM THE ARCHITECT OF ANY DISCREPANCIES PRIOR TO CONSTRUCTION.
THIS DRAWING IS COPYRIGHT & MAY NOT BE OTHERWISE USED OR COPIED.
READ IN CONJUNCTION WITH M.E.P. S.E. AND CIVIL ENGINEER'S DRAWINGS.
CDM REGULATIONS 2015
ALL CURRENT DRAWINGS AND SPECIFICATIONS FOR THE PROJECT MUST BE READ IN CONJUNCTION WITH THE DESIGNER'S HAZARD AND ENVIRONMENTAL ASSESSMENT RECORD

Key
Existing
Proposed

Please note
1. All structural opening dimensions shown are subject to confirmation on site, following opening up works and surveys undertaken by specialist subcontractor.
2. All final window and door sizes are subject to confirmation by specialist window and door suppliers.

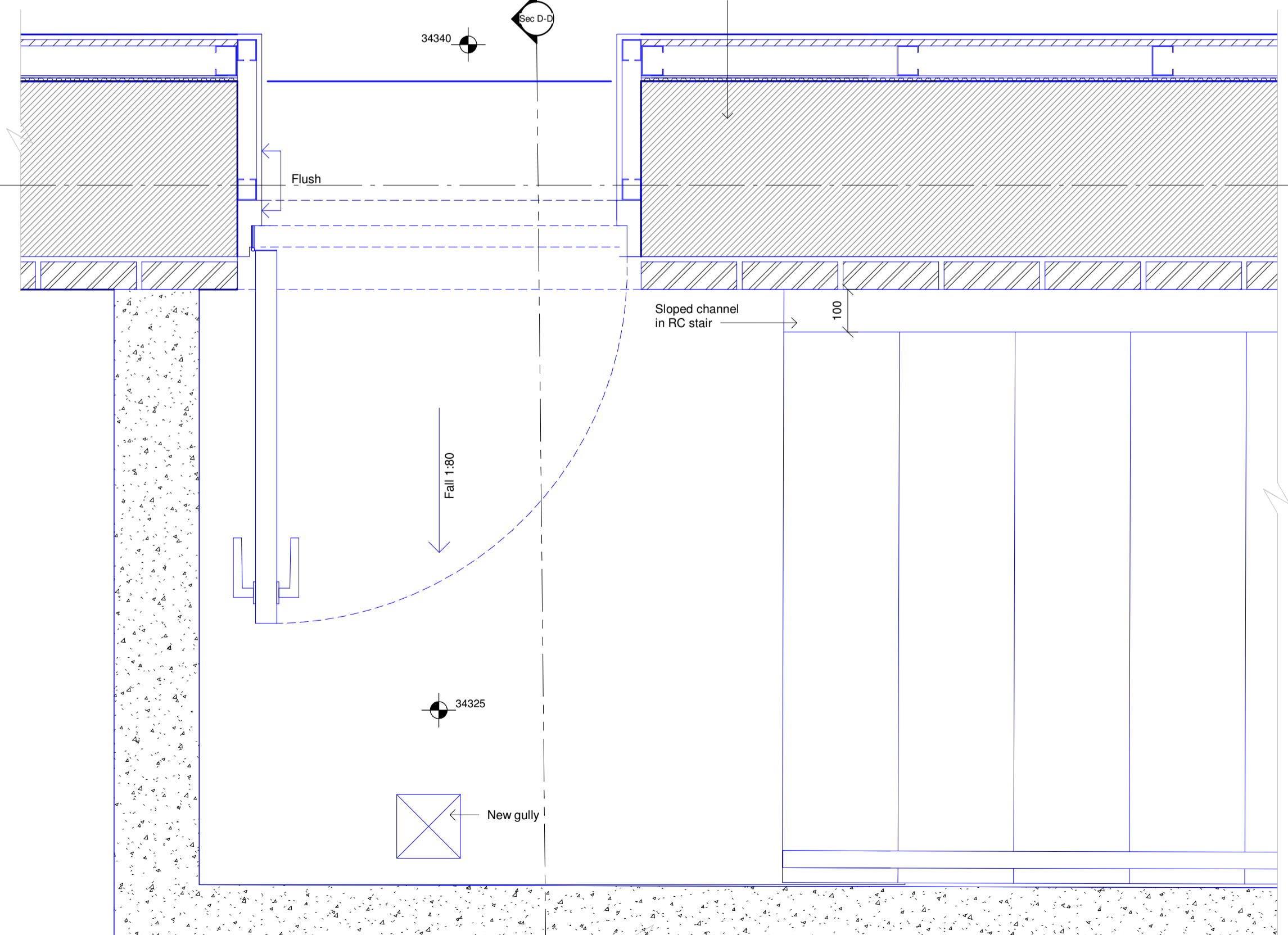
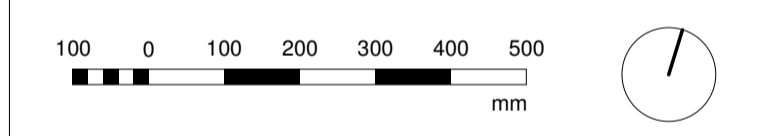
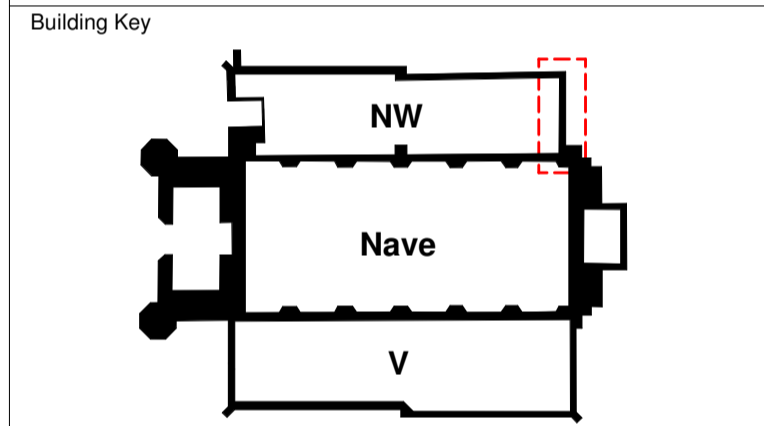

NW - D.03 - Plan
1:10

D.03

Description	Steel frame exterior door. Provides new second means of escape to North Wing basement.
Approx. structural opening size	950 x 2000mm
Clear opening width	800mm
Threshold	Sloped pre-cast concrete threshold, as shown
Finishes	Steel frame exterior door, PPC RAL 9005
Louvers	620 x 300mm stainless steel louvers, RAL to match door
Ironmongery	External door handle to be approved, to door supplier's spec. Flush security bolts inset, top and bottom.

Existing Condition



Client
The Danish Church
4 St Katharine's Precinct
London NW1 4HH

C.F. Møller
Telephone House, 69-77 Paul Street
London, EC2A 4NW
United Kingdom
Tel.: +44 020 7427 1530
london@cfmoller.com
Europaplads 2, 11
8000 Aarhus C
Denmark
Tel.: +45 8730 5300
www.cfmoller.com

C	Planning Condition Discharge	HBA	RN	16.04.19
A	Tender Issue	HBA	RN	08.02.19
Rev	Description	By	Chk	Date

The Danish Church
Title
North Wing - Kitchen Storage
Door - D.03
Details

Project No.
85331

Status
Stage 4 - TENDER

Scale @ A1	Date	Revision
1:10	08/02/19	C

Drawing Number
85331-CFM-21-607