

**The Vicarage**  
Typical Head Details

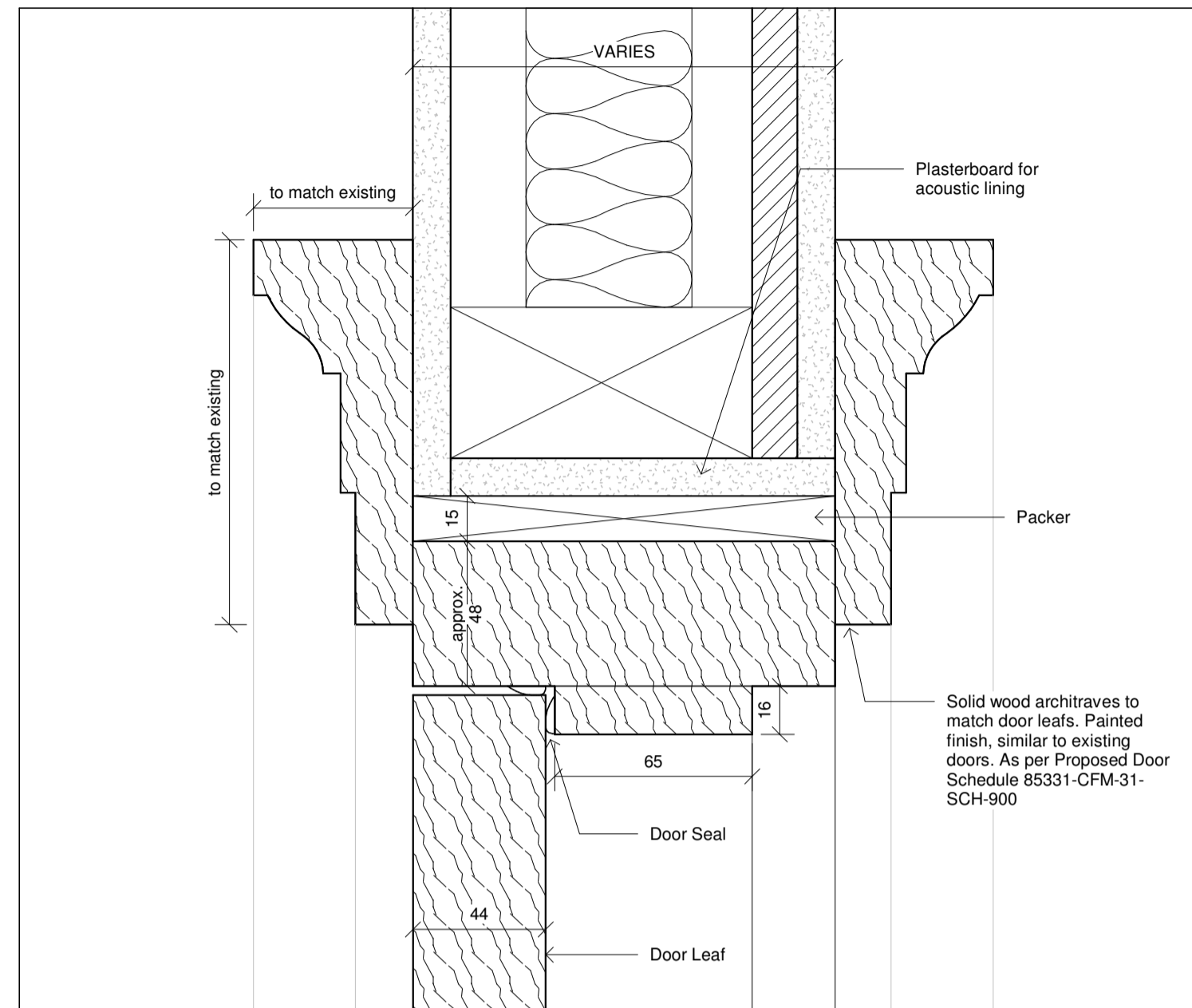

The Vicarage - Typical Head Detail  
1:2

**The Vicarage**  
Typical Jamb Details

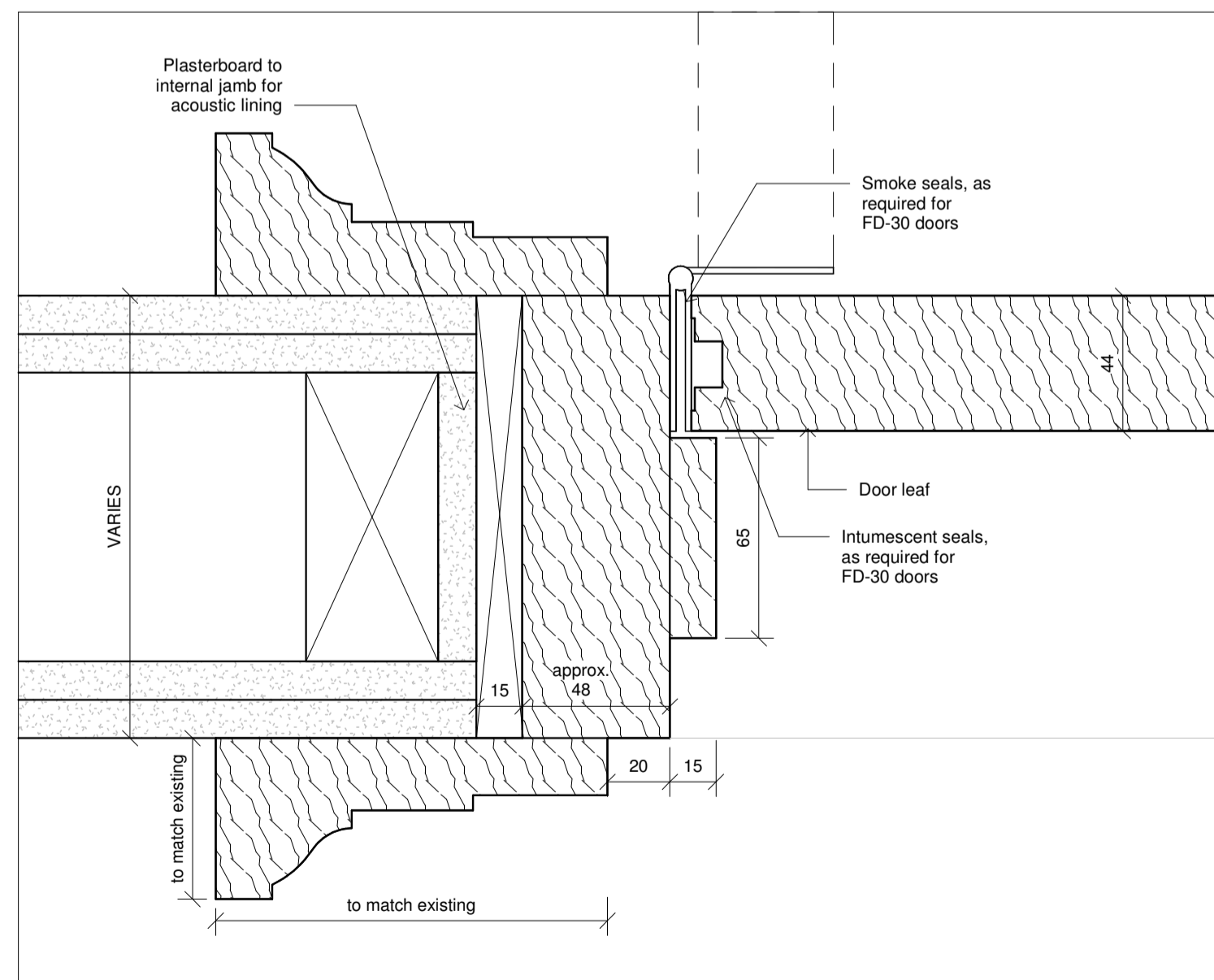

The Vicarage - Typical Jamb Detail  
1:2

**The Vicarage**  
Typical Threshold Details

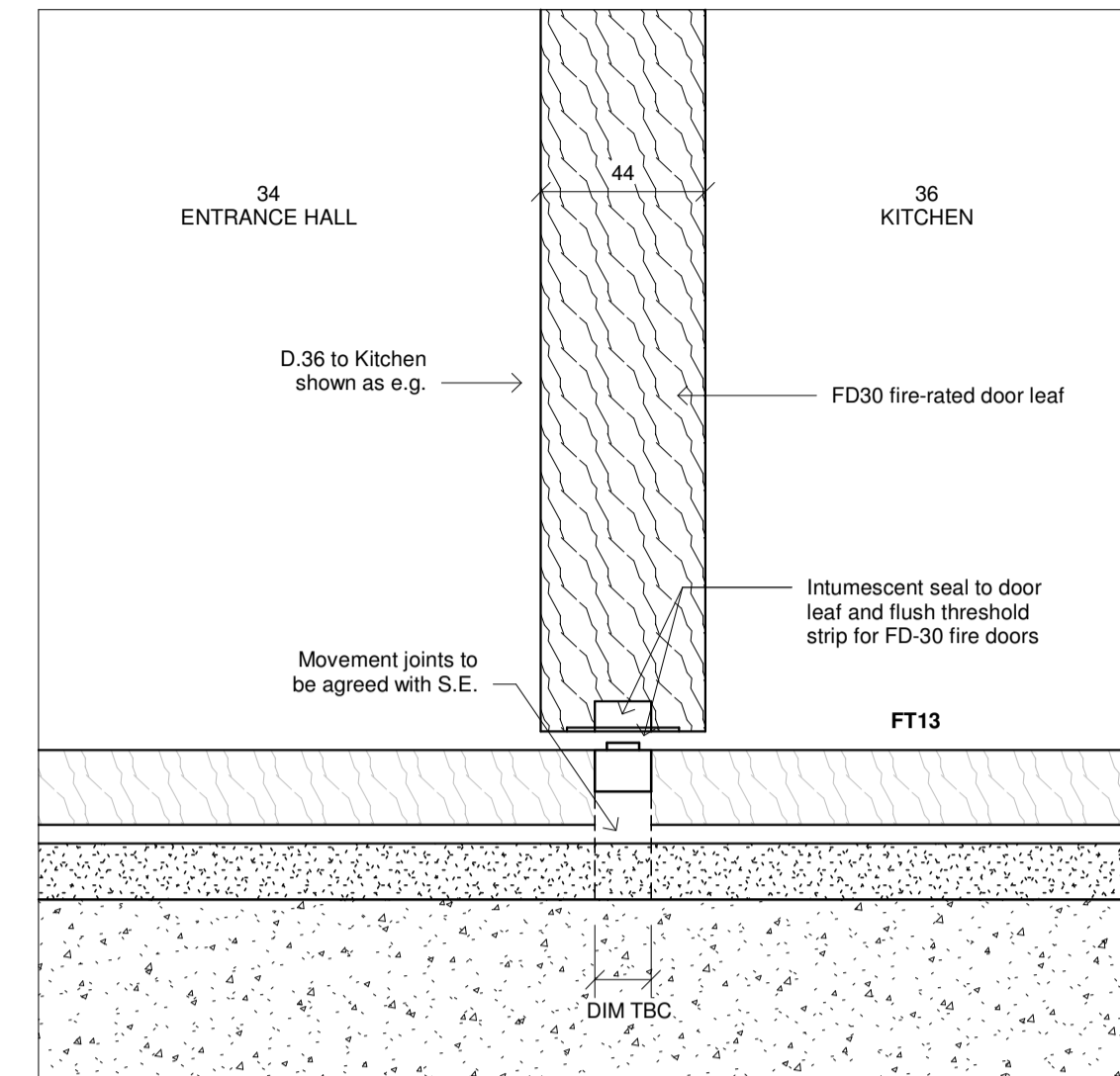

The Vicarage - Threshold Detail 01 - FD30 door  
1:2

Applies to:  
• FD-30 rated doors to Vicarage

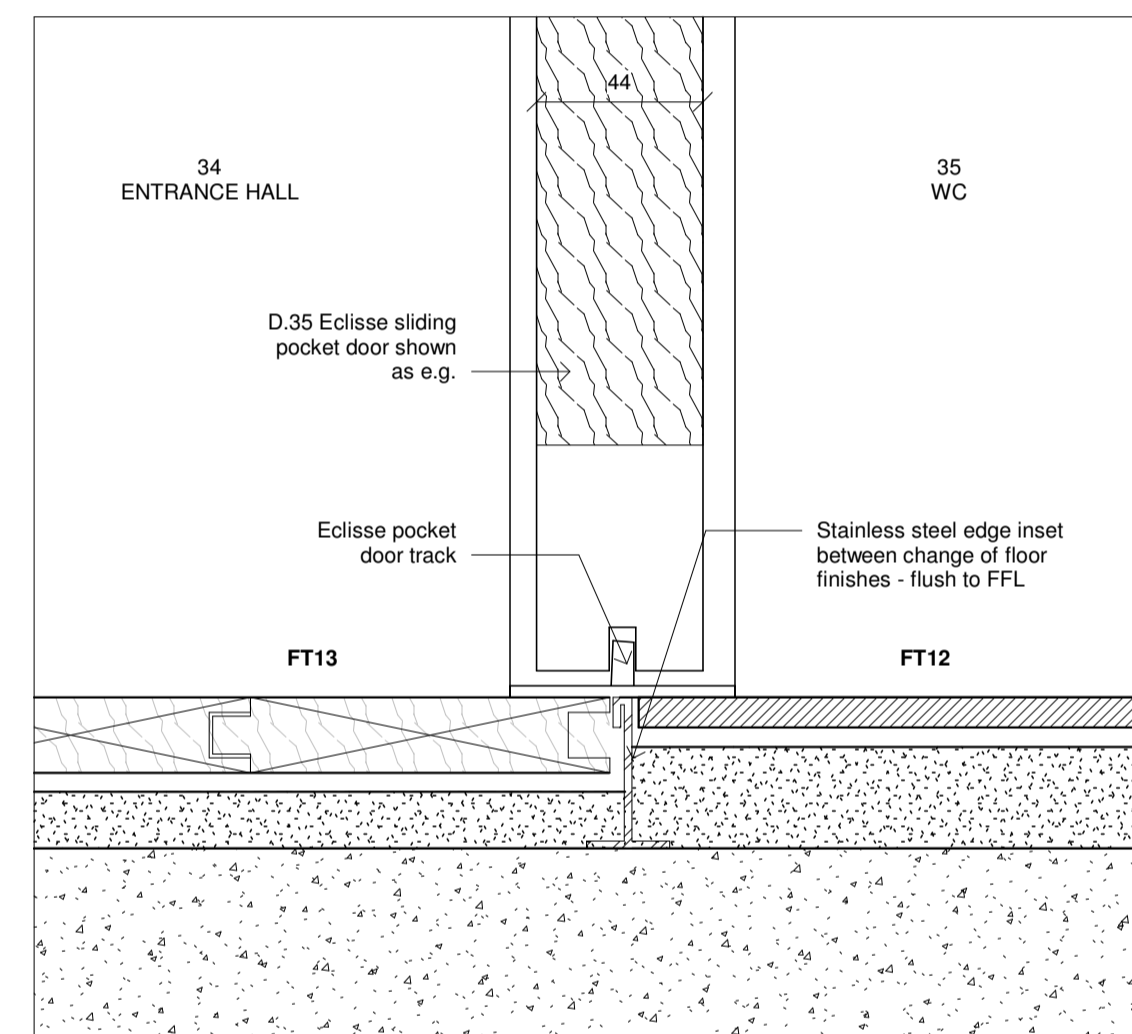

The Vicarage - Threshold Detail 02 - 2no. floor finishes  
1:2

Applies to:  
• Where two differing floor finishes abut  
• No firerating required

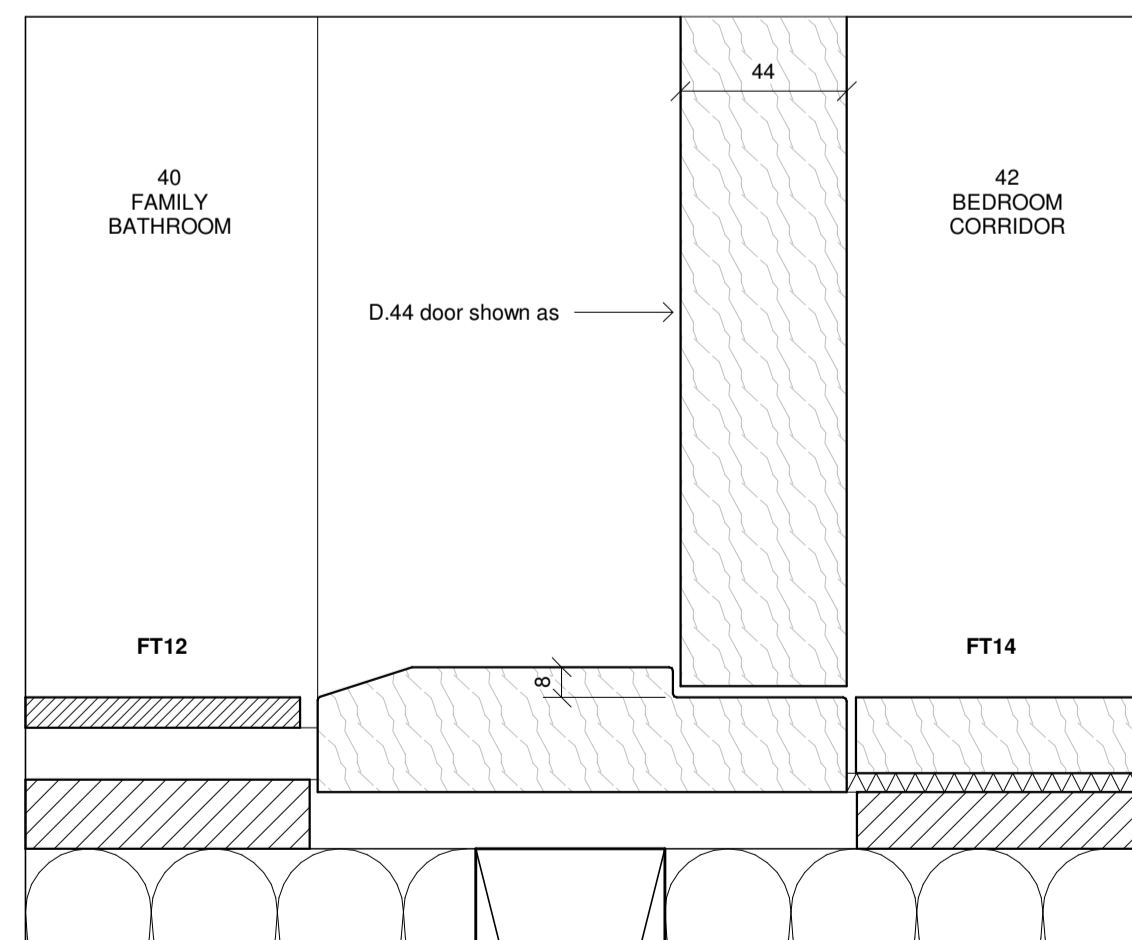

The Vicarage - Threshold Detail 03  
1:2

Applies to:  
• New doors to First Floor bedroom corridor and bathrooms  
• No firerating required

GENERAL NOTES  
DO NOT SCALE OFF THIS DRAWING.  
ALL DIMENSIONS MUST BE CHECKED ON SITE INFORM THE ARCHITECT OF ANY DISCREPANCIES PRIOR TO CONSTRUCTION.  
THIS DRAWING IS COPYRIGHT & MAY NOT BE OTHERWISE USED OR COPIED.  
READ IN CONJUNCTION WITH M.E.P. S.E. AND CIVIL ENGINEER'S DRAWINGS.  
CDM REGULATIONS 2015  
ALL CURRENT DRAWINGS AND SPECIFICATIONS FOR THE PROJECT MUST BE READ IN CONJUNCTION WITH THE DESIGNER'S HAZARD AND ENVIRONMENTAL ASSESSMENT RECORD

**Notes**

- S/O = Structural Opening  
C/O = Clear Opening
- Please read in conjunction with:
- Proposed Door Schedule 85331-CFM-31-SCH-900
  - GA plan drawings
  - Ironmongery Schedule 85331-CFM-41-SCH-901
  - Internal Door Types Drawings

**Building Key**

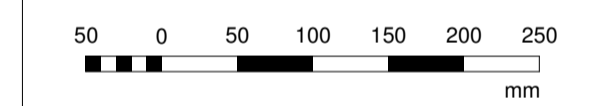
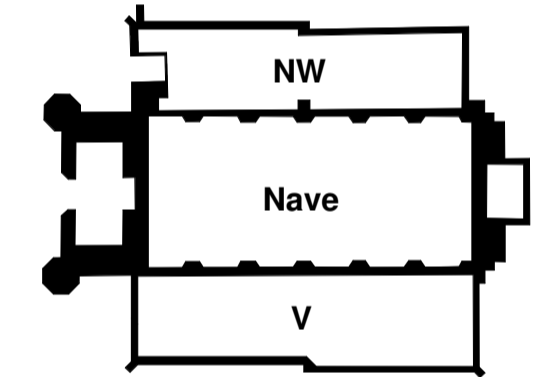

Client

The Danish Church  
4 St Katharine's Precinct  
London NW1 4HH

**C.F. Møller**

Telephone House, 69-77 Paul Street  
London, EC2A 4NW  
United Kingdom  
Tel.: +44 020 7427 1530  
london@cfmoller.com

Europaplads 2, 11  
8000 Aarhus C  
Denmark  
Tel.: +45 8730 5300  
www.cfmoller.com

Rev	Tender Issue Description	HBA	RN	By	Chk	Date
A						08/02/19

**The Danish Church**

**V - Typical Internal Door Details**

Project No.

85331

Status

**Stage 4 - TENDER**

Scale @ A1	Date	Revision
1:2	08/02/19	A

Drawing Number

85331-CFM-30-601