

North Wing
Typical Jamb Details

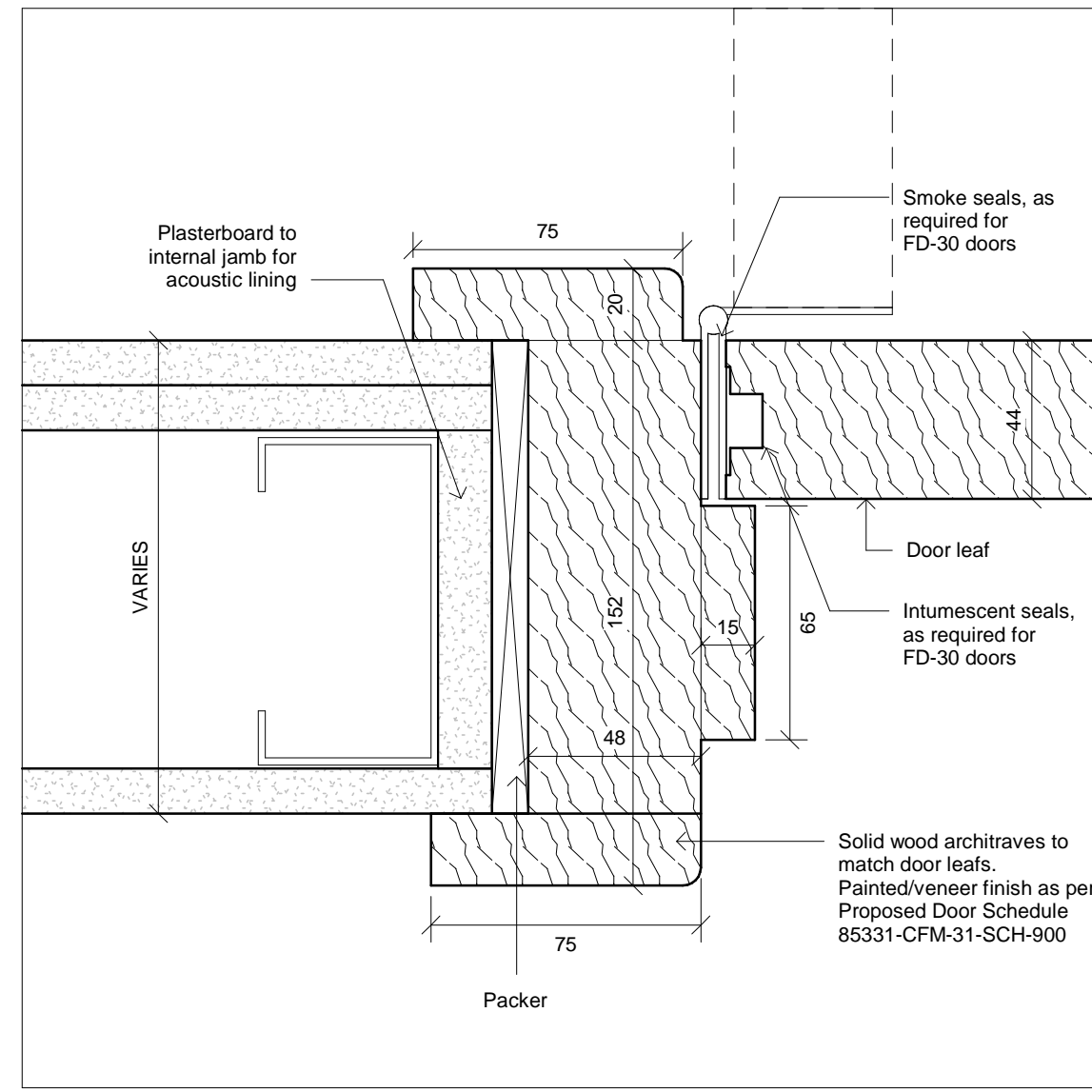

North Wing - Jamb Detail - Single-swing Doors
1:2

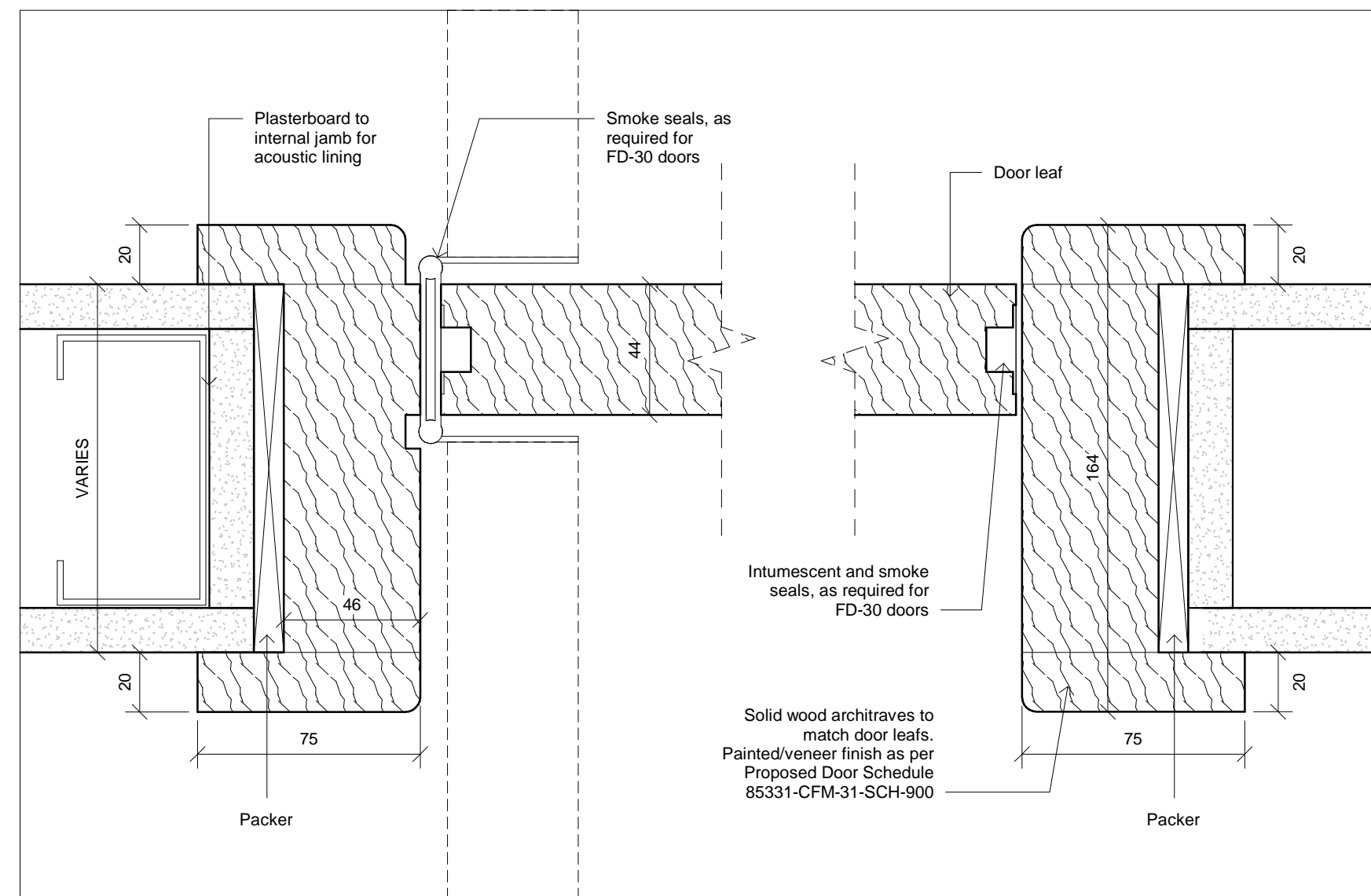

North Wing - Jamb Detail - Double-swing Doors
1:2

North Wing
Typical Head Detail

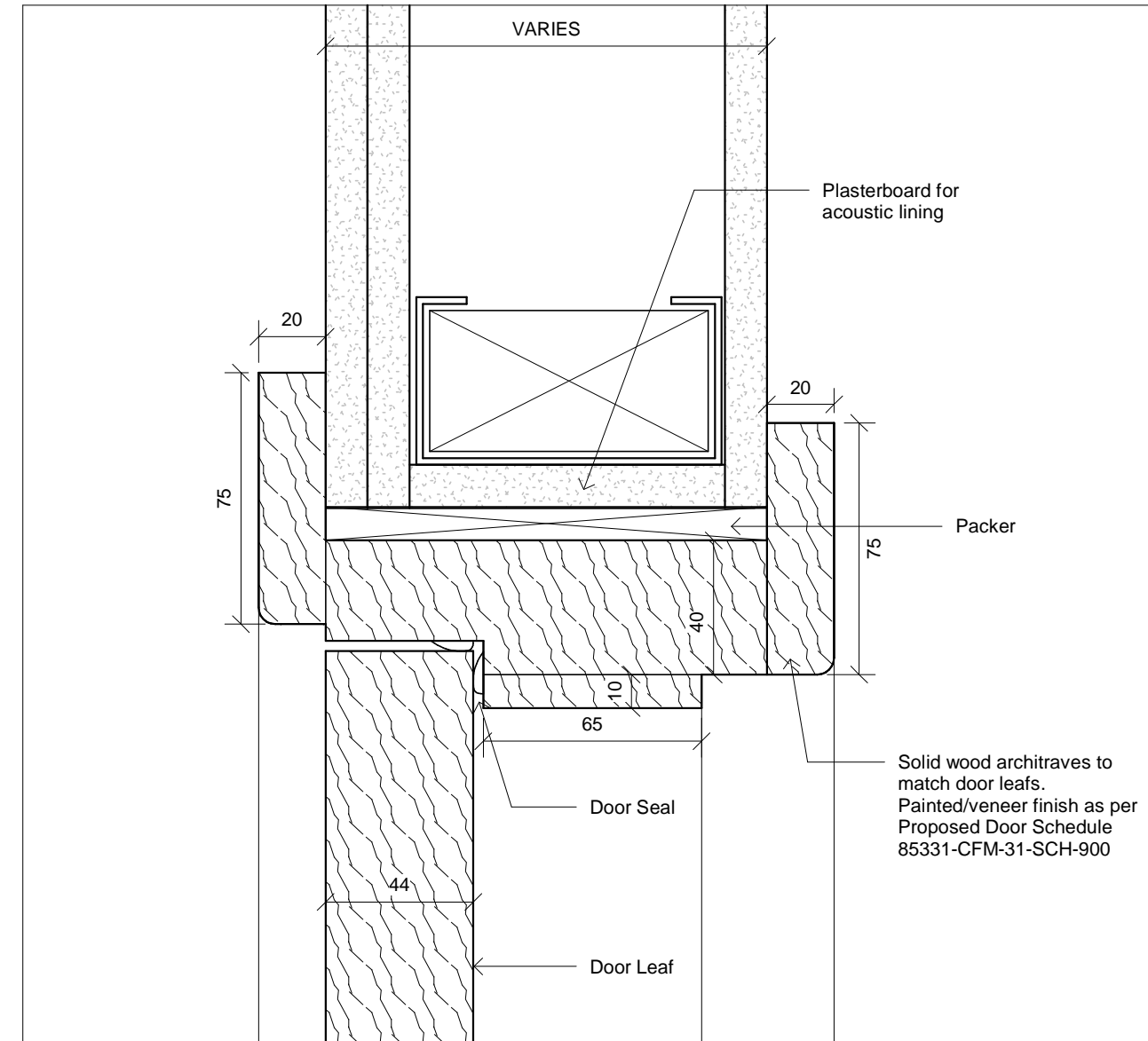

North Wing - Typical Head Detail
1:2

North Wing
Typical Threshold Details

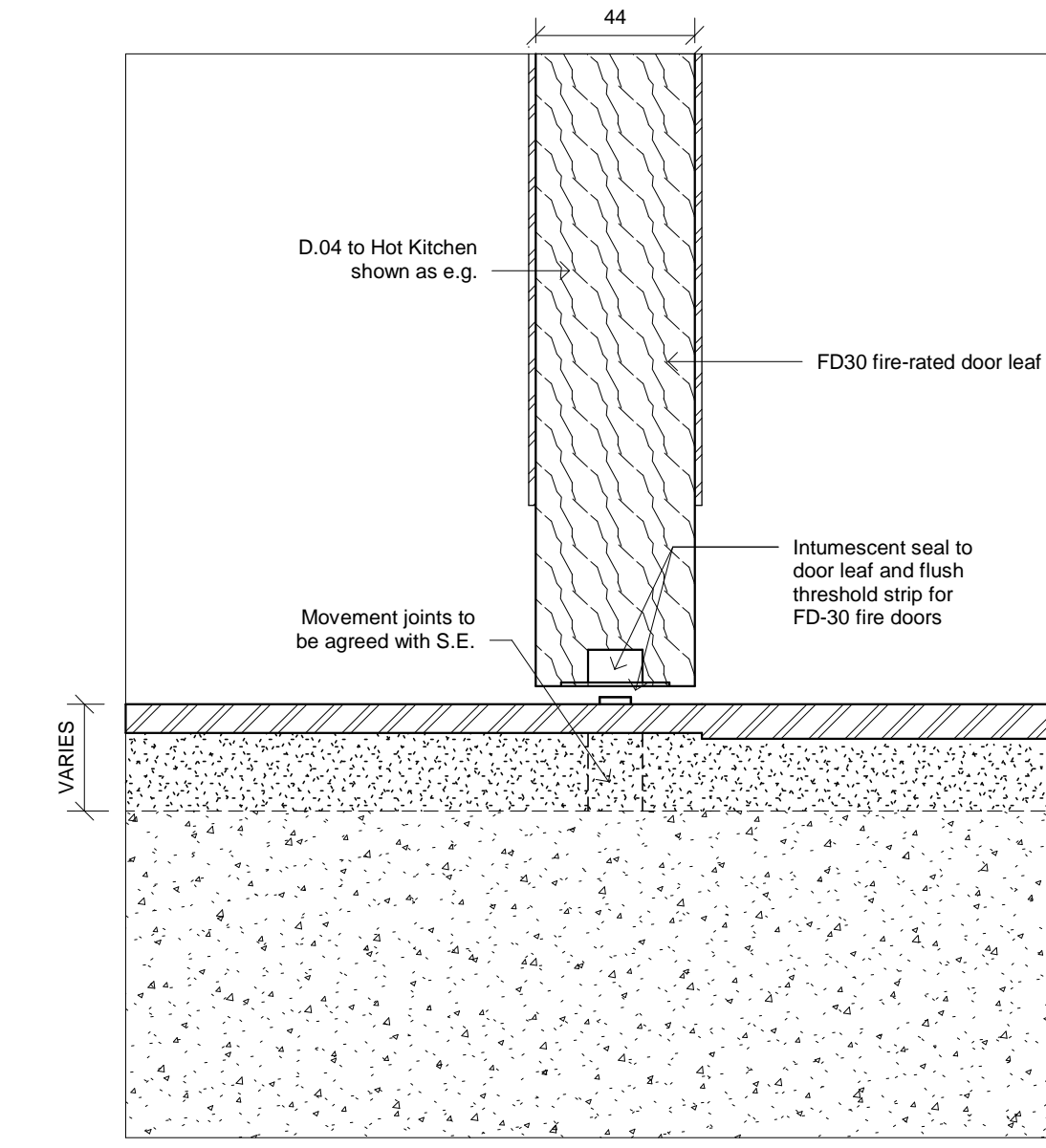

North Wing - Threshold Detail 01 - FD-30 Fire Doors
1:2

Applies to:
• All FD-30 rated doors to North Wing

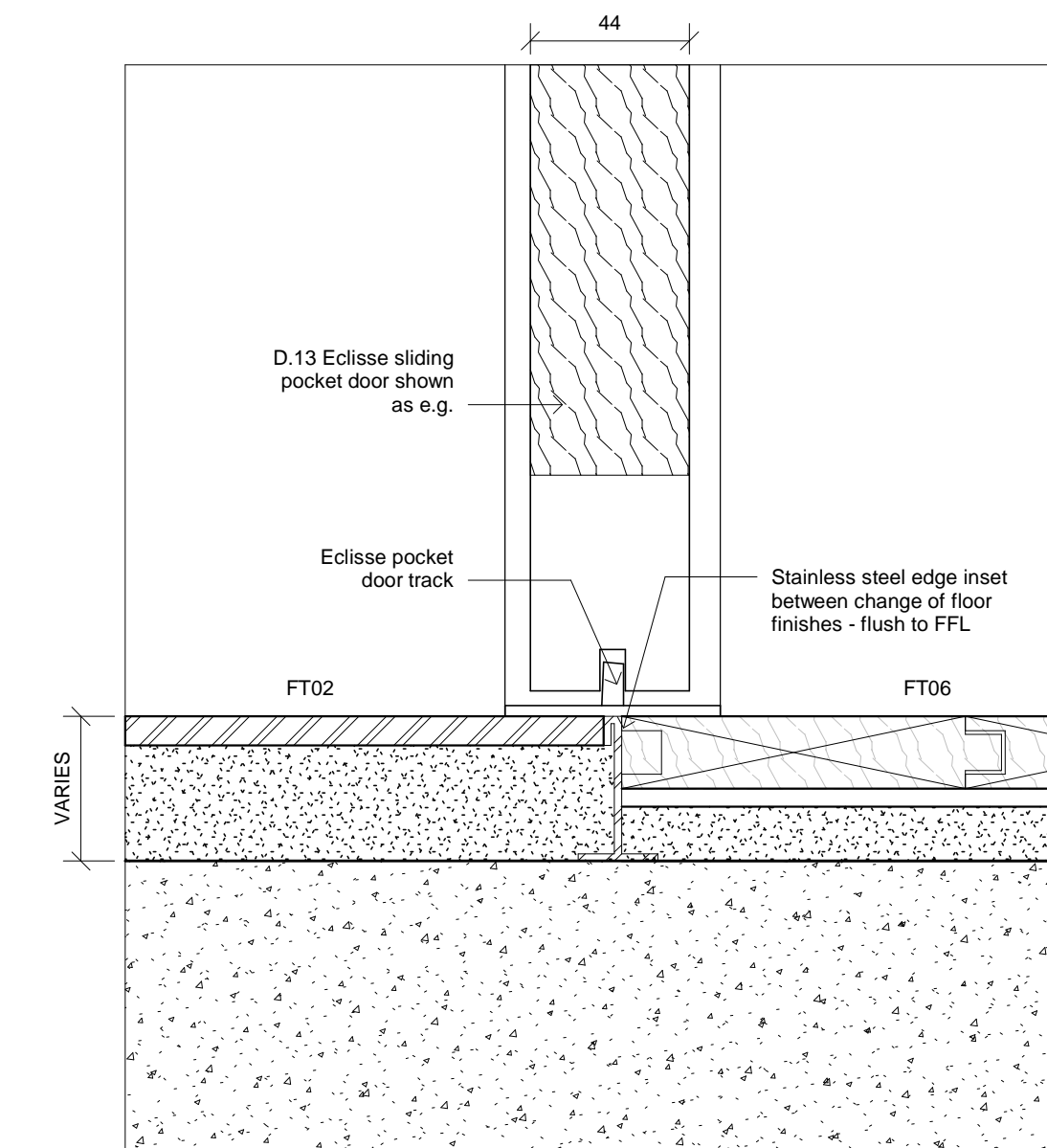

North Wing - Threshold Detail 02 - Edge Detail
1:2

Applies to:
• Where two differing floor finishes abut
• No firerating required

GENERAL NOTES
DO NOT SCALE OFF THIS DRAWING.
ALL DIMENSIONS MUST BE CHECKED ON SITE INFORM THE ARCHITECT OF ANY DISCREPANCIES PRIOR TO CONSTRUCTION.
THIS DRAWING IS COPYRIGHT & MAY NOT BE OTHERWISE USED OR COPIED.
READ IN CONJUNCTION WITH M.E.P. S.E. AND CIVIL ENGINEER'S DRAWINGS.
CDM REGULATIONS 2015
ALL CURRENT DRAWINGS AND SPECIFICATIONS FOR THE PROJECT MUST BE READ IN CONJUNCTION WITH THE DESIGNER'S HAZARD AND ENVIRONMENTAL ASSESSMENT RECORD

Notes

S/O = Structural Opening
C/O = Clear Opening

- Please read in conjunction with:
- Proposed Door Schedule 85331-CFM-31-SCH-900
 - GA plan drawings
 - Ironmongery Schedule 85331-CFM-41-SCH-901
 - Internal Door Types Drawings

Building Key

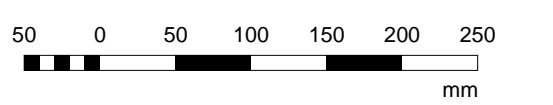
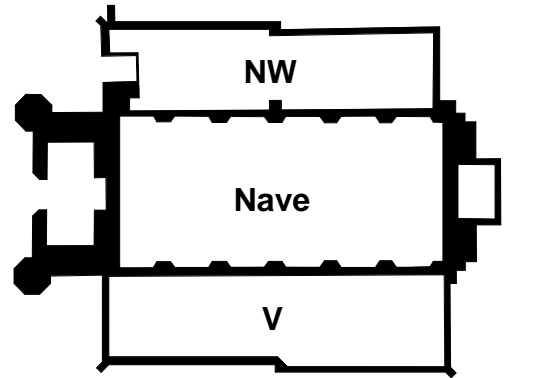

Client

The Danish Church
4 St Katharine's Precinct
London NW1 4HH

C.F. Møller

Telephone House, 69-77 Paul Street
London, EC2A 4NW
United Kingdom
Tel.: +44 020 7427 1530
london@cfmoller.com

Europaplads 2, 11
8000 Aarhus C
Denmark
Tel.: +45 8730 5300
www.cfmoller.com

Rev	Description	By	Chk	Date
A	Tender Issue	HBA	RN	08.02.19

The Danish Church

NW - Typical Internal Door Details

Project No.
85331

Status
Stage 4 - TENDER

Scale @ A1	Date	Revision
1 : 2	08/02/19	A

Drawing Number
85331-CFM-30-600