

Proposed Kitchen Section 1:20

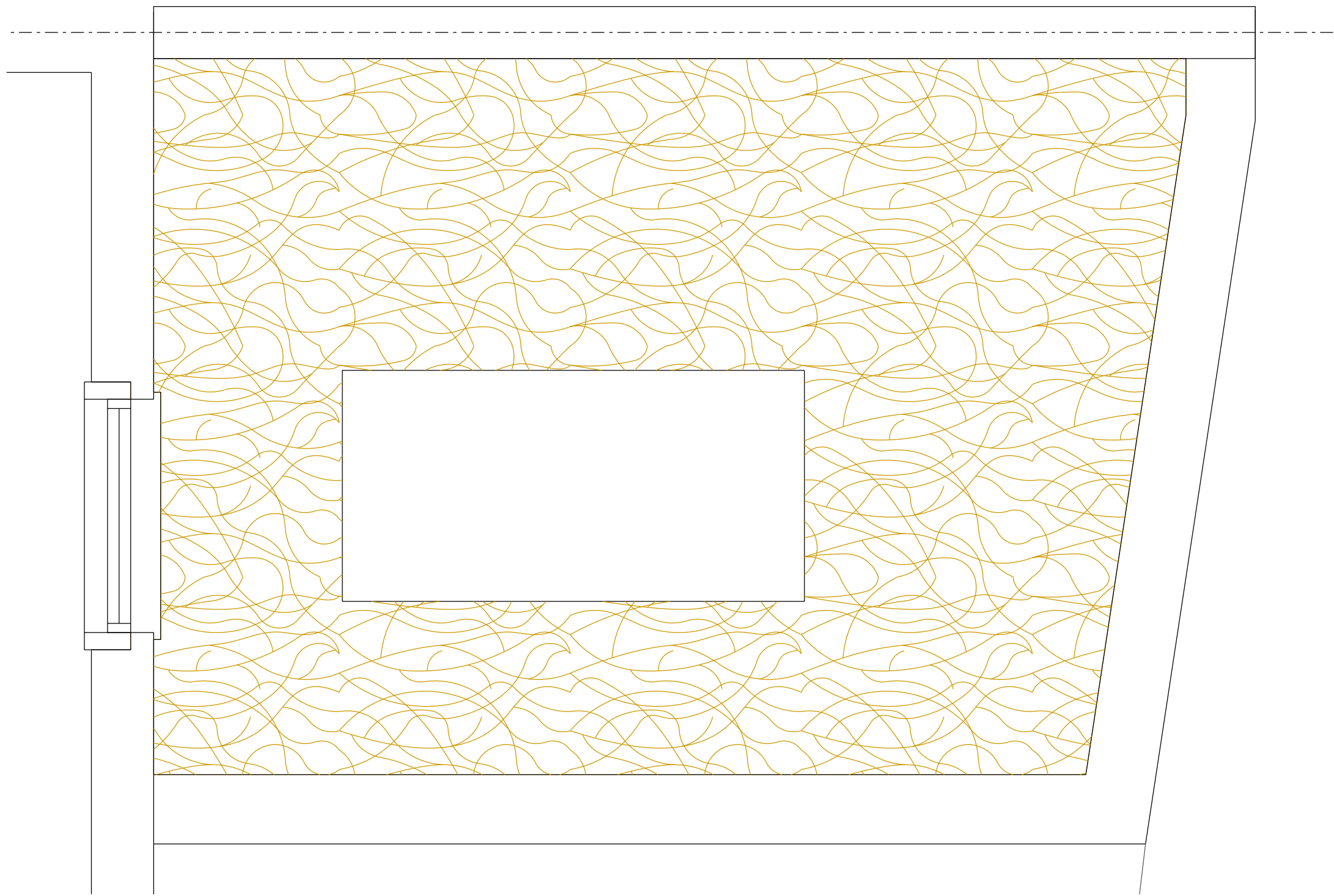

Proposed Roof Plan 1:20

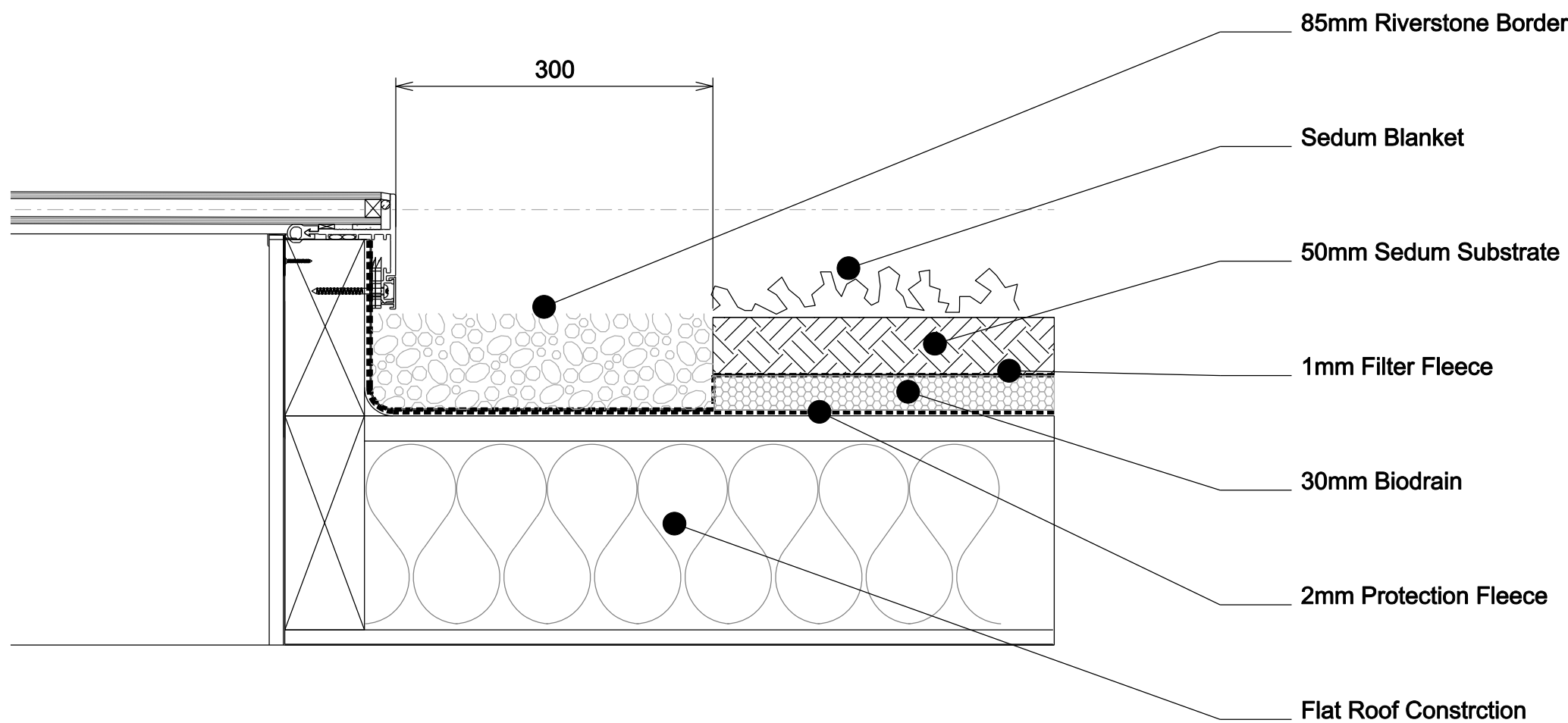

Detail A 1:5

Planning Condition No 4

Prior to commencement of the rear extension, full details in respect of the living roof in the area indicated on the approved roof plan shall be submitted to and approved by the local planning authority. The details shall include

- i. a detailed scheme of maintenance
- ii. sections at a scale of 1:20 with manufacturers details demonstrating the construction and materials used
- iii. full details of planting species and density

The living roof shall be fully provided in accordance with the approved details prior to first occupation and thereafter retained and maintained in accordance with the approved scheme.

For full details of proposed detailed scheme of maintenance and details of planting species and density refer to manufacturers specification

To be read in conjunction with Approved Planning Drawings

pa d
Independent architectural services
52 Bailey Road Leigh on Sea Essex SS9 3PJ M:07790 069188

Project: 68 Highgate Road London NW5 1PA
Client: Duah & Watson
Drawing title: Proposed Single Storey Rear Extension

Scale 1: 20@A1 Drawn by PSA
Project number 18 301 Drawing number PC 04
Status: Planning Condition Approval

Planning Condition No 4 in relation to Application ref: 2018/5514/P

All dimensions must be checked on site and not scaled from this drawing.