

PLATE 1: EXCAVATION

ENVIRONMENTAL
SAMPLES:
- ES (0.4m, 1.0m,
1.40m)

TRIAL PIT 101 (TP101)

PID:
- 0.0 ppm (0.40 m bgl)
- 0.0 ppm (1.00 m bgl)
- 0.0 ppm (1.50 m bgl)



PHOTOGRAPHS &
SECTIONS

PROJECT:
CASTLEWOOD HOUSE

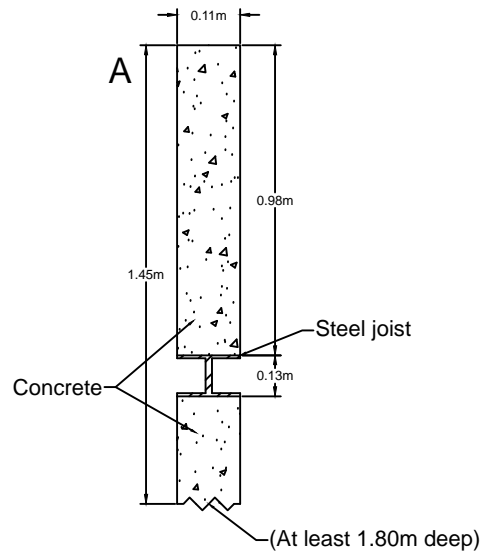
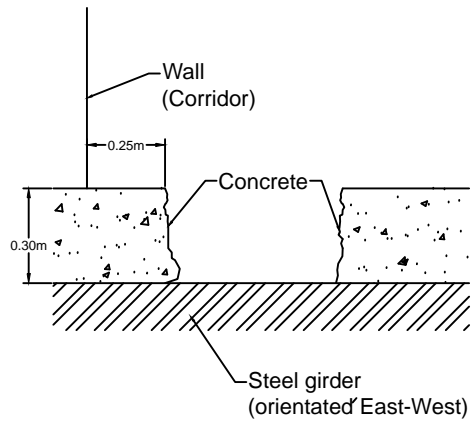
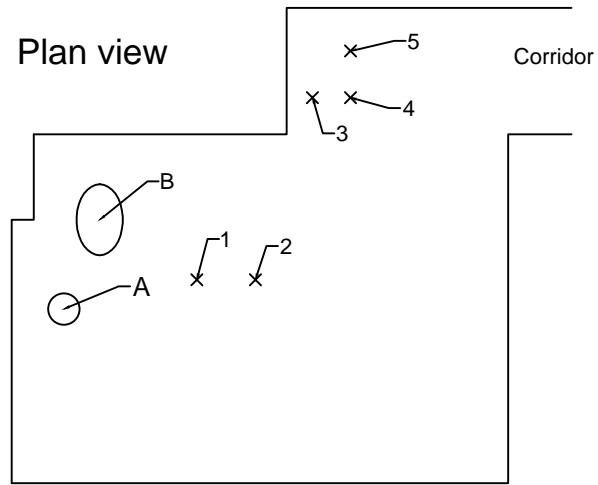

PLATE 1: EXCAVATION

ENVIRONMENTAL
SAMPLES:

TRIAL PIT 102 (TP102)



PHOTOGRAPHS &
SECTIONS

PROJECT:
CASTLEWOOD HOUSE

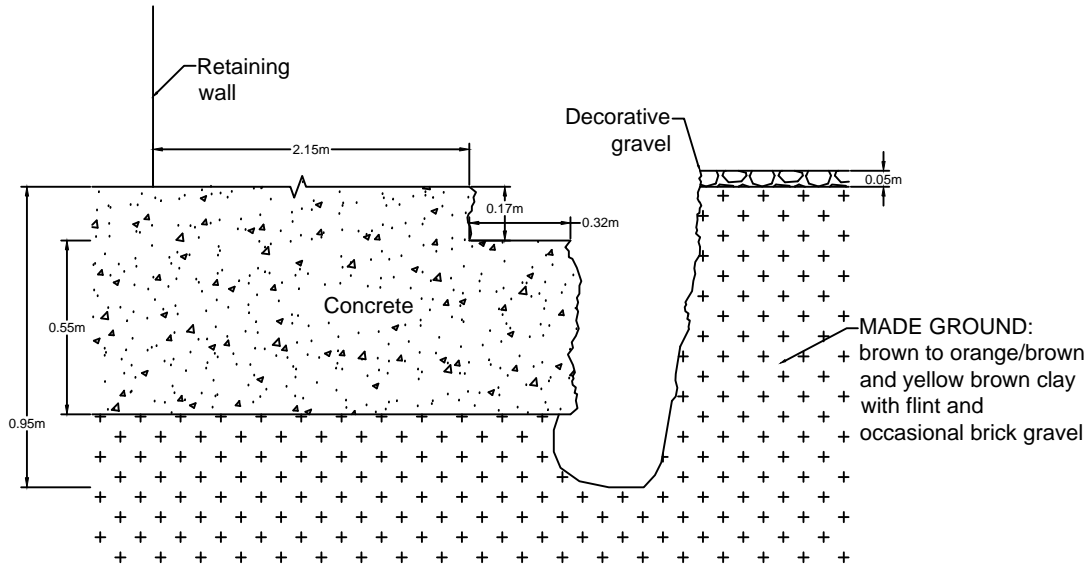

PLATE 1: EXCAVATION

ENVIRONMENTAL
SAMPLES:

-

PID:

- 0.0 ppm (0.50 m bgl)

TRIAL PIT 103 (TP103)



PHOTOGRAPHS &
SECTIONS

PROJECT:
CASTELWOOD HOUSE

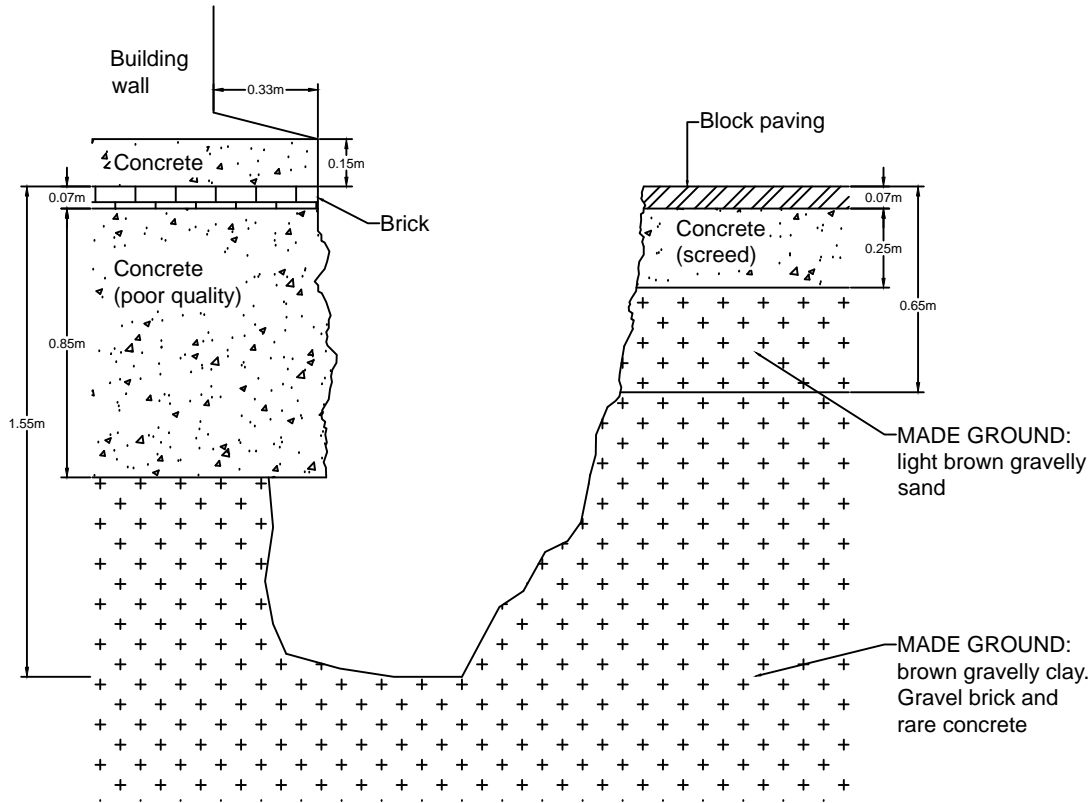

PLATE 1: EXCAVATION

ENVIRONMENTAL
SAMPLES:
- ES (0.5m, 1.0m)

TRIAL PIT 104 (TP104)

PID:
- 0.0 ppm (0.50 m bgl)
- 0.0 ppm (1.00 m bgl)



PHOTOGRAPHS &
SECTIONS

PROJECT:
CASTELWOOD HOUSE

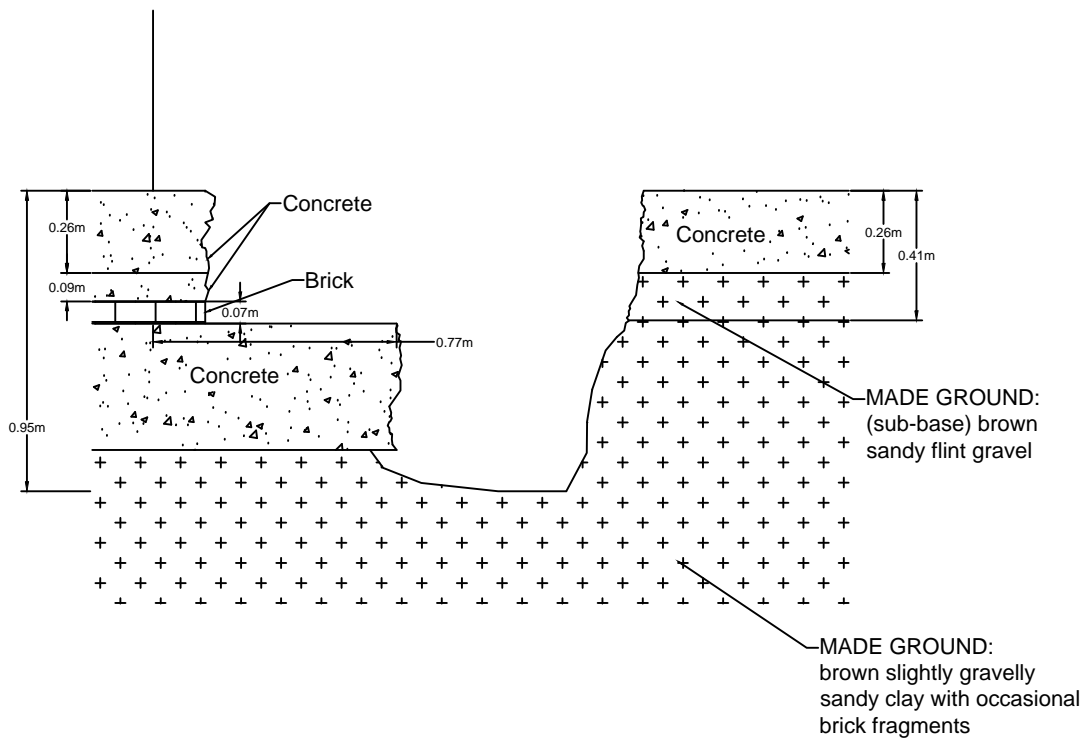

PLATE 1: EXCAVATION

ENVIRONMENTAL
SAMPLES:
- ES (0.4m)

TRIAL PIT 105 (TP105)

PID:
- 0.0 ppm (0.40 m bgl)
- 0.0 ppm (0.90 m bgl)



PHOTOGRAPHS &
SECTIONS

PROJECT:
MEDIUS HOUSE

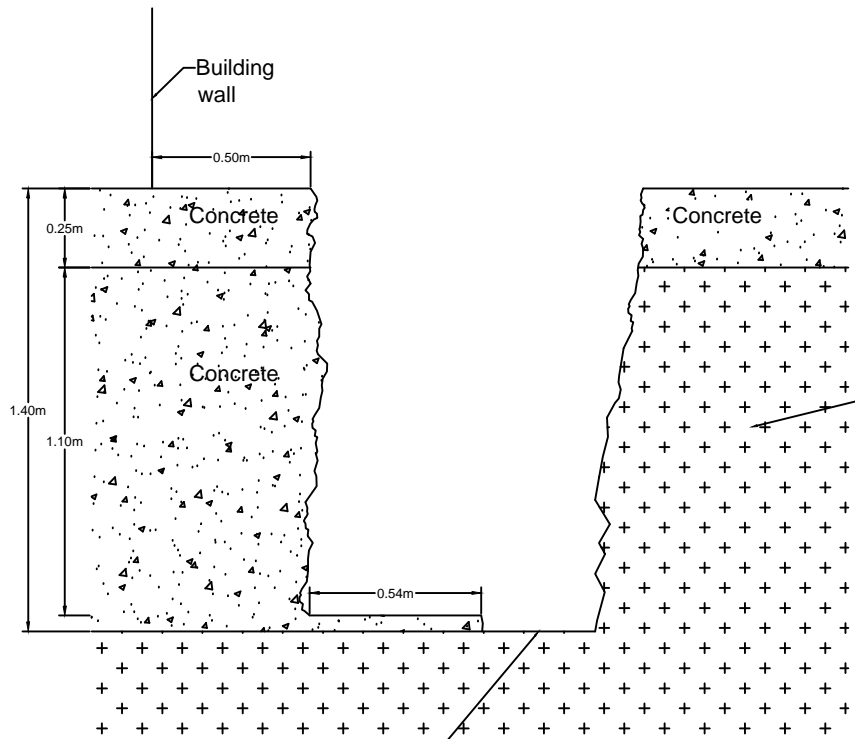

MADE GROUND:
gravelly clayey sand with
numerous brick and bricks
cobbles.

Note:
Unable to progress deeper
due to width of corridor.



PLATE 1: EXCAVATION

ENVIRONMENTAL
SAMPLES:
- ES (0.50 m bgl)

PID:
- 0.0 ppm (0.50 m bgl)
- 0.0 ppm (1.00 m bgl)

TRIAL PIT 106 (TP106)



PHOTOGRAPHS & SECTIONS

PROJECT:
MEDIUS HOUSE

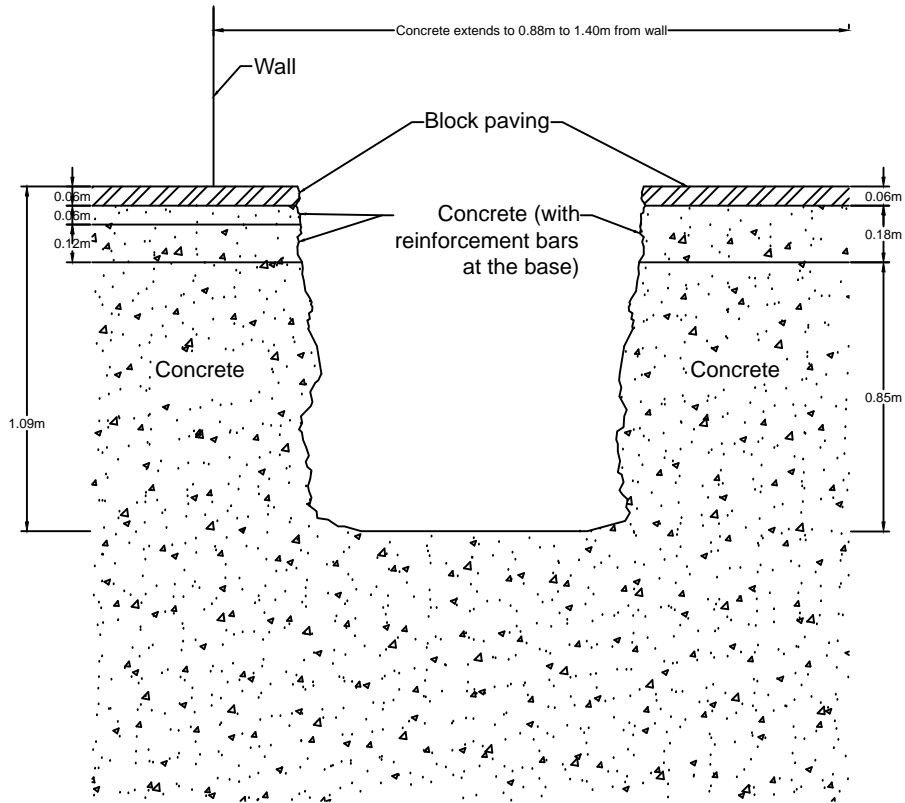

PLATE 1: EXCAVATION

ENVIRONMENTAL
SAMPLES:
- ES (0.4 m bgl)

PID:
- 0.0 ppm (0.40 m bgl)

TRIAL PIT 107 (TP107)



PHOTOGRAPHS &
SECTIONS

PROJECT:
CASTELWOOD HOUSE

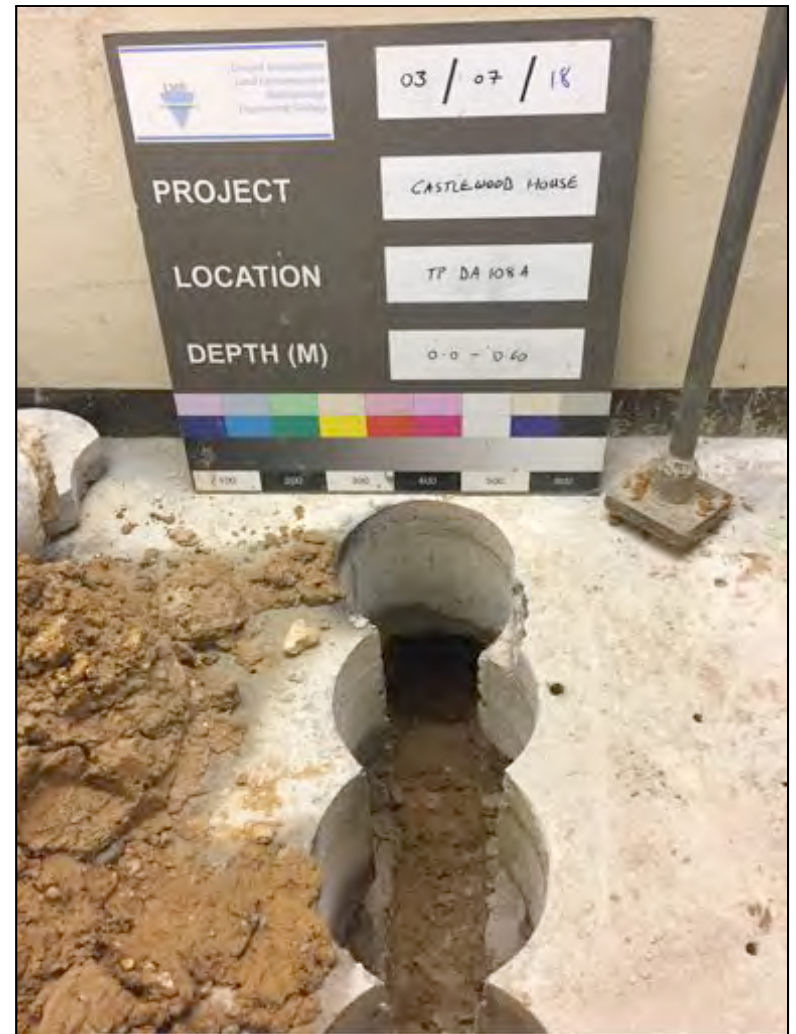
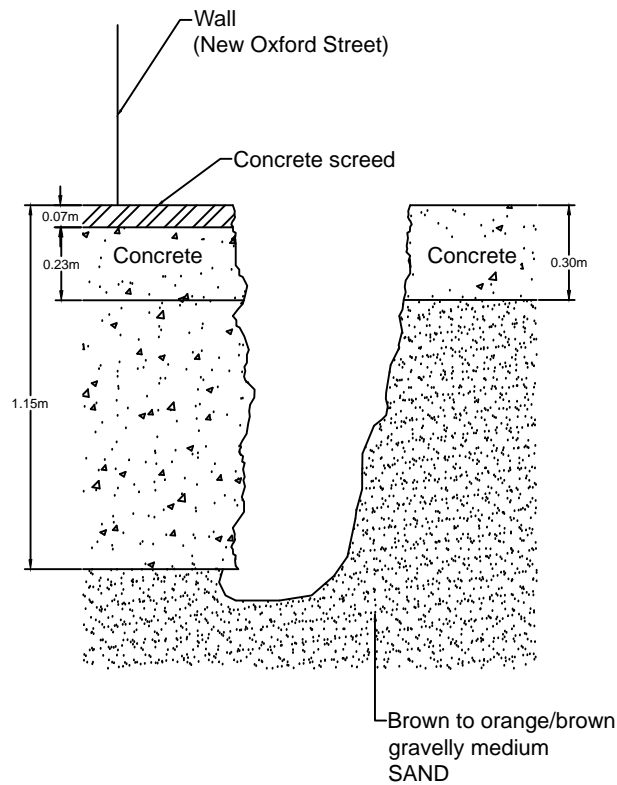
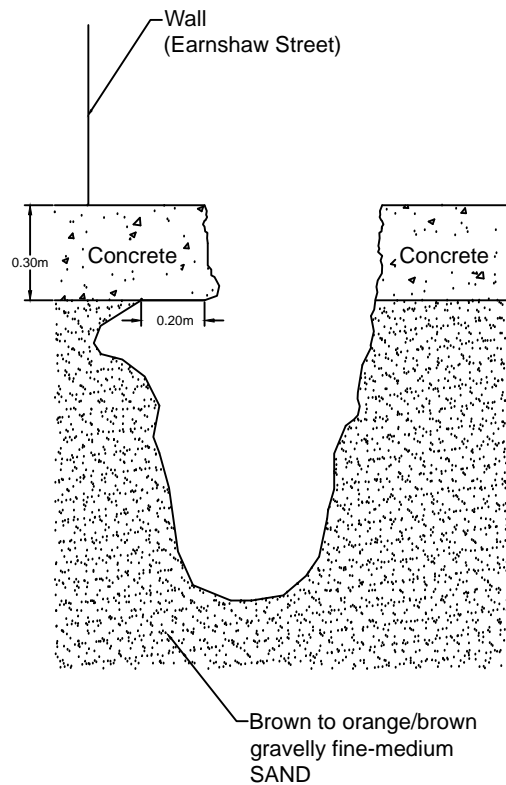

PLATE 1: EXCAVATION

ENVIRONMENTAL
SAMPLES:

-

TRIAL PIT 108 (TP108)

PID:

- 0.0 ppm (0.50 m bgl)
- 0.0 ppm (1.10 m bgl)



PHOTOGRAPHS &
SECTIONS

PROJECT:
CASTLEWOOD HOUSE

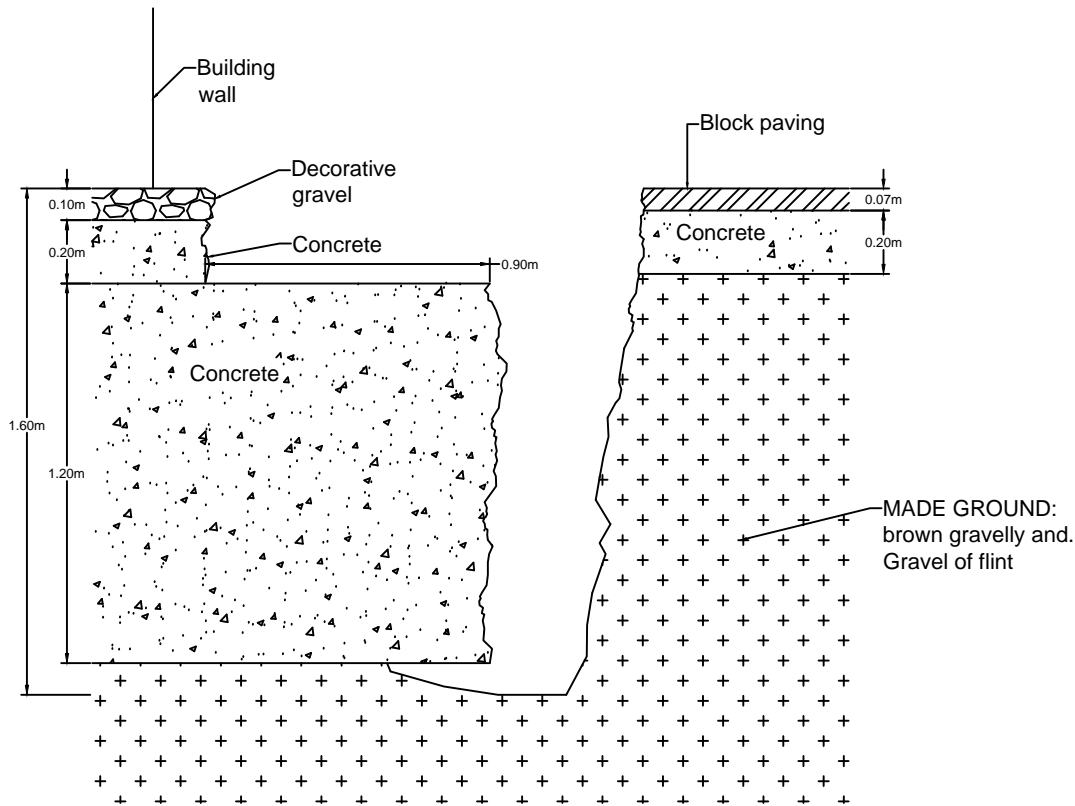

PLATE 1: EXCAVATION

ENVIRONMENTAL
SAMPLES:
- ES (0.6m)

TRIAL PIT 109 (TP109)

PID:
- 0.0 ppm (0.60 m bgl)
- 0.0 ppm (1.20 m bgl)



PHOTOGRAPHS &
SECTIONS

PROJECT:
CASTLEWOOD HOUSE

Note:
Estimated dimensions of
pad off column:
1.25m x 1.25m

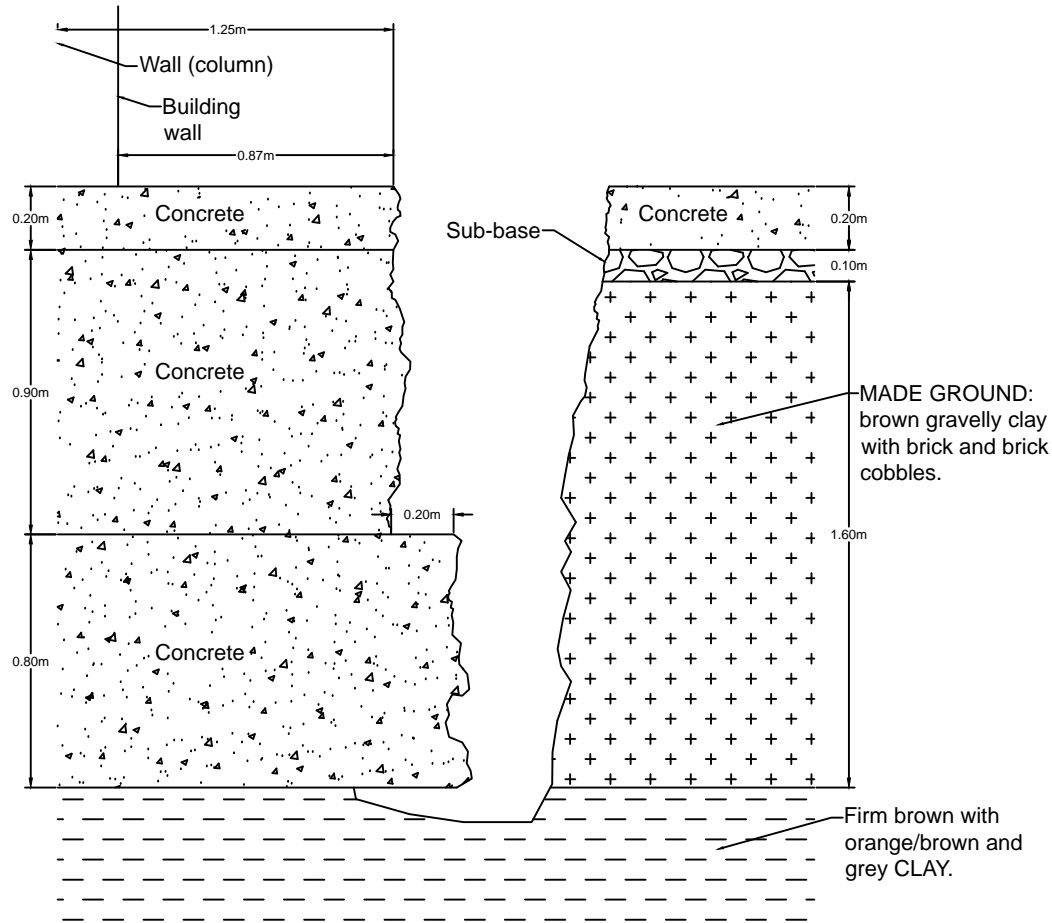

PLATE 1: EXCAVATION

ENVIRONMENTAL
SAMPLES:
- ES (0.50m, 1.90m)

TRIAL PIT 110 (TP110)

PID:
- 0.0 ppm (0.50 m bgl)
- 0.0 ppm (1.90 m bgl)



PHOTOGRAPHS & SECTIONS

PROJECT:
MEDIUS HOUSE