

PROPOSED GROUND FLOOR PLAN

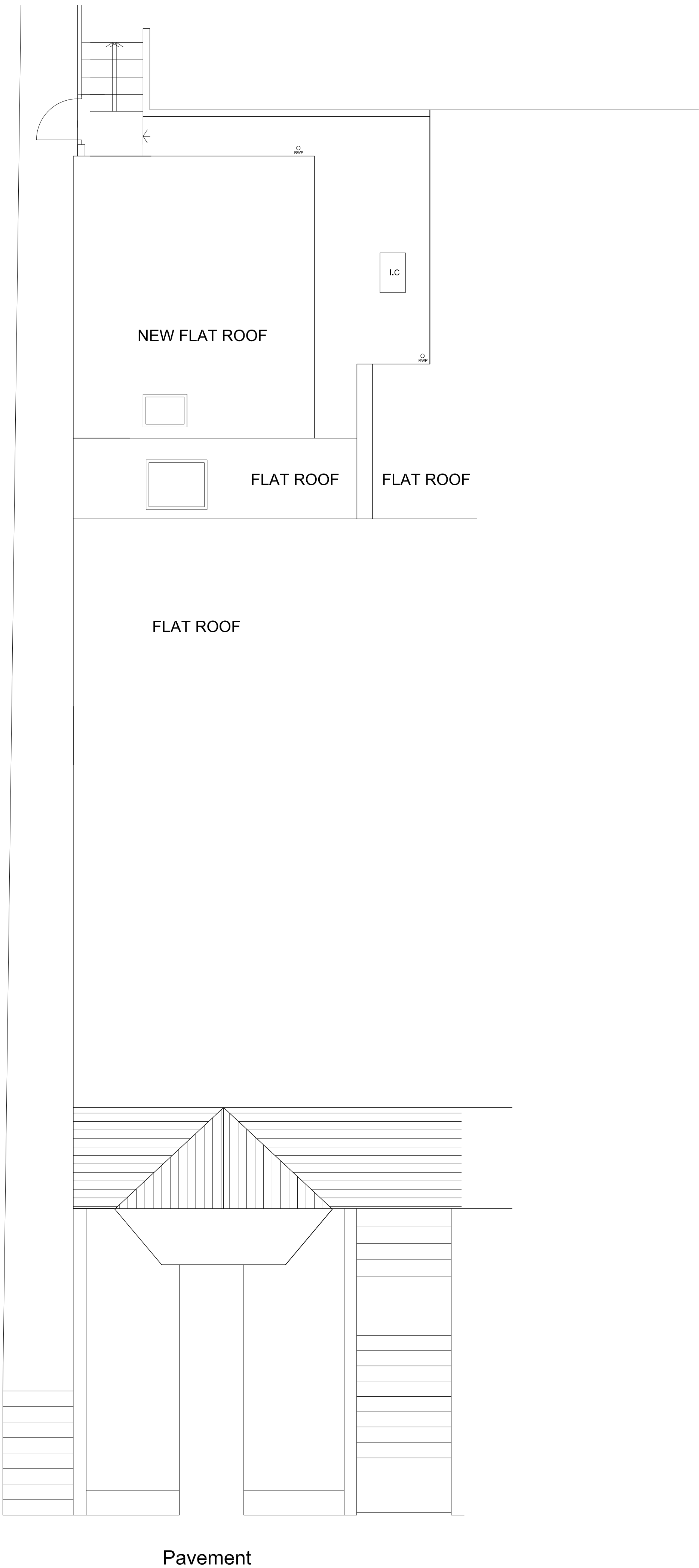

EXISTING ROOF PLAN

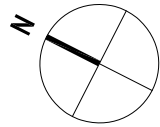
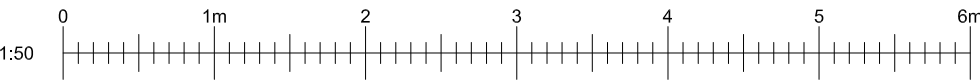

GENERAL

CONTRACTOR TO CHECK DIMENSIONS ON SITE BEFORE COMMENCEMENT OF WORK.

All materials and workmanship to be in accordance with current British Standards and Codes of Practice and comply fully with the Building Regulations.

All existing timbers to be inspected and replaced as necessary.

Electrical Services installations to be carried out in accordance with the Institute of Electrical Engineers specifications and British Standards.

Plumbing installations to be carried out in accordance with the Chartered Institute of Building Services Engineers.

All distributed surfaces to be made good prior to completion and handover of Contract.

leo|horsfield
SURVEYING

BUILDING SURVEYS - PARTY WALL MATTERS
ARCHITECTURE - BUILDING ENGINEERS



9 Clifton Hill - Brighton - East Sussex - BN1 3HQ
tel. : 01273 386 775 - fax : 01273 357 895
web : www.leohorsfieldsurveying.co.uk
mail : info@lhsurveying.co.uk

☒ PLANNING - NOT FOR CONSTRUCTION
☐ BUILDING CONTROL

Project address 226 FINCHLEY ROAD
LONDON
NW3 6DH
Client JOHN and SUSAN SPENCER
Title PROPOSED GROUND FLOOR PLAN
& ELEVATIONS
OPTION 1

Format A1 Scale 1:50
Date AUGUST 2009 Drawn RH
Drawing No. LH09-143-201 Rev E

Revision	Date	Drawn	Rev.No
Drawing updated as per clients comments.	13.10.09	RH	A
Roof plan added			
New roof revised	27.10.09	RH	B
Drawing updated	05.02.10	RH	C
Drawing updated	22.02.10	RH	D
Dimensions added	02.03.10	RH	E

DO NOT SCALE FROM THIS DRAWING
All dimensions to be verified on site.
This drawing has been produced for the specific client and project identified below and is not intended for use by any other person or for any other purpose.
This drawing is protected under The Copyright, Designs and Patents Act 1988.