



This Victorian house was built as a mid-terrace dwelling. It is arranged over four levels with six bedrooms, a living room, a dining room and a kitchen. The house is in a conservation area of the London Borough of Camden.

The house has gone through several changes in its history. Changes/ extensions to neighbouring structures have also been undertaken.

The main aim of this proposal is to improve natural light at ground level to the original 2 storey back extension, and to renovate and replace openings at ground, and first floor (also at rear of the house).

The improvement of light at ground floor level will be achieved through the installation of a new larger window to the side of the back extension, and an enlarged door opening onto the back garden. The side window will replace a door and two windows, improving natural light levels by approximately 25%, with a minimal increment in the overall opening area. These changes will take the ground floor original extension back to original natural light levels.

To be sympathetic to the architectural style of the original extension, the new door and window will be fabricated in steel (Crittall or similar), with a powder-coated grey finish. (final RAL number to be confirmed).

All the original bricks taken from the enlarged openings will be kept. These will replace any broken materials, and/or form the new soldier course lintel above the enlarged door and window, and side brickwork. Brickwork bonding (side of openings) will match existing in style. Pointing will also match the existing, both in style and colour.

In addition to these changes, the existing timber door at ground level and timber windows at first floor level will be replaced or overhauled, using original design and materials, and upgrading them to double-glazing in all openings (refer to proposed plans). The timber openings will be painted white as existing.

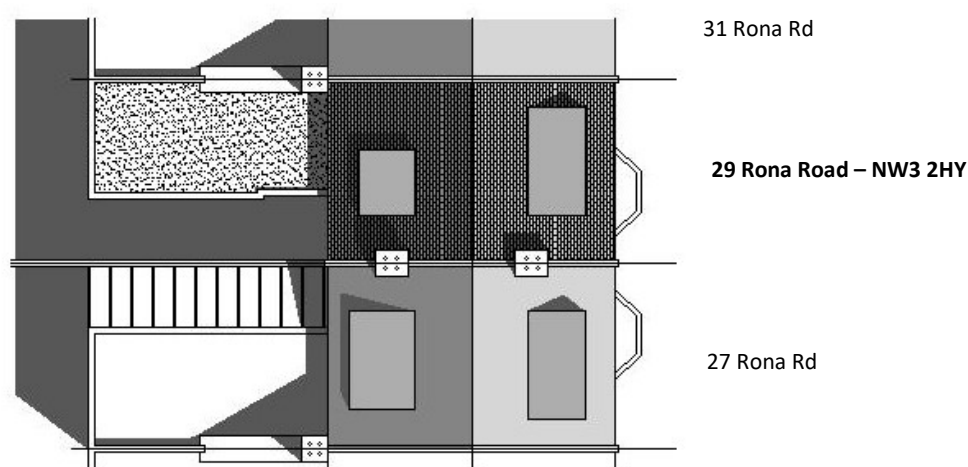

Existing Roof Plan of 29 Rona Rd. and adjacent properties



Proposed steel-frame, double-glazed door and window – Overall view



Proposed steel-frame, double-glazed window – Aerial view



Proposed steel-frame, double-glazed door – Rear garden view