

2 Vertical Section
Scale: 1:50

3 Vertical Section
Scale: 1:50

1 Horizontal Section
Scale: 1:50

| MATERIAL KEY LIST | | Issue: | 1-13 |
|------------------------------------|--|--------------|--------------------------|
| ALUMINIUM COMPONENTS | | | |
| 01 | ALUMINIUM PROFILE PPC RAL 7022 | Job: | 160070 |
| 02 | ALUMINIUM PROFILE BRONZE ANODISED | Issued for: | INFORMATION |
| 03 | ALUMINIUM SHEET/PROFILE NATURAL ANODISED | File: | KXC-T2-00-Y-FOC-21-EL451 |
| 04 | ALUMINIUM BRACKETS MILL FINISH | Scale: | 1:50 @ A3 |
| 05 | ALUMINIUM SHEET BRONZE ANODISED | Drawn by: | M. BIANCHI |
| 06 | PERFORATED ALUMINIUM SHEET BRONZE ANODISED | Date: | 29-08-2016 |
| 07 | ALUMINIUM SHEET PPC RAL 7022 | Rev: | 00 |
| 08 | ALUMINIUM BRACKETS BRONZE ANODISED | Rev: | 01 |
| 09 | ALUMINIUM BRACKET PPC RAL 7022 | Rev: | 01 |
| 10 | ALUMINIUM SHEET/PROFILE BLACK ANODISED | Rev: | 01 |
| GALVANIZED STEEL COMPONENTS | | | |
| 11 | HOT DIPPED GALVANIZED STEEL CAST-IN CHANNEL | Approved by: | L. CENNI |
| 12 | HOT DIPPED GALVANIZED STEEL BRACKET/REINFORCEMENT | Approved by: | L. CENNI |
| 13 | GALVANIZED STEEL SHEET RAL 7022 | Approved by: | L. CENNI |
| 14 | HOT DIPPED GALVANIZED AND PAINTED STEEL | Approved by: | L. CENNI |
| 15 | GALVANIZED STEEL SHEET | Approved by: | L. CENNI |
| 16 | HOT DIPPED GALVANIZED FIXING | Approved by: | L. CENNI |
| STAINLESS STEEL COMPONENTS | | | |
| 21 | STAINLESS STEEL BRACKET AISI 316 | Approved by: | L. CENNI |
| 22 | STAINLESS STEEL ROD AISI 316 | Approved by: | L. CENNI |
| 23 | STAINLESS STEEL | Approved by: | L. CENNI |
| 24 | STAINLESS STEEL BRACKET AISI 304 | Approved by: | L. CENNI |
| 25 | STAINLESS STEEL FIXING SCREW | Approved by: | L. CENNI |
| 26 | STAINLESS STEEL FIXING SCREW ACID ETCHED (BLACK) | Approved by: | L. CENNI |
| EPDM / SILICONE COMPONENTS | | | |
| 31 | BLACK EPDM GASKET | Approved by: | L. CENNI |
| 32 | BLACK SILICONE | Approved by: | L. CENNI |
| 33 | BLACK STRUCTURAL SILICONE | Approved by: | L. CENNI |
| 34 | BLACK EPDM MEMBRANE | Approved by: | L. CENNI |
| 35 | EPDM COMPATIBLE WITH STRUCTURAL SILICONE | Approved by: | L. CENNI |
| GLASS TYPES | | | |
| 41 | GL-1 DGU VISION GLASS CLADDING TYPE 1-2 (SEE GLASS TYPE SCHEDULE) | Approved by: | L. CENNI |
| 42 | GL-2 SGU SPANDREL GLASS CLADDING TYPE 1 (SEE GLASS TYPE SCHEDULE) | Approved by: | L. CENNI |
| 44 | GL-4 DGU SPANDREL GLASS CLADDING TYPE 2 (SEE GLASS TYPE SCHEDULE) | Approved by: | L. CENNI |
| 45 | GL-5 SGU BALUSTRADE GLASS CLADDING TYPE 1-2 (SEE GLASS TYPE SCHEDULE) | Approved by: | L. CENNI |
| 46 | GL-6 DGU VISION GLASS CLADDING TYPE 4A-4B-4C (SEE GLASS TYPE SCHEDULE) | Approved by: | L. CENNI |
| 50 | GL-10 DGU VISION GLASS CLADDING TYPE 7 (SEE GLASS TYPE SCHEDULE) | Approved by: | L. CENNI |
| 52 | GL-10A DGU VISION GLASS CLADDING TYPE 7 (SEE GLASS TYPE SCHEDULE) | Approved by: | L. CENNI |
| VARIOUS MATERIAL | | | |
| 61 | MINERAL WOOL | Approved by: | L. CENNI |
| 62 | FIRE AND AIR SEAL BARRIER | Approved by: | L. CENNI |
| 64 | PLASTIC SHIM / THERMAL BREAK | Approved by: | L. CENNI |
| 65 | ALU FIXINGS | Approved by: | L. CENNI |
| 71 | ELECTRIC CHAIN ACTUATOR | Approved by: | L. CENNI |
| 81 | INSECT MESH | Approved by: | L. CENNI |
| 98 | INTERNAL CEILING AND FINISH FLOOR BY OTHERS | Approved by: | L. CENNI |
| 99 | VARIOUS BY OTHERS | Approved by: | L. CENNI |

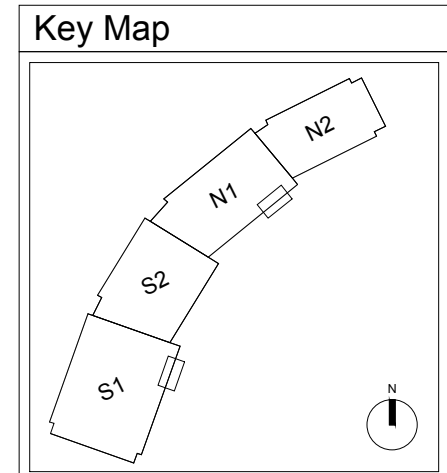

Title: **TYPICAL ELEVATION**
TYPE 4B

Project: King's Cross - T2/T3
London

Architect: Bennetts Associates

Client: BAMC

Package: FOCCHI

Issue: 1-13
Job: 160070
Issued for: INFORMATION
Scale: 1:50 @ A3
Drawn by: M. BIANCHI
Date: 29-08-2016
Rev: 00
Rev: 01
Rev: 01

File: KXC-T2-00-Y-FOC-21-EL451
Scale: 1:50 @ A3
Drawn by: M. BIANCHI
Date: 29-08-2016
Rev: 00
Rev: 01
Rev: 01

Rev: 01

EL451

FOCCHI