

INCOMING MCWS AND SITE HEATING MAINS. SEE DRG. No. 2777-RW-SCH-010

CO-ORDINATION REQUIRED WITH 'BETTER HOMES' PROJECT

REPLACEMENT HIT & MISS GRILLE TO MAINTAIN TRICKLE VENTILATION

FUTURE RADIATOR CIRCUIT & SITE HTG MAINS AT L/L BENEATH CABINETS

PIPEWORK BOXED IN SEE DETAIL TYPE 3 ON DRG. No. 2777-RW-M-100

PIPES DROP FROM KITCHEN TO LIVING ROOM. BOXED IN VERTICALLY. CORE DRILL HOLES AND SLEEVE PIPES

150 HWS, 220 SITE HEATING MAINS AND 150 FUTURE RADIATOR CIRCUIT INSTALLED INSIDE EXISTING DUCT. (ALLOW FOR REMOVAL OF LID AND REINSTATEMENT)

FUTURE RADIATOR CIRCUIT AT L/L BOXED IN

DO NOT SCALE

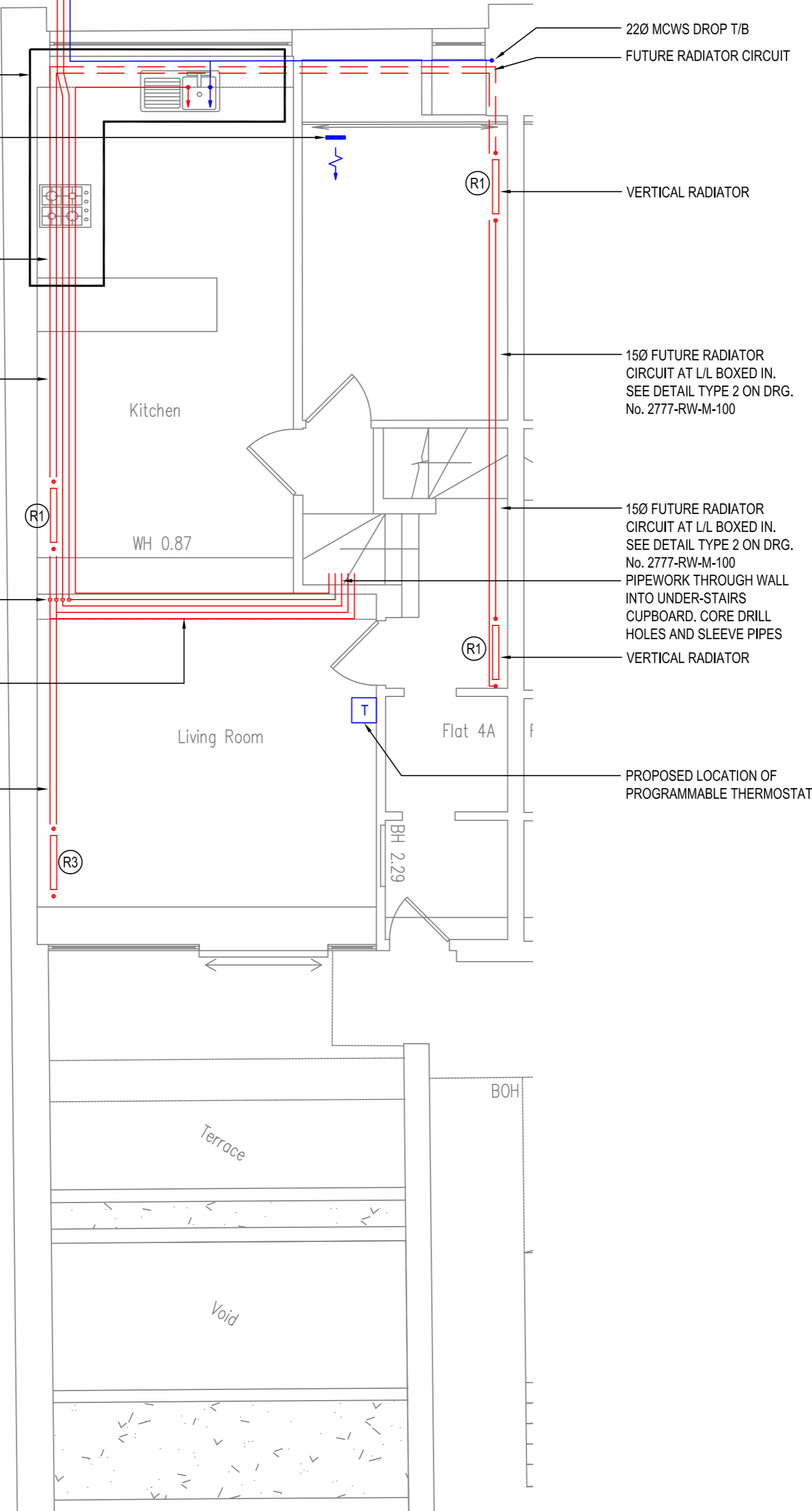

- NOTES:
1. THIS DRAWING IS TO BE READ IN CONJUNCTION WITH ALL OTHER DISCIPLINES, DRAWINGS, SCHEDULES AND SPECIFICATIONS, LEGENDS AND STANDARD DETAILS.
 2. THIS DRAWING IS COPYRIGHT AND SHALL NOT BE REPRODUCED WITHOUT PERMISSION.
 3. STATED DIMENSIONS TAKE PRECEDENCE ON ALL DRAWINGS AND DETAILS.
 4. UNLESS OTHERWISE STATED ALL DIMENSIONS ARE IN MILLIMETERS.
 5. DO NOT SCALE FROM THIS DRAWING.
 6. DIMENSIONS TO BE CHECKED ON SITE BEFORE ANY WORK IS PUT IN HAND OR PREFABRICATED.
 7. THIS DRAWING SHOULD BE USED FOR SPECIFIC SERVICES INTENDED.
 8. THIS DRAWING SHOWS THE DESIGN INTENT ONLY. THE CONTRACTOR SHALL BE RESPONSIBLE FOR THE FULL CO-ORDINATION OF THE SERVICES INDICATED ON THIS AND ALL OTHER SERVICES DRAWINGS.
 9. FINAL ACCESS AND SETTING OUT OF SERVICES SHALL BE SHOWN BY THE CONTRACTOR ON THEIR WORKING / INSTALLATION DRAWINGS.
 10. THE PROJECT NOTES ARE TO BE READ IN CONJUNCTION WITH ALL RELEVANT TECHNICAL SPECIFICATIONS.
 11. WHERE SERVICES PASS THROUGH FIRE COMPARTMENTATION CEILING VOIDS, FLOOR VOIDS AND STRUCTURAL WALLS THE CONTRACTOR SHALL SLEEVE / SEAL THE OPENING WITH AN ACOUSTIC AND FIRE SEALANT APPROVED BY THE ARCHITECT.
 12. THE CONTRACTOR SHALL REFER TO ARCHITECT'S DRAWING FOR DETAILS OF FIRE COMPARTMENTATION.
 13. INSTALLING CONTRACTOR TO ISSUE TECHNICAL SUBMISSIONS TO DESIGN TEAM FOR COMMENT PRIOR TO ORDERING OF EQUIPMENT.
 14. ADEQUATE MEASURES FOR VENTING AND DRAINING PIPEWORK SERVICES SHALL BE INCORPORATED WITHIN THE INSTALLATION. THESE DETAILS MAY NOT BE ABLE TO BE SHOWN CLEARLY ON DESIGN DRAWINGS.
 15. THERMAL INSULATION SHALL BE PROVIDED TO ALL SERVICES AS DETAILED IN SPECIFICATION.
 16. ANY QUERIES BETWEEN DRAWINGS AND SPECIFICATION SHALL BE CLARIFIED BY THE CONTRACTOR.
 17. ALL DWS SHALL BE WRAS COMPLIANT.
 18. ALL DUCTWORK SHALL BE INSTALLED TO DW144 & DW143.
 19. ALL MANUFACTURERS FINAL CONNECTION AND HANDING DETAILS TO BE CHECKED.



ARGYLE STREET
LONDON
WC1H 8NJ



Mechanical and Electrical Consulting Engineers
1st Floor, 54-62 Station Road East, Oxted, Surrey RH8 0PG
Telephone 01883 717172 Fax 01883 717174
Website www.bya.co.uk Email enquiries@bya.co.uk

Project
ALEXANDRA ROAD ESTATE
(ROWLEY WAY)

Drawing Title
MECHANICAL SERVICES
UNIT TYPE A3
GROUND FLOOR
PROPOSED LAYOUT

Scales 1:50	Xref: 2	Drwg Sheet A2
Drawn NS	Checked JS	Date FEB 18
BYA Ref: 2777	BYA Cat Ref: 2777-RW-A3-101	Drawing Number: 2777-RW-A3-101

PLANNING DRAWING