



Landmark Trees

Our ref: MAA/9GG/AIA/ADD/01

Charlotte Meynell
Planning Officer
Regeneration and Planning
Supporting Communities
London Borough of Camden

By email: Charlotte.Meynell@camden.gov.uk

7th February 2019

Dear Charlotte,

Re: Addendum to Arboricultural Report MAA/9GG/AIA/01a

I write following the excavation of a trial pit at 9 Grange Gardens, London NW3 7XG as part of a planning application 2017/2445/P, as recommended within our initial report on the potential impacts of the development on trees on and adjacent to the site.

The trial pit was excavated in the position detailed in Extracts 1 and 2 below, to a depth of some 800mm. I visited the site on the 29th January 2019 in order to inspect the trench and can confirm no roots from the adjacent high quality oaks T1 and T6 were present (see Photograph 1) and it is worthy of note that the wall foundations extended below the bottom of the trench. Photograph 2 shows a root from an adjacent Viburnum shrub that has grown towards the wall, found it to be an impenetrable barrier and adjusted its course accordingly. Oak roots possess no especial faculty for breaking through obstructions and thus I do not think it unreasonable to conclude that if a trial trench were excavated the far side of the wall that similarly deflected oak roots would be found.

Web: www.landmarktrees.co.uk
e-mail: info@landmarktrees.co.uk
Tel: 0207 851 4544



London Office: Holden House, 4th Floor, 57 Rathbone Place London W1T 1JU

Registered Office: 15 Abbey Road, Oxford OX2 0AD

Landmark Trees is the trading name of Landmark trees Ltd. Registered in Wales. Reg No. 3882076



Institute of Chartered Foresters
Registered Consultant

I therefore conclude that, as per the enclosed updated Arboricultural Impact Plan, the proposals will have no impact on T1 or T6.

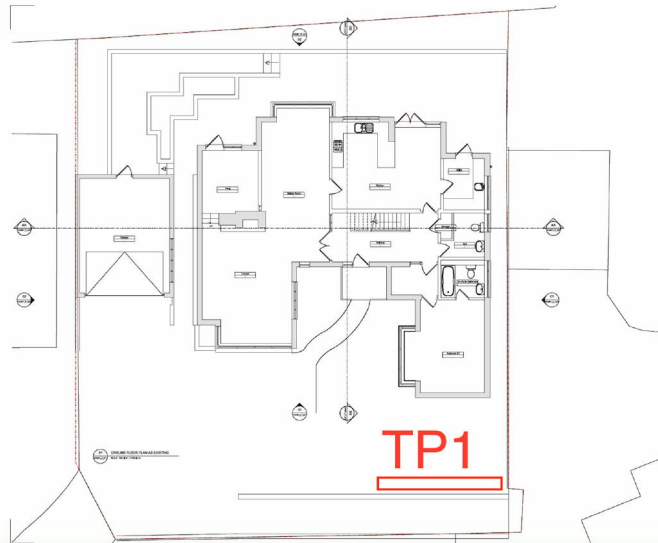

Extract 1: Location of trial pit on plan



Extract 2: Location of trial pit in section



Photograph 1: No rooting from adjacent oak T1 within trial trench / beyond boundary wall foundations



Photograph 2: Viburnum root deflected by wall

Please do not hesitate to contact us should you require further information.

Yours sincerely



Adam Hollis
MSc Arb MRICS FArborA MICFor C ENV
Registered Consultant
Chartered Surveyor, Forester & Environmentalist

Encs: Updated Arboricultural Impact Plan

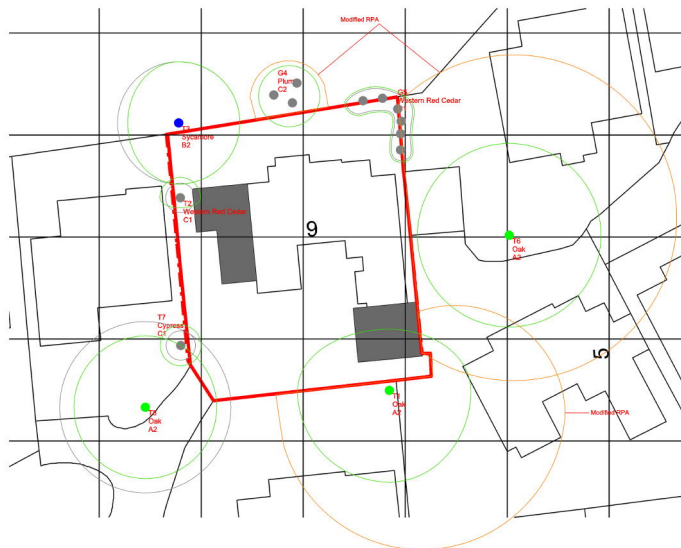

LOCK PLAN

NOTE:
 This survey is of a preliminary nature. The trees were inspected from the ground only on the basis of the Visual Tree Assessment method. No samples were taken for analysis. No decay detection equipment was employed. The survey does not cover the arrangements that may be required in connection with the laying or removal of underground services.

Branch spread in metres is taken at the four cardinal points to derive an accurate representation of the crown.
 Root Protection Areas (RPA) are derived from stem diameter measured at 1.5 m above adjacent ground level (taken on sloping ground on the upslope side of the tree base).

Landmark Trees
 20 Broadwick Street, London, W1F 8RT
 Tel: 0207 851 4544 Mobile: 0753 389828
 e-mail: info@landmarktrees.co.uk Web: www.landmarktrees.co.uk

Site: 9 George Gardens
 Drawing Title: Arboricultural Impact Assessment Plan
 1:100 @ A2
 February 2018

Key:

● Category A High Quality	○ Category B Moderate Quality	○ Category C Low Quality	○ Category U Trees Unsuitable for Retention	○ Crown Spread	○ Tree Number
○ Root Protection Area	○ Species	○ Category		○ Note: All Tree Positions Are Approximate (not shown on original survey)	