

NOTE.

AREA OF WALL TO BE RAISED ABOVE EXISTING FENCES COLOURED PINK

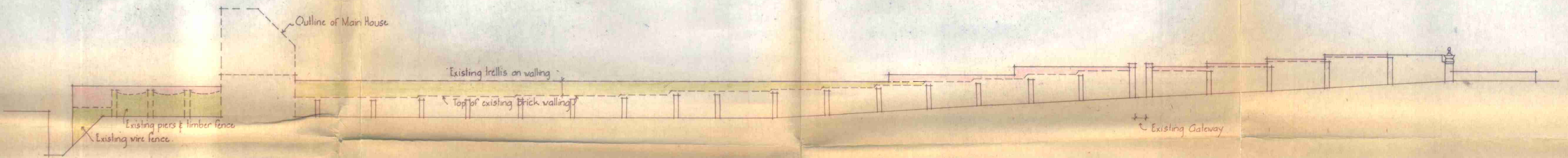

AREA OF NEW WALL TO REPLACE EXISTING FENCES COLOURED GREEN

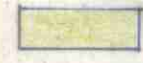

ELEVATION OF PROPOSED WALL LOOKING SOUTH TOWARDS SHEPHERD'S WALK

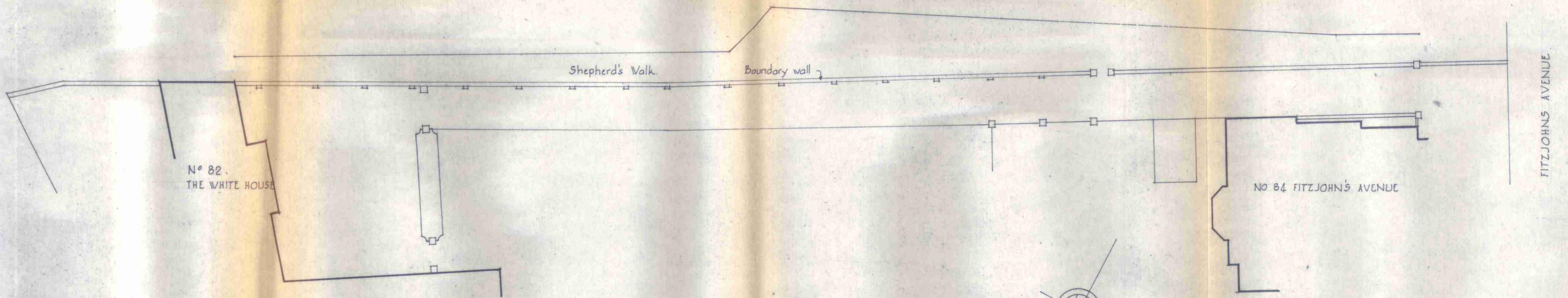

PLAN SHOWING SOUTH BOUNDARY WALL

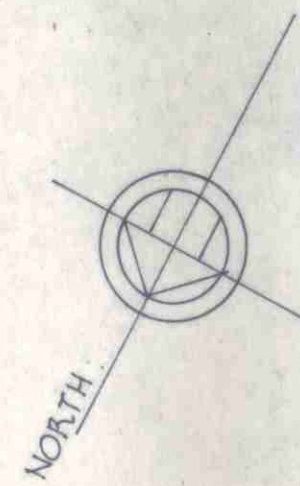

CTD/F7 2/C/12883

'THE WHITE HOUSE' FITZJOHN'S AVENUE NW3  
SOUTH BOUNDARY WALL

SCALE 1/16" = 1' 0"

RICHARDSON BELLAMY & BENTON  
17 EXCHANGE ROAD WATFORD HEATS

DECEMBER 1971

DRWG N° 71 2456/10

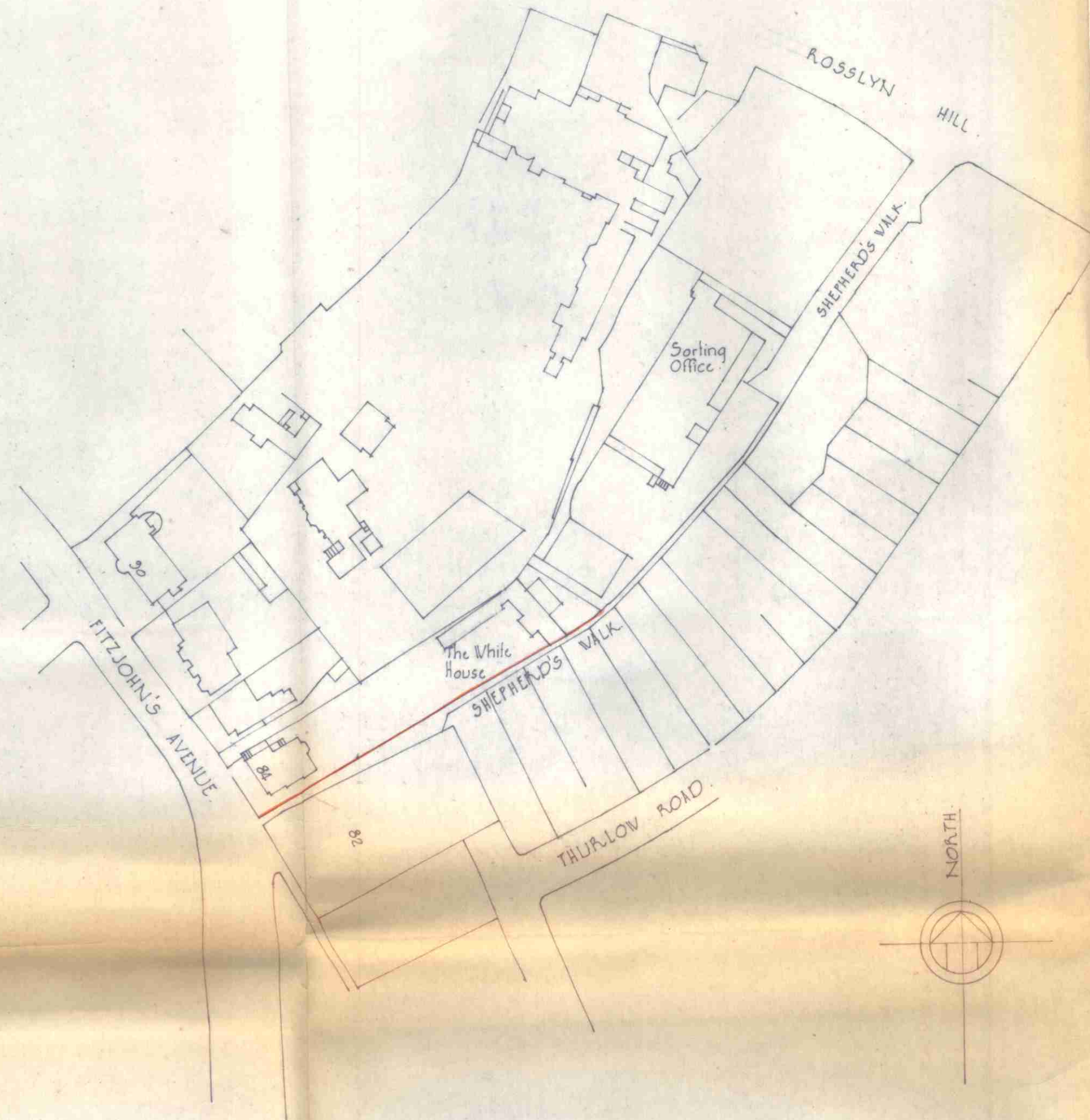

'THE WHITE HOUSE' FITZJOHN'S AVENUE NW3  
 SITE PLAN

SCALE 1/1250  
 RICHARDSON BELLAMY & BENTON  
 17 EXCHANGE ROAD, WATFORD HEATS

JUNE 1971  
 DRWG NO 71.2456/8

LONDON BOROUGH OF CAMDEN  
 APPROVED  
 PLANS ~~DISAPPROVED~~  
 28 MAR 1972  
 5th APRIL 72  
 ON BEHALF OF THE COUNCIL

CTC/F7/a/c/13823