

Notes:

- This drawing is to be read in conjunction with all relevant Architect's, Engineer's and Specialist's drawings and specifications.
- This drawing is the copyright of Constructure Ltd and is not to be used or reproduced without permission.
- Do not scale from this drawing in either paper or digital form. Use written dimensions only. To check drawing has been printed to the intended scale the width of the column should be 100mm wide @ A1 or 50mm wide @ A3.

Legend:

- Existing structure.
- Structure under.
- Reinforced concrete section.
- Reinforced concrete surface.
- Mass concrete.
- Blockwork.
- Brickwork.

NOTES:

- Pile loads shown are unfactored permanent downward loads only. Pile designer to derive lateral loads due to soil, water & surcharge from buildings adjacent and in accordance with main contractor's propping levels.
- Hydrostatic uplift to apply tension to piles in accordance with assumed groundwater level as at theoretical 1m below ground level. Allow 125 kN/m per pile.
- Pile cut-off datum: Proposed GF slab = +0.00m

<p>Sequencing indicative only. All temporary works by contractor.</p>	<p>RC underpins cast in 1.0m wide sequenced bays</p>
---	--

Status		PLANNING	
P1	21.03.18	TFC	TC
Rev	Date	Drawn	Eng
			Amendment

Project
77 AVENUE ROAD

SUB-BASEMENT PLAN

Drawing No.	1679 / 01	Rev	P1
Scale @ A1	1:50	Scale @ A3	1:100
Drawn	TFC	Engineer	PL
constructure			
Structural Designers	constructure.co.uk office@constructure.co.uk 020 7403 7989		

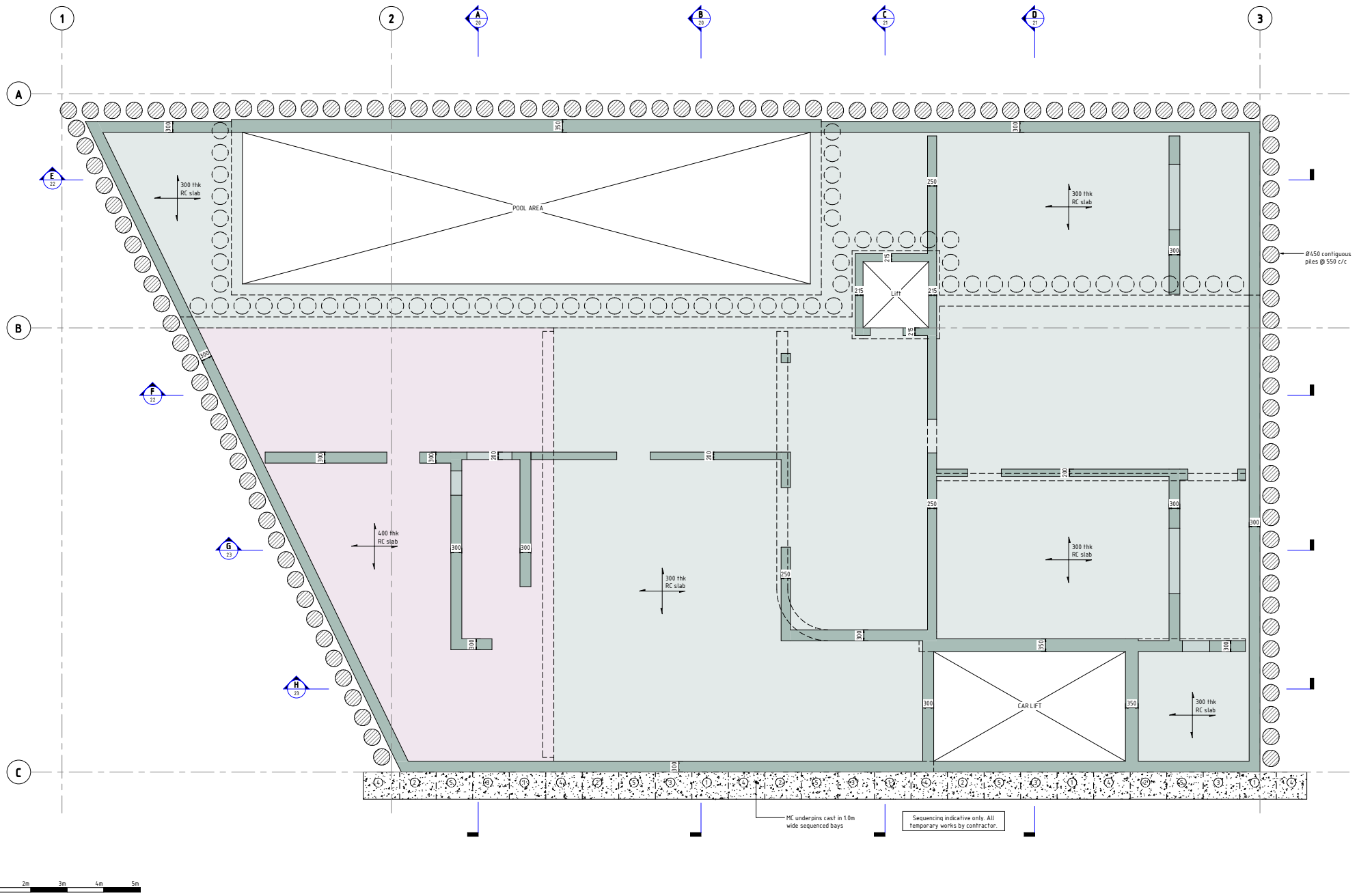

Notes:

- This drawing is to be read in conjunction with all relevant Architect's, Engineer's and Specialist's drawings and specifications.
- This drawing is the copyright of Constructure Ltd and is not to be used or reproduced without permission.
- Do not scale from this drawing in either paper or digital form. Use written dimensions only. To check drawing has been printed to the intended scale the width of the column should be 100mm wide @ A1 or 50mm wide @ A3.

Legend:

	- Existing structure.
	- Structure under.
	- Reinforced concrete section.
	- Reinforced concrete surface.
	- Mass concrete.
	- Blockwork.
	- Brickwork.

NOTES:

- Pile loads shown are unfactored permanent downward loads only. Pile designer to derive lateral loads due to soil, water & surcharge from buildings adjacent and in accordance with main contractor's propping levels.
- Hydrostatic uplift to apply tension to piles in accordance with assumed groundwater level as at theoretical 1m below ground level. Allow 125 kN/m per pile.
- Pile cut-off datum: Proposed GF slab +10.00m

<p>Sequencing indicative only. All temporary works by contractor.</p>	
<p>RC underpins cast in 1.0m wide sequenced bays</p>	

<p>Status</p> <p style="text-align: center;">PLANNING</p>	
P1	21.03.18 TFC TC Issued for Planning
Rev	Date Drawn Eng Amendment

<p>Project</p> <p>77 AVENUE ROAD</p>	
<p>BASEMENT PLAN</p>	

Drawing No.	1679 / 02	Rev	P1
Scale @ A1	150	Scale @ A3	1:100
Drawn	TFC	Engineer	PL
<p>constructure</p>			
<p>Structural Designers</p>		<p>constructure.co.uk office@constructure.co.uk 020 7403 7989</p>	

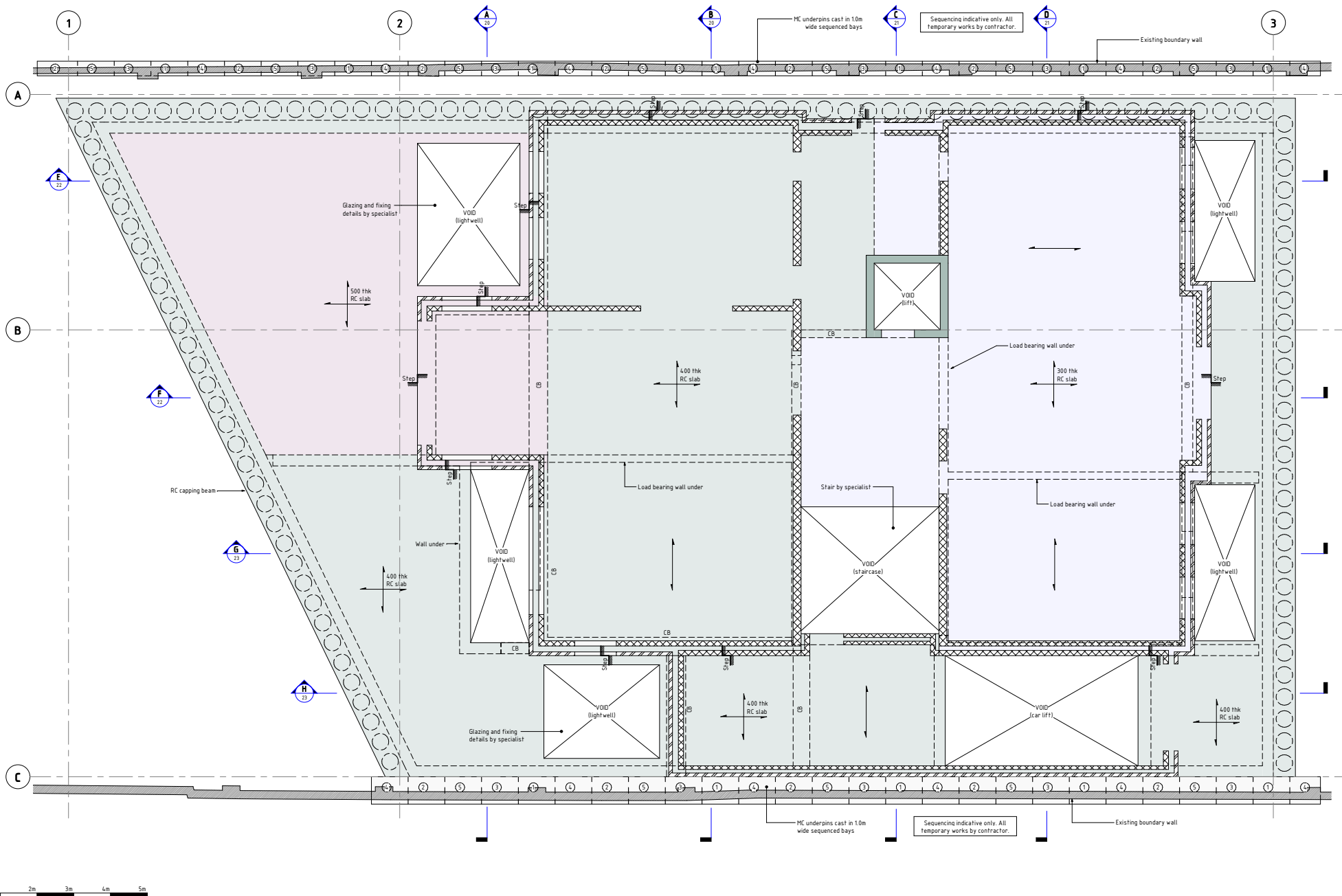

Notes:	
1.	This drawing is to be read in conjunction with all relevant Architect's, Engineer's and Specialist's drawings and specifications.
2.	This drawing is the copyright of Constructure Ltd and is not to be used or reproduced without permission.
3.	Do not scale from this drawing in either paper or digital form. Use written dimensions only. To check drawing has been printed to the intended scale the width of the column should be 100mm wide @ A1 or 50mm wide @ A3.
Legend:	
	- Existing structure.
	- Structure under.
	- Reinforced concrete section.
	- Reinforced concrete surface.
	- Mass concrete.
	- Blockwork.
	- Brickwork.

NOTES:	
a.	Pile loads shown are unfactored permanent downward loads only. Pile designer to derive lateral loads due to soil, water & surcharge from buildings adjacent and in accordance with main contractor's propping levels.
b.	Hydrostatic uplift to apply tension to piles in accordance with assumed groundwater level as at theoretical 1m below ground level. Allow 125 kN/m per pile.
c.	Pile cut-off datum: Proposed GF slab +10.00m

Status	
PLANNING	
P1	21.03.18 TFC TC Issued for Planning
Rev	Date Drawn Eng Amendment

Project	
77 AVENUE ROAD	
GROUND FLOOR PLAN	

Drawing No.	1679 / 03	Rev	P1
Scale @ A1	150	Scale @ A3	1:100
Drawn	TFC	Engineer	PL
constructure			
Structural Designers		constructure.co.uk office@constructure.co.uk 020 7403 7989	

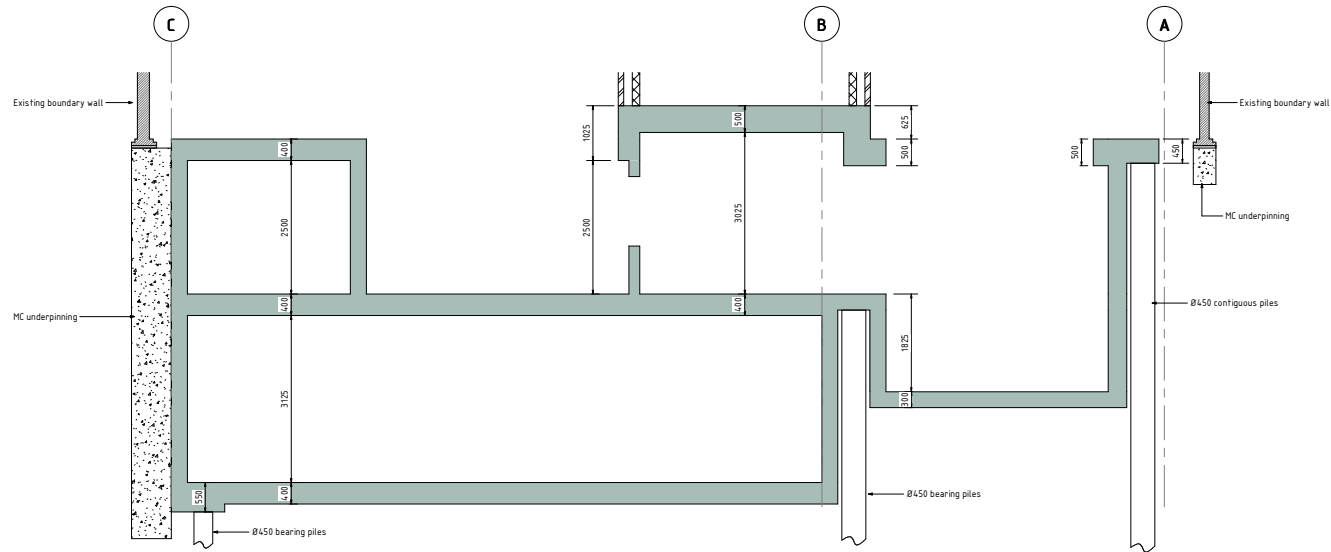

SECTION A-A
SCALE 1:50

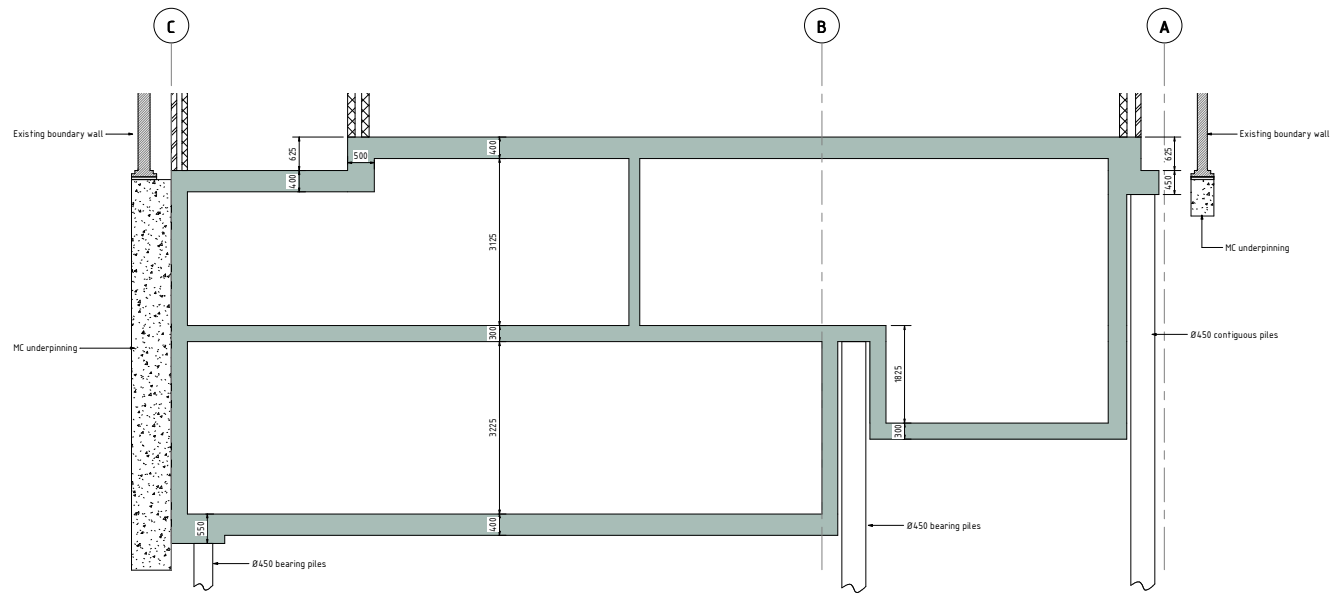

SECTION B-B
SCALE 1:50

- Notes:
- This drawing is to be read in conjunction with all relevant Architect's, Engineer's and Specialist's drawings and specifications.
 - This drawing is the copyright of Constructure Ltd and is not to be used or reproduced without permission.
 - Do not scale from this drawing in either paper or digital form. Use written dimensions only. To check drawing has been printed to the intended scale the width of the column should be 100mm wide @ A1 or 50mm wide @ A3.

Legend:

	- Existing structure.
	- Structure under.
	- Reinforced concrete section.
	- Reinforced concrete surface.
	- Mass concrete.
	- Blockwork.
	- Brickwork.

Status **PLANNING**

P1	21.03.18	TFC	TC	Issued for Planning
Rev	Date	Drawn	Eng	Amendment

Project
77 AVENUE ROAD

DETAILS & SECTIONS
SHEET 1

Drawing No.	1679 / 20	Rev	P1
Scale @ A1	1:50	Scale @ A3	1:100
Drawn	TFC	Engineer	PL

constructure

Structural Designers

constructure.co.uk
office@constructure.co.uk
020 7403 7989

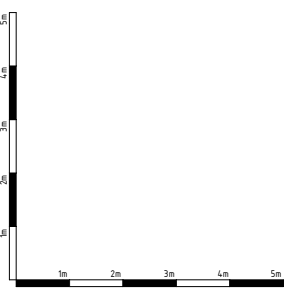

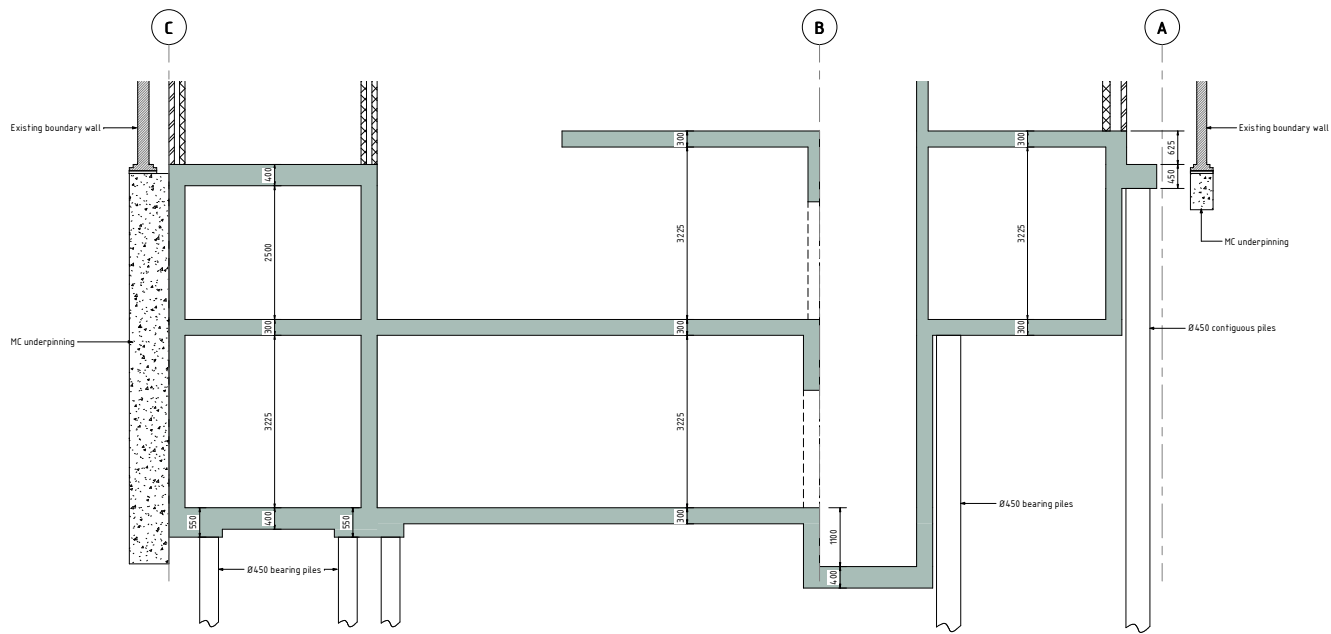

SECTION C-C
SCALE 1:50

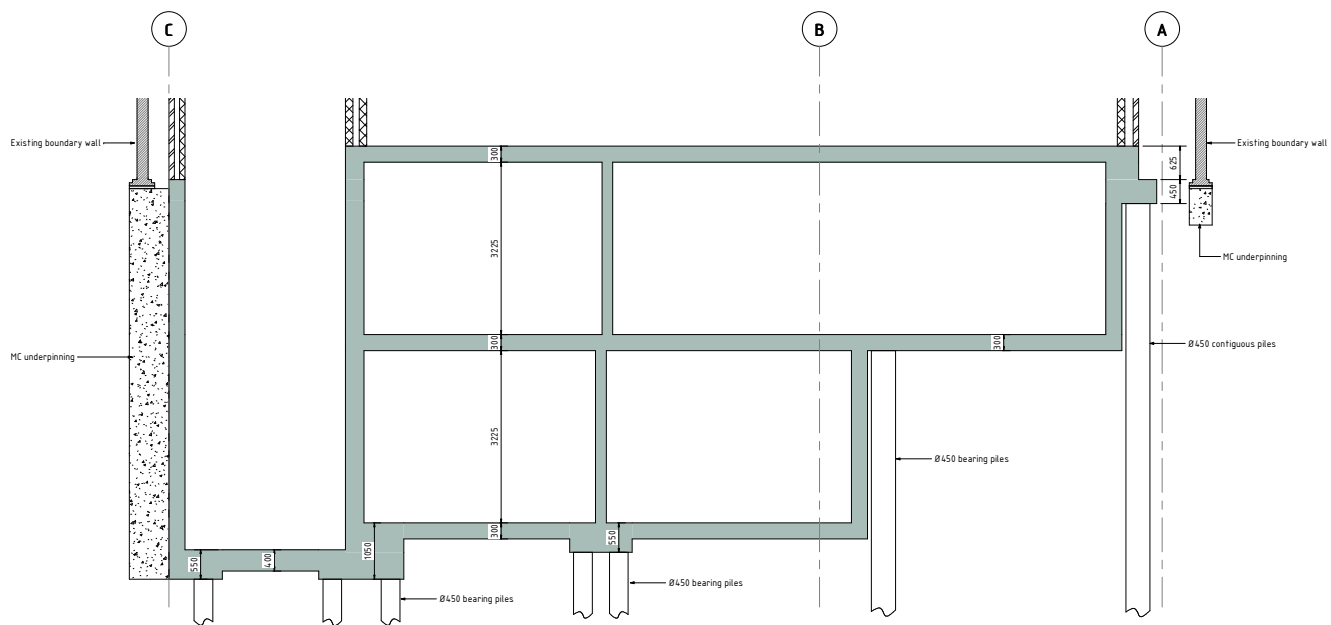

SECTION D-D
SCALE 1:50

- Notes:
- This drawing is to be read in conjunction with all relevant Architect's, Engineer's and Specialist's drawings and specifications.
 - This drawing is the copyright of Constructure Ltd and is not to be used or reproduced without permission.
 - Do not scale from this drawing in either paper or digital form. Use written dimensions only. To check drawing has been printed to the intended scale the width of the column should be 100mm wide @ A1 or 50mm wide @ A3.

Legend:

	- Existing structure.
	- Structure under.
	- Reinforced concrete section.
	- Reinforced concrete surface.
	- Mass concrete.
	- Blockwork.
	- Brickwork.

Status **PLANNING**

P1	21.03.18	TFC	TC	Issued for Planning
----	----------	-----	----	---------------------

Rev	Date	Drawn	Eng	Amendment
-----	------	-------	-----	-----------

Project
77 AVENUE ROAD

DETAILS & SECTIONS
SHEET 2

Drawing No.	1679 / 21	Rev	P1
-------------	-----------	-----	----

Scale @ A1	1:50	Scale @ A3	1:100
------------	------	------------	-------

Drawn	TFC	Engineer	PL
-------	-----	----------	----

constructure

Structural Designers
constructure.co.uk
office@constructure.co.uk
020 7403 7989

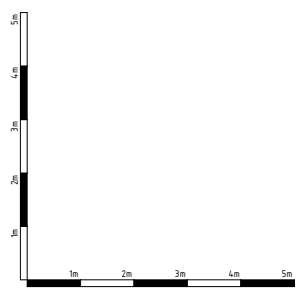

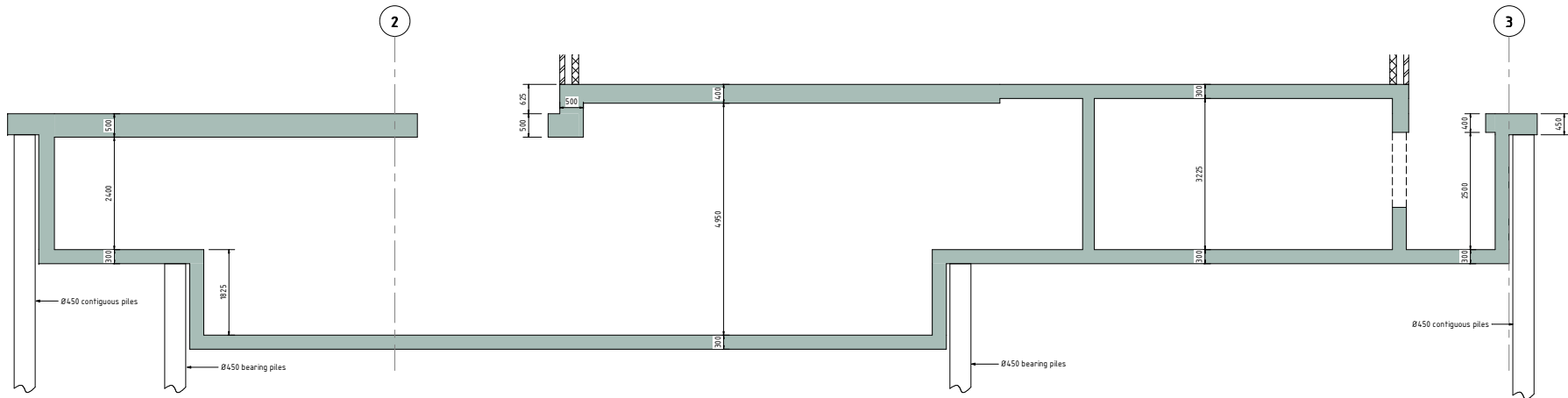

SECTION E-E
SCALE 1:50

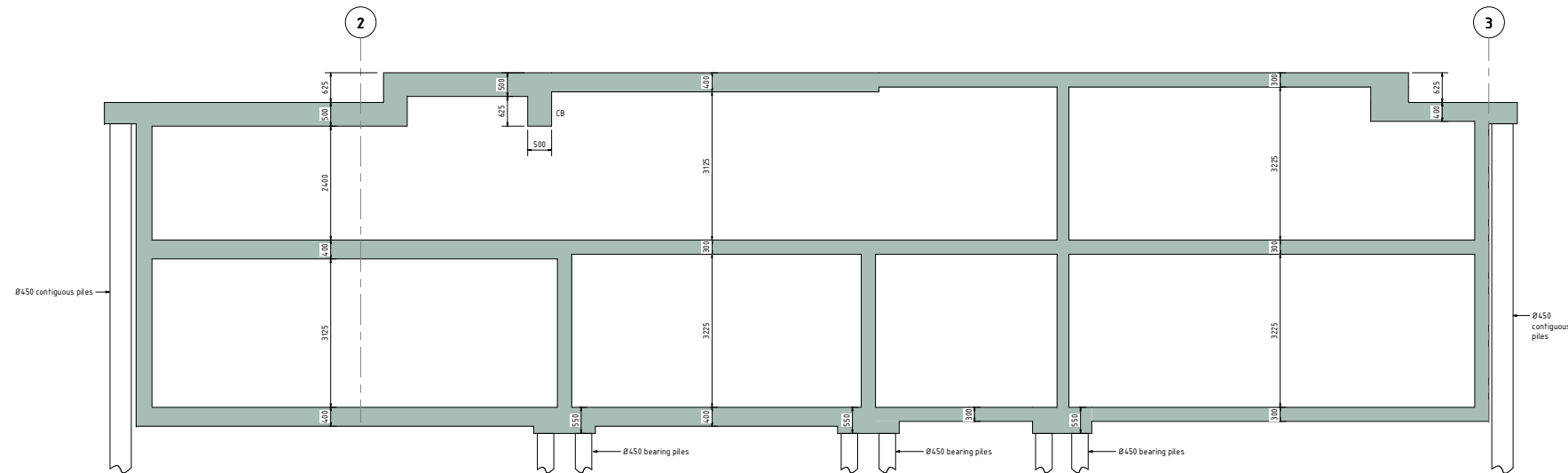

SECTION F-F
SCALE 1:50

- Notes:
1. This drawing is to be read in conjunction with all relevant Architect's, Engineer's and Specialist's drawings and specifications.
 2. This drawing is the copyright of Constructure Ltd and is not to be used or reproduced without permission.
 3. Do not scale from this drawing in either paper or digital form. Use written dimensions only. To check drawing has been printed to the intended scale the width of the column should be 100mm wide @ A1 or 50mm wide @ A3.

Legend:

	- Existing structure.
	- Structure under.
	- Reinforced concrete section.
	- Reinforced concrete surface.
	- Mass concrete.
	- Blockwork.
	- Brickwork.

Status **PLANNING**

P1	21.03.18	TFC	TC	Issued for Planning
Rev	Date	Drawn	Eng	Amendment

Project
77 AVENUE ROAD

DETAILS & SECTIONS
SHEET 3

Drawing No.	1679 / 22	Rev	P1
-------------	-----------	-----	----

Scale @ A1	1:50	Scale @ A3	1:100
Drawn	TFC	Engineer	PL

constructure

Structural Designers

constructure.co.uk
office@constructure.co.uk
020 7403 7989

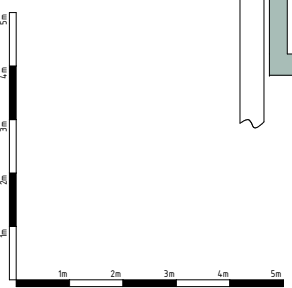

- Notes:
- This drawing is to be read in conjunction with all relevant Architect's, Engineer's and Specialist's drawings and specifications.
 - This drawing is the copyright of Constructure Ltd and is not to be used or reproduced without permission.
 - Do not scale from this drawing in either paper or digital form. Use written dimensions only. To check drawing has been printed to the intended scale the width of the column should be 100mm wide @ A1 or 50mm wide @ A3.

Legend:

	- Existing structure.
	- Structure under.
	- Reinforced concrete section.
	- Reinforced concrete surface.
	- Mass concrete.
	- Blockwork.
	- Brickwork.

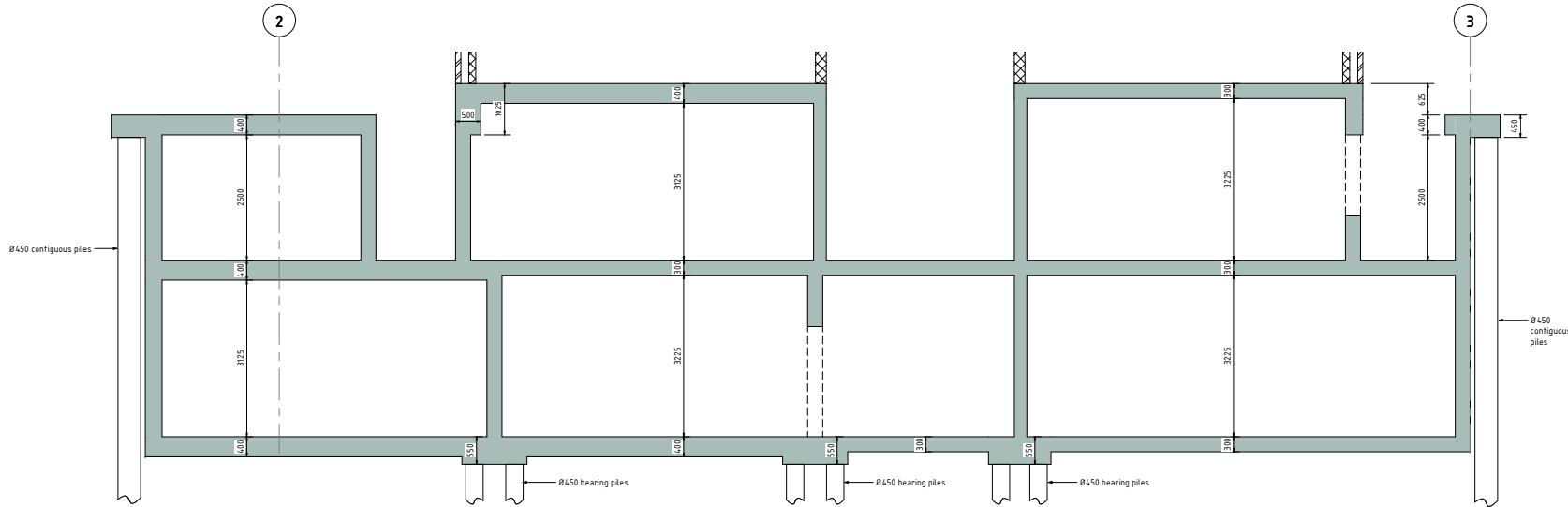

SECTION G-G
SCALE 1:50

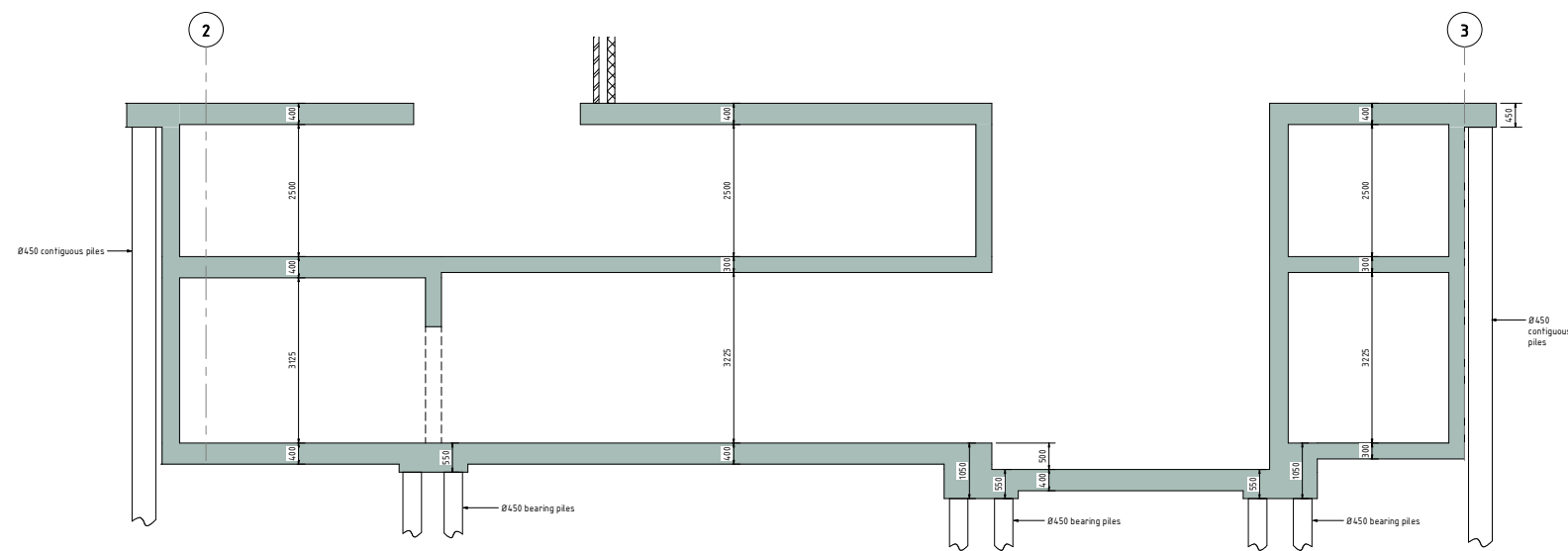

SECTION H-H
SCALE 1:50

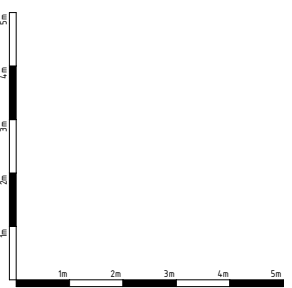

Status	PLANNING		
P1	21.03.18	TFC	TC Issued for Planning
Rev	Date	Drawn	Eng Amendment
Project			
77 AVENUE ROAD			
DETAILS & SECTIONS			
SHEET 4			
Drawing No.	1679 / 23	Rev	P1
Scale @ A1	1:50	Scale @ A3	1:100
Drawn	TFC	Engineer	PL
constructure			
Structural Designers		constructure.co.uk office@constructure.co.uk 020 7403 7989	