

Notes

- existing cill bricks (shown orange in section) to be carefully removed.
- window is supported on inner leaf of blockwork; dpc behind cill to be retained and inspected before the new cill bricks are installed.
- install replacement cill bricks to match existing; mortar joints to be 10mm.
- see Schedule of Works notes for mortar and pointing
- allow for mastic seal (manufacturer: adshhead ratcliffe ltd) between timber cill and brick cill

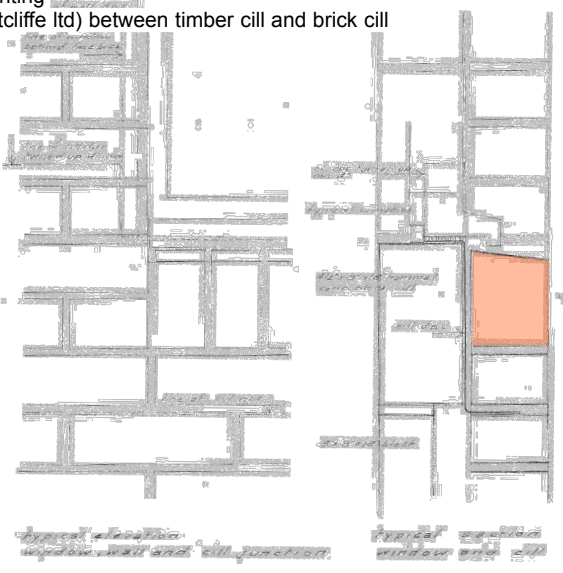
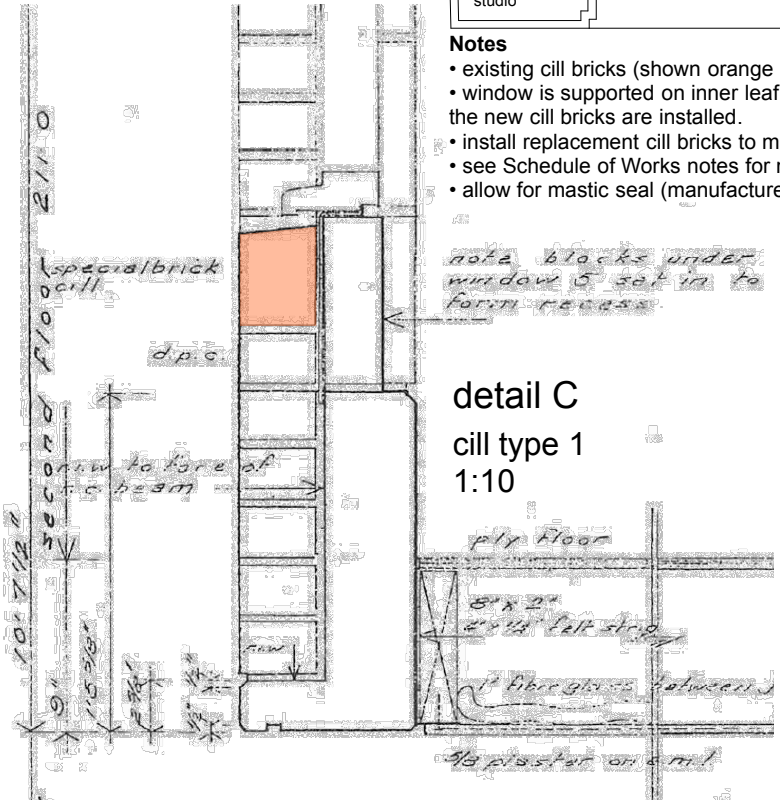

revisions

drawing title	First floor plan + details
project	Brickwork repairs 24-32 Wmscombe St London N19 5DG
scale	As indicated
date	24.06.18
drawing no	556.P.02
	C

Pentad Housing Society

tender
drawing status

26 Wmscombe Street, London N19 5DG
T 07973 625 711