

**GENERAL NOTES:**

- THIS DRAWING IS TO BE READ IN CONJUNCTION WITH ALL RELEVANT DESIGN DRAWINGS, SPECIFICATIONS AND DOCUMENTATION.
- ALL DIMENSIONS ARE IN MILLIMETRES AND LEVELS IN METRES ABOVE LOCAL DATUM, UNLESS NOTED OTHERWISE
- ROAD CONSTRUCTION DETAIL NOTES:**
  - ANY DISCREPANCIES IN THE DETAILS SHOWN ARE TO BE REPORTED TO THE EMPLOYER'S REPRESENTATIVE/ENGINEER PRIOR TO CONSTRUCTION.
  - ALL EXISTING SERVICES ARE TO BE LOCATED PRIOR TO THE COMMENCEMENT OF ANY WORKS. THE CONTRACTOR MUST NOTIFY THE ENGINEER IMMEDIATELY OF ANY CONFLICT WITH THE PROPOSED WORKS.
  - CONCRETE MIXES INDICATED ON THIS DRAWING ARE DESIGNATED MIXES IN ACCORDANCE WITH BS 8500-1:2006. ALL CONCRETE TO BE SULPHATE RESISTANT.
  - BACKFILL TO ALL TRENCHES UNDER CARRIAGEWAYS TO BE TYPE 1 SUB-BASE MATERIAL, ELSEWHERE BACKFILL TO BE IN ACCORDANCE WITH THE SPECIFICATION, FREE DRAINING READILY COMPACTABLE MATERIAL, FREE FROM RUBBISH AND ORGANIC MATTER, FROZEN SOIL, CLAY LUMPS AND LARGE STONES. TO BE COMPACTED IN LAYERS NOT EXCEEDING 150mm THICK.
  - THE GENERAL SPECIFICATION OF MATERIALS AND WORKMANSHIPS FOR THE CONSTRUCTION OF THE ACCESS ROAD, FOOTPATHS AND OTHER AREAS OF HARDSTANDING SHALL BE TO THE MANUAL OF CONTRACT DOCUMENTS FOR HIGHWAY WORKS, VOLUME 1. SPECIFICATION OF HIGHWAY WORKS (SHW) PUBLISHED BY THE STATIONARY OFFICE.
  - IN THE EVENT THAT LOCALISED 'SOFT SPOTS' ARE ENCOUNTERED WITHIN THE EARTHWORKS DURING CONSTRUCTION, AN APPROPRIATE COURSE OF ACTION IS TO BE AGREED WITH THE ENGINEER.

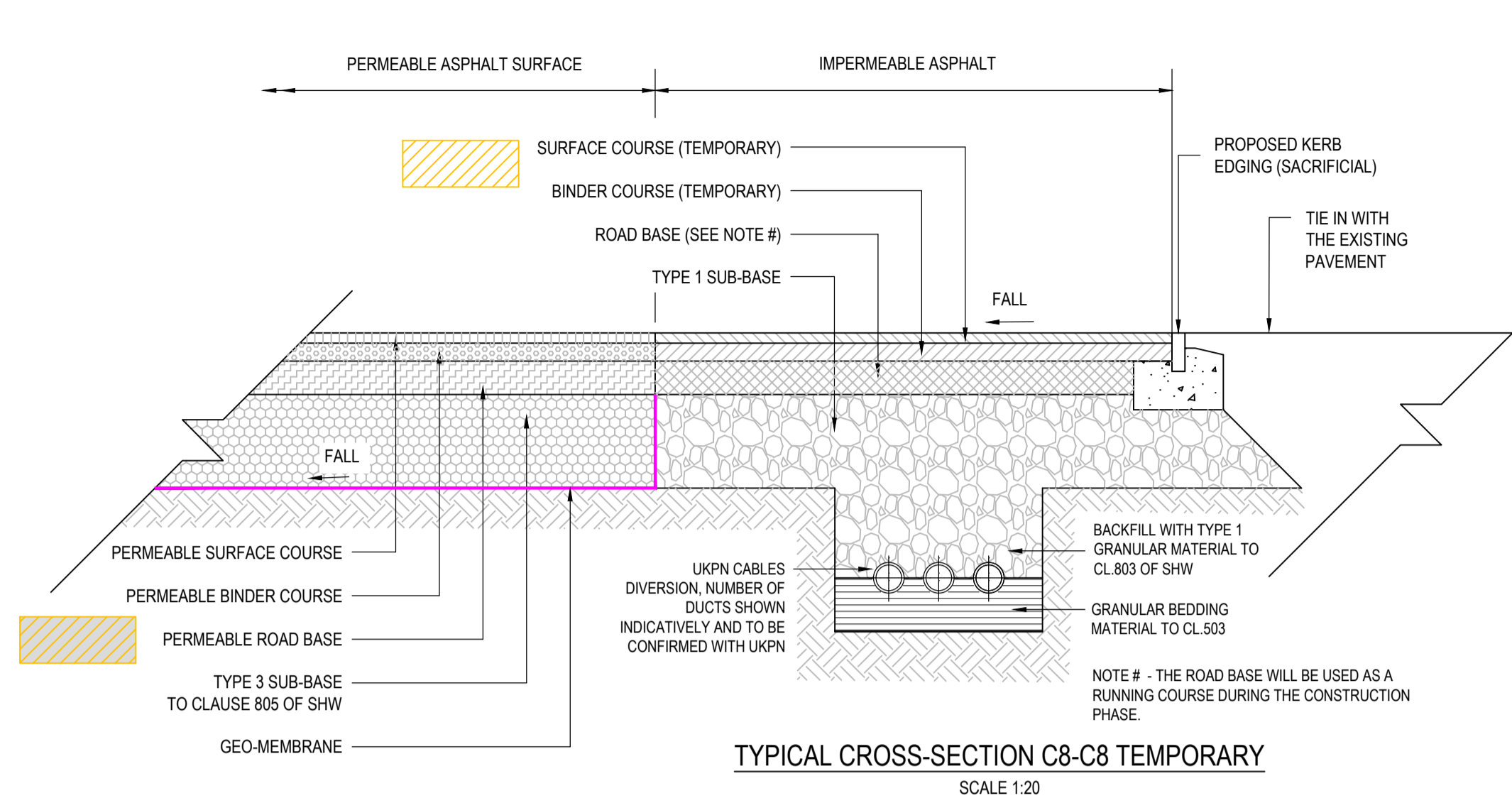

**TYPICAL CROSS-SECTION C8-C8 TEMPORARY**  
SCALE 1:20

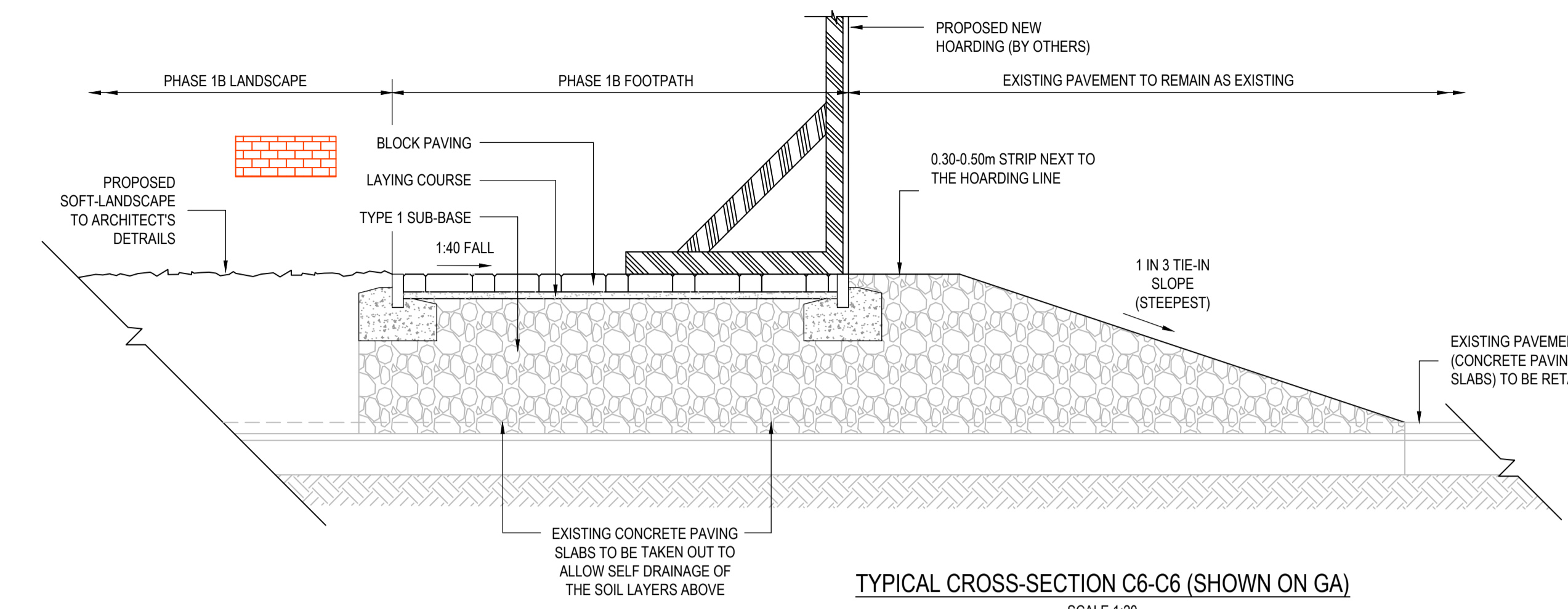

**TYPICAL CROSS-SECTION C6-C6 (SHOWN ON GA)**  
SCALE 1:20

**TURNING HEAD IN BLOCK PAVING**

**BLOCK PAVING**  
80mm CHARCON ANDOVER TEXTURED RANGE, 300mm x 100mm COLOUR 'SILVER FLECK', LAID IN HERRINGBONE PATTERN

**LAYING COURSE**  
50mm CATEGORY 2 SAND LAYING COURSE (30mm AFTER COMPACTION)

**BASE COURSE (RUNNING COURSE)**  
125mm AC32 DENSE BASE COURSE 40/60 TO BS EN 13103-1

**SUB-BASE (SEE NOTE \*)**  
350mm TYPE 1 SUB-BASE TO CLAUSE 803 OF SPECIFICATION FOR HIGHWAY WORKS

**NOTE \*** - THE THICKNESS OF THE TYPE 1 SUB-BASE IS BASED ON THE RECOMMENDED CBR VALUE OF 2.5%. THE CONTRACTOR MUST UNDERTAKE SITE CBR TESTS AS SHOWN IN DRAWING NO T14011-PBA-DR-C-1B-FGH-00-PA-011 AND CONFIRM THESE TO THE ENGINEER 14NO DAYS IN ADVANCE OF STARTING THE SITE WORKS.

**TURNING HEAD IN IMPERMEABLE ASPHALT**

**SURFACE COURSE (TEMPORARY - SACRIFICIAL)**  
40mm DRAINASPALT 10mm AGGREGATE OR SIMILAR APPROVED

**BINDER COURSE (TEMPORARY - SACRIFICIAL)**  
70mm AC20 DENSE BINDER COURSE 40/60 TO BS EN 13103-1

**BASE COURSE (TO REMAIN AS RUNNING COURSE)**  
125mm AC32 DENSE BASE COURSE 40/60 TO BS EN 13103-1

**SUB-BASE (SEE NOTE \*)**  
350mm TYPE 1 SUB-BASE TO CLAUSE 803 OF SPECIFICATION FOR HIGHWAY WORKS

**NOTE \*** - THE THICKNESS OF THE TYPE 1 SUB-BASE IS BASED ON THE RECOMMENDED CBR VALUE OF 2.5%. THE CONTRACTOR MUST UNDERTAKE SITE CBR TESTS AS SHOWN IN DRAWING NO T14011-PBA-DR-C-1B-FGH-00-PA-011 AND CONFIRM THESE TO THE ENGINEER 14NO DAYS IN ADVANCE OF STARTING THE SITE WORKS.

**TURNING HEAD IN PERMEABLE ASPHALT**

**SURFACE COURSE**  
40mm DRAINASPALT 10mm AGGREGATE OR SIMILAR APPROVED

**BINDER COURSE**  
70mm DRAINASPALT 20mm AGGREGATE OR SIMILAR APPROVED

**BASE COURSE (RUNNING COURSE)**  
125mm DRAINASPALT 32mm AGGREGATE OR SIMILAR APPROVED

**SUB-BASE**  
MIN. 350mm TYPE 3 (OPENGRADE) SUB-BASE TO CL 805 OF SPECIFICATION OF HIGHWAY WORKS. THE SUB-BASE TO FALL TOWARDS THE OUTFALL.

PERMEABLE PAVEMENT CONSTRUCTION SPECIFIED ABOVE IS SUITABLE FOR A CBR VALUE OF 2.5%. FOR DIFFERENT CBR VALUES, PLEASE REFER BACK TO ENGINEER FOR CLARIFICATION. CONTRACTOR TO UNDERTAKE 2NO INSITU CBR TESTS AT THE PROPOSED FORMATION LEVEL.

ALL MATERIAL SPECIFICATION AND WORKMANSHIP OF PERMEABLE PAVEMENT CONSTRUCTION TO BE STRICTLY IN ACCORDANCE WITH MANUFACTURERS RECOMMENDATIONS. NO ALTERNATIVE OR SUBSTITUTIONS WILL BE CONSIDERED WITHOUT PRIOR APPROVAL OF THE ENGINEER.

**FOOTWAY IN BLOCK PAVING AWAY FROM THE MAIN PART OF THE SITE**

**BLOCK PAVING**  
80mm CHARCON ANDOVER TEXTURED RANGE, 200mm x 100mm COLOUR 'SILVER FLECK', LAID IN STRETCHER BOND PATTERN

**LAYING COURSE**  
50mm CATEGORY 2 SAND LAYING COURSE (30mm AFTER COMPACTION)

**SUB-BASE (SEE NOTE \*)**  
350mm TYPE 1 SUB-BASE TO CLAUSE 803 OF SPECIFICATION FOR HIGHWAY WORKS

**NOTE \*** - THE THICKNESS OF THE TYPE 1 SUB-BASE IS BASED ON THE RECOMMENDED CBR VALUE OF 2.5%. THE CONTRACTOR MUST UNDERTAKE SITE CBR TESTS AS SHOWN IN DRAWING NO T14011-PBA-DR-C-1B-FGH-00-PA-011 AND CONFIRM THESE TO THE ENGINEER 14NO DAYS IN ADVANCE OF STARTING THE SITE WORKS.

**FOOTWAY IN BLOCK PAVING (WITH BASE COURSE)**

**BLOCK PAVING**  
80mm CHARCON ANDOVER TEXTURED RANGE, 200mm x 100mm COLOUR 'SILVER FLECK', LAID IN STRETCHER BOND PATTERN

**LAYING COURSE**  
50mm CATEGORY 2 SAND LAYING COURSE (30mm AFTER COMPACTION)

**BASE COURSE (RUNNING COURSE)**  
125mm AC32 DENSE BASE COURSE 40/60 TO BS EN 13103-1

**SUB-BASE (SEE NOTE \*)**  
350mm TYPE 1 SUB-BASE TO CLAUSE 803 OF SPECIFICATION FOR HIGHWAY WORKS

**NOTE \*** - THE THICKNESS OF THE TYPE 1 SUB-BASE IS BASED ON THE RECOMMENDED CBR VALUE OF 2.5%. THE CONTRACTOR MUST UNDERTAKE SITE CBR TESTS AS SHOWN IN DRAWING NO T14011-PBA-DR-C-1B-FGH-00-PA-011 AND CONFIRM THESE TO THE ENGINEER 14NO DAYS IN ADVANCE OF STARTING THE SITE WORKS.

**NOTE \*** - THE THICKNESS OF THE TYPE 1 SUB-BASE IS BASED ON THE RECOMMENDED CBR VALUE OF 2.5%. THE CONTRACTOR MUST UNDERTAKE SITE CBR TESTS AS SHOWN IN DRAWING NO T14011-PBA-DR-C-1B-FGH-00-PA-011 AND CONFIRM THESE TO THE ENGINEER 14NO DAYS IN ADVANCE OF STARTING THE SITE WORKS.

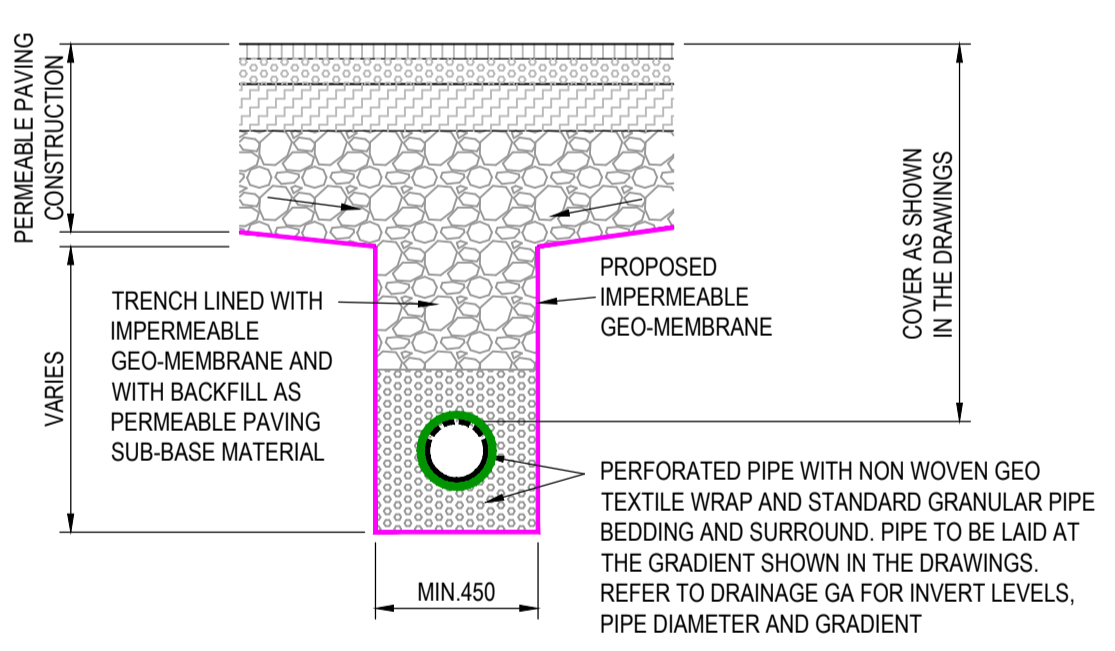

**PERMEABLE ASPHALT SURFACE COLLECTOR DRAIN**  
SCALE 1:20

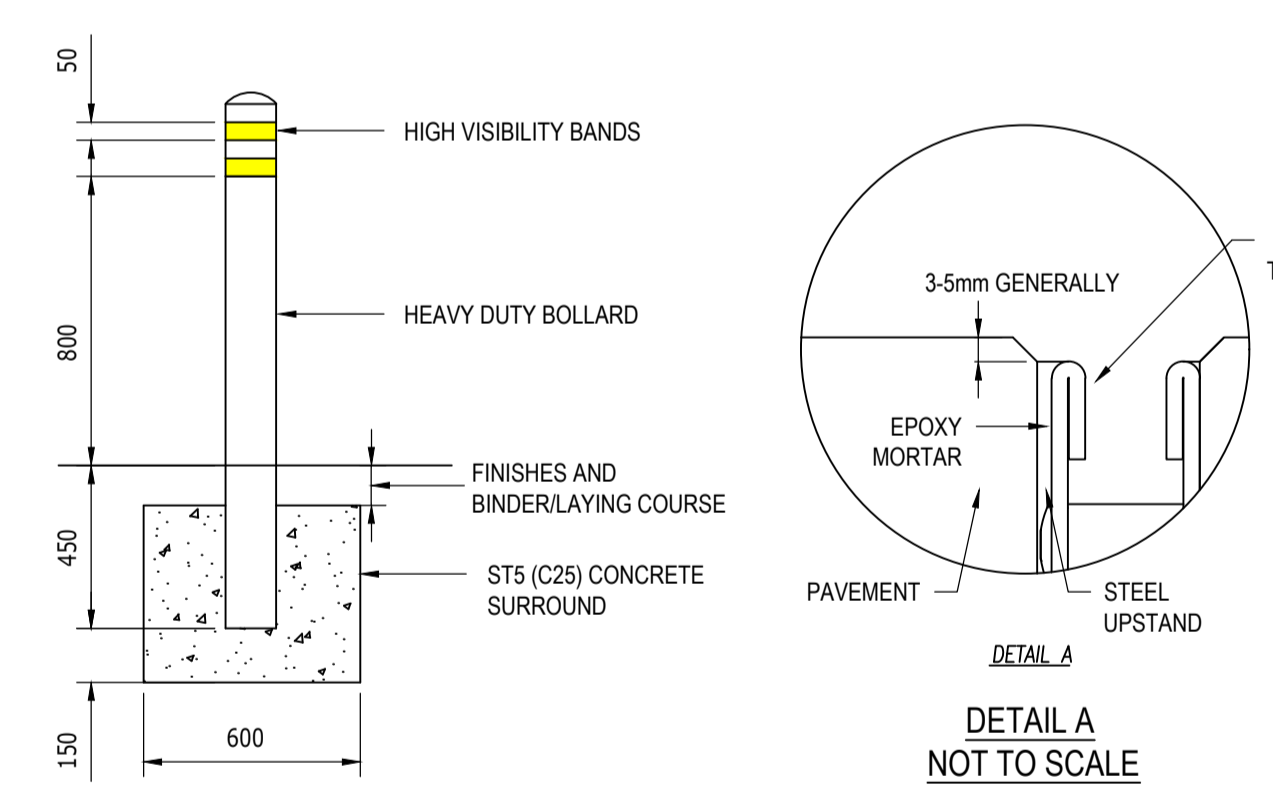

**TYPICAL BOLLARD DETAILS**  
SCALE 1:20

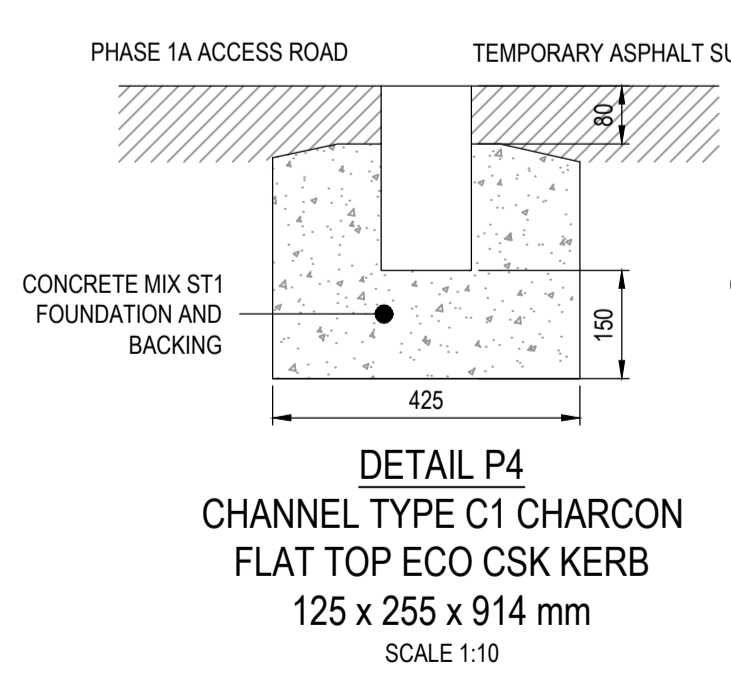

**DETAIL P4**  
CHANNEL TYPE C1 CHARCON  
FLAT TOP ECO CSK KERB  
125 x 255 x 914 mm  
SCALE 1:10

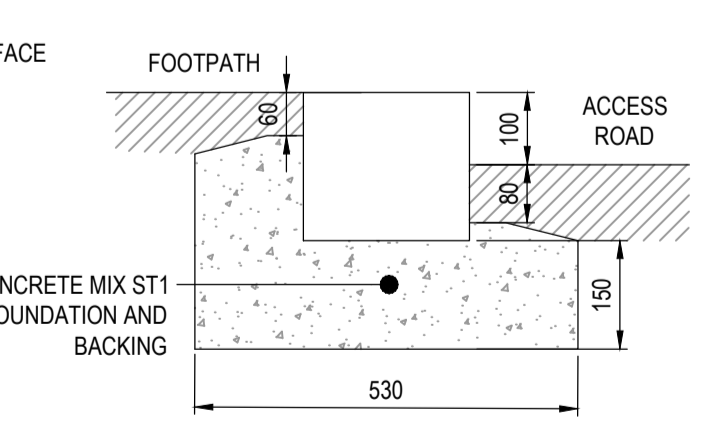

**DETAIL NS3**  
CHARCON ECO KERB  
290 x 205 x 914 mm  
SCALE 1:10

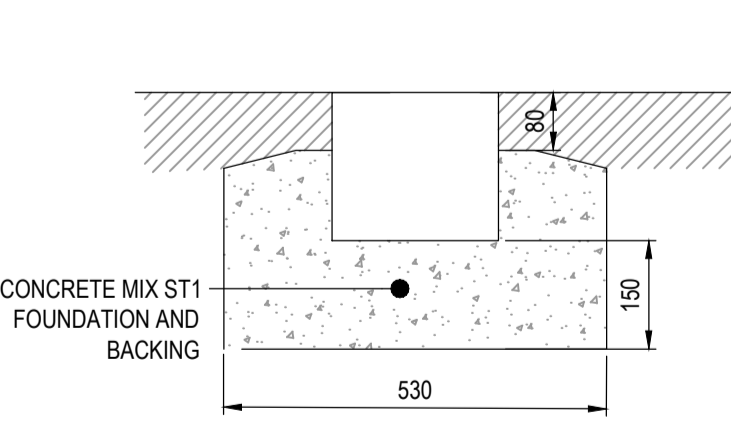

**DETAIL NS3(F)**  
CHARCON ECO KERB  
290 x 205 x 914 mm  
SCALE 1:10

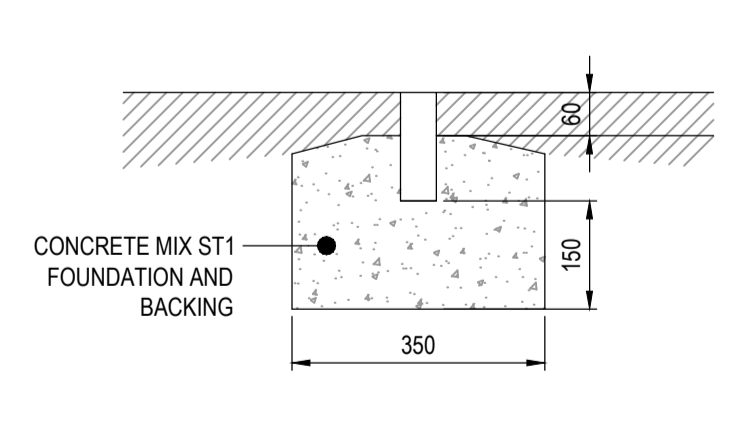

**DETAIL PK3**  
CHARCON ECO KERB EDGING  
150 x 50 x 914 mm  
SCALE 1:10

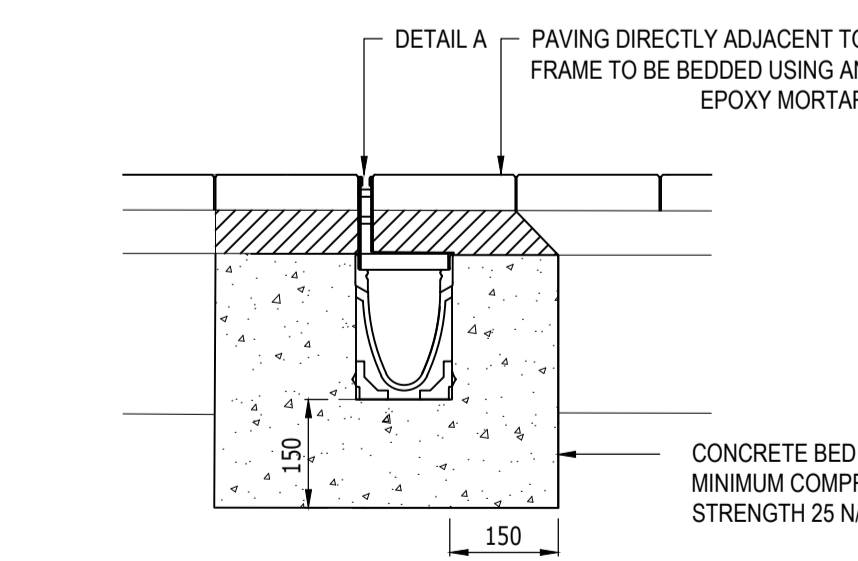

**SLOT DRAIN - ACO MULTIDRAIN M1000-23007 BRICKSLOT  
INSTALLATION DETAIL FOR STANDARD BRICKSLOT TOPS**  
SCALE 1:10

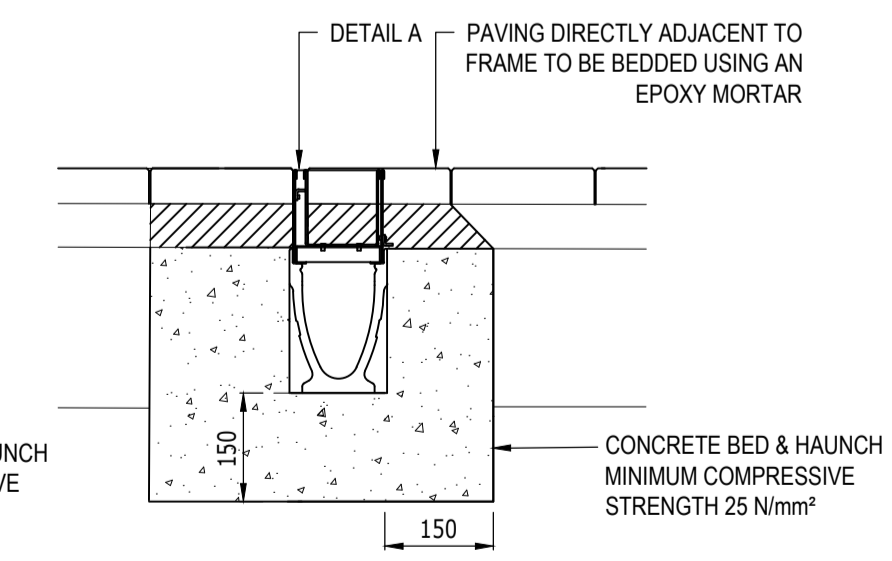

**SLOT DRAIN - ACO MULTIDRAIN M1000-23007 BRICKSLOT  
INSTALLATION DETAIL FOR STANDARD BRICKSLOT TOPS  
ACCESS COVERS/SUMP TOPS**  
SCALE 1:10

ALL PAVEMENT CONSTRUCTION MAKE UPS SHOWN IN THIS DRAWING HAVE BEEN BASED ON AN EQUILIBRIUM CBR VALUE (AT SUB-GRADE LEVEL) OF 2.5%. SHOULD THE SITE CBR VALUES BE LESS THAN THIS THEN THE CONTRACTOR SHALL CONSULT THE ENGINEER

C1	CONSTRUCTION ISSUE	04.07.18	IK	BH	PDS
P1	SECTION C8-C8 AMENDED	26.06.18	IK	BH	PDS
-	WORK IN PROGRESS - DRAFT	05.03.18	IK	BH	PDS
Mark	Revision	Date	Drawn	Chkd	Appd

SCALING NOTE: Do not scale from this drawing. If in doubt, ask.  
UTILITIES NOTE: The position of any existing public or private sewers, utility services, plant or apparatus shown on this drawing is believed to be correct, but no warranty to this is expressed or implied. Other such plant or apparatus may also be present but not shown. The Contractor is therefore advised to undertake his own investigation where the presence of any existing sewers, services, plant or apparatus may affect his operations.

Drawing Issue Status  
**CONSTRUCTION**

**AGAR GROVE ESTATE REGENERATION  
PHASE 1A & 1B TEMPORARY TURNING HEAD  
N-W OF LULWORTH BLOCK  
CONSTRUCTION DETAILS (2 OF 2)**

Client **Hill**

**ARCHITYPE**

Date of 1st Issue: 05.03.18  
Designed: IK  
A1 Scale: AS SHOWN  
Checked: BH  
Drawing Number: T14011-PBA-DR-C-1B-FGH-00-SD-066

Drawn: IK  
Approved: PDS  
Revision: C1

**pba peterbrett**  
Offices throughout the UK and Europe  
www.peterbrett.com  
© Peter Brett Associates LLP  
LONDON  
Tel: 020 7566 8600