

NOTES

Copyright All rights reserved.
This drawing is the property of the Architect and must not be reproduced without permission.
This drawing must not be scaled. Dimensions are in millimetres unless specified.

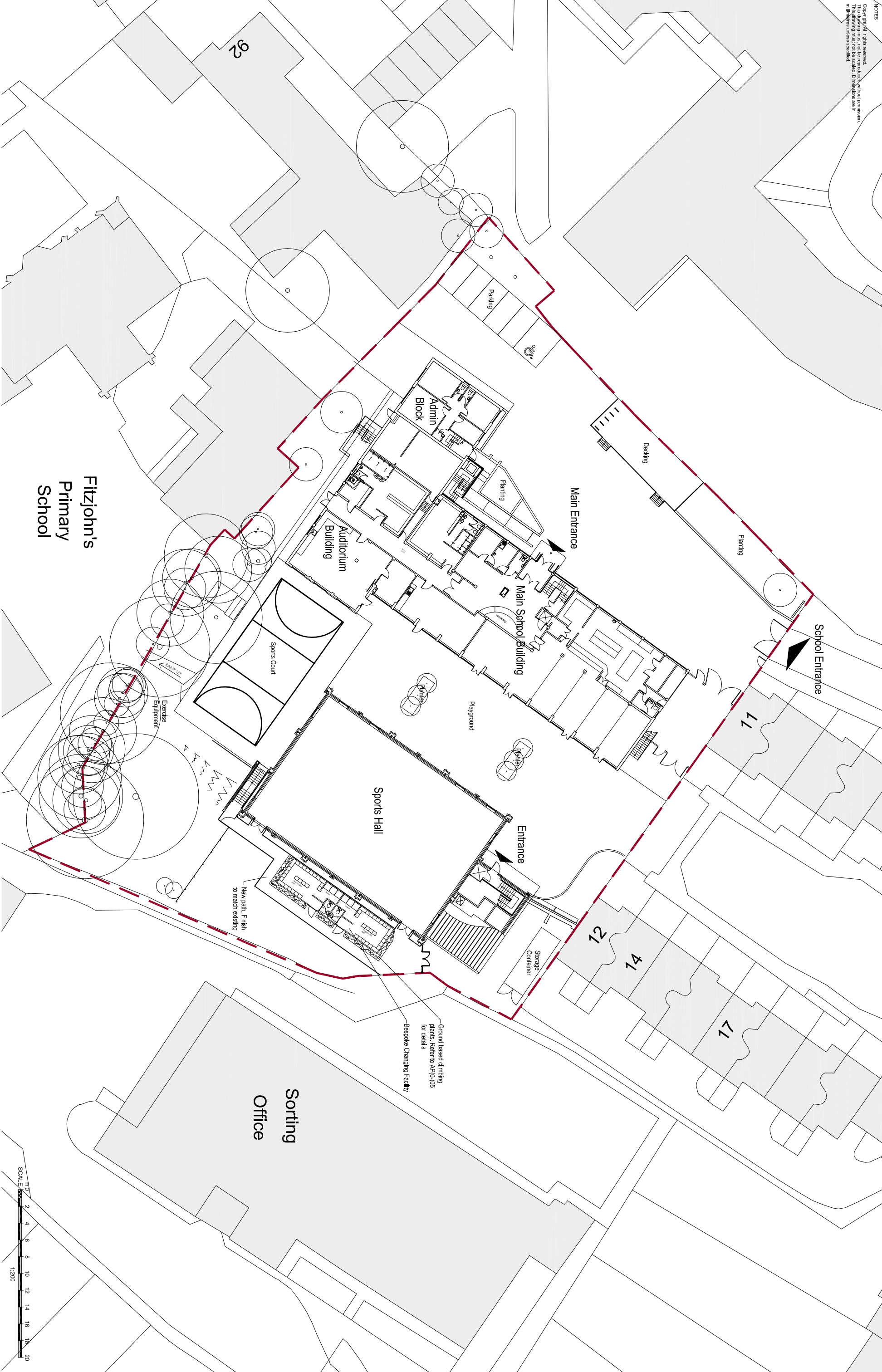

REV	DATE	REVISION NOTE	BY	CHECK



Fitzjohn's
Primary
School

Sorting
Office

Ground based climbing
plants. Refer to AP(C)-05
for details

Bespoke Changing Facility

New path, Finish
to match existing



eliswiliams
ARCHITECTS

2nd Floor 131 Stowmarket High Street London E1 6LE
T: +44 (0)20 7541 7200 E: info@eliswiliams.co.uk

North Bridge House Senior School, Hampshire
Site Plan - Proposed / Changing Facilities
2432_AP(0-0)01
STATUS | PLANNING
DRAWN BY | ESW
SCALE | 1:500 @ A1
DATE | 14/03/2019
REV