

STUD WALLS AND DOORS TO BE REMOVED TO ALLOW FOR RECONFIGURATION OF THE LAYOUT - NO WALLS OR DOORS CARRY ANY SIGNIFICANT HISTORICAL VALUE AND THEREFORE DO NOT CAUSE ANY IMPACT

DEMOLITION PLAN - THIRD FLOOR

109 GUILFORD STREET

110 GUILFORD STREET

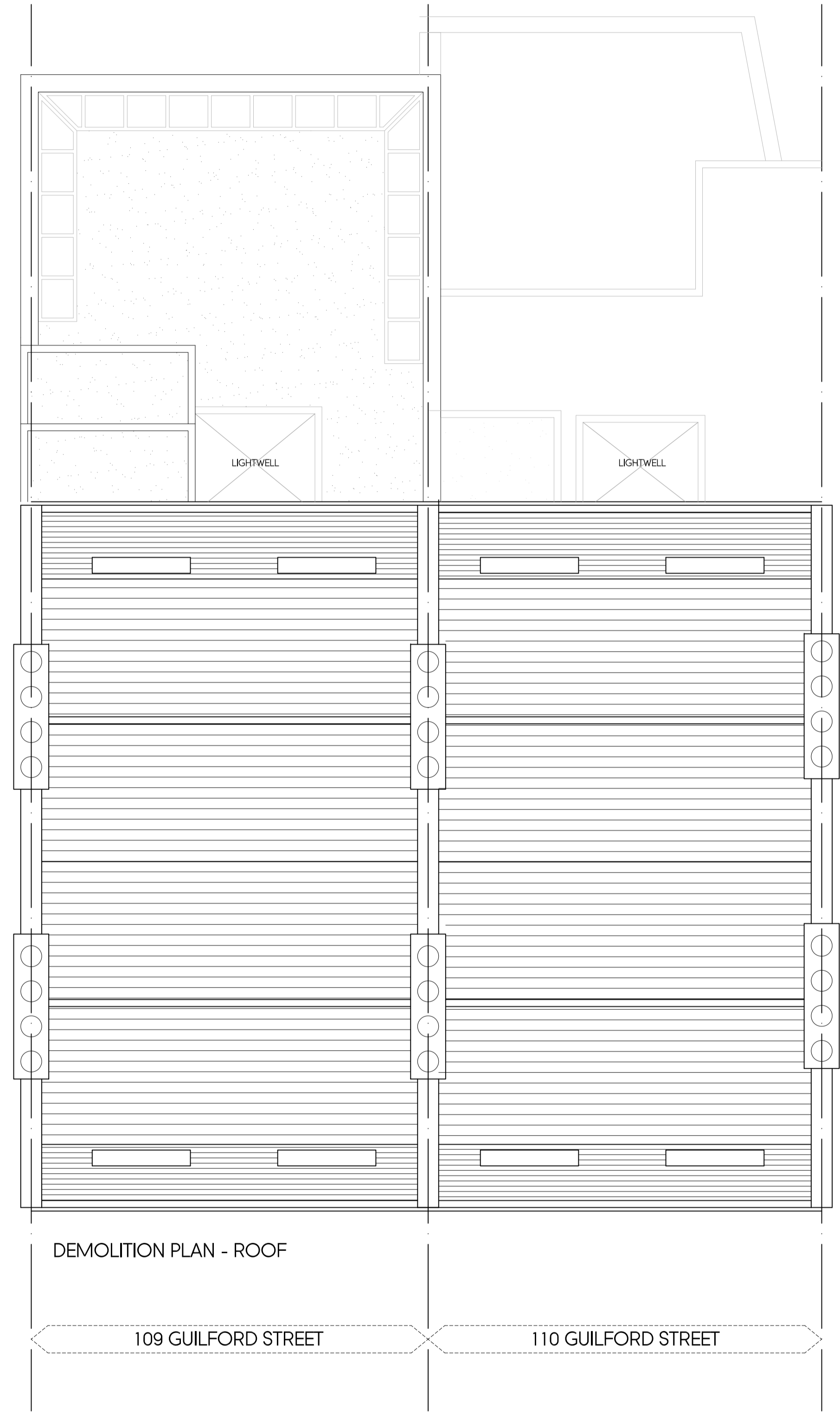

DEMOLITION PLAN - ROOF

109 GUILFORD STREET

110 GUILFORD STREET

Rev	Date	Description	Init.
B	28.02.19	AMENDED TO SUIT PLANNERS COMMENTS	BR
A	07.08.18	AMENDED TO SUIT CLIENT COMMENTS	BR

Client
OCEANIC JEWELLERS

Project Title
PROPOSED EXTENSION & INTERNAL ALTERATIONS

109-110 GUILFORD STREET, LONDON, WC1
Drawing Title

DEMOLITION PLAN - THIRD FLOOR & ROOF

Cad File	Sheet Size	Scale
P004	A1	1:50
Drawn by	Drawing Date	Approved by
BR	MAR 2018	NJ
Project No.	Drawing No.	Revision
1565	P303	B



Argyle House, Joel Street,
Northwood Hill, Middlesex, HA6 1NW
t 01923 840077 f 01923 840078
info@jutla-architects.com
jutla-architects.com

This drawing is property of Jutla Architects Ltd © and must not be copied or otherwise reproduced. All dimensions must be checked on site before commencing work. No dimensions to be scaled from this drawing. This drawing was produced using AutoCad 2016.

PLANNING ISSUE