

CDM NOTE:	Ref	Description of hazard and relevant actions
Refer to 2849-RA-01 for an assessment of all hazards and risks associated with this project. Hazards with a high risk rating specific to this drawing are listed adjacent for ease of reference.		

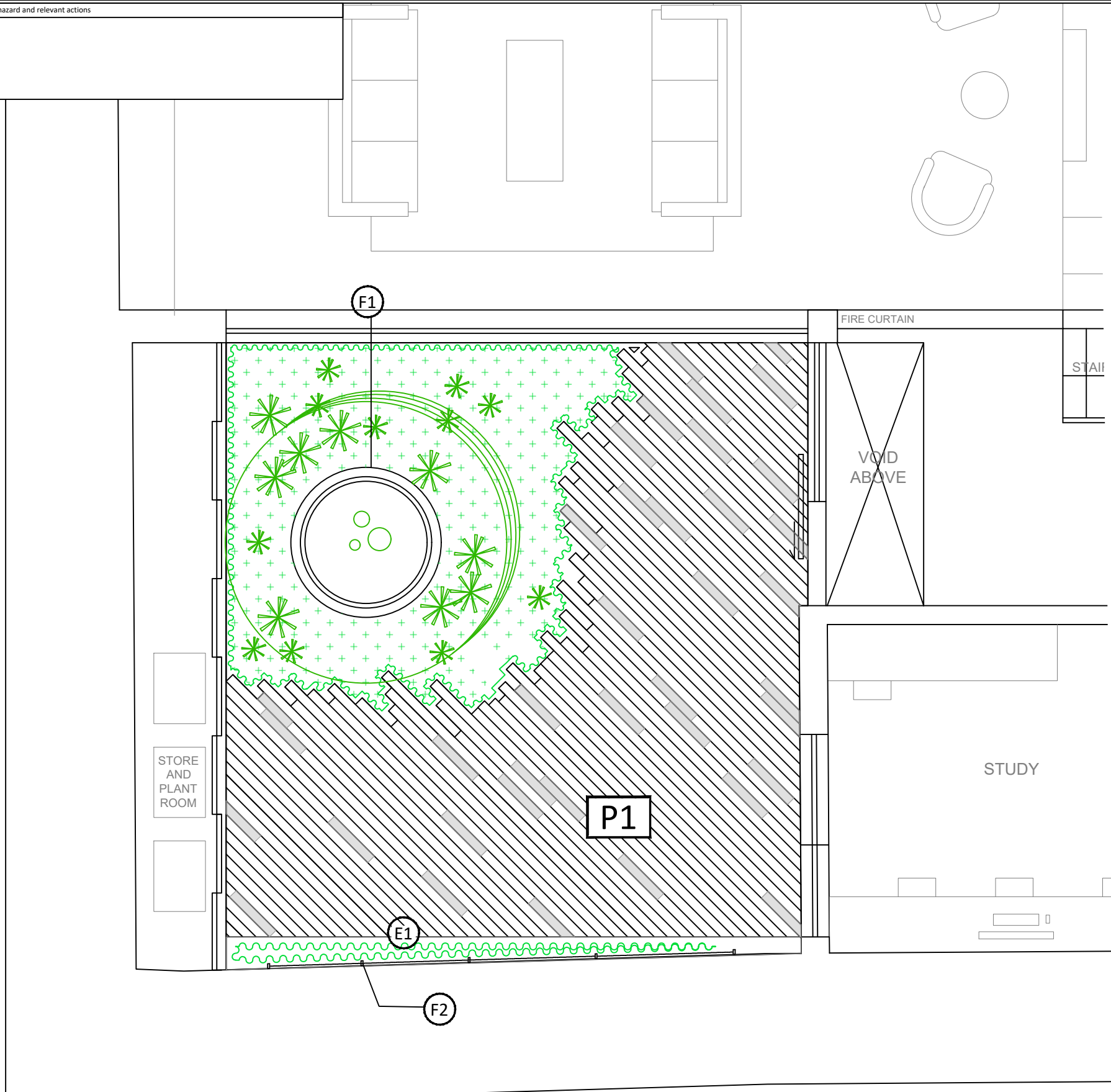

APAL FILE REFERENCE  
2849-LA-01.dwg

Notes  
This drawing is subject to copyright.  
Do not scale from this drawing.  
Based on drawing by RODIC DAVIDSON ARCHITECTS  
Drawing number 0881-P.101

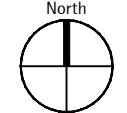

LEGEND

- P1** Marshalls PCC slab 600mm lengths cut to 100mm width with contrasting slab, random staggered bond on 50mm sand base
- E1** Aluminium edging to be AluExcel edge or similar approved. To be fixed to formed concrete foundation race to ensure maximum planting volume.
- F1** Corten steel Globe tree planter produced by Streetlife, product similar or to be approved
- F2** Tensioned Stainless steel climber support to be Brandmeier plant support system by Green Blue Urban or similar approved. To reach within 500mm of top of wall.

Reproduced from the Ordnance Survey Map with the permission of the Controller of Her Majesty's Stationery Office © Crown Copyright  
Allen Pyke Associates Ltd  
Licence No. AL 1000289

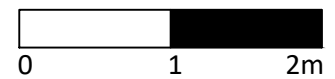

Rev	Description	Date	Drawn	Checked

Drawing Status  
**PLANNING**

**Allen Pyke**  
69A Lensfield Road,  
Cambridge, CB2 1EN  
T 01223 358055  
www.allenpyke.co.uk  
CAMBRIDGE • KINGSTON UPON THAMES  
A registered practice of the Landscape Institute

Client <b>Waxflower Properties Ltd</b>	Scale <b>1:50@A3</b>
Project <b>17 Middlefield London</b>	By/Chk <b>WD/APA</b>
Drawing Title <b>Courtyard Hard Landscape General Arrangement Plan</b>	Date <b>13/03/19</b>
Drawing Number <b>2849-LA-01</b>	Revision <b>*</b>