

14 15 16 17 18 19 20 21

15A 16A 18A 19A 19B 20A

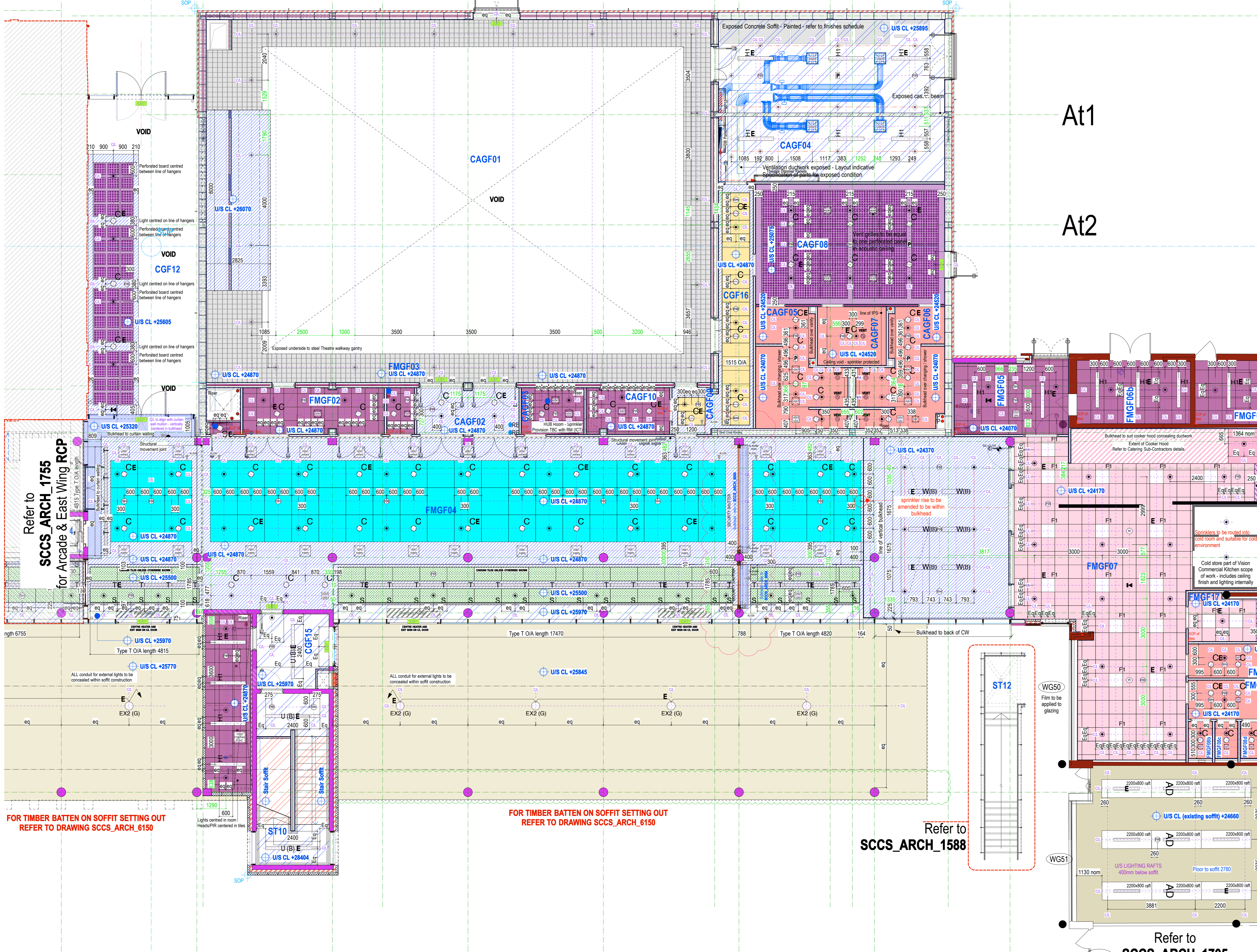

- Ceiling Types:**
- Type 1. K4011 - Kitchen - Hygienic mineral fibre batten with integrated service installations
  - Type 2. K4012 - Suspended mineral fibre tile
  - Type 3A. K4014 - Suspended Bulkhead with demountable high density glass wool acoustic tiles and plasterboard edges (K1021). Contains integrated lighting, emergency lighting and sprinkler systems as required.
  - Type 3B. K4015 - Suspended Acoustic Panels
  - Type 4. M0010 & A & J - Painted concrete soffit - White finish and/or clear concrete sealant as annotated (refer to finishes schedule)  
**NOTE - These concrete soffits to be "Backed Out" - refer to Finishes Schedule**
  - Type 5. K1020 - Moisture resistant suspended plasterboard ceiling (WC's & Wet Spaces)
  - Type 6A. K1023 - MEDBURN MF suspended plasterboard ceiling with access panels as required. Two layers 12.5mm Finesse with 75mm acoustic insulation quilt. Acoustic resistant suspended ceiling. Fire & Acoustic lining. All penetrations and perimeter to be fire & acoustically sealed.
  - Type 6B. K1023 - MEDBURN MF suspended plasterboard ceiling. Built flush to window head soffit to provide clearance to windows. Bulkhead 400mm deep from finished wall face.
  - Type 6C. MEDBURN 15mm Finesse board mechanically fixed to underside of existing ceiling - typically in corridors with adjacent stairs land
  - Type 12. K1023 - Existing ceiling finish to be removed and to be replaced with plasterboard ceiling and level of insulation that follows shape of **PHIBO 2 ONLY**
  - Type 7. Existing concrete soffit. M0010 A & J - Painted concrete soffit - White finish and/or clear concrete sealant as annotated
  - Type 8. H2110 - Timber Lining to External Soffit
  - Type 9. K1020 - Perforated Plasterboard (Quattro 41) - high acoustic absorbance
  - Type 11. K1311 - Suspended acoustic panel
  - Type 13. H10 & H14 - Rooflight - refer to **SCCS\_ARCH\_1406**
  - Type 14. K1020 - Perforated Plasterboard (Rigibone 1023) Suspended Ceiling and plasterboard edges (margin **K1021**)
  - Type 15. K1020 - Plain Plasterboard Suspended Ceiling (**K1021** - Plain Plasterboard ceiling)
  - Type 16. M0116 - Suspended system with demountable high density glass wool acoustic tiles and plasterboard edges (**K1021**)
  - Type 17. P1016 - Mineral fibre with a black tissue facing
  - Type 18. M2014 - External Insulated Rendered Soffit
  - Type 19. M2014 - External Rendered Uninsulated Soffit
  - Type 20. K4017 - Suspended system with demountable acoustic tile area high impact
  - K1012 - Acoustic baffle panels
  - Steel beam at ceiling level concealed within proprietary fire board system (**K1010** or **K1010**)
  - External Insulated Rendered Soffit **M2014**
  - Painted underside of steel deck DARK GREY - RAL colour 7012
  - Painted underside of concrete panels WHITE
  - Line of existing steel to be fire lined to 60 minutes integrity and insulation (Locations are indicative - to be checked on site)
  - Access Panel - Structural Opening 455x455mm, Outside edge of frame 50x50mm
  - Access Panel - Structural Opening 305x305mm, Outside edge of frame 50x50mm
  - Line of exposed sprinkler pipe - Setting out as shown on H&K drawings for sprinkler information
  - Smoke Sensor - Setting out shown above. Refer to Buro Happold Services for specification / type
  - PIR - Setting out shown above. Refer to Buro Happold Services for specification / type
  - Supply / Extract Ventilation - Setting out shown above. Refer to Buro Happold Services for grille specification

- Light Types:**  
For light fitting colours the letter next to the light fitting symbol refers to **Black, White, Grey**
- H1 MVP surface mounted light fitting
  - H2 MVP surface mounted light fitting (awn)
  - K1 Suspended pendant light fitting
  - P Wall mounted adjustable spotlight - dc
  - AD Acoustic baffle light fitting with integrated sprinklers and emergency lighting Whitecroft Life In Escapion Masterstar
  - C IP rated recessed spot light
  - C\* IP rated recessed spot lights with the hood
  - G Ceiling and wall mounted light fitting TYPE G fitting as per BAM in specific locations
  - L1 Linear fluorescent batten light fitting
  - F1 Hygiene Whitecroft hygiene
  - Y Linear recessed luminaire (through fitting)
  - S Batten luminaire behind panels
  - U Wall/ceiling mounted light fitting (Type G replacement)
  - X Over sconcer table - Phase 1 only
  - W Ceiling mounted light fitting (Type G replacement)
  - R Iguzzini Full square BSF2
  - EX2 Casper Die Cast
  - EX11 Product dc
  - EX19 Circular wall mounted light fitting - Ada range
  - E Emergency light fitting requirement

- General Notes**
- Drawing to be read with Buro Happold / Grates layouts for - lighting, ventilation, security, fire, sprinklers, small power & data
- All levels to be checked on site
- All setting out to Architects approval
- Allow for ceiling access panels, as advised by Buro Happold. Setting out to be agreed with Architect.
- Service distribution contained within services void in ceiling build up, unless shown otherwise. All exposed conduit routes to be set out and agreed with Architect. ALL routes are to be equally spaced, minimise crossings, NO cable baskets.
- ALL service penetrations through ceiling to be fire & acoustically sealed. Access panels to also meet same requirements
- Ceiling voids exceeding 800mm clear require sprinkler void protection - reference to be made to Sprinkler specialist
- AD light rats typically contain lighting PIR / smoke / sprinklers - all service routes (cables, conduits, trunking, etc) to be run on top of rat and not ceiling mounted unless agreed with Architect.
- Sprinkler pipe distribution to be over rat unless agreed otherwise with Architect.
- Final Fire Exit Sign
  - Directional Fire Exit Sign to Final Exit
  - Static CCTV Camera
  - Pager system speaker recessed in ceiling
  - PA in circulation installed in ceiling

**GRATTES TO UPDATE AND RE-ISSUE CCTV DRAWINGS - ONCE CCTV LOCATIONS ARE FINALISED RCP DRAWINGS WILL BE UPDATED**

**GRATTES TO ADVISE ON ADDITIONAL ACCESS PANEL REQUIREMENTS AND LOCATIONS**

Refer to **SCCS\_ARCH\_1755** for Arcade & East Wing RCP

Refer to **SCCS\_ARCH\_1588**

Refer to **SCCS\_ARCH\_1705** for Salisbury RCP

FOR TIMBER BATTEN ON SOFFIT SETTING OUT REFER TO DRAWING **SCCS\_ARCH\_6150**

FOR TIMBER BATTEN ON SOFFIT SETTING OUT REFER TO DRAWING **SCCS\_ARCH\_6150**

Refer to **SCCS\_ARCH\_1588**

Refer to **SCCS\_ARCH\_1705** for Salisbury RCP

G	08.01.14	For Construction - Bulkhead to shutters SH30 & SH31
E	22.11.13	For Construction - CAN 143
D	05.08.13	For Construction - External lighting reviewed
C	02.08.13	For Construction - See bubbles
B	05.03.13	For Construction - Setting Out
A	23.10.12	For Construction - See bubbles
		For Construction - Contractors Change 041, Fire signage update BHFEDRA; Gas Vents added
	07.09.12	For Construction

Project: **CAMDEN BSF SOUTH CAMDEN COMMUNITY SCHOOL**  
Theatre / Arts Building - Ground Floor Plan RCP

Date: 07/09/12 Drawing No: **SCCS\_ARCH\_1740**

Scale: 1:75 @ A0

Original Drawing Size: A1 @ 900mm

All Dimensions adjacent to the Medburn & Salisbury Buildings to be checked on site

This drawing is copyright.

Notes:  
Do not scale from drawing. Use figured dimensions only. All dimensions to be checked on site.  
All drawings should be read in conjunction with Structural Engineer's and Services Engineer's documentation.