

Notes:

1. NOT FOR CONSTRUCTION. Do not measure from this drawing. All dimensions to be verified on site. Please note that for any construction, demolition, fitting, installation etc., pricing or costing a detailed survey of the related work is to be taken.
2. This is an indicative proposal only and subject to all statutory requirements. Input will be required from Structural and MEP engineers.

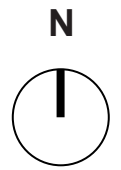

Original entrance to 10 Keats Grove

Existing north east entrance to No 10 Keats Grove feels like a back entrance

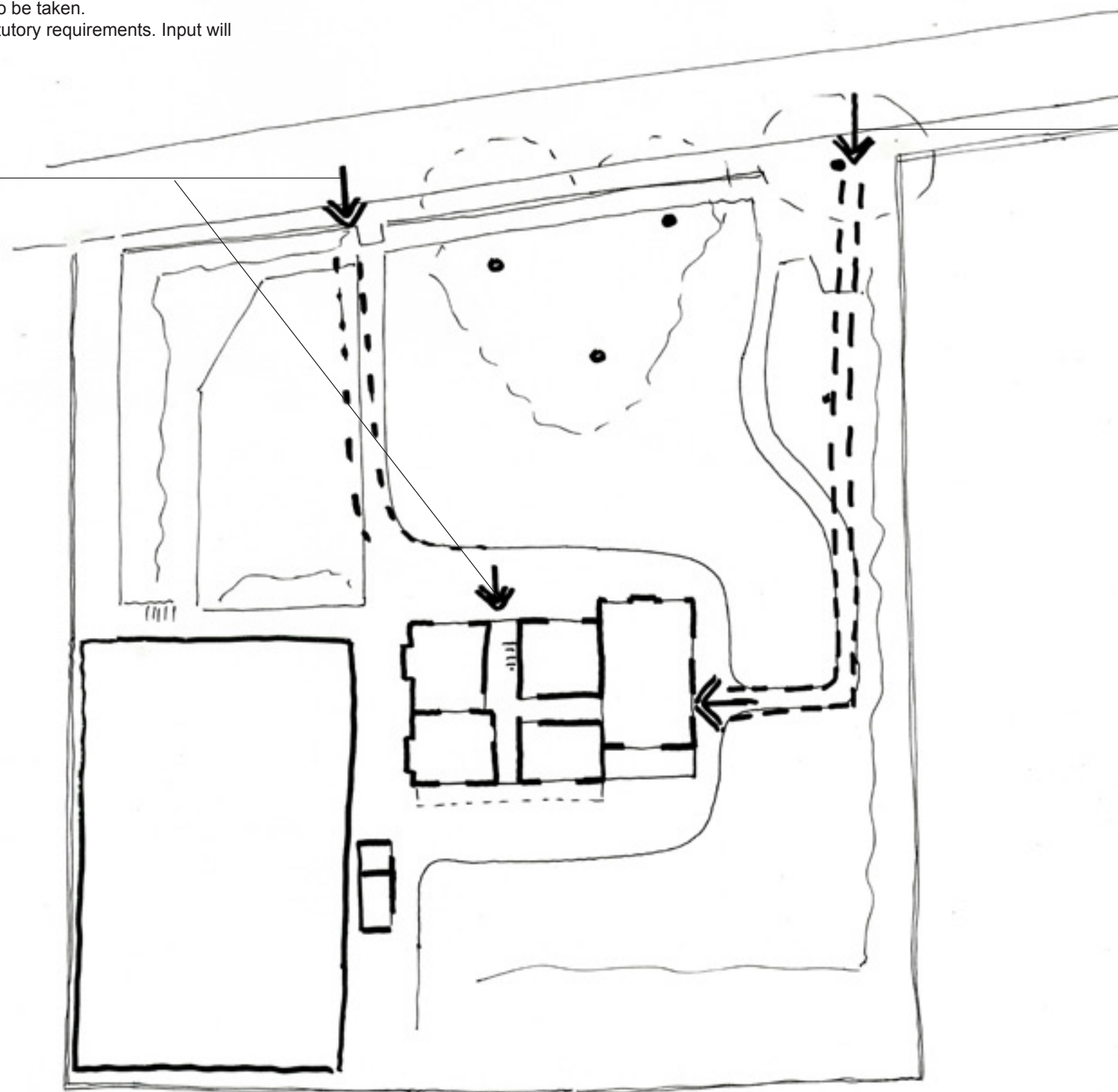

Notes:

1. NOT FOR CONSTRUCTION. Do not measure from this drawing. All dimensions to be verified on site. Please note that for any construction, demolition, fitting, installation etc., pricing or costing a detailed survey of the related work is to be taken.
2. This is an indicative proposal only and subject to all statutory requirements. Input will be required from Structural and MEP engineers.

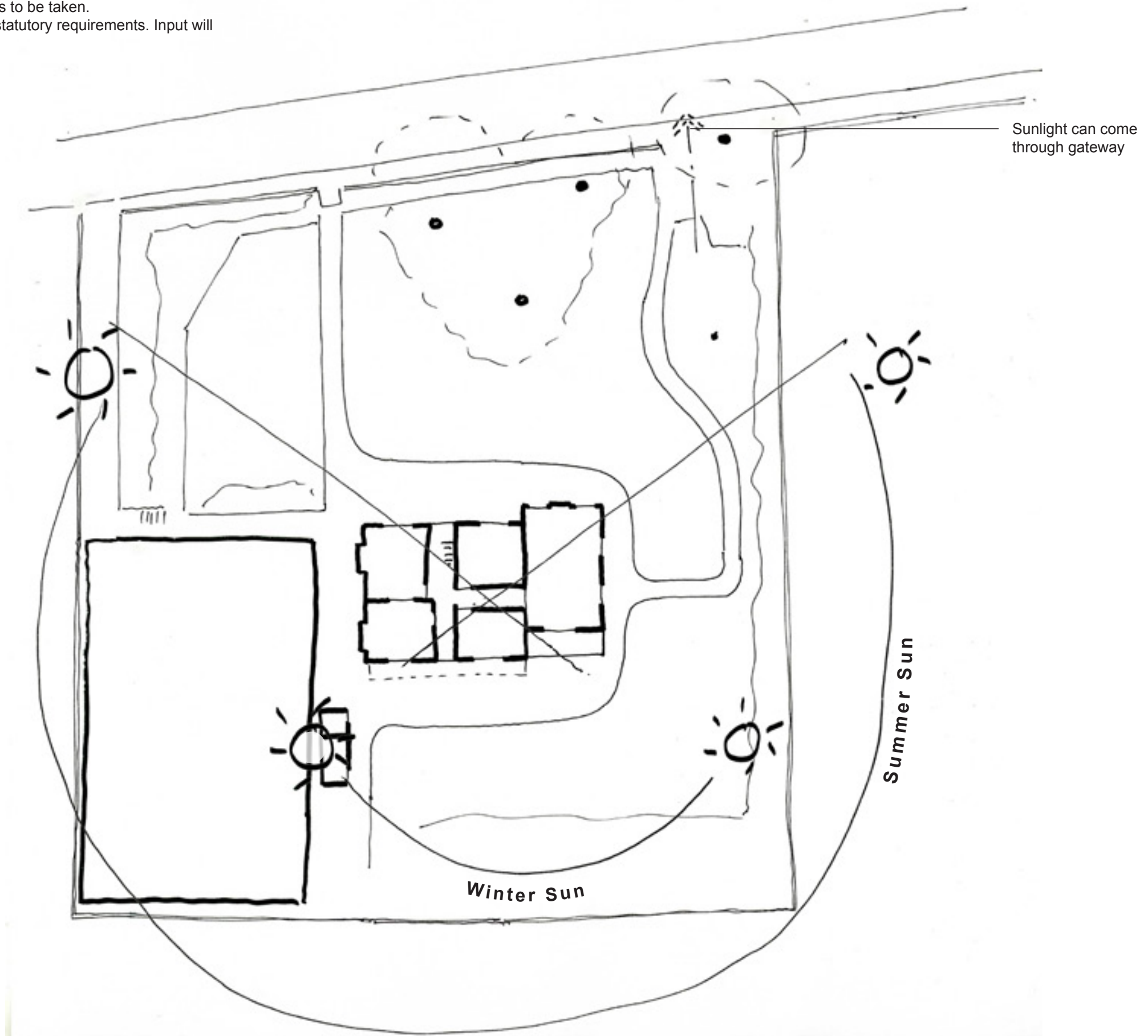
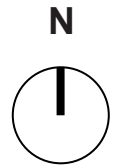

Notes:

1. NOT FOR CONSTRUCTION. Do not measure from this drawing. All dimensions to be verified on site. Please note that for any construction, demolition, fitting, installation etc., pricing or costing a detailed survey of the related work is to be taken.
2. This is an indicative proposal only and subject to all statutory requirements. Input will be required from Structural and MEP engineers.

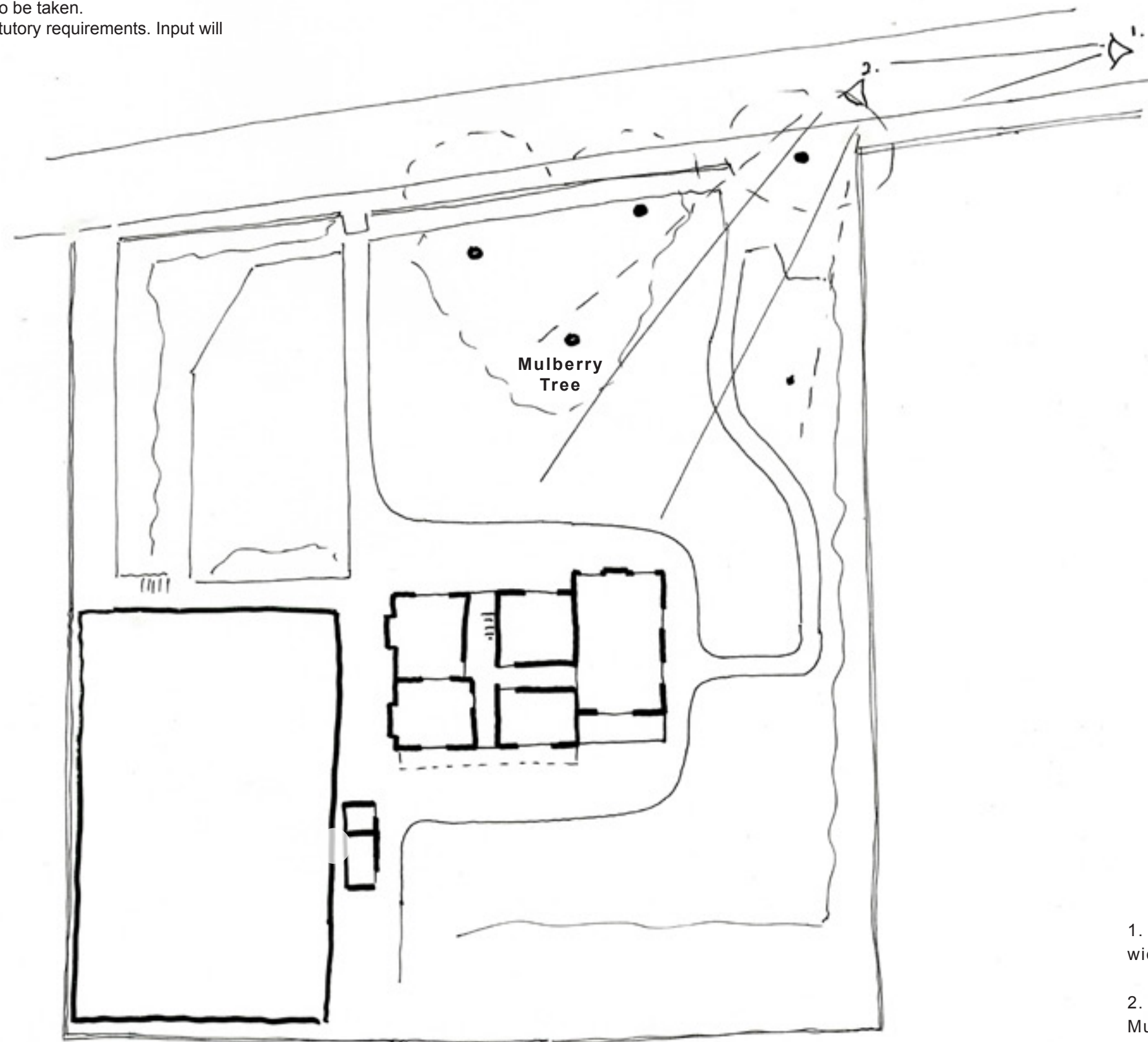
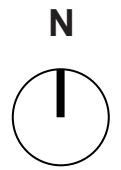

1. Current poor awareness of widest entrance to site.
2. Potential views of house and Mulberry tree through garden.