

This drawing is not to be scaled.
All dimensions to be checked on site.

- REVISION DATE DESCRIPTION
- K 18.11.88 REDRAWN TO COMPLY WITH REVISED SHOPS LAYOUT.
 - L Lift Shaft Modified to Eastons Drg. & Stairs At Lift Positioned to Grid Fl. Slab Hole Celcon Standard Blocks 4/1/89 Nared.
 - M Restaurant Fire Escape Stairs In Modified Position to Suit Slab Hole at Grid Floor 25/1/89
 - N Colorifiers Added to Area Adjacent to Lift Motor Room doors DB/2 & DB/7 Repositioned. 18/2/89
 - O Blockwork, Demolished, Omitted From Contract & New to Clients Instruction to be Cover on A.I. 17/2/89
 - P Doors DB/7 to DB/14 Cancelled DB/2 Enlarged & Repositioned Tank Room Added As Sk 45/1 and I.W.P. Sizes Next to Lift Motor Rm.

FIRE NOTES FOR WHOLE BUILDING

1. Basement structure is 2 hr. fire resistance, upper floors & structure is 1 hr. f.r.
2. Fire exits & warning notices will be provided in accordance with BS 5499 Pt 1 throughout fitted before completion of contract, to the direction of the fire officer.
3. Surface finishes to circulation areas & corridors will be Class 0 rated.

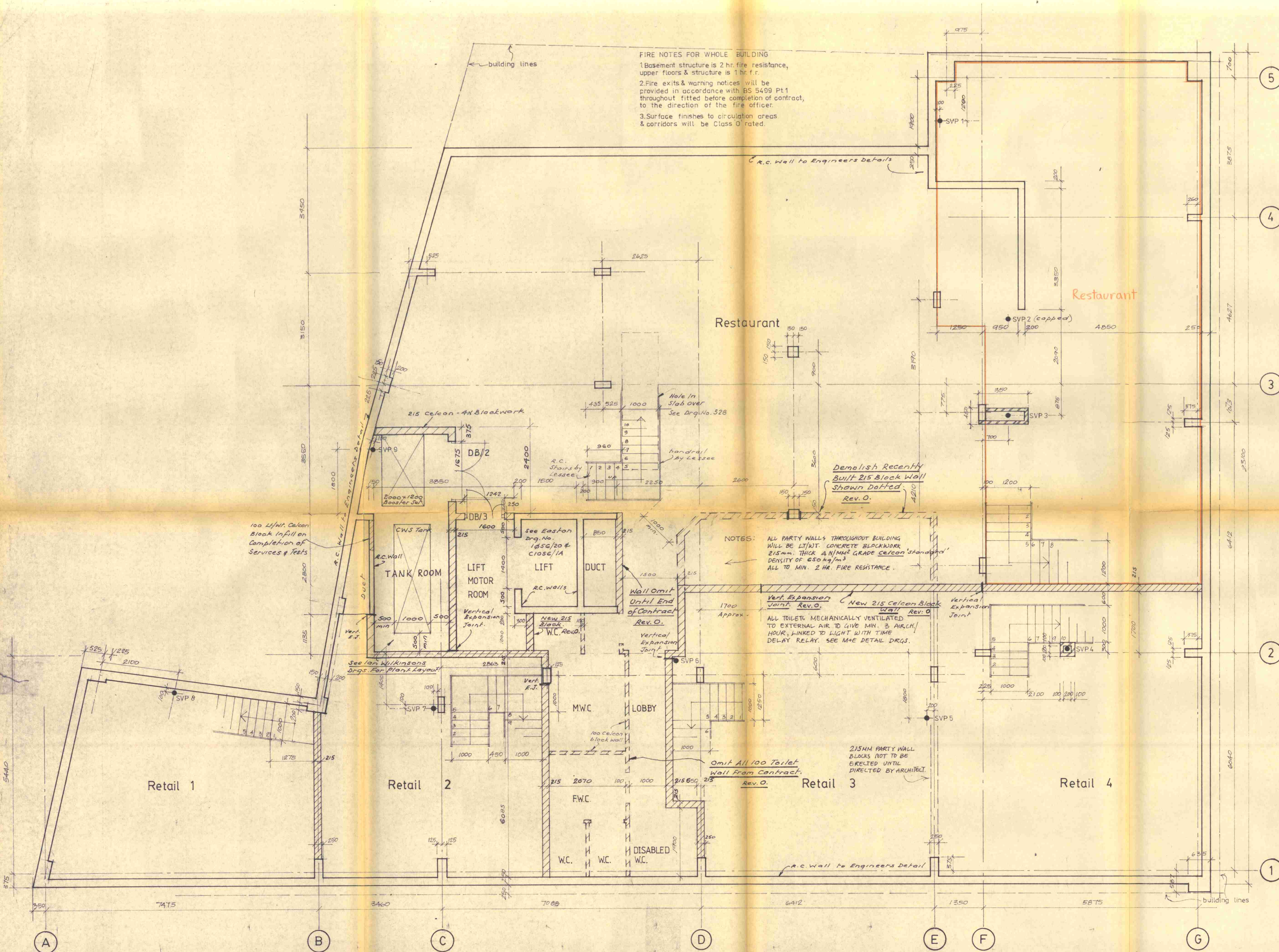

LONDON BOROUGH OF CAMDEN
PLANNING AND TRANSPORT
DEPARTMENT
3-11-88
RECEIVED
TP9000180

For Expansion detail to Block Walls See Drg. No. 500. @ 6cm &
To be read in conjunction with drawing no. 527
For Engineers Drawings Refer to Drg. No. L/8036/A/1 & A/02

SHENSTONE & PARTNERS
ARCHITECTS
DESIGNERS
PLANNERS
SURVEYORS

26 BLOOMSBURY SQUARE LONDON WC1A 3PJ
TEL: 01-636 8595 01-580 6752 FAX: 01-631 5092
INCORPORATING LAURENCE KING & PARTNERS

**BLOOMSBURY STREET
RESIDENTIAL SITE**
Working Drawing

BASEMENT FLOOR AS PROPOSED		
project	5423	515 <i>P</i>
scale	1:50	
date	18 NOV. 1988	
drawn	HPD	

This drawing is not to be scaled.
All dimensions to be checked on site.

- Rev. H: Redrawn and Modified to Comply With Drg. No. 528 & Sx. No. 4. Blockwork Specified. Reference Notes & Dimensions Added. 28/1/88
- Rev. J: Fire Escape to Restaurant Repositioned to Engineers Site Dimension. 24/1/89
- Rev. K: False Facing Column Positions Modified as Sketches 4344 21/1/89
- Rev. L: Plant Room & Bin Store Modified, Plant Shown and Doors Modified. 13/2/89
- Rev. M: Fire escape to restaurant omitted. Vertical expansion joint in brickwork added. steel platform for 20/2/89 plant room tank omitted.
- Rev. N: plant room/bin store wall changed to 150mm thick blockwork. additional dimensions around plant room area & detail A added. 08/05/89
- Rev. P: NOTES ADDED. 15/1/89

LONDON BOROUGH OF CAMB...
PLANNING AND TRANSPORT
DEPARTMENT
3-APR 1990
RECEIVED

Doors Omitted Through
Change of Layout
DG/5, 7,

Allow For Vertical DPCs
At All Reveals & Cavity
Closures in DPC as
Specified in Specification.
Insulate Cavity With Sawn
Drier as Specification
Note:

Read in Conjunction With
Drg. No. 525 for Paving
Layout, and Drg. No. 528 for
Holes Through Ground Floor.

All Party Walls to be 215mm
Celcon Standard Blocks.
4mm² Built Fair Faced With
Flush Marker Joints.
Finishes by Lessee.

TP9000180

SHENSTONE
& PARTNERS
ARCHITECTS
DESIGNERS
PLANNERS
SURVEYORS

26 BLOOMSBURY SQUARE LONDON WC1A 2PJ
TEL: 01-636 8595 01-580 6752 FAX: 01-631 5092
INCORPORATING LAURENCE KING & PARTNERS

BLOOMSBURY STREET
RESIDENTIAL SITE
Working Drawing

GROUND FLOOR PLAN

project	5423	516
scale	1:50	
date	25.11.88	
drawn	LS	

SCALE: REPROGRAPHIC

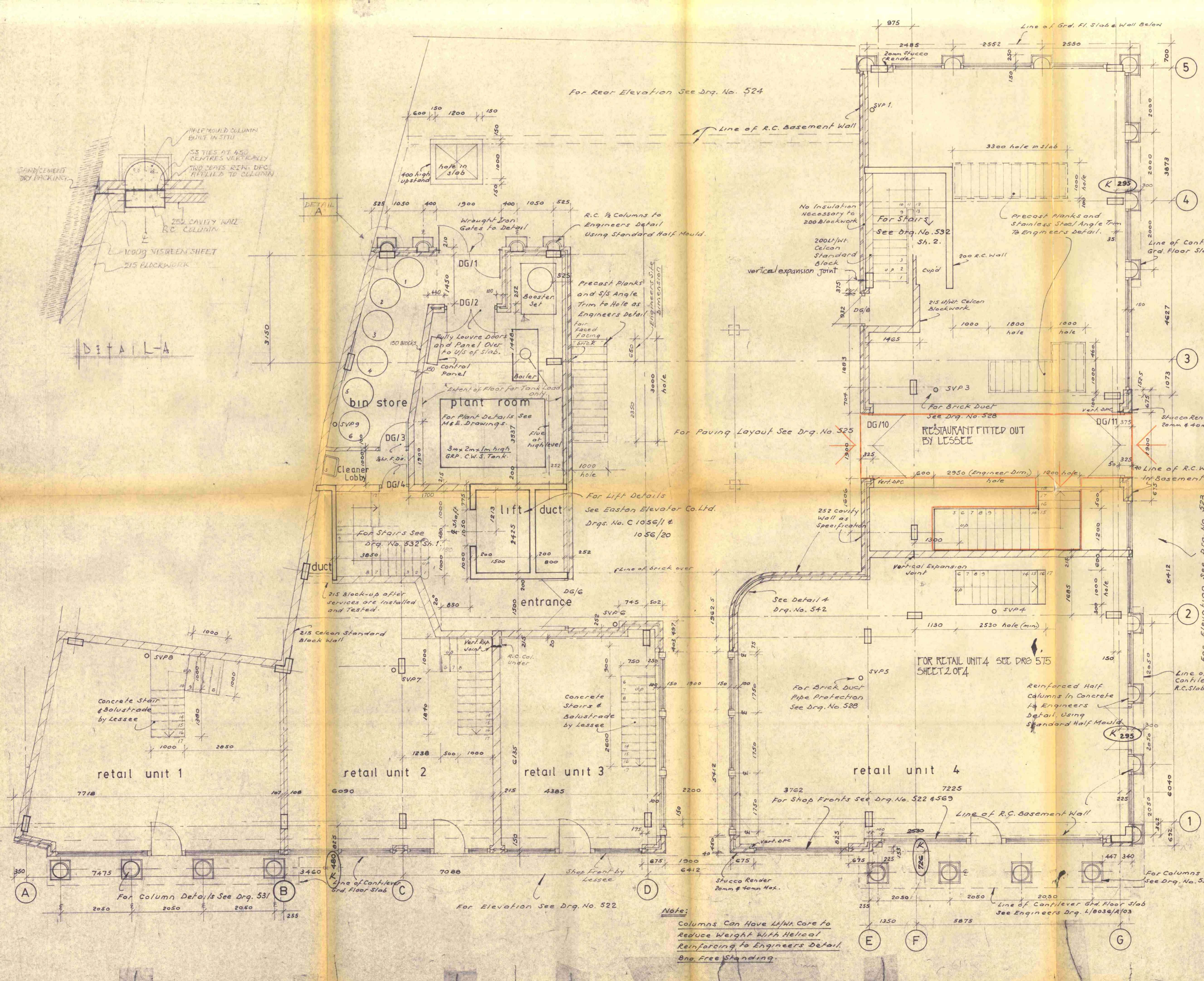

For Rear Elevation See Drg. No. 524

Line of R.C. Basement Wall

For Paving Layout See Drg. No. 525

For Lift Details
See Easton Elevator Co. Ltd.
Drgs. No. C 1056/1 &
1056/20

See Detail 4
Drg. No. 542

For Brick Duct
Pipe Protection
See Drg. No. 528

For Shop Fronts See Drg. No. 522 & 569

FOR RETAIL UNIT 4 SEE DRG 575
SHEET 2 OF 4

For Elevation See Drg. No. 522

Note:
Columns Can Have L/Wth Core to
Reduce Weight With Helical
Reinforcing to Engineers Detail.
One Free Standing.

For Elevation See Drg. No. 523

For Columns
See Drg. No. 531

Line of Cont./lev. Gd. Floor Slab
See Engineers Drg. L/8036/A/03

this drawing is not to be scaled.
all dimensions to be checked on site.

REVISION A
REVISED ELEVATION

LEGEND:
B - BRICKWORK

S - STUCCO SURFACES.

GRP - GLASS REINFORCED PLASTIC
HODKIN & JONES CODE F105
PROJECTION 90mm
DEPTH 200mm

REVISION B 25.10.88
REVISED TO SUIT DETAILS.

REV C 9.11.88
SPECIAL BRICKS ADDED

REVISION D 16.2.89
NOTES ON FINISHES ADDED
LINES OF HORIZONTAL EXPANSION JOINTS ADDED.
1/4" ANGLE IS FIXED AT MID-SLAB.
RAIN WATER PIPES ADDED.
VERTICAL EXPANSION JOINTS ADDED.
PARAPET WALLS REDRAWN.



LONDON BOROUGH OF CAMDEN
PLANNING AND TRANSPORT
DEPARTMENT
3 - APR 1990
RECEIVED

NOTE
BOTTOM OF SLAB
JUNCTIONS WITH RAIN WATER PIPES: LEAVE 50 MM
GAP IN G.R.P. MOULDING.
40 MM STUCCO COURSE TO BE
20 MM THICK X 150 MM WIDE
BEHIND R.W.P. ON ALL ELEVATIONS.
123456 TYPES OF SPECIAL BRICKS
DWG. REF. 530
40mm STUCCO ON S/S E.M.L.
TO SPECIALIST DETAIL
TPY000180

GERALD
SHENSTONE
AND
PARTNERS ARCHITECTS

28 BLOOMSBURY SQUARE WC1A 2PJ
01 636 8595

BLOOMSBURY STREET
RESIDENTIAL SITE
Working Drawing

STREATHAM ST. ELEVATION

PROPOSED ENTRANCE
TO RESTAURANT

project	5423	523 D
scale	1:50	
date	MAY 88	
drawn	AFJ	