

General notes:
 This drawing is copyright of KSR architects. This drawing must be read in conjunction with the Designer's Risk Assessment, specification and all other relevant documentation and drawings. KSR architects accept no liability for any expense, loss or damage of whatsoever nature and however arising from any variation made to this drawing or in the execution of the work to which it relates which has not been referred to them and their approval obtained.
 Do not scale from this drawing or the digital data, only figured dimensions are to be used. For Planning refer to linear scale. Check all dimensions on site prior to carrying out any works - advise of any discrepancy

Notes/Legends

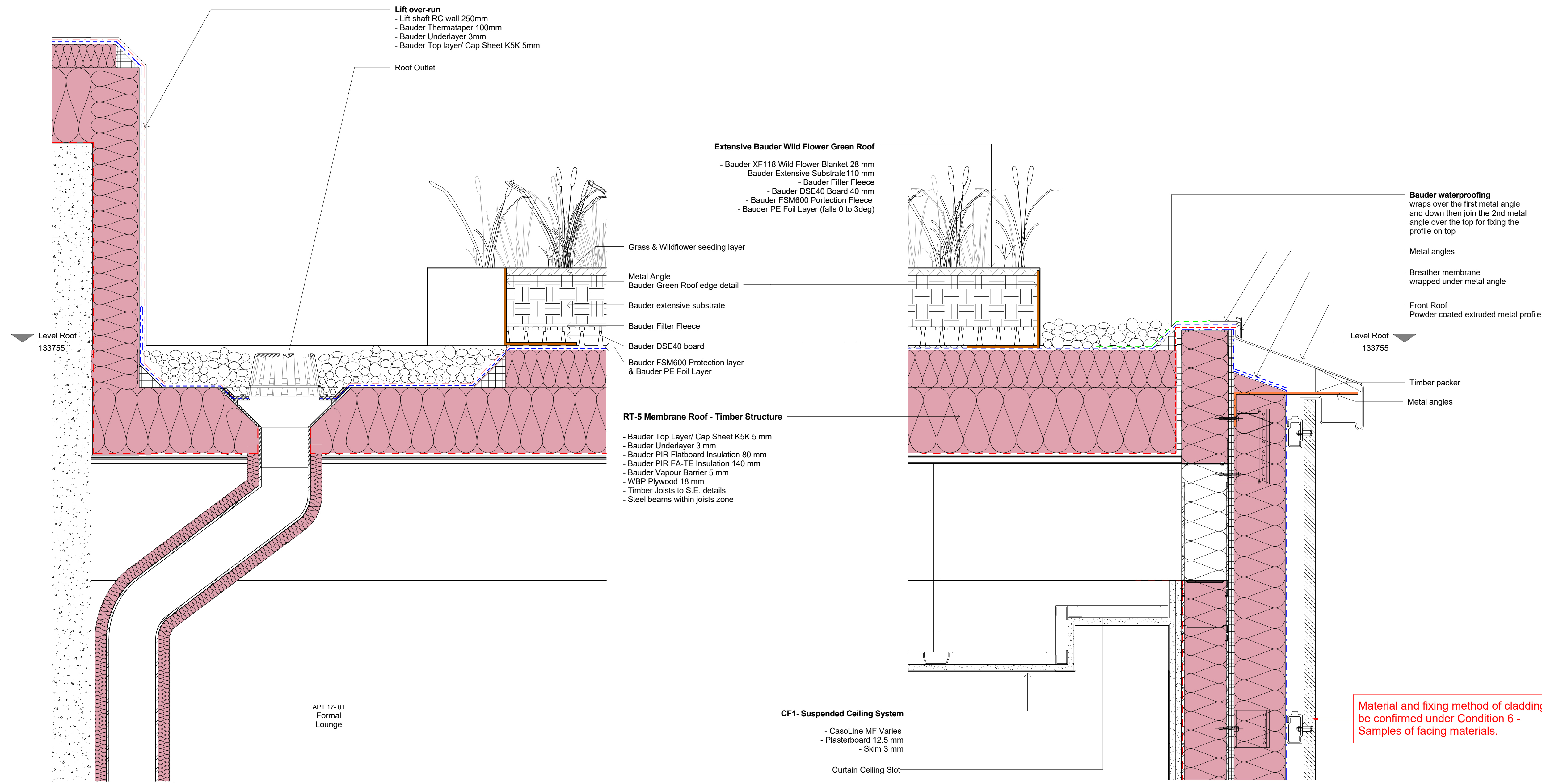

1 GREEN ROOF EDGE - DRAIN DETAIL
 1 : 5

2 GREEN ROOF EDGE - SLATE FACADE DETAIL
 1 : 5

1000
500
250
0 mm

B	Planning conditions	28 Feb 19	SAS
A	Detail Planning Details Sign-off	09 Jan 19	EB
Rev	Description	Date	Chd
© KSR architects			
Stamp			
Planning			
Key Plan			
<p style="color: red; border: 1px solid red; padding: 2px;">Material and fixing method of cladding to be confirmed under Condition 6 - Samples of facing materials.</p>			
<p>KSRARCHITECTS KSR Architects LLP mail@ksrarchitects.com 14 Greenleaf Street t +44 (0)20 7692 5000 London NW9 0ND www.ksrarchitect.com</p>			
<p>Project: 29 NEW END</p>			
<p>Title: Typical Roof Details 2</p>			
Date:	12/2/18	Drawn By:	Authd
Scale:	1:5 @ A1	Status:	Planning
Project Ref:	NEN	Drawing No:	NEN - PL-4-311.1
Revision:		Checked:	B