

**Schueco- External Doors**  
 Schueco- AWS 75 SI Window system refer to KSR PL-4-XXX and 8-XXX series for details, sizes and locations  
 Powder Coated Metal to a bronze finish

APT 07- 04  
 Master  
 Bedroom

**F-3 Separating Floor - Timber Finish**  
 - Engineered Timber Boards 20 mm  
 - Adhesive bed 5 mm  
 - Sand / cement Screed with UFH to M&E spec. 75 mm  
 (Screed: mass per unit area 80 kg/m<sup>2</sup>)  
 - Rigid insulation to M&E specification 40 mm  
 - Acoustic mat 10 mm

Lateral Design threshold drain  
 Threshold drain Aqaulevel CT1  
 Visqueen  
 To be installed on site to manufacturers details.

Level 1 First FFL  
 116680

Metal angle  
 Metsec upstand with insulation

In situ reinforced concrete floor 250 mm

**EPDM**  
 To be attached to the window in the factory, ready for installation on site. To manufacturers details. The space Behind the EPDM is to be filled with insulation.

**Metsec Structural Angle**  
 1  
 4-759

16 mm plywood  
 Insulation

APT 01- 01  
 Living

Schueco- AWS 75 SI Window system refer to KSR PL-4-XXX and 8-XXX series for details, sizes and locations  
 Powder Coated Metal to a bronze finish

XD 01 13  
 Type 02

XD G 08  
 Type 02

Powder coated MS railings

**F-13 Balcony**  
 - Stone paving slabs 20mm (laid flat, open joints)  
 - Paver supports - Bauder DPH min 17 mm (39 mm shown)  
 - Bauder Top Layer / Cap Sheet 15 mm  
 - Bauder Underlay  
 - Screed (laid to falls) min 6 mm (46 mm shown)

In situ reinforced concrete floor 150 mm

Cementitious render

Catnic Single Leaf Lintel (only 1 brick available for each lintel).

Cast Stone Coping / Fascia/ Terrace openings

**ExW1 Cavity Wall**  
 - Facing Brickwork 102.5 mm  
 - Cavity 50 mm  
 - Thermal Insulation Celotex GA4000 100 mm  
 - Breather Membrane  
 - Cementitious board lining 12 mm  
 - Metal C Studs to S.E. Details 100 mm (Metsec or similar)  
 - Thermal Insulation mineral wool between studs 100 mm  
 - Vapour control layer  
 - LW3 lining type

**General notes:**  
 This drawing is copyright of KSR architects. This drawing must be read in conjunction with the Designer's Risk Assessment, specification and all other relevant documentation and drawings. KSR architects accept no liability for any expense, loss or damage of whatsoever nature and however arising from any variation made to this drawing or in the execution of the work to which it relates which has not been referred to them and their approval obtained.  
 Do not scale from this drawing or the digital data, only figured dimensions are to be used. For Planning refer to linear scale. Check all dimensions on site prior to carrying out any works - advise of any discrepancy

**Notes/Legends**

B	Planning conditions	28 Feb 19	SAS
A	Detail Planning Details Sign-off	09 Jan 19	JB
Rev	Description	Date	Chd

© KSR architects

Stamp  
**Planning**

Key Plan

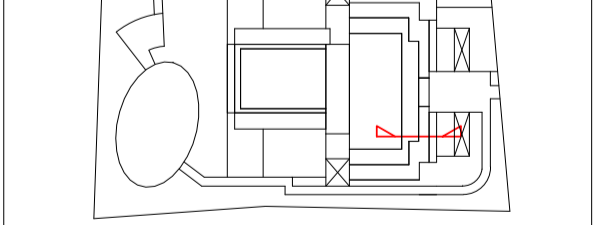

**KSRARCHITECTS**  
 KSR Architects LLP  
 14 Greenland Street  
 London NW10 0ND  
 Email: info@ksrarchitects.com  
 Tel: +44 (0)20 7692 5000  
 Website: www.ksrarchitects.com

Project  
**29 NEW END**

Title  
**Section E Details 1-1**

Date:	12/19/18	Drawn By:	Autho	Checked:	Checke
Scale:	1:5 @ A1	1:10 @ G1	Status:	Planning	

Project Ref:	29NEN	Drawing No:	NEN - PL-4-150.1	Revision:	B
--------------	-------	-------------	------------------	-----------	---

**R** **DIAGRAM SECTION E - SOUTH**  
 1 : 50

**1** **1F BALCONY**  
 1 : 5

