

Schueco- External Doors
Schueco- AWS 75 SI BS Window system refer to KSR PL-4-XXX and 8-XXX series for details, sizes and locations. Powder Coated Metal to a bronze finish

Door with blanking panel and insulated wall lining to internal face

APT 13- 02
Kitchen

XD 03 06
Type 01B

Lateral Design threshold drain
Threshold drain Aqaulevel CT1
Metsec upstand with insulation
Visqueen
To be installed on site to manufacturers details.

Level 3 Third Floor
123430

Metal Angle

In situ reinforced concrete floor 250 mm
Minimum density 2400 Kg/cm³

ExW6 Insulated Render on MetSec (Recessed balconies)
- Sto Render 20mm
- Sto EPS K90 100 mm
- Sheathing board (non combustible) 12 mm
- Thermal Insulation mineral wool between studs 100 mm
- 100 metal C Studs to S.E. Details 100 mm (Metsec or similar)
- Vapour Control Layer
- LW3 lining type

12 mm plywood
Insulation
EPDM
To be attached to the window in the factory, ready for installation on site. To manufacturers details.

APT 11- 02
Kitchen

Schueco- External Doors
Schueco- AWS 75 SI BS Window system refer to KSR PL-4-XXX and 8-XXX series for details, sizes and locations. Powder Coated Metal to a bronze finish

Door with blanking panel and insulated wall lining to internal face

XD 02 04
Type 01B

8

Powder coated MS railings

APT 13- E01
Terrace 1

F-13 Balcony

- Stone paving slabs 20mm (laid flat, open joints)
- Paver supports - Bauder DPH min 17 mm (39 mm shown)
- Bauder Top Layer / Cap Sheet 15 mm
- Bauder Underlay
- Screed (laid to falls) min 6 mm (46 mm shown)

In situ reinforced concrete floor 250 mm

In situ reinforced concrete floor 150 mm

APT 11- E01
Balcony

Cementitious render

Cast Stone Coping / Fascia/ Terrace openings

Weather seal

Air extract

General notes:
This drawing is copyright of KSR architects. This drawing must be read in conjunction with the Designer's Risk Assessment, specification and all other relevant documentation and drawings. KSR architects accept no liability for any expense, loss or damage of whatsoever nature and however arising from any variation made to this drawing or in the execution of the work to which it relates which has not been referred to them and their approval obtained.
Do not scale from this drawing or the digital data, only figured dimensions are to be used. For Planning refer to linear scale. Check all dimensions on site prior to carrying out any works - advise of any discrepancy

Notes/Legends

B Planning conditions 28 Feb 19 SAS
A Draft Planning Details Sign-off 09 Jan 19 JB

Rev Description Date Chd

© KSR architects

Stamp

Planning

Key Plan

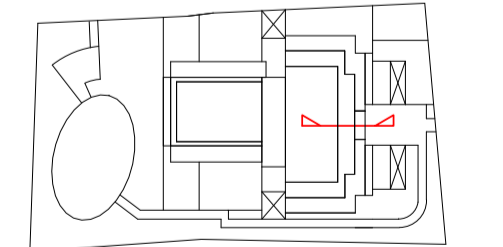

KSRARCHITECTS
KSR Architects LLP mail@ksrarchitects.com
14 Greenland Street t +44 (0)20 7692 5000
London W9 0ND www.ksrarchitects.com

Project
29 NEW END

Title
Section C Details 3

Date: 12/19/18 Drawn By: Author Checked: Checker

Scale: 1:5 @ A1 110mm Status: Planning

Project Ref: Drawing No: Revision:

NEN NEN - PL-4-132.1 B

DIAGRAM SECTION C - SOUTH
1 : 50

3F BALCONY DETAIL 1
1 : 5

