



289-293
HIGH
HOLBORN

294-295
HIGH
HOLBORN

303-306
NORTHUMBERLAND
HOUSE

1 0420 0240-Ground
1:100

KEY

- Office
- WCs
- Reception
- Retail
- UKPN
- Fire Control

PLANNING

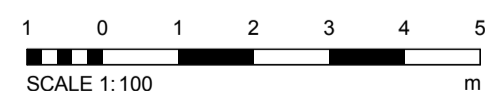
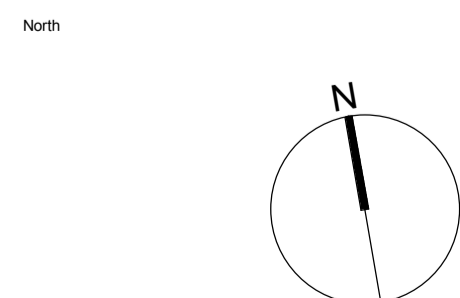
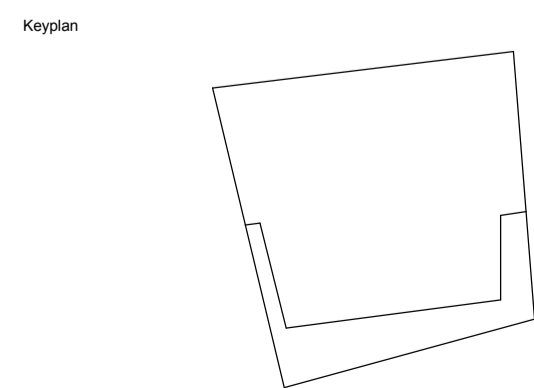

No.	Revision	Date	Initial	Chk'd
7	Revised LIR	17.01.19	JC	JC
6	PLANNING ISSUE	28.02.18	BH	BH
5	PRE-APP 3 Issue	21.02.18	BH	AB
4	PRE-APP 2 Issue	17.02.17	BH	BH
3	Plans updated to reflect MEP and layout changes	09.01.17	BH	BH
2	Revised facade updated to reflect ICE comments	05.12.16	BH	BH
1	Plans Updated following Planners feedback	29.11.16	BH	BH

17-Jan-19 11:39:59 AM

- Notes:
1. Do not scale
 2. Contractor to Check all dimensions and report omissions and errors to the Architect
 3. EPR Architects accepts no liability for use of this drawing by parties other than the party for whom it was prepared or for purposes other than those for which it was prepared.
 4. This drawing is issued in dwg/dgn format as an uncontrolled version to enable the recipient to prepare their own documents/drawings/models for which they are solely responsible. This drawing is based on project information current at the time of issue. EPR Architects Limited accepts no liability for any alterations or additions to or discrepancies arising out of any change to such project information that occurs to the information after it is issued by EPR Architects Limited.
 5. This drawing does not contain shared coordinates and is not issued for coordination purposes.

EPR architects
30 Millbank
London SW1P 4DU
+44 (0) 20 7932 7600
www.epr.co.uk

Lincoln House
296-302 High Holborn
WC1V-7JH London

Proposed Ground Plan

Project No	Originator	Zone	Level	Type	Role	Number	Rev
10323-EPR-00	GF	DR	A	0240		7	