

WB-6
Double Glazed Walk-on Rooflight with 3 no. wall abutments.

1. This drawing is not for construction. Do not scale from this drawing.
 2. It is the contractor's responsibility to ensure that design principles, calculations, drawings and final construction must conform to the current building regulations, the CDM regulations and the relevant british or european codes of practice as appropriate.
 3. The contractor must verify all site dimensions, drawings, details and specifications and report any discrepancies to the architect before proceeding with any work.
 4. All specified items are to be installed in accordance with the manufacturer's recommendations.
 5. The drawing is to be read in conjunction with the other relevant consultants drawings.
 6. This drawing is copyright of the architect.

Revision		Date
A	DOC Issue	28.02.19

**prewett
bizley
architects**

118a London Wall London EC2Y 5JA 020 7256 2195
 rp@prewettbizley.com www.prewettbizley.com

Project
**39 Great James Street
 London
 WC1N 2LF**

Drawing Window Schedule - Rooflight WB-6	
Scale 1:20 @ A3 1:10 @ A1	Date Oct 2018
Dwg. no. 125 L 45	Revision A

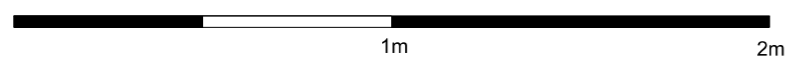

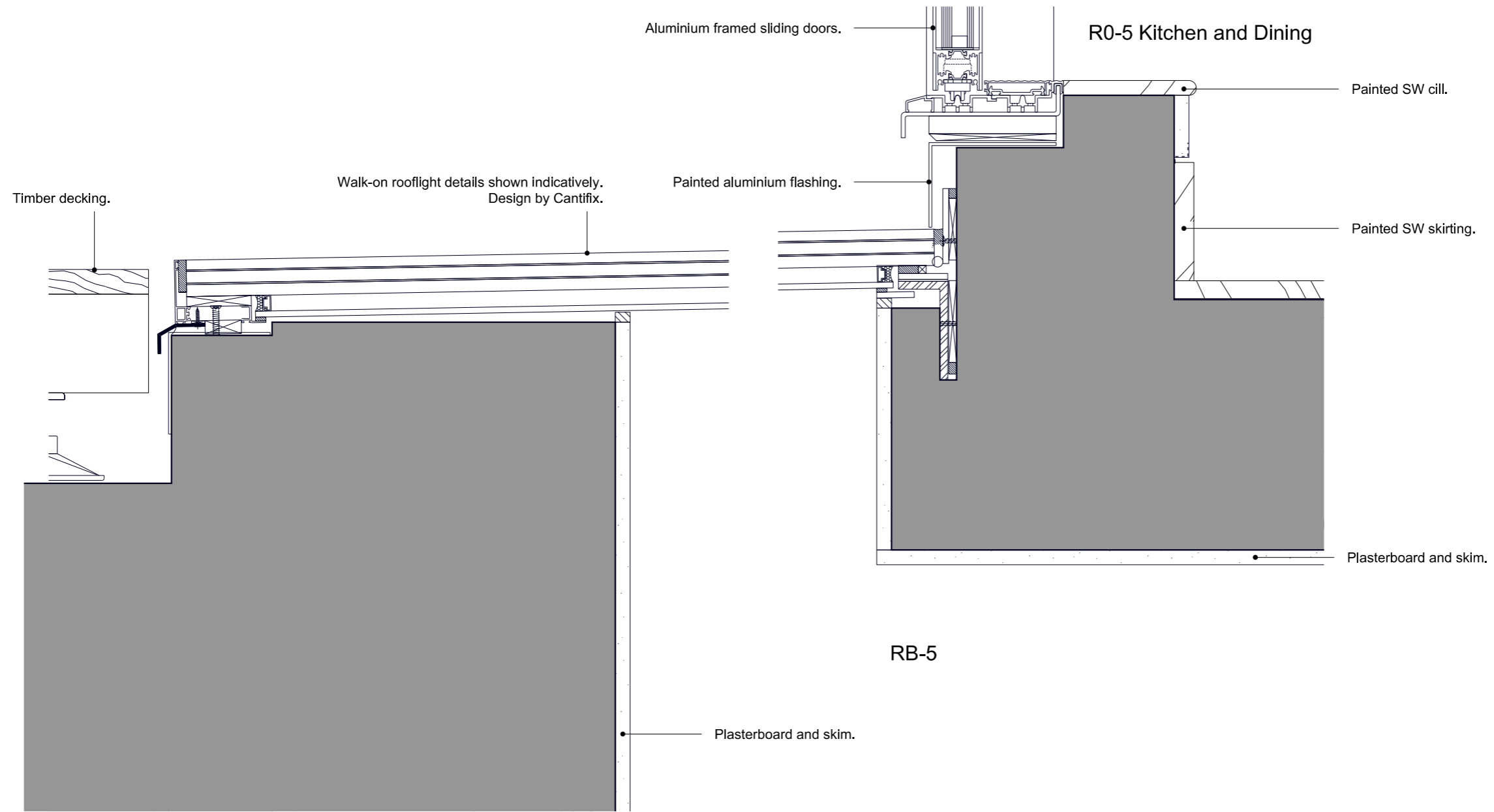

1. It is the contractor's responsibility to ensure that design principles, calculations, drawings and final construction must conform to the current building regulations, the CDM regulations and the relevant British or European codes of practice as appropriate.
2. The contractor must verify all site dimensions, drawings, details and specifications and report any discrepancies to the architect before proceeding with any work.
3. All specified items are to be installed in accordance with the manufacturer's recommendations.
4. The drawing is to be read in conjunction with the other relevant consultant drawings.
5. This drawing is copyright of the architect.

Drawing Status:

Planning

Revision	Date

prewett
bizley
architects

118a London Wall, London EC2Y 5JA
rp@prewettbizley.com 020 7256 2195
www.prewettbizley.com

Project
39 Great James Street
London
WC1N 3HB

Drawing
Walk-on Rooflight WB-6 Rear
Elevation Details

Scale
1:5 @ A3 Date
July 2018

Dwg. no.
125 D 50 Revision
-

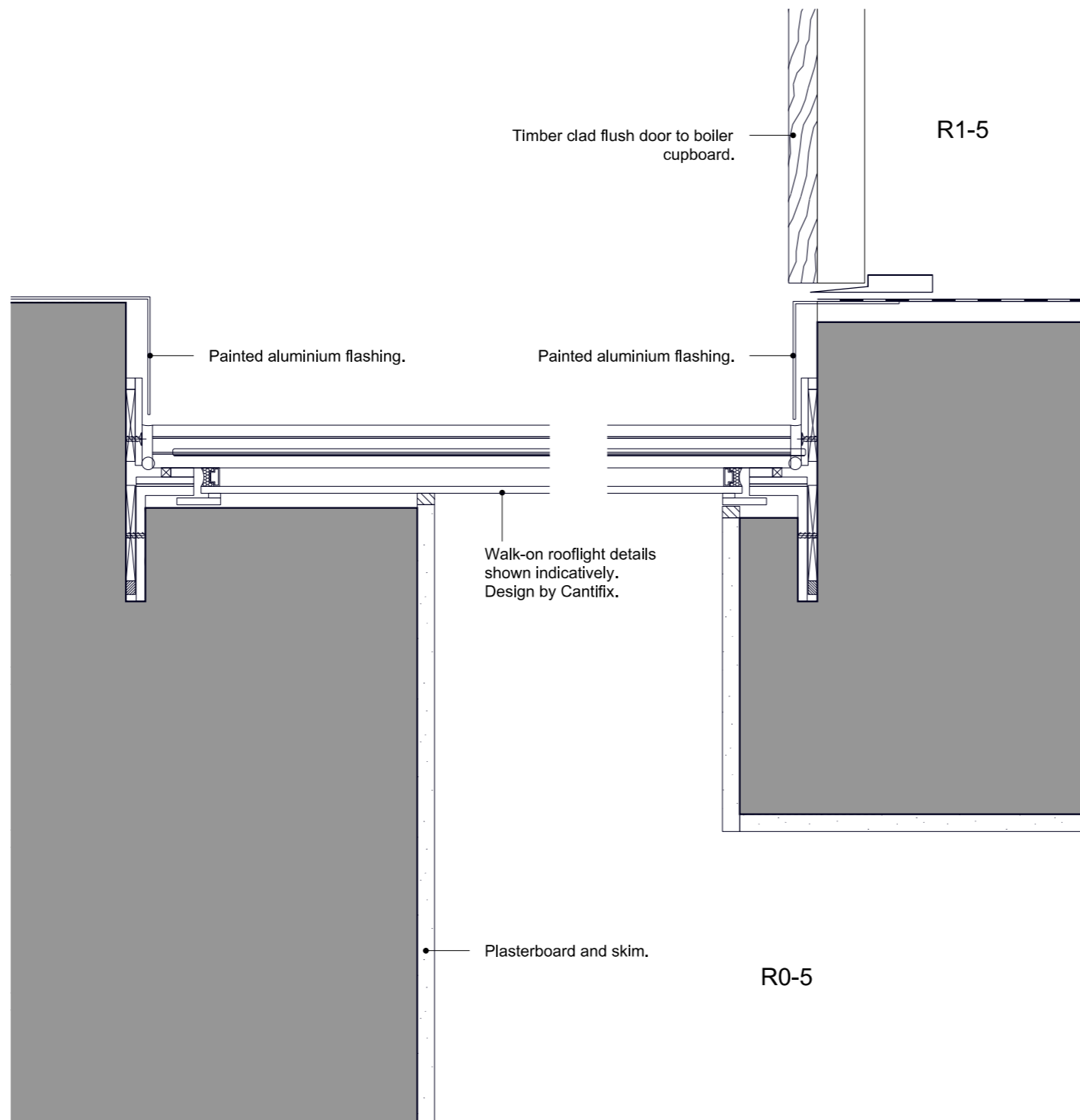

1. It is the contractor's responsibility to ensure that design principles, calculations, drawings and final construction must conform to the current building regulations, the CDM regulations and the relevant British or European codes of practice as appropriate.
2. The contractor must verify all site dimensions, drawings, details and specifications and report any discrepancies to the architect before proceeding with any work.
3. All specified items are to be installed in accordance with the manufacturer's recommendations.
4. The drawing is to be read in conjunction with the other relevant consultants drawings.
5. This drawing is copyright of the architect.

Drawing Status:
Planning

Revision	Date

**prewett
bizley
architects**

118a London Wall, London EC2Y 5JA
rp@prewettbizley.com

020 7256 2195
www.prewettbizley.com

Project
**39 Great James Street
London
WC1N 3HB**

Drawing
**Walk-on Rooflight WB-6 Party
Wall Details**

Scale 1:5 @ A3	Date July 2018
--------------------------	--------------------------

Dwg. no. 125 D 51	Revision -
-----------------------------	----------------------

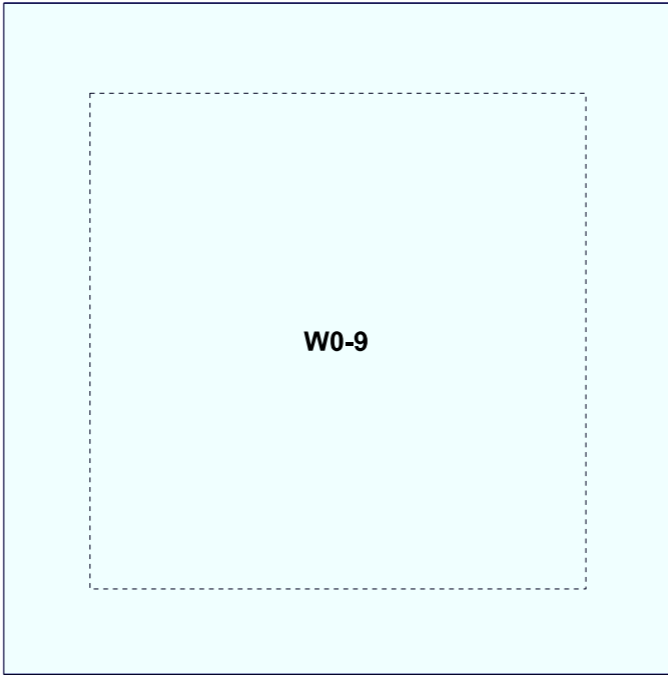

W0-9
Double Glazed Venting Rooflight.

1. This drawing is not for construction. Do not scale from this drawing.
 2. It is the contractor's responsibility to ensure that design principles, calculations, drawings and final construction must conform to the current building regulations, the CDM regulations and the relevant british or european codes of practice as appropriate.
 3. The contractor must verify all site dimensions, drawings, details and specifications and report any discrepancies to the architect before proceeding with any work.
 4. All specified items are to be installed in accordance with the manufacturer's recommendations.
 5. The drawing is to be read in conjunction with the other relevant consultants drawings.
 6. This drawing is copyright of the architect.

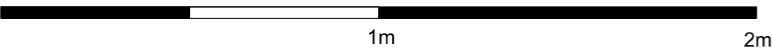

Revision		Date
A	DOC Issue	28.02.19

**prewett
bizley
architects**

118a London Wall London EC2Y 5JA 020 7256 2195
 rp@prewettbizley.com www.prewettbizley.com

Project
**39 Great James Street
 London
 WC1N 2LF**

Drawing Window Schedule - Rooflight W0-9	
Scale 1:20 @ A3 1:10 @ A1	Date Oct 2018
Dwg. no. 125 L 46	Revision A

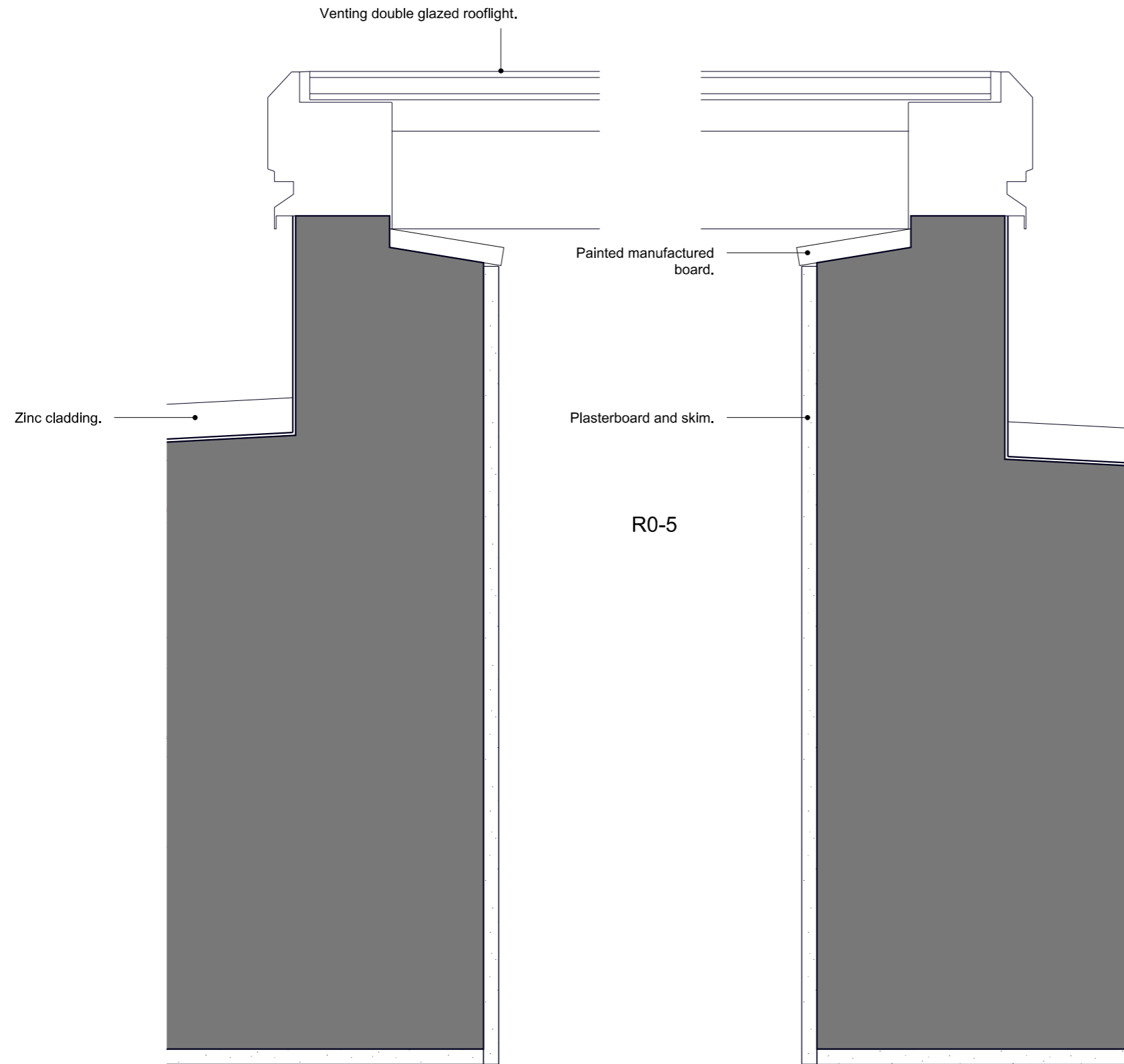

1. It is the contractor's responsibility to ensure that design principles, calculations, drawings and final construction must conform to the current building regulations, the CDM regulations and the relevant British or European codes of practice as appropriate.
 2. The contractor must verify all site dimensions, drawings, details and specifications and report any discrepancies to the architect before proceeding with any work.
 3. All specified items are to be installed in accordance with the manufacturer's recommendations.
 4. The drawing is to be read in conjunction with the other relevant consultants drawings.
 5. This drawing is copyright of the architect.

Drawing Status:
Planning

Revision	Date

prewett
 bizley
 architects

118a London Wall, London EC2Y 5JA 020 7256 2195
 rp@prewettbizley.com www.prewettbizley.com

Project
**39 Great James Street
 London
 WC1N 3HB**

Drawing
**Kitchen Dining Rooflight
 W0-9 Details**

Scale 1:5 @ A3	Date July 2018
--------------------------	--------------------------

Dwg. no. 125 D 55	Revision -
-----------------------------	----------------------