

Do not scale from this drawing.
 Check drawing on receipt and immediately report any discrepancies to the Architect.
 Verify all dimensions and levels on site prior to construction.
 The contents of this drawing are Stiff + Trevillion Architects LLP copyright and shall not be re-used without their written permission.

Notes

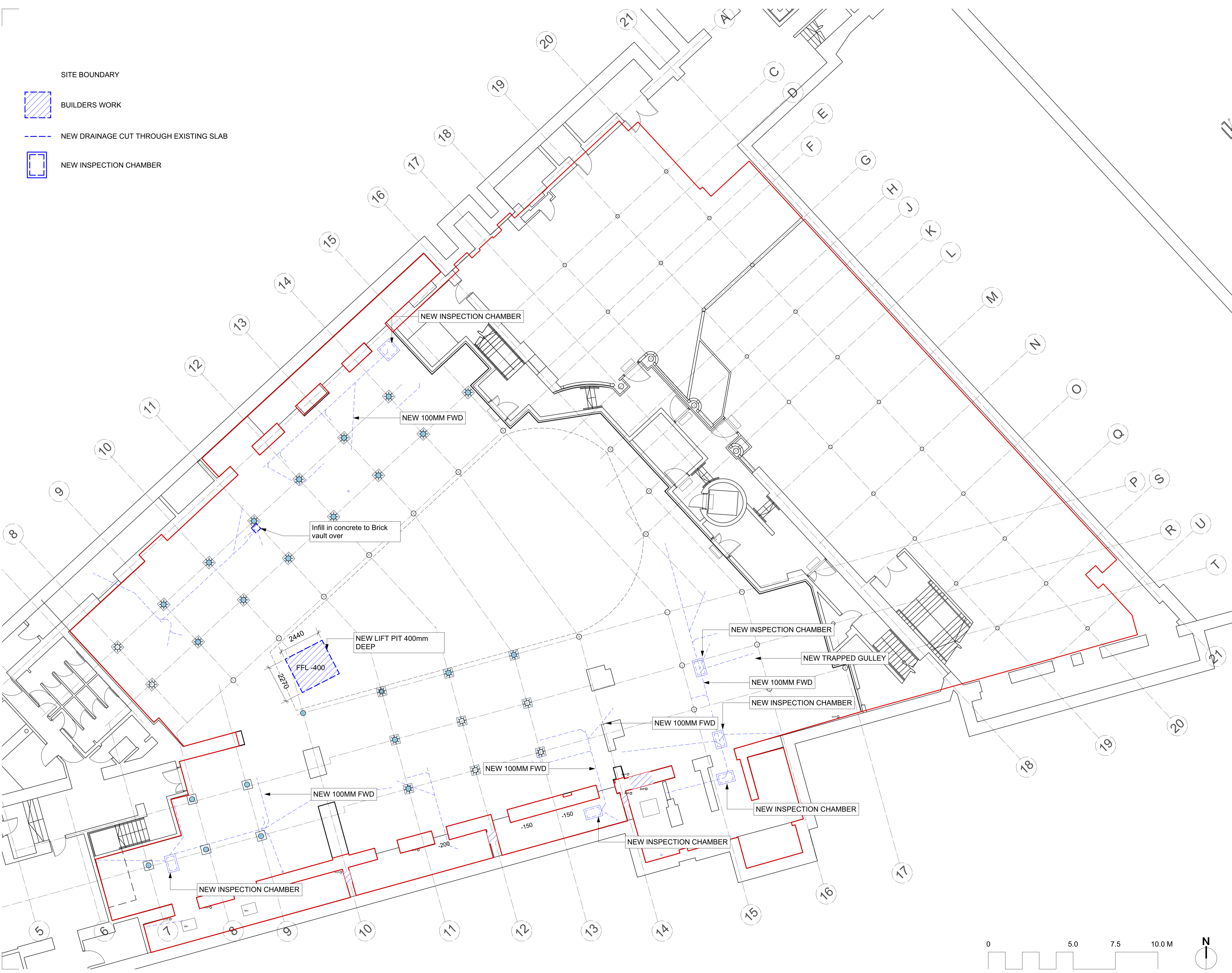

SITE BOUNDARY

BUILDERS WORK

NEW DRAINAGE CUT THROUGH EXISTING SLAB

NEW INSPECTION CHAMBER

NO OF UNITS

ALLEY UNIT - 12
 GF CATERING = 7
 BF CATERING = 7

COVERS(Seated)

GROUND FLOOR	301
BASEMENT	302
TOTAL COVERS	603

Rev. Date Note Approved

Stiff + Trevillion

Stiff + Trevillion Architects Ltd
 16 Woodfield Road
 London W9 2BE
 T +44(0)20 8960 5550
 mail@stiffandtrevillion.com
 www.stiffandtrevillion.com

Client
KERB SEVEN DIALS MARKET
 Project
**THOMAS NEAL'S WAREHOUSE
 35 EARLHAM STREET WC2H 9LD**

Drawing Title
**BUILDERS WORK
 BASEMENT**

Drawing Status
PLANNING

Date	Scale @ A1	Scale @ A3
20.02.19	1:100	1:200
Project No.	Drawing No.	Revision
4256	ST-[01]-499	

