

NOTE: ALL SETTING OUT DETAILS ARE TO BE PROVIDED BY THE ARCHITECT

NOTE: FLOOR FINISHES, SCREED, INSULATION, DPC, DPM, SETTING OUT AS DETAILED BY ARCHITECT.
INNER LEAF METAL STUD INFILL AND INTERNAL NON-LOADBEARING PARTITIONS BY SPECIALIST.
BALUSTRADES, HANDRAIL, GLAZING ETC. TO SPECIALIST DETAILS.

NOTE:
FOR SECTION A-A REFER TO 508 LAYOUT
AND FOR SECTIONS 1-1, 2-2, 3-3, 4-4
& 5-5 REFER TO 509 LAYOUT.

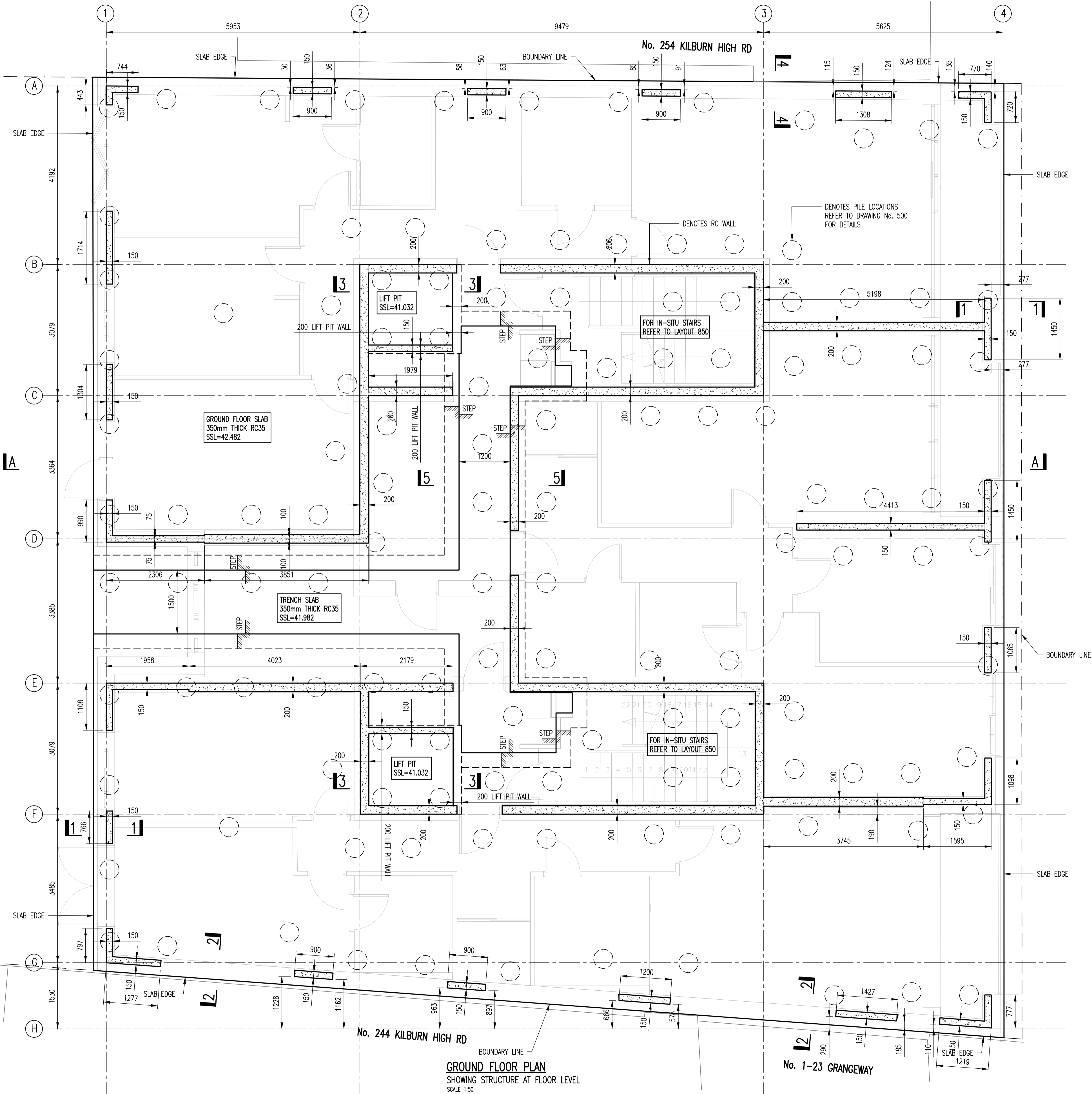

- GENERAL NOTES:**
- DO NOT SCALE THIS DRAWING OR MODEL. ALL DIMENSIONS ARE IN MILLIMETRES UNLESS NOTED OTHERWISE. ANY DISCREPANCIES ARE TO BE RECORDED AND REPORTED TO THE ENGINEERS IMMEDIATELY.
 - THIS DRAWING IS TO BE READ IN CONJUNCTION WITH ALL OTHER ENGINEERS AND ARCHITECTS DRAWINGS AND THE SPECIFICATION.
 - ALL WORK IS TO BE TO THE SATISFACTION OF THE ENGINEER AND LOCAL AUTHORITY BUILDING CONTROL.
 - THE CONTRACTOR IS RESPONSIBLE FOR AND MUST TAKE ALL NECESSARY PRECAUTIONS TO ENSURE THE STABILITY OF THE WORKS AT ALL TIMES DURING CONSTRUCTION.
 - ALL WORKMANSHIP AND MATERIALS ARE TO BE TO CURRENT BRITISH STANDARDS OR EUROCODES. ALL CONSTRUCTION PRODUCTS AND STRUCTURAL STEELWORK SHOULD BE CE MARKED IN ACCORDANCE WITH CURRENT LEGISLATION.
 - ALL SERVICES ARE TO BE LOCATED AND PROTECTED AS NECESSARY BY THE CONTRACTOR PRIOR TO THE COMMENCEMENT OF THE WORKS.
 - ANY EXISTING DETAILS WHICH ARE SHOWN ON THIS DRAWING ARE FOR GUIDANCE ONLY AND ARE TO BE CHECKED ON SITE BY THE CONTRACTOR. ANY VARIATIONS ARE TO BE RECORDED AND REPORTED TO THE ENGINEER IMMEDIATELY.
- CONCRETE**
- CONCRETE IS TO BE GRADE RC35, DS-3 DESIGNATED MIX.
 - BLINDING TO BE GRADE GEN1 CONCRETE MIX CONTAINING NOT LESS THAN 200kg/m³ OF O.P.C. AND A NOMINAL 20mm SIZE AGGREGATE.
 - CONCRETE IS TO BE TO BS EN 206 Pt 1 TO 4: 2000 AND BS EN 8500 Pt 1 AND 2: 2002.
 - THE CONTRACTOR IS RESPONSIBLE FOR THE DESIGN, SUPPORT AND ERECTION OF ANY FORM WORK REQUIRED.
 - FLEXIBLE PROTECTION IS TO BE PROVIDED AROUND ALL SERVICE WITH 50mm COMPRESSIBLE WRAPPING MATERIAL.
 - COVER TO SLABS IS TO BE 40mm TOP, 50mm BOTTOM, 50mm SIDES AND TO WALLS IS TO BE 30mm EACH FACE UNLESS NOTED OTHERWISE.
 - THE CONTRACTOR IS TO SUPPLY STOOLS, SPACERS, COVER BLOCKS ETC. THESE ITEMS ARE NOT SCHEDULED.
 - REINFORCEMENT IS TO BE TO BS 4449: 2005, BS 4483: 2005 AND BS 8666: 2005 AS APPLICABLE.

CONSTRUCTION

Rev	Amendments	Drawn	Approved	Date
C1	CONSTRUCTION ISSUE	BA	JM	05.11.2018
T2	SURVEY TRENCH ADDS, SECTIONS MOVED TO 509 LAYOUT	JM/BA	JM	18.09.2018
T1	TENDER ISSUE	SN	JM	29.08.2018
P2	MINOR MODIFICATIONS TO SECTIONS	BA	JM	24.07.2018
P1	INITIAL ISSUE	BA	JM	13.07.2018

jms CIVIL & STRUCTURAL CONSULTING ENGINEERS
LONDON • MIDLANDS • EAST ANGLIA • MANCHESTER • GREECE

Visit our website: www.jmsengineers.co.uk Or scan QR code

Document was issued from
JMS London: Tel: 0207 043 4619
The Pill Box, Coventry Road, London E2 6GG

Other offices include:
JMS Midlands Tel: 02476 350505
JMS East Anglia Tel: 01473 487250
JMS Manchester Tel: 0161 7904404
JMS Greece Tel: 0030 2310 960636
JMS Chelmsford Tel: 01245 905886

Project 246-248 KILBURN HIGH ROAD, NW6 2BS	
Drawing Title GROUND FLOOR PLAN BLOCK B	
Client PLANNING AND CONSULTING	
Drawn by BA	Designed by JM
Approved by JMS	Checked by JM
Scale AS SHOWN	Date JULY 2018
Drawing No. L18_064_04 / 501	Rev. C1