

Key:

Existing Retained

Existing Demolished

E
R
A
J
O
S
D
R
O
F
E
B

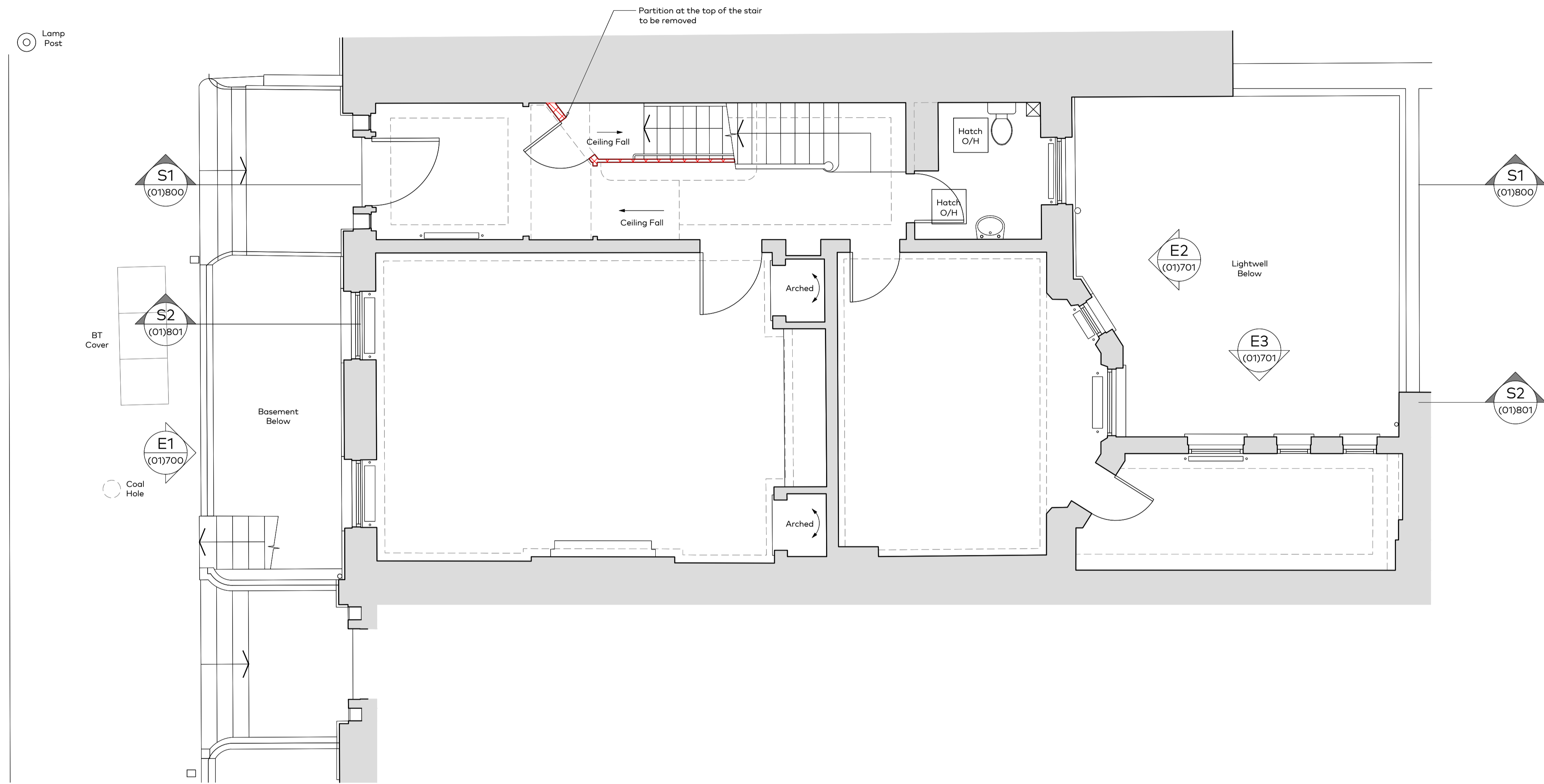

01 - EXISTING GROUND FLOOR PLAN WITH DEMOLITIONS
1:100@A3

B	22.01.2019	Demolition removed and general amendments	AS
A	24.08.2018	Issued for Information	YD
Rev	Issue Date	Revision Notes	Drawn

General Notes
Do not scale. All written dimensions must be checked on site before work commences on site or in shop. Figured dimensions take preference over those scaled. Discrepancies, where identified, must be reported to the Architect immediately. Any areas indicated on this drawing are for guidance purposes only. No responsibility is taken for their accuracy. All work must be carried out in accordance with the Building Regulations and to the satisfaction of the Local Authority.

Drawing Status

PLANNING			
Job Number	Drawing Number	Rev	Scale
859	(01)101	B	1:50@A1 1:100@A3
Drawing Title: Ground Floor Plan As Existing with Demolitions			
Project: Leverton House, 13 Bedford Square London WC1			
Client: The Bedford Estates			
Date	12.07.2018	drawn	checked