

ROOF PLAN
SCALE 1:100

ELECTRICITY REQUIREMENTS	
SUPPLY	NEW 3PHASE 100A REC SUPPLY
LOCATION	BASEMENT ELECTRICAL CUPBOARD
R.E.C	24 SEVEN (L.E) METER No. N/A

EQUIPMENT SCHEDULE			
No.	TYPE	SIZE	OTHER INFO
No.1	3F CABIN	3400x4500x2800mm	PROPOSED
No.1	Tx (13A)	845x770x2075mm	TO BE REMOVED
No.1	P	845x770x1360mm	TO BE REMOVED
No.1	R	845x770x1360mm	TO BE REMOVED

NOTE: INFORMATION HELD ON THIS TAKES PRECEDENCE OVER ALL KEYS AND SCHEDULES SHOWN

INITIAL ANTENNA KEY						
ITEM	ANTENNA REF	FUNCTION/ LINK NO.	TYPE / SIZE	BEARING	HEIGHT TO CENTRE OF ANTENNA FROM G/L	NO OF LINKS (OR IF REMOVED)
1	A1	TX/RX	120 SECTOR A	0°EGN	26.45m AGL	1
2	A2	RX	120 SECTOR A	0°EGN	26.45m AGL	1
3	B1	TX/RX	120 SECTOR B	120°EGN	26.45m AGL	1
4	B2	RX	120 SECTOR B	120°EGN	26.45m AGL	1
5	C1	TX/RX	120 SECTOR C	240°EGN	26.45m AGL	1
6	C2	RX	120 SECTOR C	240°EGN	26.45m AGL	1

INITIAL DISH KEY						
ITEM	ANTENNA REF	FUNCTION/ LINK NO.	TYPE / SIZE	BEARING	HEIGHT TO CENTRE OF DISH FROM G/L	REMOVE RFU Y/N
7	D1	-	300mmØ	179.3°EGN	22.5m AGL	Y
8	D2	-	600mmØ	TBA	23.7m AGL	Y
9	D3	-	600mmØ	TBA	23.7m AGL	Y
10	D4	-	600mmØ	TBA	23.7m AGL	Y

NOTE: INFORMATION HELD ON THIS TAKES PRECEDENCE OVER ALL KEYS AND SCHEDULES SHOWN

FINAL ANTENNA KEY						
ITEM	ANTENNA REF	FUNCTION/ LINK NO.	TYPE / SIZE	BEARING	HEIGHT TO CENTRE OF ANTENNA FROM G/L	NO OF LINKS (OR IF REMOVED)
1	A1/A2	TX/RX	DBDP-A	330°EGN	26.45m AGL	4R
2	E1/E2	TX/RX	DBDP-E	30°EGN	26.45m AGL	4R
3	B1/B2	TX/RX	DBDP-B	90°EGN	26.45m AGL	4R
4	F1/F2	TX/RX	DBDP-F	150°EGN	26.45m AGL	4R
5	C1/C2	TX/RX	DBDP-C	210°EGN	26.45m AGL	4R
6	G1/G2	TX/RX	DBDP-G	270°EGN	26.45m AGL	4R
7	TBA	TBA	FUTURE	TBA	TBA	TBA
8	TBA	TBA	FUTURE	TBA	TBA	TBA
9	TBA	TBA	FUTURE	TBA	TBA	TBA
10	TBA	TBA	FUTURE	TBA	TBA	TBA
11	TBA	TBA	FUTURE	TBA	TBA	TBA
12	TBA	TBA	FUTURE	TBA	TBA	TBA

FINAL DISH KEY						
ITEM	ANTENNA REF	FUNCTION/ LINK NO.	TYPE / SIZE	BEARING	HEIGHT TO CENTRE OF DISH FROM G/L	REMOVE RFU Y/N
7	D1	-	300mmØ	179.3°EGN	22.5m AGL	Y
8	D2	-	600mmØ	TBA	23.7m AGL	Y
9	D3	-	600mmØ	TBA	23.7m AGL	Y
10	D4	-	600mmØ	TBA	23.7m AGL	Y

FEEDER CABLES						
ITEM	ANT. REF	TYPE & SIZE	MAX BEND RADIUS	MAX FEEDER LENGTH	No. OF FEEDERS	
1	A1/A2	ANDREW LDF5/50	250mm	15m	4	
2	E1/E2	ANDREW LDF5/50	250mm	10m	4	
3	B1/B2	ANDREW LDF5/50	250mm	10m	4	
4	F1/F2	ANDREW LDF5/50	250mm	15m	4	
5	C1/C2	ANDREW LDF5/50	250mm	25m	4	
6	G1/G2	ANDREW LDF5/50	250mm	25m	4	

SOUTH EAST ELEVATION
SCALE 1:200



Mivan Limited
TELECOMS
84-88 High Street South
Dunstable, LU6 3HD
Tel: +44(0) 1582 608 636
Fax: +44(0) 1582 696 930

- COMPLIES WITH OPC SPEC.252 EXCEPT:
- NONE
 -
 -
 -

ISS.	DESCRIPTION	BY	DATE
D	CABIN UPDATED AND NOTES MODIFIED	JB	03.07.00
C	ELECTRICAL NOTES AMENDED	MH	05.06.00
B	GENERAL AMENDMENTS	MH	14.04.00
A	ISSUED FOR APPROVAL		

SCALE	DATE	DRAWN	C.B.	CHECKED	MH	APPROVED	BL
RTD	03.04.00				14.04.00		14.04.00

TITLE GENERAL ARRANGEMENT
DARTMOUTH PARK, CREST VIEW
47 DARTMOUTH PARK HILL
LONDON, NW5
DRAWING NUMBER 30/GLN0528/01
ISSUE D



St. James Court
Great Park Road
Almondsbury
Bristol
BS12 4QJ
Tel 01454 624600
Fax 01454 618501

This document should not be relied on or used in circumstances other than those for which it was originally prepared and for which Mivan Limited was commissioned. Mivan Limited accepts no responsibility for this document to any party other than the person by whom it was commissioned.

SITE NUMBER GLN 0528

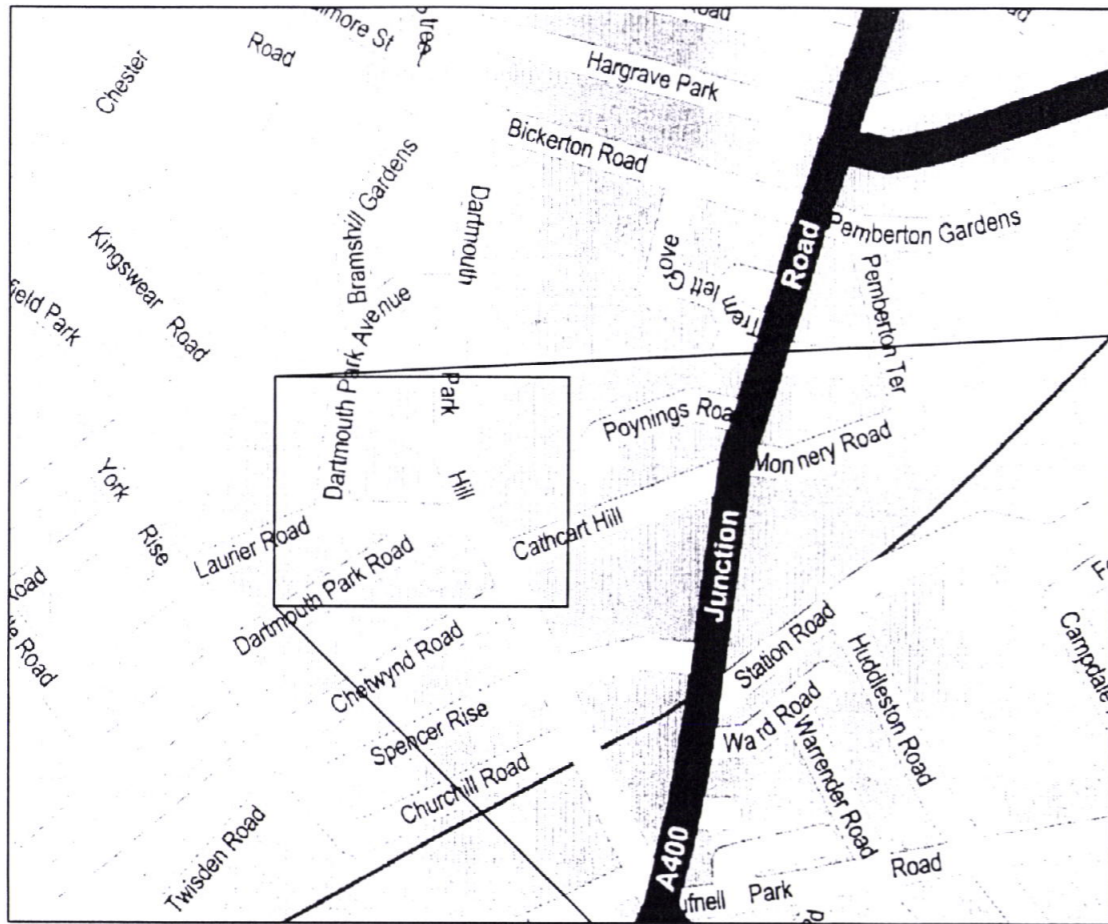

N
SITE LOCATION
NOT TO SCALE

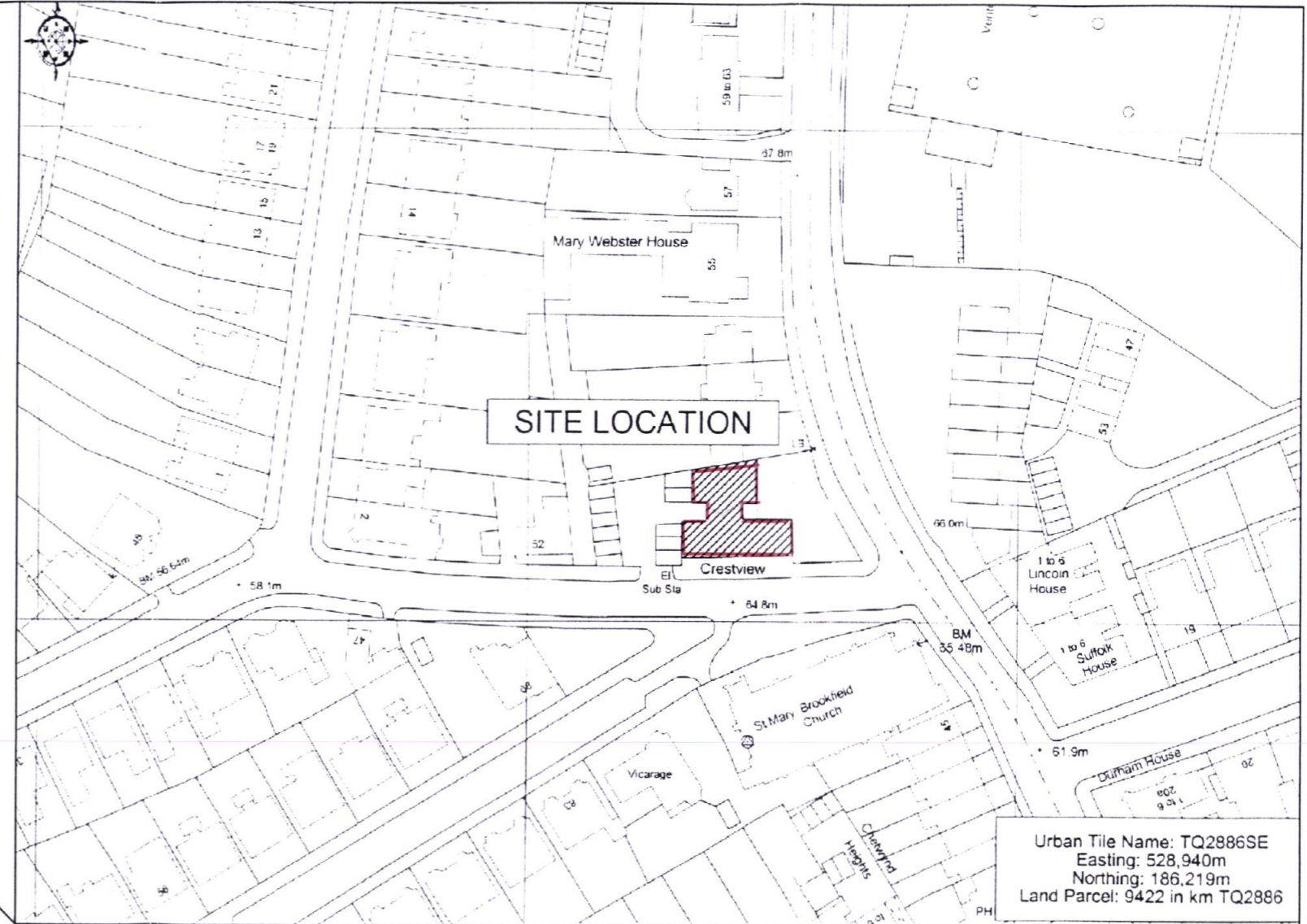

Urban Tile Name: TQ2886SE
Easting: 528,940m
Northing: 186,219m
Land Parcel: 9422 in km TQ2886

N
ORDNANCE SURVEY
SCALE 1:1250

PEX0000653



Mivan Limited
TELECOMS
84-88 High Street South
Dunstable, LU6 3HD
Tel: +44(0) 1582 608 636
Fax: +44(0) 1582 696 930

COMPLIES WITH OPC SPEC.252 EXCEPT:

- 1.
- 2.
- 3.
- 4.

ISS.	DESCRIPTION	BY	DATE
1	ISSUED FOR APPROVAL	MNH	05/00
SCALE	RTD	DATE	03.04.00
CHECKED	DATE	05/00	DATE
APPROVED	DATE	05/00	DATE

TITLE
SITE LOCATION
CREST VIEW
DARTMOUTH PARK HILL
LONDON, NWS
DRAWING NUMBER
30/GLN0528-90-MIVAN
ISSUE
1



St. James Court
Great Park Road
Almondsbury
Bristol
BS12 4QJ
Tel 01454 624600
Fax 01454 618501

This document should not be relied on or used in circumstances other than those for which it was originally prepared and for which Mivan Limited was commissioned. Mivan Limited accepts no responsibility for this document to any party other than the person by whom it was commissioned.