

CLIENT :
TESCO EXPRESS

PROJECT :
EXTERNAL SIGNAGE

SITE REFERENCE :
SWISS COTTAGE

PRODUCT TYPE/DOCUMENT TITLE :
ILLUMINATED FASCIA



DRAWING / DOCUMENT No :
CD-ASW11660-1

FILE PATH:
C:\Users\Bedros\Dropbox\MER\LB__JAN\23. ASW11660 -
TESCO Express - SWISS COTTAGE

ISSUE : **2** **DATE :** **26.02.19**

DESIGN STATUS :
FOR CONSTRUCTION

DESIGN REGISTER

Our design information is issued as a multi-page document. Each document has a unique number and each drawing or page a sequential number of that. Individual drawings/pages within a document have a revision status marked by a letter and a red 'rev' cloud on the drawing. Each document issue is marked by a number, the table below provides a history of this document.

ISSUE :	DATE :	DESIGNER :	CHECKED :	APPROVED :	DESIGN STATUS :	SUMMARY OF ISSUE :	RISK No :	DESCRIPTION OF RISK :	RESOLUTION AGREED :
1	22.01.19	BJ	SC	SW	FOR CONSTRUCTION	DRAWING FIRST ISSUED	R1	SUITABLE FIXING FOR SUBSTRATE TO BE DETERMINED ON SITE	-
2	26.02.19	BJ	SC	SW	FOR CONSTRUCTION	BLUE SIDE PANELS REMOVED	R2	LED LAYOUT TO BE TRIALLED DURING MANUFACTURE	-
							INDICATED BY:	-----	



DRAWING / DOCUMENT No :
CD-ASW11660-1

ISSUE :
2 DATE :
26.02.19

DESIGN STATUS :
FOR CONSTRUCTION

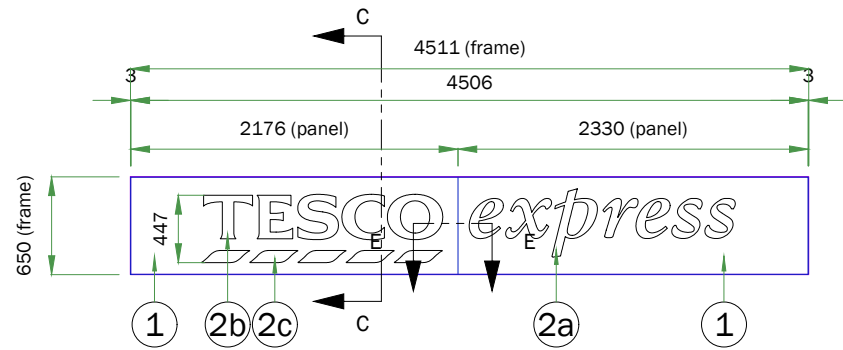

1 **Main Fascia Elevation**
scale 1:50

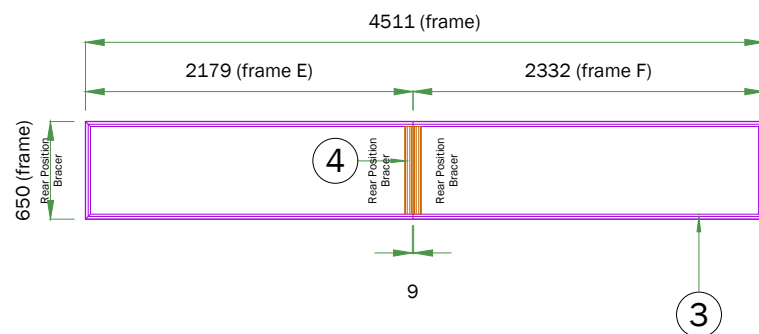

3 **Extrusion Frame Modules - Main Fascia**
scale 1:50

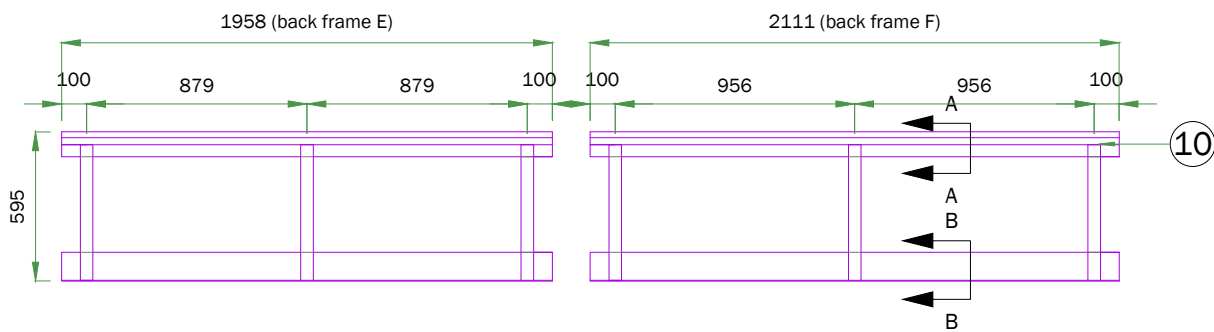

10 **Back Frames**
scale 1:30

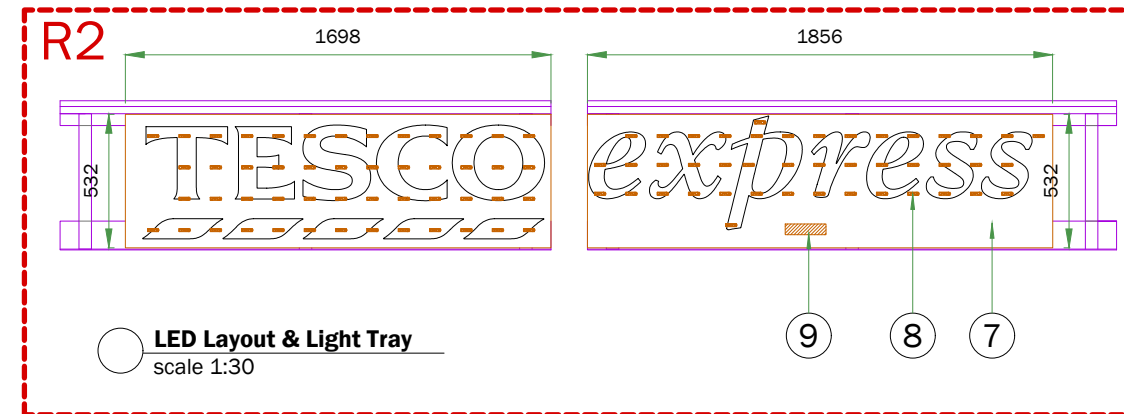

9 **LED Layout & Light Tray**
scale 1:30

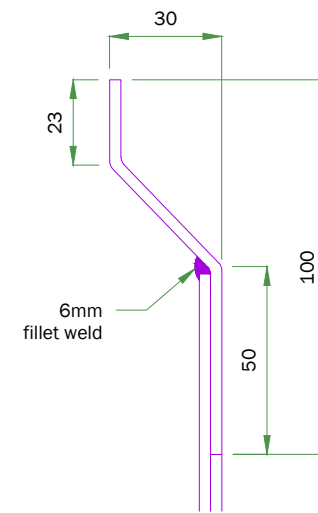

A **Section A-A**
scale 1:2

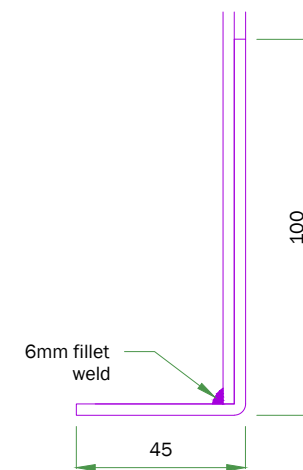

B **Section B-B**
scale 1:2



CLIENT :
TESCO EXPRESS
PROJECT :
EXTERNAL SIGNAGE
SITE REFERENCE :
SWISS COTTAGE

PRODUCT TYPE :
ILLUMINATED FASCIA
PAGE TITLE :
MAIN FASCIA DETAILS
DRAWING NO :
CD-ASW11660-1.1

DESIGN STATUS :
FOR CONSTRUCTION
PAGE : 1/3
REV : BY : SCALE @ A3 :
B BJ AS SHOWN
ISSUE : DATE :
2 26.02.19

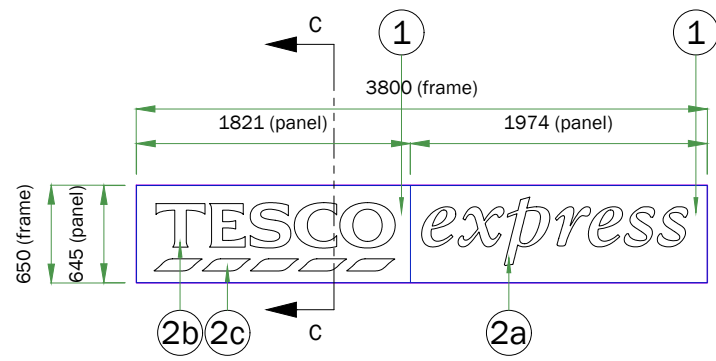

○ **Side Fascia Elevation**
scale 1:50

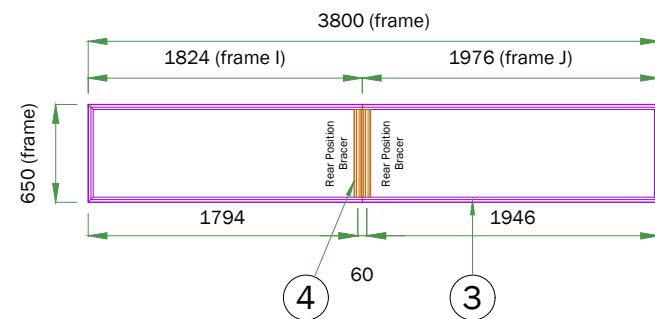

○ **Extrusion Frame Modules - Side Fascia**
scale 1:50

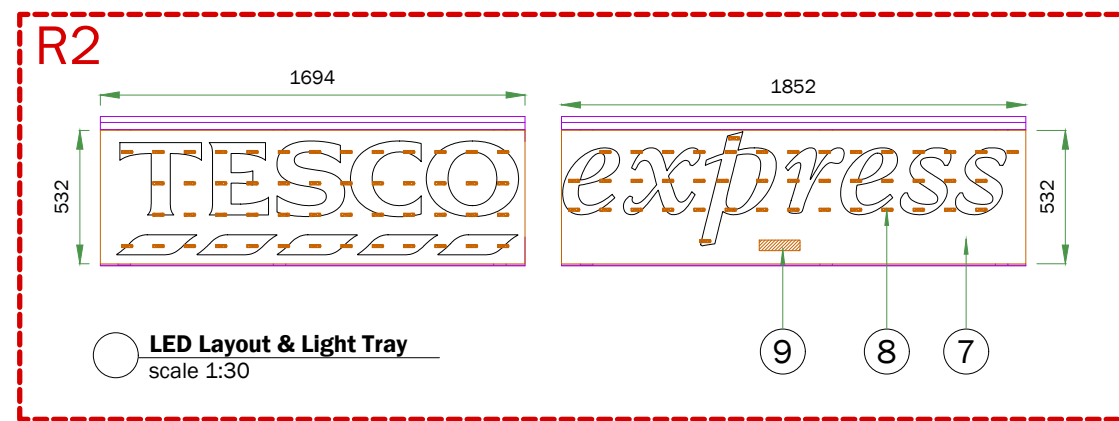

○ **LED Layout & Light Tray**
scale 1:30

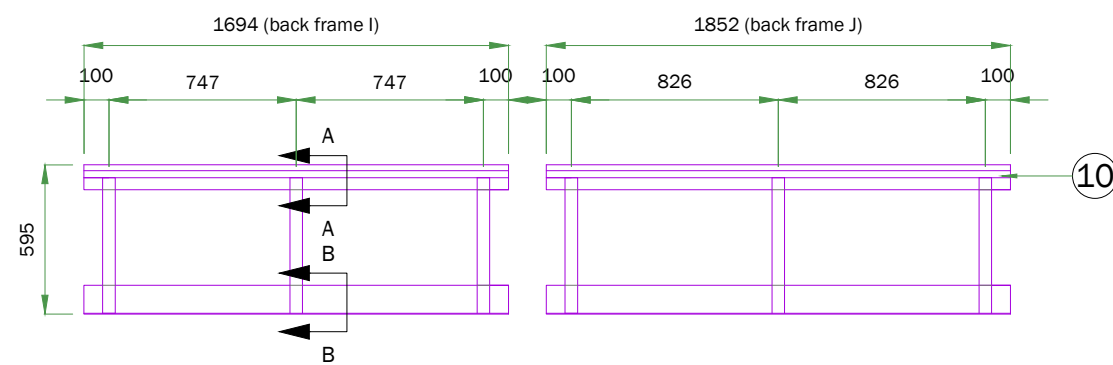

○ **Back Frames**
scale 1:30

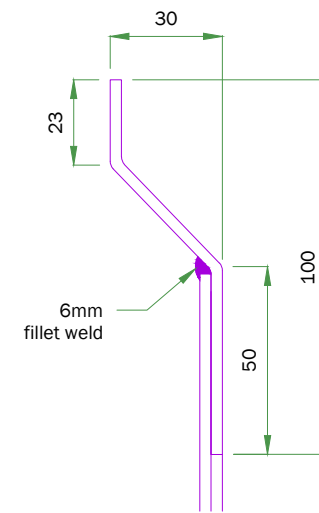

A Section A-A
scale 1:2

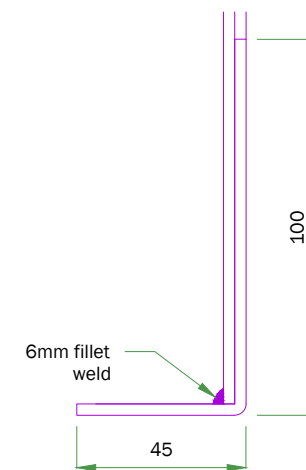

B Section B-B
scale 1:2



CLIENT :
TESCO EXPRESS
PROJECT :
EXTERNAL SIGNAGE
SITE REFERENCE :
SWISS COTTAGE

PRODUCT TYPE :
ILLUMINATED FASCIA
PAGE TITLE :
SIDE FASCIA DETAILS
DRAWING NO :
CD-ASW11660-1.2

DESIGN STATUS :
FOR CONSTRUCTION
PAGE : 2/3
REV : BY : SCALE @ A3 :
B BJ AS SHOWN
ISSUE : DATE :
2 26.02.19

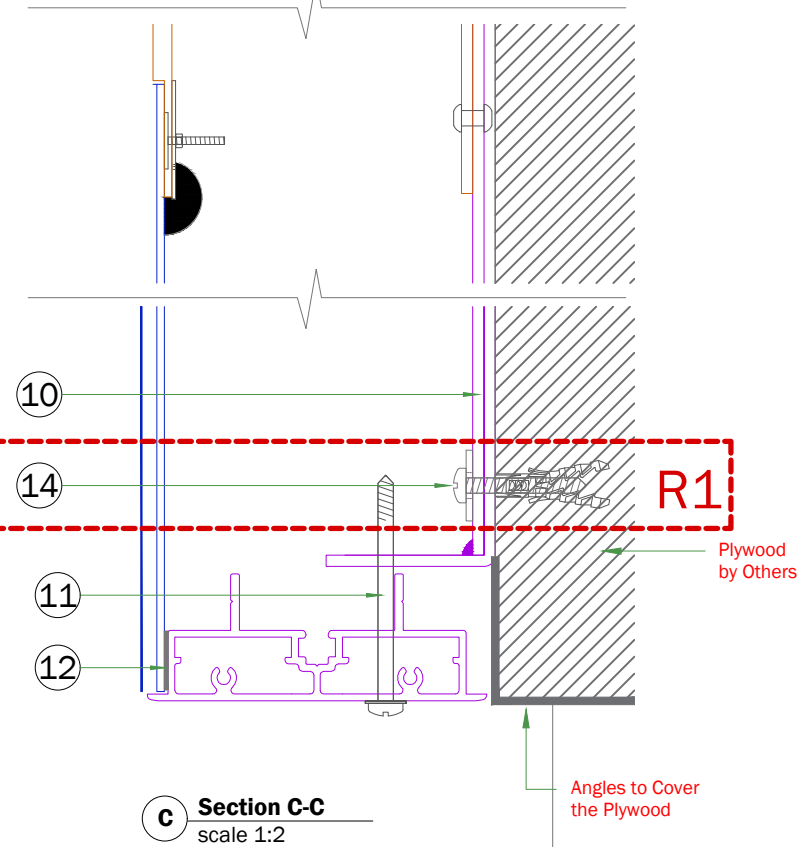
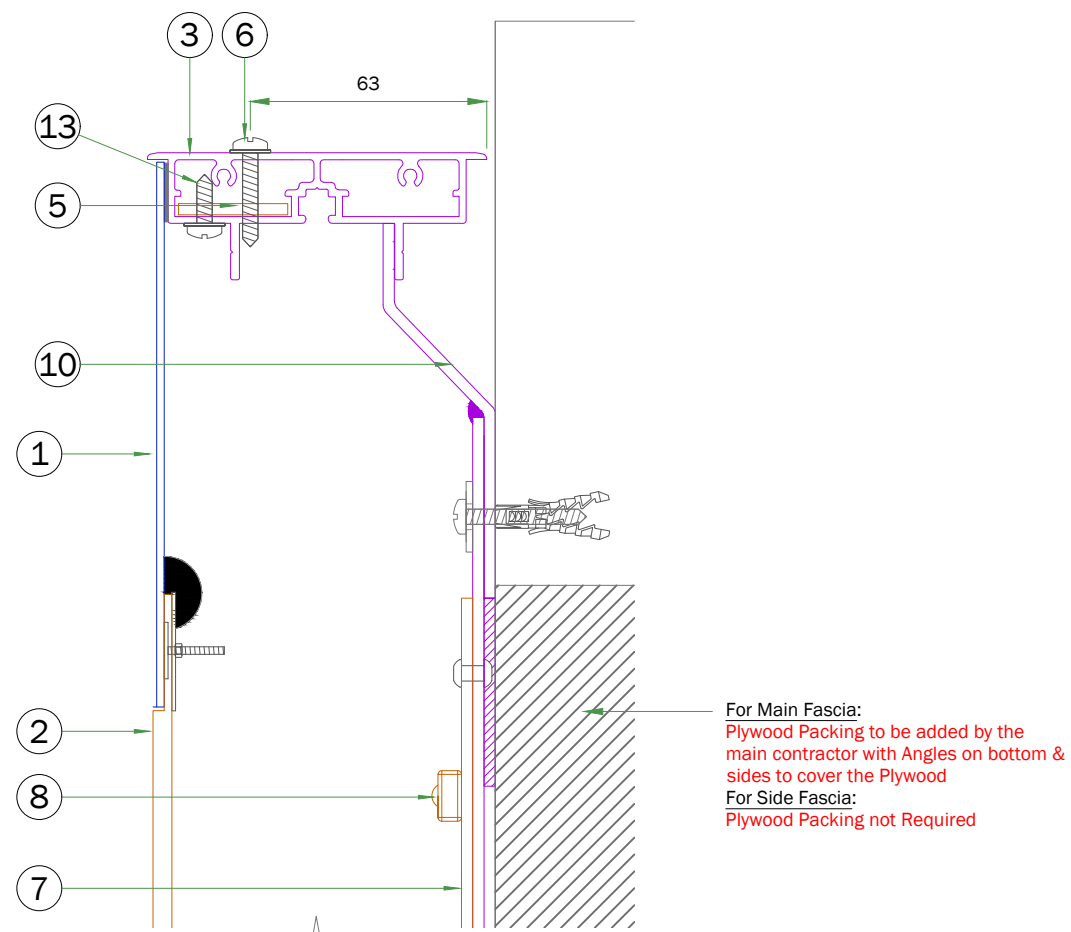

C Section C-C
scale 1:2

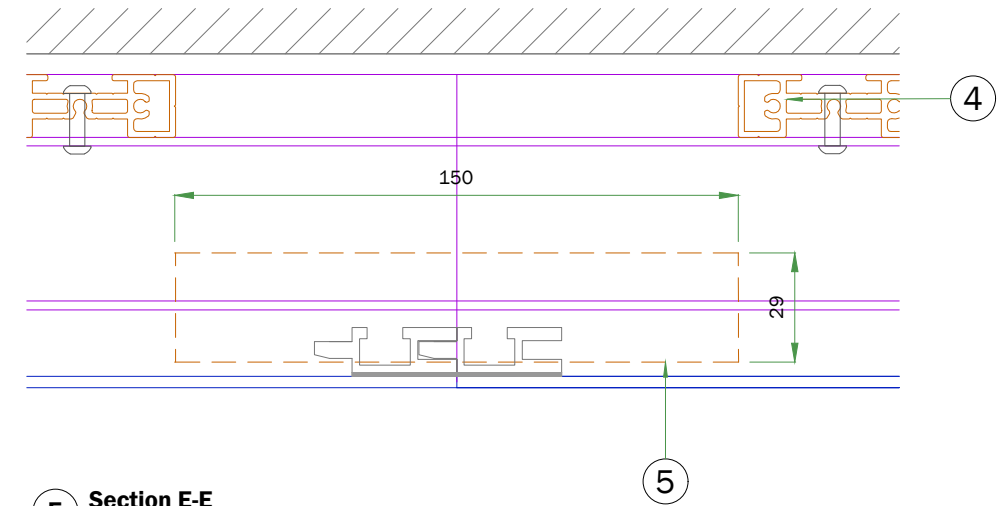

E Section E-E
scale 1:2

WRITTEN SPECIFICATION

PART No.	DESCRIPTION	PART QTY.	PART WEIGHT (KG)	TOTAL WEIGHT (KG)	MATERIAL USAGE (UOM)	LEAD TIME RISK
1	3mm fret cut aluminium panel, to be powdercoated WHITE RAL 9010, 30% gloss	4	-	-	-	Y
2a	'EXPRESS' to be 5mm Opal 030 with Avery 5600LD/82A BLUE translucent vinyl applied to face, flush in-laid and fixed to rear of panel with Big Head fixings and Simson ISR 70-03.	2	-	-	-	-
2b	'TESCO' to be 5mm Opal 030 with Avery 4509 RED translucent vinyl applied to face, flush in-laid and fixed to rear of panel with Big Head fixings and Simson ISR 70-03.	2	-	-	-	-
2c	BLIPS to be 5mm Opal 030 with Avery 5600LD/82A BLUE translucent vinyl applied to face, flush in-laid and fixed to rear of panel with Big Head fixings and Simson ISR 70-03.	2	-	-	-	-
3	ASGUK081 extrusion frame, to be wrapped with vinyl having digitally printed Brown Arizona Oak effect finish	4	-	-	-	-
4	ASGUK016 extrusion bracer, riveted to extrusion frame. To be left mill finish	4	-	-	-	-
5	3mm flat aluminium joining piece, 29x150mm. To be left mill finish	2	-	-	-	-
6	No.8x25mm Flange Head Self Tapper, touched up to match Brown Arizona Oak	as req'd	-	-	-	-
7	3mm WHITE Foam PVC LED panel	4	-	-	-	-
8	Tetra MiniMAX 7100K LEDs (GEMM71-2)	188	-	-	-	-
9	MEAN WELL LPV-60-12	1	-	-	-	-
10	Frame work from folded from 3mm aluminium z bracket welded to 45x45x3mm aluminium angle using 50x3mm straps (6mm fillet weld)	4	-	-	-	-
11	No.8x60mm Flange Head Self Tapper, touched up to match to match Brown Arizona Oak	as req'd	-	-	-	-
12	Bonding to be 3M 5952 VHB tape. To be applied to full perimeter of frame and also vertical bracers	as req'd	-	-	-	-
13	No.8x13mm Flange Head Self Tapper	as req'd	-	-	-	-
14	Fixings and anchors to suit substrate	as req'd	-	-	-	-

R1



CLIENT :
TESCO EXPRESS
PROJECT :
EXTERNAL SIGNAGE
SITE REFERENCE :
SWISS COTTAGE

PRODUCT TYPE :
ILLUMINATED FASCIA
PAGE TITLE :
SECTIONS & DETAILS
DRAWING NO :
CD-ASW11660-1.3

DESIGN STATUS :
FOR CONSTRUCTION
PAGE : 3/3
REV : BY: SCALE @ A3 :
B BJ AS SHOWN
ISSUE : DATE :
2 26.02.19