

1 STAIR ELEVATION 1
SCALE: 1:20 @ A2

2 STAIR ELEVATION 2
SCALE: 1:20 @ A2

3 STAIR ELEVATION 3
SCALE: 1:20 @ A2

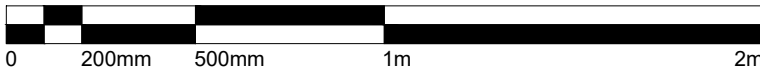

NOTES

ADDRESS

37 NEAL STREET
LONDON
WC2H 9PR

BASED ON PARTIAL SURVEY TO CONFIRM OUTLINE
PARAMETERS OF BUILDING. VERIFY ALL DIMS ON SITE.

SCOPE OF WORKS

INTERNAL WORKS: NEW BALUSTERS AND HANDRAIL TO
STAIRCASE LEADING TO BASEMENT. NEW FIRE RATED
PARTITION AND DOOR SEPARATING STOCKROOM. NEW
WC. NEW KITCHENETTES IN BASEMENT. NEW PLUMBING
CONNECTIONS TO EXISTING SVP AND MECHANICAL
EXTRACT FROM WC.

SHOPFRONT: NEW PAINT FINISH TO SHOPFRONT
FACADE. NEW FASCIA SIGNAGE AND BLADE SIGNAGE IN
ACCORDANCE WITH LANDLORD GUIDELINES. REFER TO
DRAWINGS A200, A201, A202.

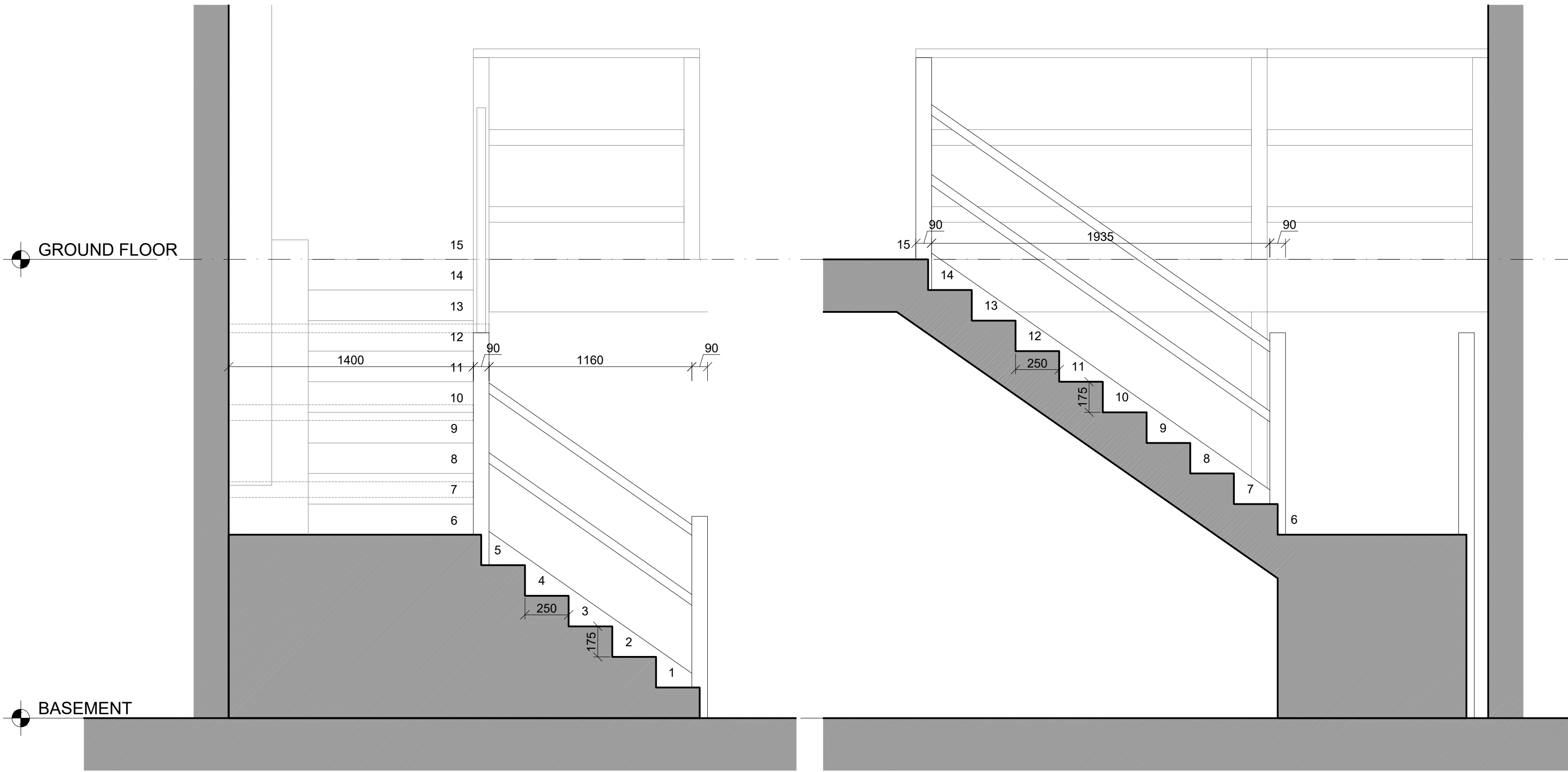

4 STAIR ELEVATION 4
SCALE: 1:20 @ A2

5 STAIR ELEVATION 5
SCALE: 1:20 @ A2

BUILDING CONTROL

LISTED BUILDING CONSENT

P0	LISTED BUILDING+ADVERTISING	NF	PD	07/03/2019
P0	BUILDING CONTROL	NF	PD	06/03/2019
Rev	Description	By	Check	Date

Hyphen
39 Moreland Street
London, EC1V 8BB
+44 20 7940 3170
info@hyphen.archi

Client
The Cambridge Satchel Company

Project
The Cambridge Satchel Company
Neal Street

Drawing
**Stair Details
Existing**

Scale	Date	Author	Checked
1:20 @ A2	21.02.2019	NF	PD
Workstage	Status		
3	PLANNING		
Hyphen Project No.	Drawing No.	Revision	
6698	A301	P0	

Scale only for planning purposes
Report any discrepancies to the author
© The Hyphen Group Ltd