

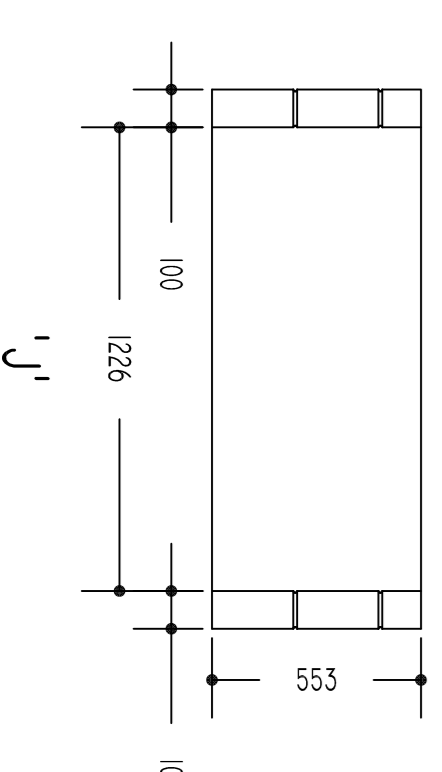

The Honourable  
Society of Gray's Inn  
8 South Square,  
London,  
WC1R 5ET  
Telephone:  
020 7458 7800

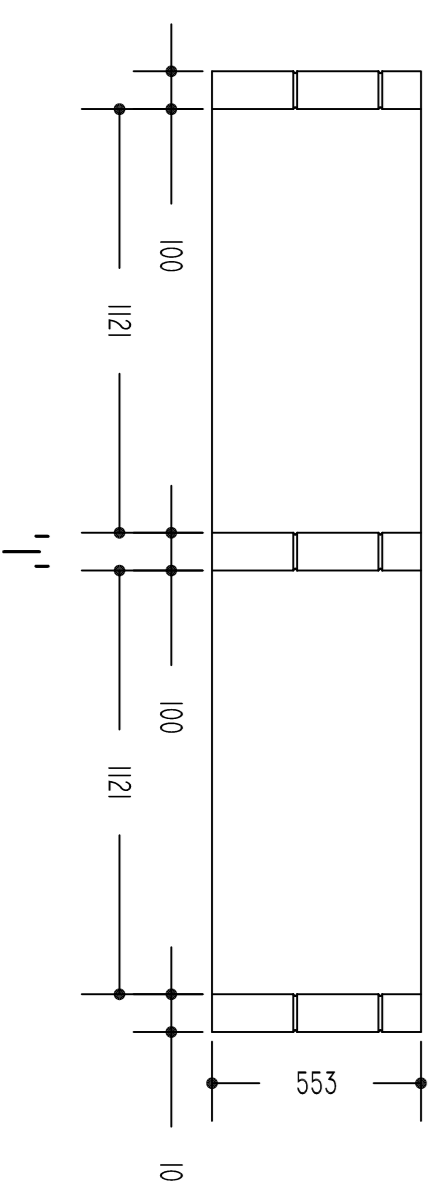
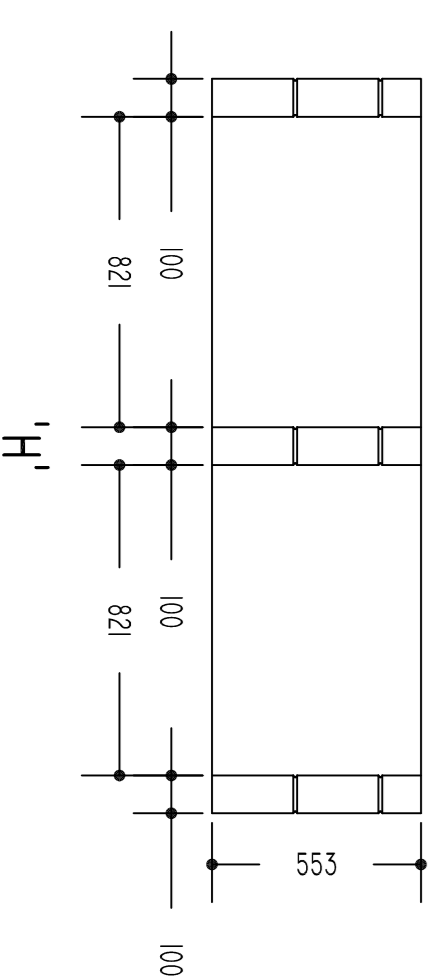
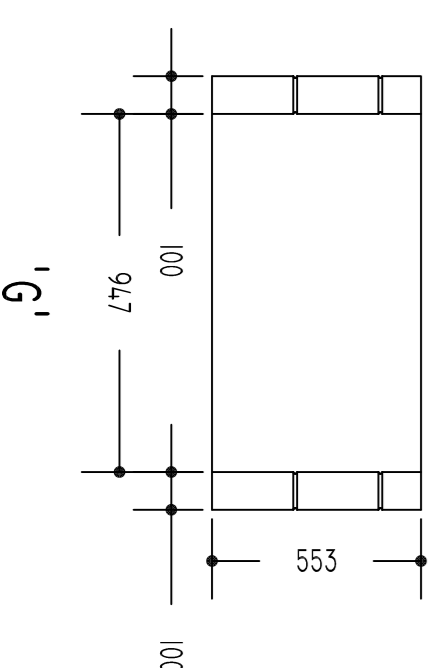
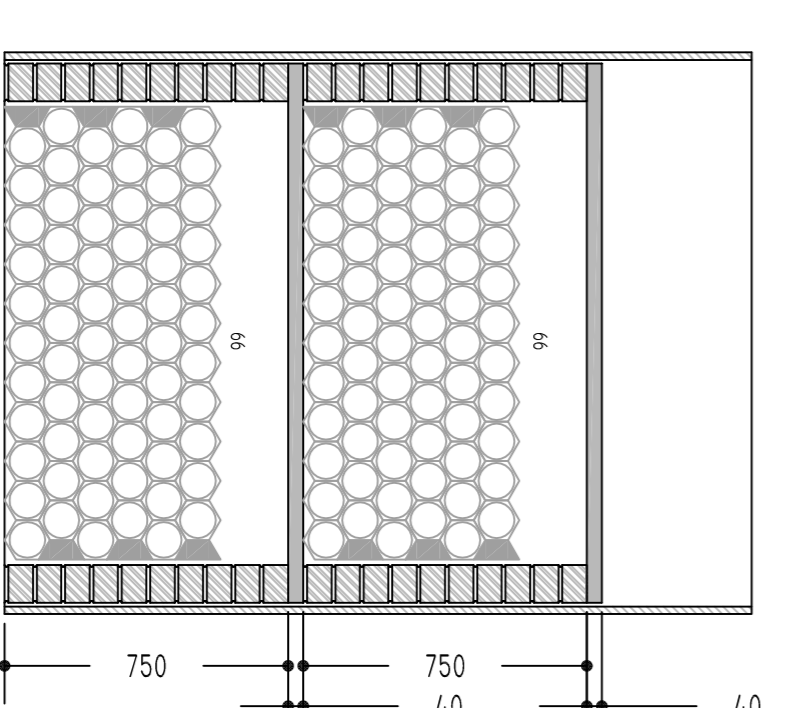
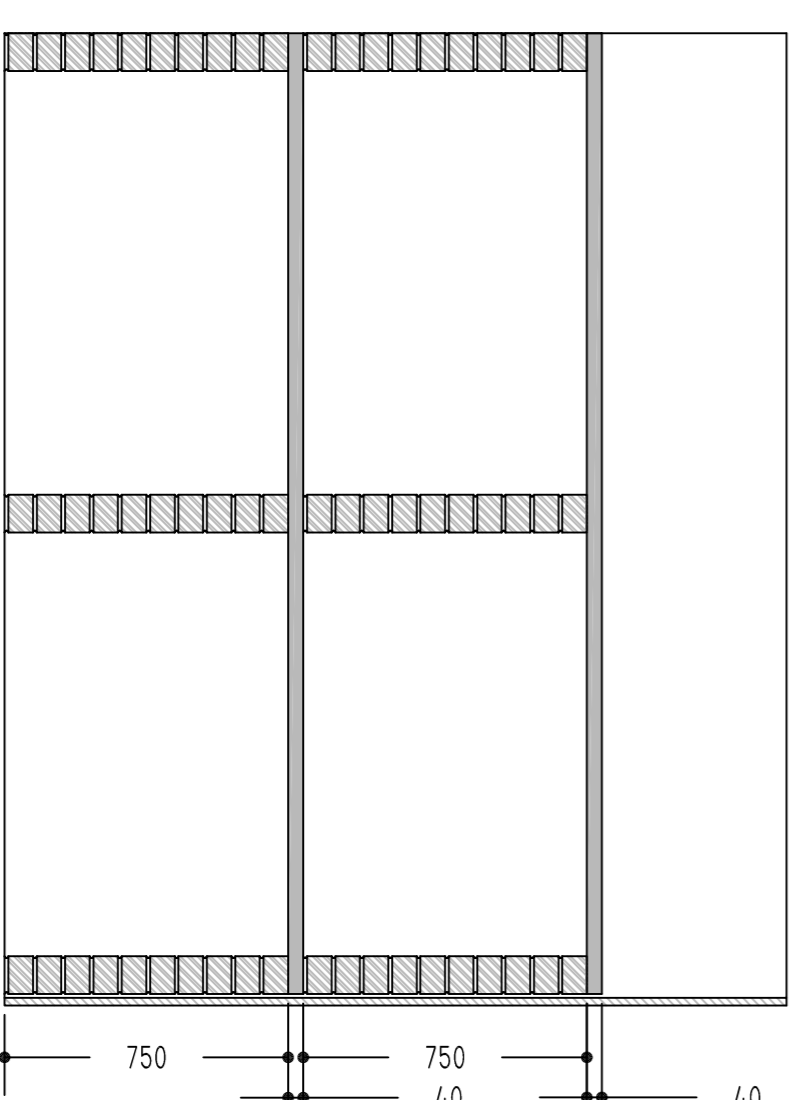
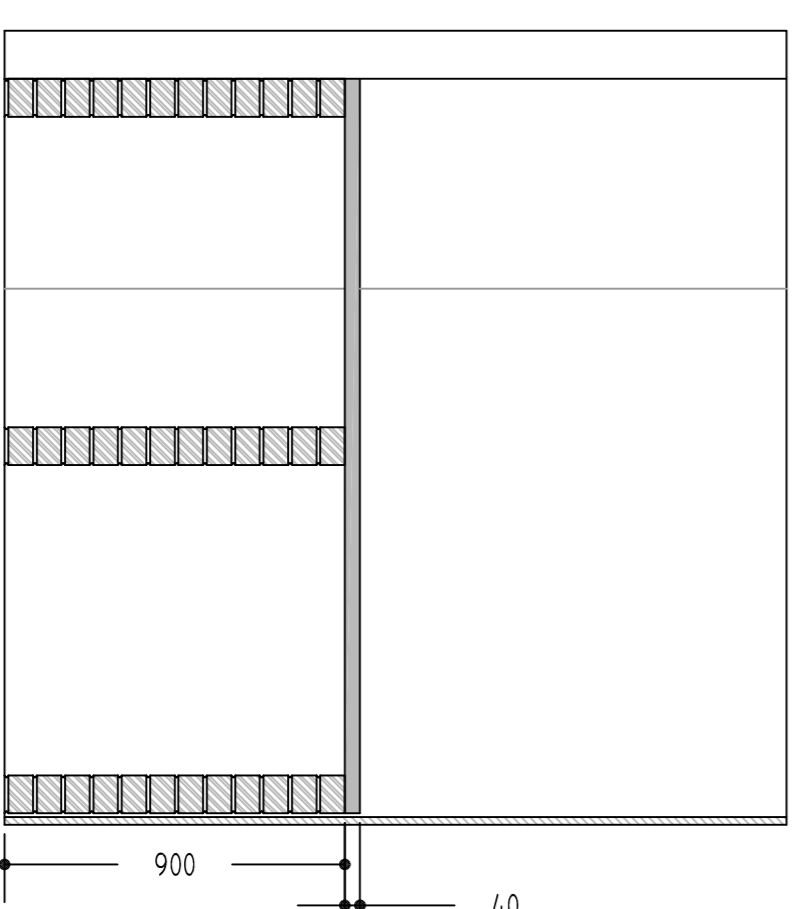
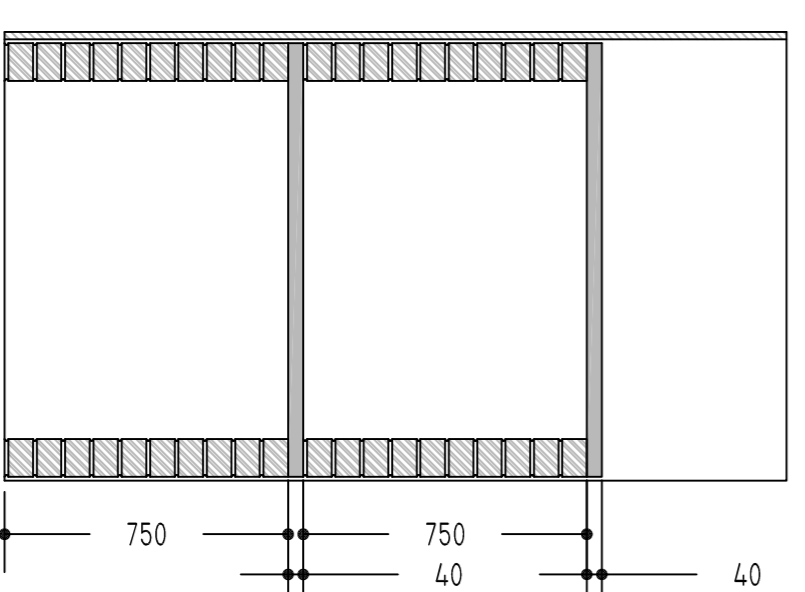
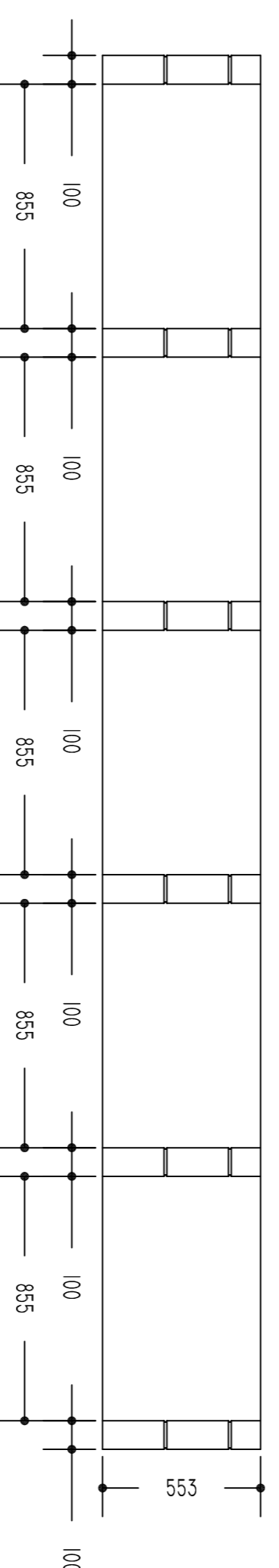
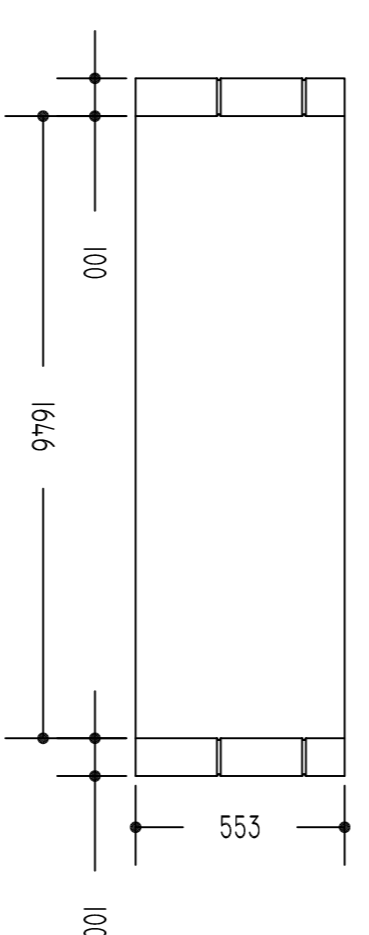
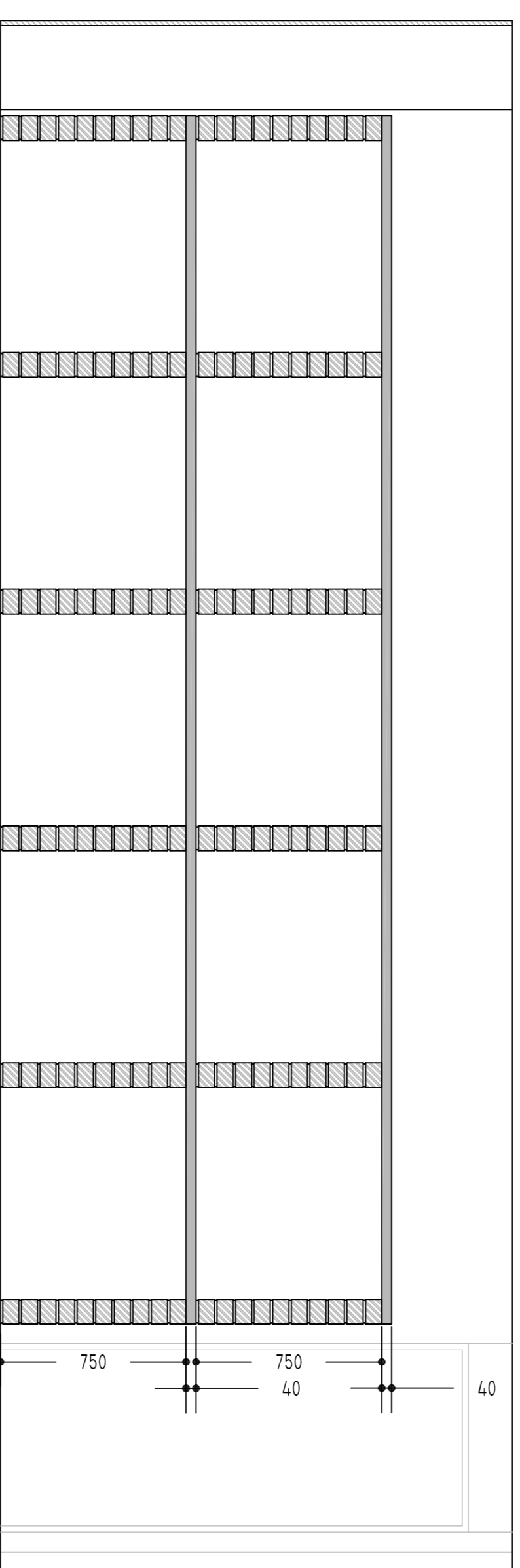
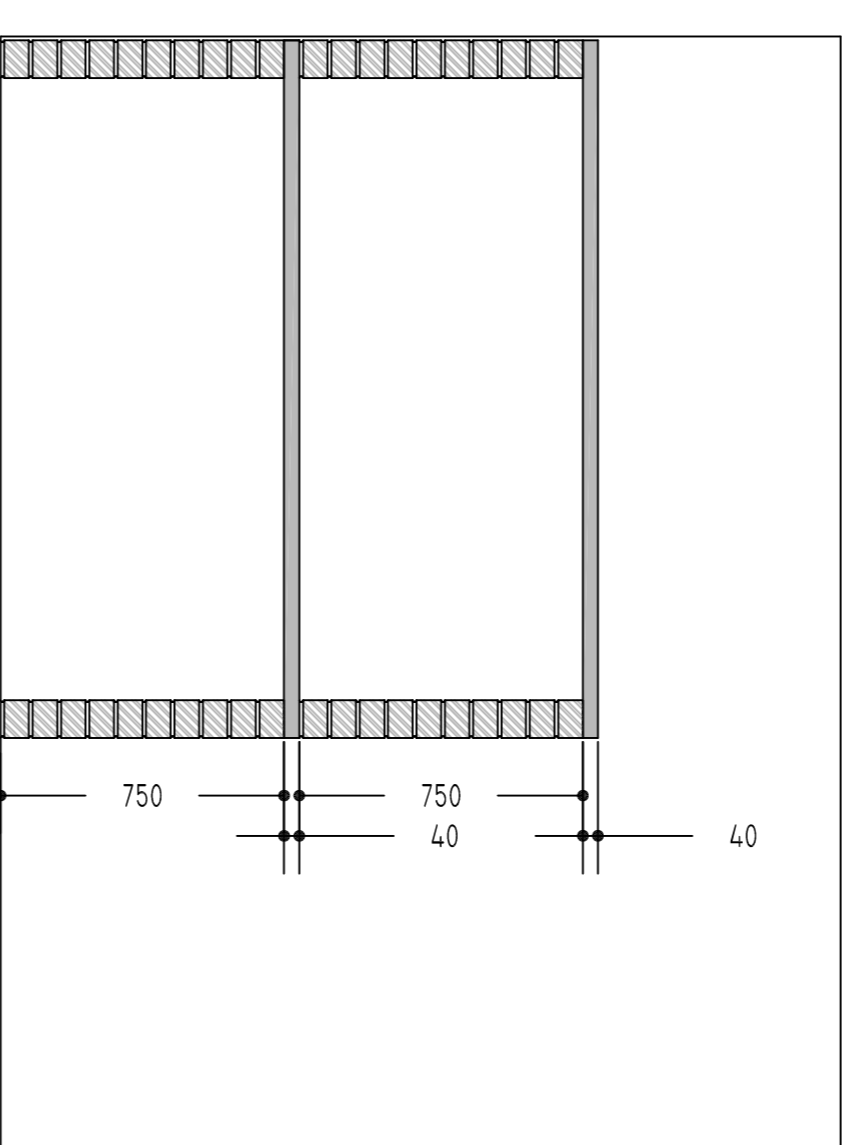
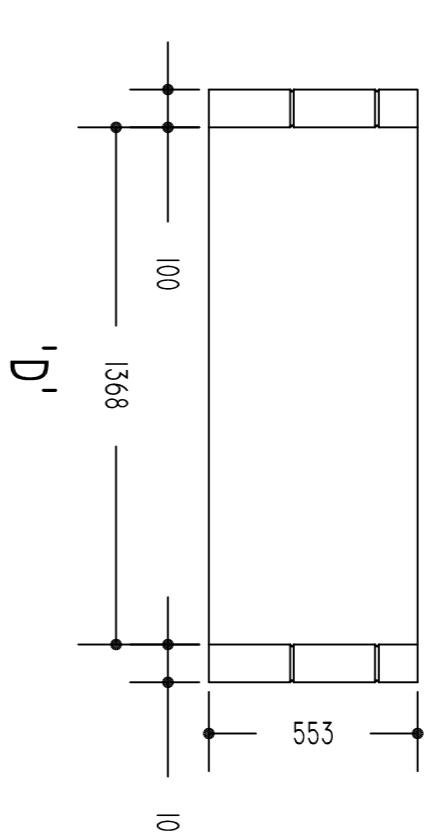
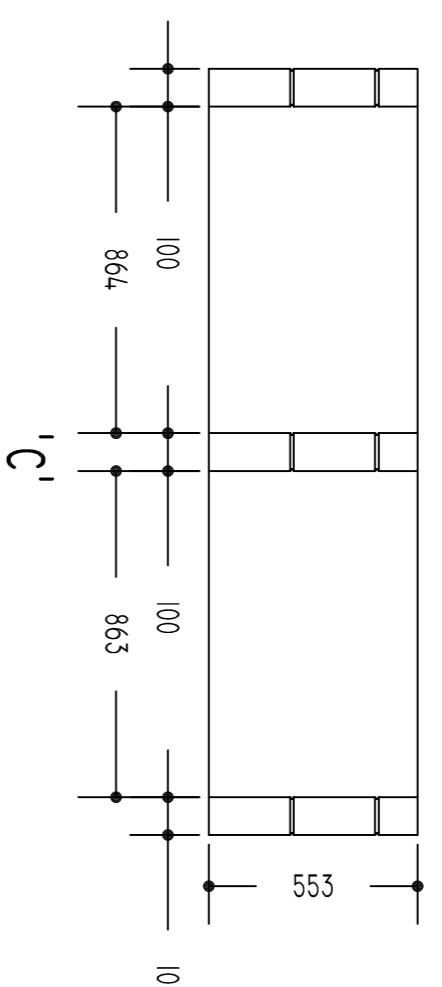
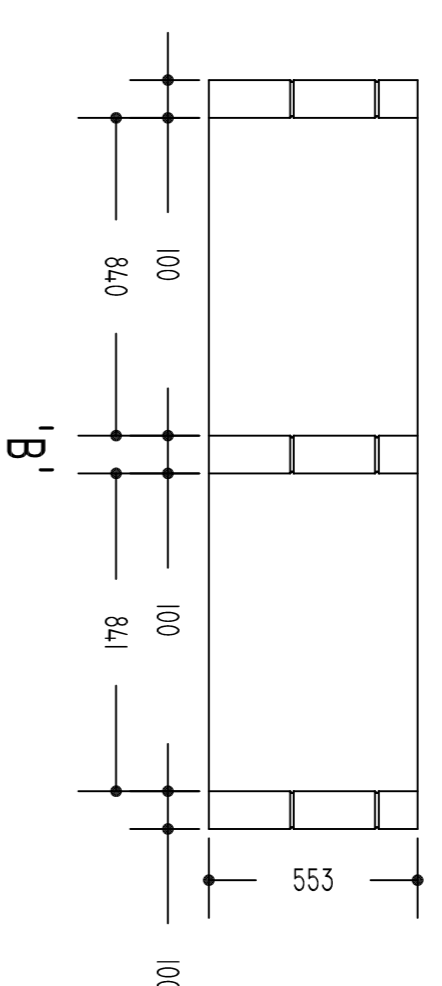
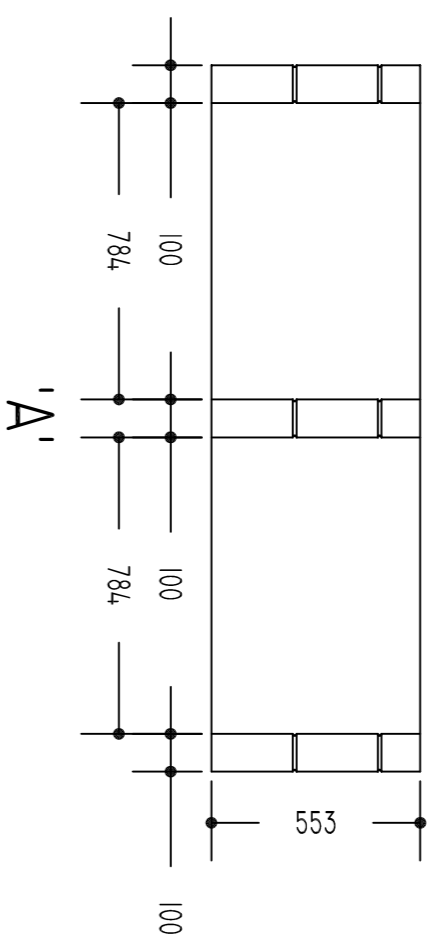
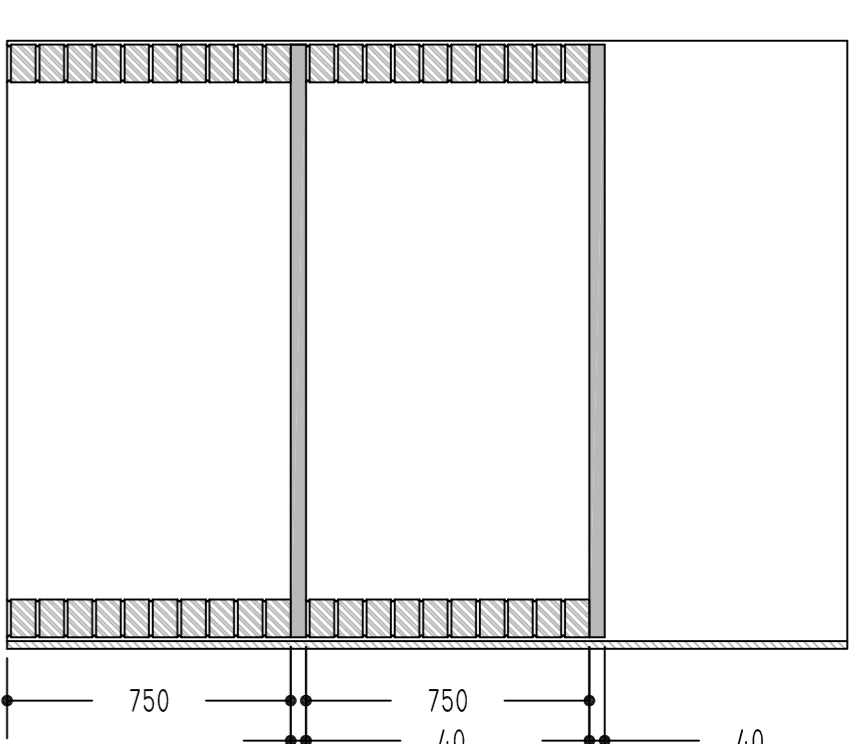
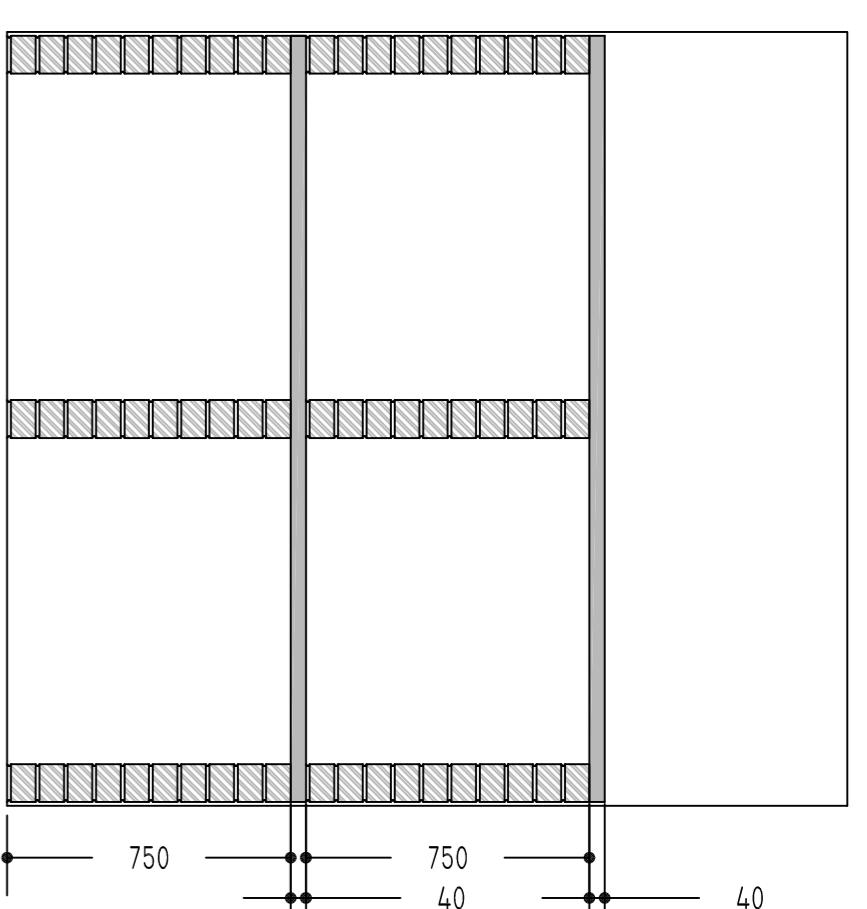
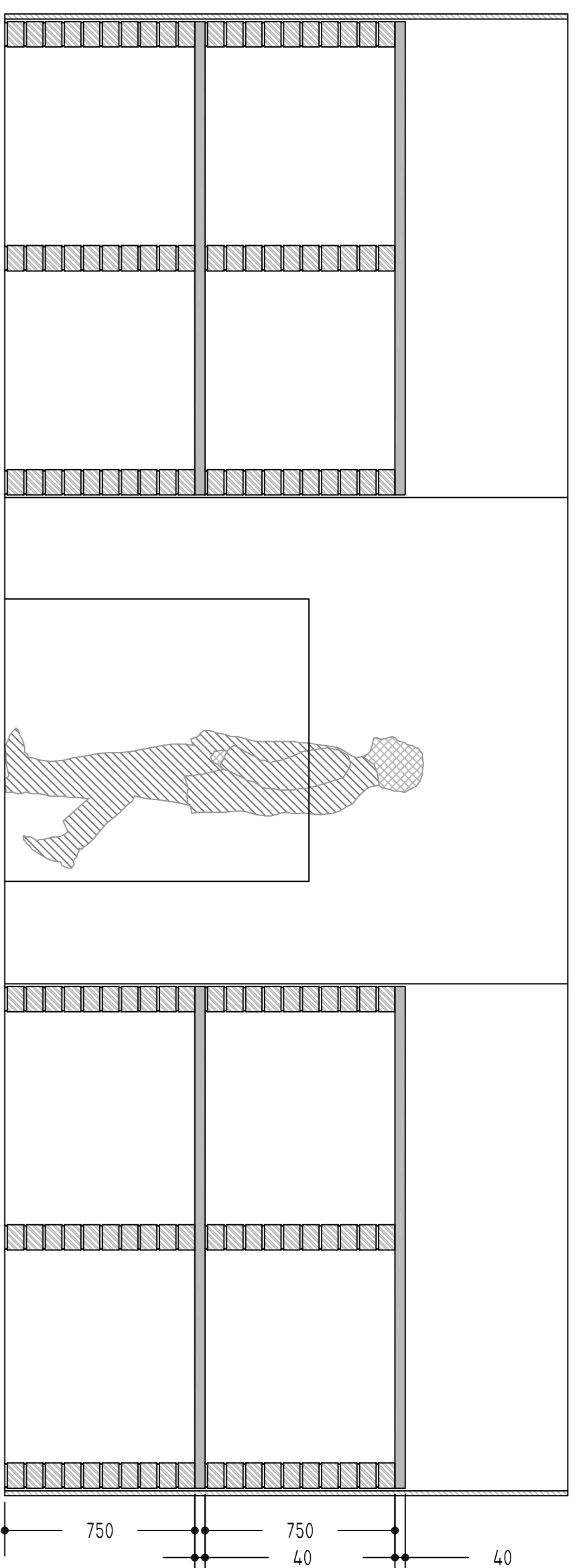

Revision	INN/1064/1/GIS/PL/11/18005/C	File No. 1064
----------	------------------------------	---------------

**Notes**  
Do not scale this drawing. Use figured dimensions only.  
Mark Snook Planning accepts no responsibility for any errors made by others in scaling from this drawing.  
Copyright © Mark Snook Planning.  
This drawing is Copyright and must not be reproduced, lent, or otherwise disclosed to any third party without the written consent of the owners of the Copyright.

**MSP**  
Town Planning Consultants.



The Pike House,  
Kingshill Road,  
Dursley, Glos.  
GL11 4BU  
Telephone:  
01453 549336  
E-Mail:  
marksnookplanning@hotmail.com

**Title:-**  
Wine Cellar, No. 1 Gray's Inn Square

**Client:-**  
The Honourable Society of Gray's Inn

**Drawing:-**  
Proposed Racking Dimensions

**Date:-**  
01/11/2018

**Scale:-**  
1:20 @ A1

**Drawn:-**  
M.H