

1 Existing Ground Floor Plan

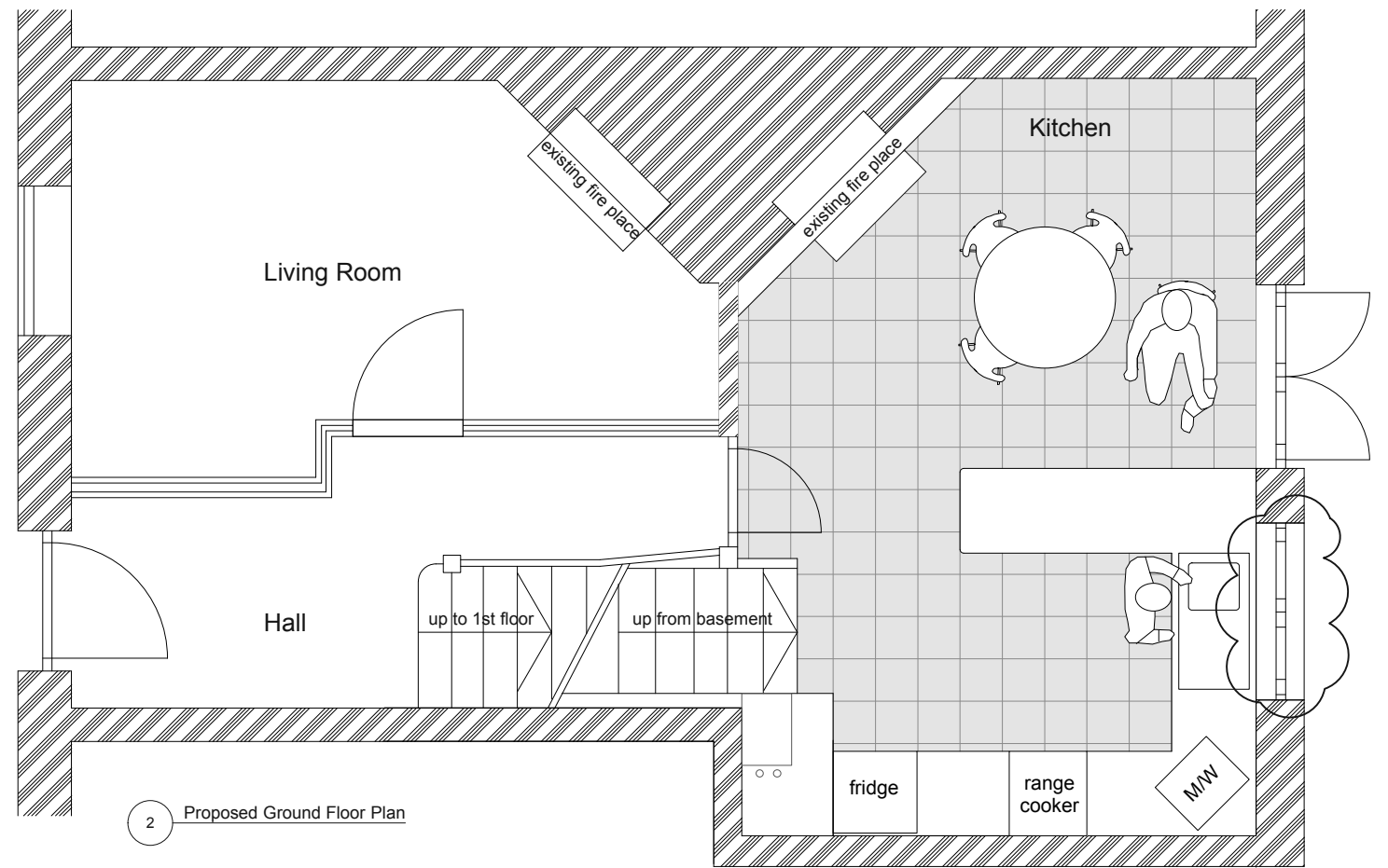
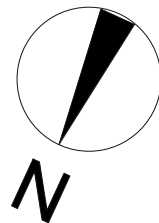

2 Proposed Ground Floor Plan

- items:
- 1- partial infill of french doors to mid height to facilitate installation of kitchen units.
 - 2 - reconfiguration of kitchen units and new floor finishes comprising of ceramic tiles.

Notes

Rev Description Date

Client
Dr Morris

Drawing Status
Planning

Job Number
P568
Job Title
4 Pond Square

Scale
1:50@A3
Date
27/02/19

Drawn By
MKS

Checked By

Rev

ARCHER ARCHITECTS LLP

Ground Floor West
Coate House
1-3 Coate Street
London E2 9AG

t: 020 7739 2424
f: 020 7739 1818
e: studio@archerarchitects.com
www.archerarchitects.com

Drawing Title
Ground Floor Plan; Existing
and Proposed

Drawing No
P568/02/101

DO NOT SCALE FROM THIS DRAWING
ALL DIMENSIONS ARE TO BE CHECKED ON SITE
THIS DRAWING IS TO BE READ IN CONJUNCTION WITH ALL CONSULTANTS INFORMATION
ARCHER ARCHITECTS RETAIN THE COPYRIGHT OF ALL INFORMATION WITHIN THIS DRAWING