

GENERAL NOTES:

- Ref:
- 1) Solid Plinth (Timber Finish Oak)
 - 2) Precast Concrete Ramp (Light Gray Ridged Finish for Grp)
 - 3) Reconstituted Stone Cill (Sand Stone Finish)
 - 4) Timber Slat Canopy (Timber Finish & Coated with protection)
 - 5) Soldier Course (Brickslip Finish EBS Sanded Red Stock)
 - 6) Flat Coping Stone (Sand Stone Finish)
 - 7) Upstand to visually hide the roof & guttering system
 - 8) Aluminum framed windows (Dark Grey Powder-Coated Finish)
 - 9) Ironmongery fence full height (Jet Black Gloss Coat Finish)
 - 10) New secure & lockable ironmongery entrance gate
 - 11) Eurobrick slip brick product (EBS Sanded Red Stock)



Ref: 5 - Soldier Course (Brickslip Finish Britannia Range Deep Sanded Red)



Ref: 4 - Timber Slat Canopy (Timber Finish & Coated with protection. Colour: T.B.C)



Ref: 6 - Flat Coping Stone (Sand Stone Finish)



Ref: 1 - Solid Plinth (Timber Finish Oak)



Ref: 3 - Reconstituted stone cill (Sand Stone Finish)



Ref: 2 - Precast Concrete Ramp (Light Gray Ridged Finish for Grp)



A	Issue For Approval	02/19
No	Revision / Issue	Date

Site :
Land Adjacent to Pegasus Court
105 St. Pancras Way
London
NW1 0RA

Project Title :
Construction of a one bedroom dwelling with a total internal floorspace of 50m²

Client :
Conway Investments Ltd 86
West Green Road
2/7 Brewery Square
London
N15 5PD

Do not scale from this drawing. The information may be suitable for discussion purposes and for obtaining Planning Approval Only. This drawing is NOT for construction purposes and should not be relied upon for any other works. This drawing is copyright and may not be copied or altered in any way except by way of written permission from the designers.

Copyright 2016 - 2019

Project Ref No : ABP-LAPC-70	Sheet No : MS-0
Date : February 2019	Drawn By : ABP
Scale : VARIED @ A-3	

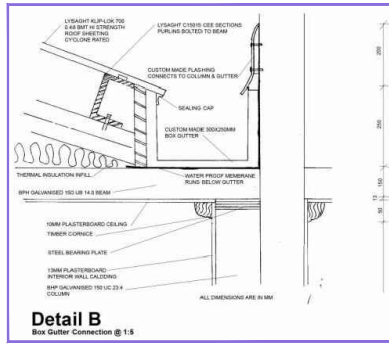

Detail B
Roof Soffit Construction @ 1:5



Ref: 8 - Aluminum framed windows (Dark Grey Powder-Coated Finish)



Ref: 9 - Ironmongery fence full height (Jet Black Gloss Coat Finish)



Ref: 10 - New secure & lockable ironmongery entrance gate

GENERAL NOTES:

- Ref:
- 1) Solid Plinth (Timber Finish Oak)
 - 2) Precast Concrete Ramp (Light Gray Ridged Finish for Grp)
 - 3) Reconstituted Stone Cill (Sand Stone Finish)
 - 4) Timber Slat Canopy (Timber Finish & Coated with protection)
 - 5) Soldier Course (Brickslip Finish EBS Sanded Red Stock)
 - 6) Flat Coping Stone (Sand Stone Finish)
 - 7) Upstand to visually hide the roof & guttering system
 - 8) Aluminum framed windows (Dark Grey Powder-Coated Finish)
 - 9) Ironmongery fence full height (Jet Black Gloss Coat Finish)
 - 10) New secure & lockable ironmongery entrance gate
 - 11) Eurobrick slip brick product (EBS Sanded Red Stock)

A	Issue For Approval	02/19
No	Revision / Issue	Date

Site :
Land Adjacent to Pegasus Court
105 St. Pancras Way
London
NW1 0RA

Project Title :
Construction of a one bedroom dwelling with a total internal floorspace of 50m²

Client :
Conway Investments Ltd 86
West Green Road
2/7 Brewery Square
London
N15 5PD

Do not scale from this drawing. The information may be suitable for discussion purposes and for obtaining Planning Approval Only. This drawing is NOT for construction purposes and should not be relied upon for any other works. This drawing is copyright and may not be copied or altered in any way except by way of written permission from the designers.

Copyright 2016 - 2019

Project Ref No : ABP-LAPC-70	Sheet No : MS-1
Date : February 2019	Drawn By : ABP
Scale : VARIED @ A-3	

Ref: 7 - Upstand to perimeter to conceal roof fall & guttering

Ref: 8 - Glazing to be aluminium frame with a dark grey powder-coated finish

Soldier course added to fenestration

Ref: 9 - New robust ironmongery fence to be set back behind existing trees

Existing party fence wall to rear of site

Ref: 10 - New secure & lockable ironmongery entrance gate

APPROVED EAST ELEVATION
Scale: 1/100

High quality reconstituted stone cills to fenestration

Ref: 11 - Brick-slip cladding to timber-frame

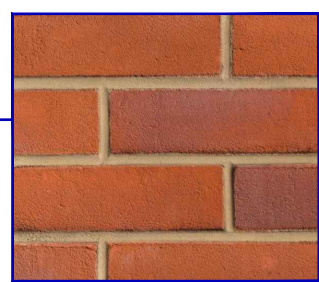

Ref: 11 - Sanded Red Stock

PROPOSED MATERIALS
Scale: 1/100

GENERAL NOTES:

- Ref:
- 1) Solid Plinth (Timber Finish Oak)
 - 2) Precast Concrete Ramp (Light Gray Ridged Finish for Grp)
 - 3) Reconstituted Stone Cill (Sand Stone Finish)
 - 4) Timber Slat Canopy (Timber Finish & Coated with protection)
 - 5) Soldier Course (Brickslip Finish EBS Sanded Red Stock)
 - 6) Flat Coping Stone (Sand Stone Finish)
 - 7) Upstand to visually hide the roof & guttering system
 - 8) Aluminum framed windows (Dark Grey Powder-Coated Finish)
 - 9) Ironmongery fence full height (Jet Black Gloss Coat Finish)
 - 10) New secure & lockable ironmongery entrance gate
 - 11) Eurobrick slip brick product (EBS Sanded Red Stock)

A	Issue For Approval	02/19
No	Revision / Issue	Date

Site :
 Land Adjacent to Pegasus Court
 105 St. Pancras Way
 London
 NW1 0RA

Project Title :
 Construction of a one bedroom dwelling with a total internal floorspace of 50m²

Client :
 Conway Investments Ltd 86
 West Green Road
 2/7 Brewery Square
 London
 N15 5PD

Do not scale from this drawing. The information may be suitable for discussion purposes and for obtaining Planning Approval Only. This drawing is NOT for construction purposes and should not be relied upon for any other works. This drawing is copyright and may not be copied or altered in any way except by way of written permission from the designers.

Copyright 2016 - 2019

Project Ref No : ABP-LAPC-70	Sheet No : MS-2
Date : February 2019	
Scale : VARIED @ A-3	Drawn By : ABP



APPROVED WEST ELEVATION
 Scale: 1/100