



Marcus Foster
Arboricultural Design & Consultancy

BA (Hons) | NDArb | Techcert (AA) | MArborA

Arboricultural Method Statement
(BS5837: 2012)

Site details:

La Sainte Union School
Highgate Road
London
NW5 1RP

Client details:

Watkinson & Cosgrave
c/o
La Sainte Union School

Date of Report:

4th March 2019

Report Reference:

AMS/MF/025/19

Report Prepared by:

Marcus Foster
BA (Hons) NDArb. TechCert (AA) MArborA

Marcus Foster
Arboricultural Design & Consultancy
Tel: + 44 (0) 7812 024 070
Email: marcus@mfdesignconsultancy.com
www.mfdesignconsultancy.com

Contents

1. Introduction
2. Summary
3. Sequence of Events
4. Tree Protection Specifications
5. Communication, Monitoring & Compliance
6. Tree Works Schedule
7. Appendices

A: Tree Survey

B: T001 - Tree Protection Plan (TPP)

C: Proposed Drawings

D: Summary AMS Document

E: Tree Protection Sign

F: Tree Protection Fencing Specification

G: References

1. Introduction

1.1 This report has been commissioned by Watkinson & Cosgrave to provide an Arboricultural Method Statement (AMS) for 1 x early mature to mature Ash tree (T1) being retained as highlighted within the proposed development at La Sainte Union School, Highgate Road, London, NW5 1RP.

1.2 The tree survey, report and recommendations included 1 x tree surveyed within close proximity of the development; there are other trees within the area but with adherence to the AMS construction site activities will be managed away from any other trees. The aim of this report is to ensure tree T1 is both retained and preserved in order to both protect the amenity value provided and also the Conservation Area status. Trees can be retained and comprehensively protected during the proposed redevelopment of the site by clearly setting out tree protection methods, construction techniques and working practices. This report provides this information; principles that are approved and enforced by the local planning authority.

1.3 It should be noted that this is a site specific Arboricultural Method Statement (AMS) produced solely for the physical protection of the tree identified on the plan within La Sainte Union School within the report and is not relevant to any other site or situation.

1.4 This report and the opinions within it have been produced by Marcus Foster, a qualified Arboriculturist holding a National Diploma in Arboriculture, and the Arboricultural Association's Technicians Certificate, Professional Tree Inspection Certificate (LANTRA) and a Professional Member of the Arboricultural Association in addition to a degree in History & Society. Work experience within the industry includes work as a Contracts Manager for an Arboricultural Association Approved Company, a Local Authority Tree Preservation Officer and an independent Arboricultural Consultant.

1.5 The following documentation has been referred to relating to the tree or the site at this property for the compilation of this report:

*Watkinson + Cosgrave
LSU dwgs 4803.2, GA-01
November 2018*

This information is included within *Appendix D*.

1.6 The AMS must be made available to all contractors and operatives on the site during the construction process so that they fully understand the importance of the measures set out for tree protection.

2. Summary

2.1 Tree T1 is the only tree located within close proximity of the development which comprises the installation of a lean-to structure within a hard landscape area which currently exists. The implementation of the proposed development can be achieved whilst retaining the tree for the long term by taking into account all information within this report.

2.2 Tree T1 is an early mature to mature Ash tree which is sited within soft landscape ground to the north of the area of proposed development and to the south of an existing access road. The tree, a fair specimen, is rated as 'C2' (BS5837:2012) and has the following key characteristics:

- Tree is generally structurally sound at the base with evenly distributed root flare
- Sited within raised mound within 1m radius (0.5m only to east). Straight main stem and crown lifted to 4-5m (7m to east towards school building) - fair occluding growth
- Significant crown thinning, particularly to north / east recovering although some selective dieback throughout crown. Minor deadwood throughout - some developing major deadwood
- RPA radius of 4800mm which encroaches within development area to south

2.3 For tree T1 the document will give site specific instructions to provide protection. The methods are set out in a logical and coherent sequence for ease of understanding and implementation. The operations that will require comprehensive tree protection include:

- Removal of existing hard landscape feature where new supporting posts are required
- General Construction Site Activities and access
- Ground works, foundations within close / relevant proximity to retained tree for implementation of new supporting posts

2.4 The Tree Protection Plan (TPP), indicates precise locations of protective barriers and ground protection, precautionary areas and general arboricultural solutions where applicable.

2.5 This document and the associated Tree Protection Plan will be endorsed by planning conditions, agreement or obligation as appropriate.

3. Sequence of Events

3.1 The following sequences are governed by operational constraints and are subject to change. The consulting arboriculturist must be noted of any changes to this schedule prior to implementation where trees / tree protection measures as existing are likely to be affected.

3.2 Pre-development stage

- a) Pre Contract / Commencement site meeting between client and contractor. The meeting should take place before any development activity begins to confirm the timing and implementation of the agreed tree protection measures including site storage and any pertinent time scheduled for site operators.
- b) Tree protection measures installed as specified within Tree Protection Plan
- c) Site to be inspected by consulting arboriculturist with contractor meeting held

3.3 Development Stage

- d) Implementation of development adhering to tree protection measures as outlined within this AMS
- e) Arboricultural Supervision at key stages as highlighted within AMS
- f) The local authority arboriculturist will have free access to the site and forward any recommendations directly to the consulting arboriculturist.
- g) Tree Protection discharge

4. Tree Protection Specifications

4.1 The implementation of the lean to structure with associated foundations should be implemented with tree protection as outlined within this AMS report. For clarification, an additional summary of the AMS has been provided to ensure tree protection and supervision is applied at all key stages. This document, supplied separately and also as Appendix C is as follows:

LA SAINTE UNION SCHOOL_ AMS SUMMARY_040319

4.2 The implementation of tree protection measures including removal of existing hard landscape features and undertaking hand dug excavations must be adhered to at all times during the development process. In addition general construction site activities must adhere to the AMS at all times.

Tree Protection Fencing

4.3 Tree protection for tree T1 is to implemented as follows

- To specification outlined within Tree Protection Plan (TPP) with use of 4 x 2400mm length *Herras* fence panels
- Tree Protection Fencing area to provide Construction Exclusion Zone (CEZ)
- To be implemented prior to the commencement of any development works

RPA Precautionary Zone & Storage Area

4.4 As highlighted within TPP, the RPA requires access for the lightweight construction site activities - this area must be clearly demonstrated to site foreman and incorporated within construction methodology.

4.5 Based on setting out of site as above, the designation of a site storage area outside of the RPA must be provided with agreement from the arboricultural consultant. This area should incorporate the following:

- Delivery of materials and chemicals
- Storage of materials and chemicals
- Mixing of Chemicals
- Construction site Infrastructure
- Construction site welfare

Guidance in relation to Excavations & Root Severance

4.6 Excavations are required within the RPA of this tree for supporting posts and foundations only but will be selectively located only as shown within the *Watkinson + Cosgrave* LSU dwgs 4803.2, GA-01 - see extract below:

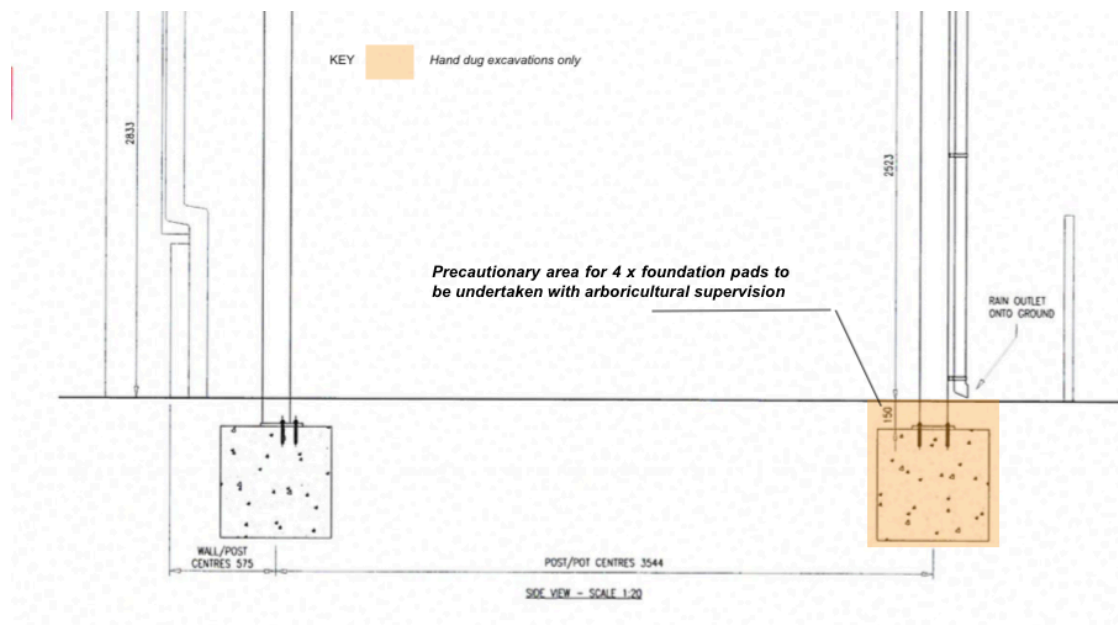

Watkinson + Cosgrave LSU dwgs 4803.2, GA-01 - Annotated Extract by MF - 040119
DO NOT SCALE FROM EXTRACT

4.7 The implementation should be undertaken by hand digging only. It is important to note that in the case of major roots being discovered the following points should be closely adhered to:

- **The severance of any tree roots encountered larger than 25mm in diameter MUST NOT occur**
- **If at any point it is deemed not possible to continue with excavations without having to damage very significant tree roots - in excess of 25mm diameter - the Local Authority Tree Officer and / or the appointed Arboricultural Consultant must be contacted**
- **With the encountering of large roots in a area where posts are required structural engineering solutions to accommodate the roots with lintels or similar methods must be applied**

Implementation of foundation works within RPA of retained tree

4.8 For supporting posts works the below protective measures must apply where carried out within the RPA of tree T1 and as specified within contractor drawings - *Appendix D*:

- Removal of existing hard landscape pavers by hand only
- Hand digging for installation of posts close adherence to Excavations and Root Severance Guidance (*Section 4.3*) is required at all times
- No amendment to existing hard landscape surface other than where holes have been hand dug to construct fence posts
- No build up / increase of levels of the underlying soil surface will occur during final landscaping works within the RPA of retained tree T1 for the landscape process
- Undertaking of works to be under arboricultural supervision

4.9 For installation of concrete foundations for the posts where located in positions where significant roots are not affected the sheathing of the minimal concrete post foundation is recommended to avoid any leaching of the material within the subsoil.

Installation of Utility Services

4.10 No utility services are specified within the RPA. However, if for any reason installation of utility services within the Root Protection Area of tree T1, the consulting arboriculturist and Local Authority must be notified prior to implementation and the following details adhered to:

- Trenching for the installation of underground services severs any tree roots present and can have a detrimental impact on the structural integrity of affected trees. When services are required to pass through a Tree Protection Area, detailed plans showing proposed routes should be drawn up in conjunction with the consulting arboriculturist to avoid long term health and anchorage problems for related trees.
- The preferable method for trenching is to use a 'Air Spade' or similar to remove soil with compressed air, therefore minimising damage to roots in the process. Hand dug excavations are also permissible if undertaken to specifications outlined within *Section 4.3*.

4.11 Further reference can be made to National Joint Utilities Group (Volume 4, Issue 2) for guidance but any approach must be approved by both the consulting arboriculturist and Local Authority tree officer.

5. Communication, Monitoring and Compliance

5.1 In ensuring that all Tree Protections Specifications as highlighted within this AMS are closely adhered to at all times, it is important to set out for the long term of the development, communication details for key individuals and tasks that require monitoring.

5.2 The key individuals appointed for advising and complying with Tree Protection specifications must adhere to the following at all times:

- Relevant parties / key individuals must be advised of any changes in personnel or contractor during the development process.
- Relevant parties / key individuals must be responsible for relaying information regarding tree protection within work force where deemed applicable / relevant

Arboricultural Supervision Schedule

5.3 The appointment of an arboricultural consultant will be required within the construction management of the development to carry out all arboricultural supervision for the scheme. In addition to attending site, *Site Meeting Notes* will be prepared to provide a summary of site conditions, therefore highlighting any problems or solutions required in order to ensure close adherence to the AMS is provided at all times.

5.4 This will ensure that Tree Protection is implemented as specified within this report therefore avoiding significant tree root damage or compaction of tree roots. The following is recommended:

Agreement of Construction Methodology / Site Storage / Pre-Commencement Meeting

Arboricultural supervision (1 x site visit) undertaken as pre-commencement check to ensure tree protection correctly installed

Supervision of Hand Dug Foundation holes

Arboricultural supervision (1 x site visit and further as deemed appropriate) undertaken during installation of works requiring excavations

Discharge of Tree Protection

Arboricultural supervision (1 x site visit and further as appropriate) to inspect tree and ground conditions upon completion of development

5.5 In addition to the implementation of arboricultural supervision as above, the Local Authority Tree Officer will have open site access at any point during the development to undertake inspections as deemed appropriate

6. Tree Works Schedule

6.1 Any tree work should be carried out to BS 3998; 2010 'Tree Work – Recommendations' and to standards set within the Arboricultural Association's 'Standard Form of Contract and Specifications for Tree Work' by a qualified arboriculturist.

6.2 The works specified below are recommended to be carried out as part of or independently of the proposed development as are recommended in line with good Arboricultural practice - these can be implemented upon completion / within 6 months of this report.

6.3 Tree Works Specification

T1 Ash

Remove any major deadwood

7. Appendices

Appendix A

Tree survey (BS5837:2012) February 2019

La Sainte Union School
Highgate Road
London
NW5 1RP

-  Category A
-  Category B
-  Category C
-  Category U

BS5837:2012 TREE SURVEY
La Sainte Union School, La Sainte Union Convent, Highgate Road, London, NW5 1RP
Arboricultural Impact Assessment - Tree Schedule (BS5837:2012) - 270219

Tree No	Species	Height (m)	DBH (mm)	Spread (m)	Age	Structural Condition	Vigour	BS5837 (2012) Rating	Remaining Contribution (years)	Comments / Structural Condition	Root Protection Area (RPA) m2	Root Protection Area (RPA) Radius (m)
T1	Ash	13	410	N: 5 E: 4 S: 6 W:5	M	F	F	C2	10 years +	Tree is generally structurally sound at the base with evenly distributed root flare - raised mound within 1m radius (0.5m to east). Straight main stem and crown lifted to 4-5m (7m to east towards school building) - fair occluding growth. Significant crown thinning, particularly to north / east recovering although some selective dieback throughout crown. Minor deadwood throughout	76.06	4.8

Appendix B

T001 Tree Protection Plan (TPP)

La Sainte Union School
Highgate Road
London
NW5 1RP

Tree Canopy Colour Key: BS5837: 2012 (see Section 2.6)

-  **Category A**
-  **Category B**
-  **Category C**
-  **Category U**

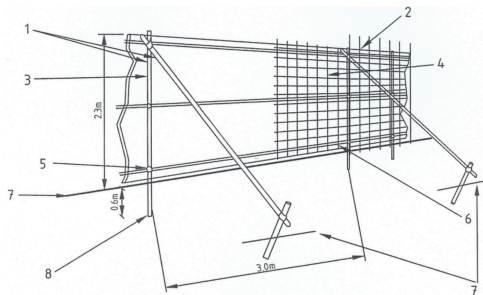

- | | |
|--|--|
| 1 Standard scaffold poles | 5 Standard clamps |
| 2 Uprights to be driven into the ground | 6 Wire twisted and secured on inside face of fencing to avoid easy dismantling |
| 3 Panels secured to uprights with wire ties and, where necessary, standard scaffold clamps | 7 Ground level |
| 4 Weldmesh wired to the uprights and horizontals | 8 Approx. 0.6m driven into the ground |

NOTE:

The construction exclusion zone (CEZ) is the area protected by tree protection fencing. Within the CEZ the following exclusions shall apply:

- No excavation
- No storage of materials or equipment
- No changes in levels
- No installation of services without arboricultural supervision
- No access

The fencing shall be maintained in a condition fit-for-purpose throughout the construction process

Implementation of tree protection fencing prior to the commencement of any construction site activities - recommended to be constructed of 4 x 2400mm length Herras fence panels constructed as per diagram within this TPP

Root Protection Area (RPA) 4800mm distance to be a designated tree protection area allowing lightweight pedestrian construction access only but with strict adherence to:

- No storage of materials and / or chemicals
- No storage of spoil
- No mixing of chemicals
- No installation of utility services

STORAGE OF ALL MATERIALS OUTSIDE CONSTRUCTION EXCLUSION ZONE (CEZ)

STORAGE OF ALL MATERIALS OUTSIDE CONSTRUCTION EXCLUSION ZONE (CEZ)

Precautionary dig area as highlighted to be undertaken under arboricultural supervision only and using hand tools only - refer to AMS SUMMARY within AMS report

	CATEGORY A
	CATEGORY B
	CATEGORY C
	CATEGORY U
	RPA (RADIUS)
	PRECAUTIONARY ZONE
	TREE PROTECTION FENCING

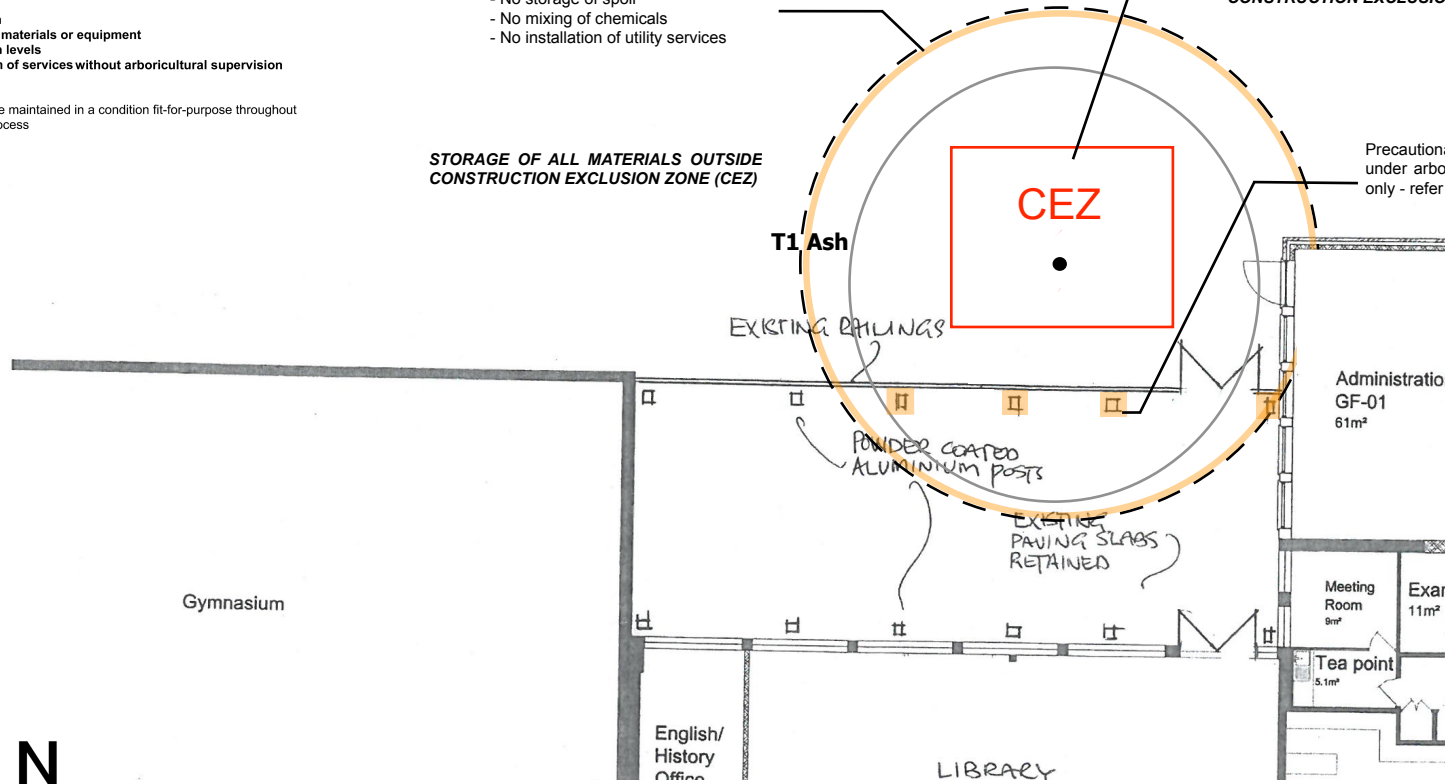

Rev.	Date	Checked
/		MF

JOB TITLE
LA SAINTE UNION SCHOOL, HIGHGATE ROAD, N6

DWG TITLE
TREE PROTECTION PLAN (TPP)

SCALE: 1:100 @ A3
DATE: MARCH 19

JOB NO: AMS/MF/025/19
DWG NO: T001

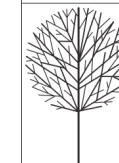

T: 0781 2024070
marcus@mfdesignconsultancy.com
www.mfdesignconsultancy.com

Marcus Foster
TREE CONSULTANCY

BSS837 (2012) TREE SURVEY NOTES

1. In accordance with BSS837(2012) this drawing is a colour coded schedule and should not be read in black and white
2. If received electronically it is the recipients responsibility to print this drawing to correct scale. Only written dimensions should be used where not printed to scale.
3. This drawing should be read in conjunction with all other relevant drawings and specifications
4. Marcus Foster Arboricultural Design & Consultancy accepts no liability for any use of this document other than by its client and only for the purposes for which it was prepared and provided

Appendix C

AMS TREE PROTECTION SUMMARY DOCUMENT

La Sainte Union School
Highgate Road
London
NW5 1RP



Marcus Foster
Arboricultural Design & Consultancy
BA (Hons) | ND Arb | AATechcert (ArborA)

LA SAINTE UNION SCHOOL
LEAN-TO TREE PROTECTION METHOD STATEMENT SUMMARY:
AMS/MF025/19

The following document is a supplementary summary of tree protective measures should be read, understood and signed by all operatives working on site and should be available for reference AT ALL TIMES

Reference should be made to T001 - Tree Protection Plan as included within AMS/MF/025/19

Tree Protection Measure 1
Implement Tree Protection Fencing



Tree Protection Measure 2
Agreement of Site Storage & Construction Methodology



Tree Protection Measure 3
Implementation of supporting posts for lean to under arboricultural supervision



Tree Protection Measure 4
Site Discharge / Tree Inspection upon completion of development

Arboricultural Supervision should be undertaken at all times where specified

Consulting Arboriculturist - Marcus Foster :
Tel: 0781 202 4070 Email: mail@marcus-foster.com
Local Authority - London Borough of Camden
Tel: 020 7974 5939 Email: nick.bell@camden.gov.uk

SUMMARY OF TREE PROTECTION GUIDELINES

Tree Protection Measure 1: Implement Tree Protection Fencing

Refer to T001 - TPP for position of fencing and specification
To be agreed with consulting arboriculturist further to tree protection measure 2 below



Tree Protection Measure 2: Agreement of Site Storage & Methodology Implement Arboricultural Supervision

The storage area for materials, plant machinery, chemicals and aggregates is recommended to be outside of the RPA as recommended within the Tree Protection Plan and therefore tree T1 will not be affected by this factor. The location should be agreed with the consulting arboriculturist



Tree Protection Measure 3: Implementation of Supporting Foundations Implement Arboricultural Supervision

For supporting post implementation the below protective measures must apply where carried out within the RPA of tree T1 and as specified within contractor drawings - Appendix D within AMS and under arboricultural supervision:

Hand digging for installation of fencing / hard landscape features for all works to determine existence and/or location of larger roots in this area and avoid damage for foundation pads. Close adherence to Excavations and Root Severance Guidance is required at all times - see AMS and where deemed appropriate structural engineering solutions MUST be applied as agreed with consulting Arboriculturist and LB Camden.

No amendment to existing hard landscape surface other than where holes have been hand dug to construct supporting posts. for the posts where located in positions where significant roots are not affected the sheathing of the minimal concrete post foundation is recommended to avoid any leaching of the material within the subsoil.

No build up / increase of levels of the underlying soil surface will occur during final landscaping works within the RPA of retained tree T1



Tree Protection Measure 4: Tree Protection Discharge Implement Arboricultural Supervision

Arboricultural site visit to inspect tree and ground conditions upon completion of development

Page 2 of 2
END OF SUMMARY REPORT

Appendix D

Related Drawings

**La Sainte Union School
Highgate Road
London
NW5 1RP**

*Watkinson + Cosgrave
LSU dwgs 4803.2, GA-01
November 2018*

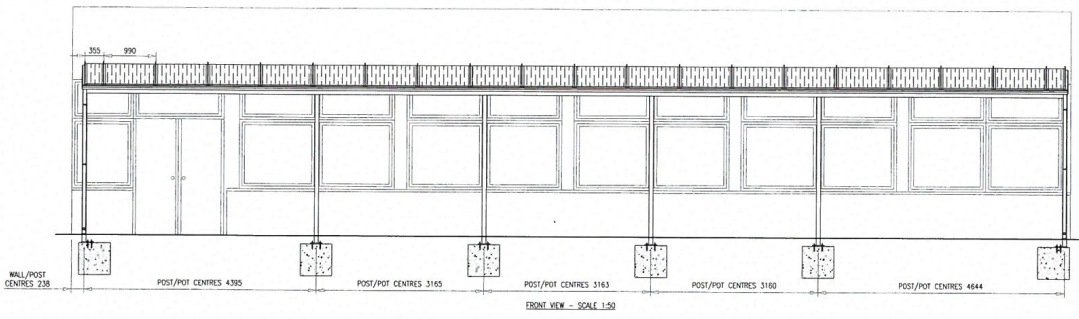

PLEASE NOTE: PANELS TO BE CUT AROUND DOWNPIPES ON-SITE.

PLEASE NOTE: CABLE TO BE FIXED BACK TO BUILDING IN CORNER BY OTHERS.

PLEASE NOTE: PANELS TO BE CUT AROUND DOWNPIPES ON-SITE.

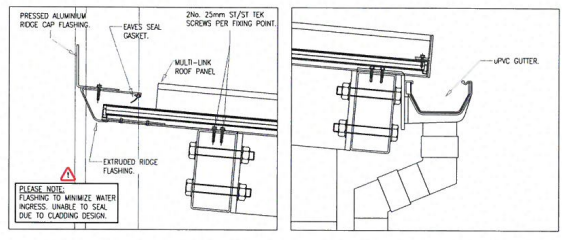
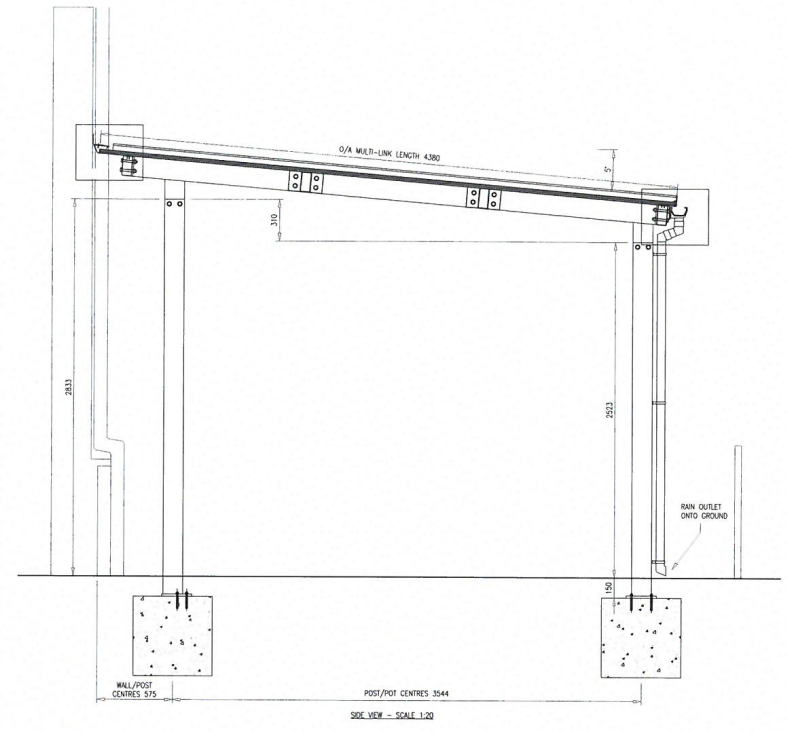
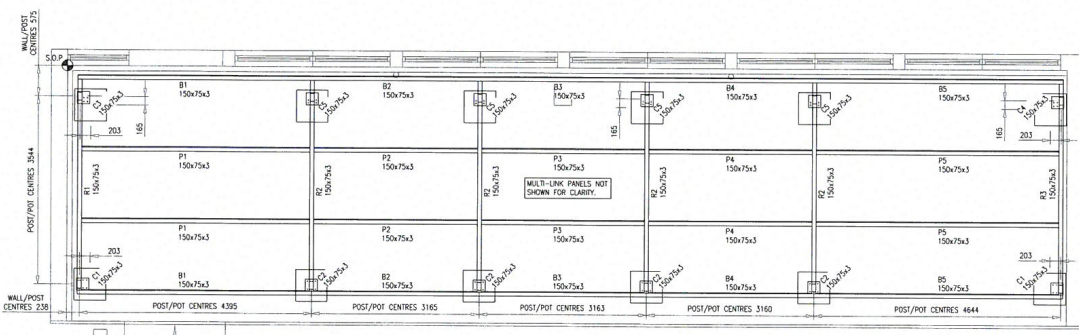
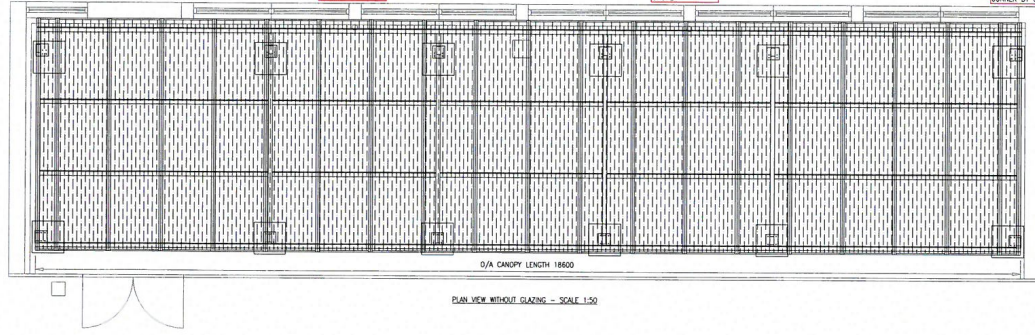

PLEASE NOTE: FLASHING TO MINIMIZE WATER INGRESS. UNABLE TO SEAL DUE TO CLADDING DESIGN.

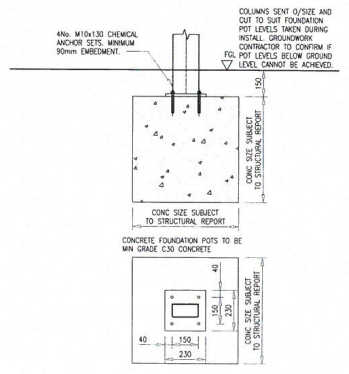

SECTION (GROUNDWORKS) SCALE 1:15

SPECIFICATION / NOTES:

ROOF GLAZING
 BAR/PANEL TYPE - MULTI-LINK
 FRAGILITY - NON-FRAGILE CLASS B TO ACR(M001:2011)
 STALK CUT BACK SIZE - 100mm
 GLAZING MATERIAL - POLYCARBONATE
 GLAZING THICKNESS - 16mm
 GLAZING COLOUR - TBC
 GLAZING BAR COLOUR - TBC
 GLAZING BRAND - MAKROLON

STRUCTURE
 STRUCTURE MATERIAL - ALUMINIUM
 STRUCTURE COLOUR - TBC
 SECTIONS - AS INDICATED ON DRAWING
 FINISH - POLYESTER POWDER COATED

FLASHINGS
 FLASHING MATERIAL - PRESSED ALUMINIUM
 FLASHING COLOUR - TBC
 BUTYL SEAL - WHITE/LEAD LOOK

RAIN WATER GOODS
 GUTTER MATERIAL - uPVC
 GUTTER COLOUR - TBC
 DOWNPIPE MATERIAL - uPVC
 DOWNPIPE COLOUR - TBC
 DRAINING TO - ACC BY OTHERS

GROUNDWORKS
 CONCRETE TYPE - C20 (MINIMUM)
 FOUNDATION POT SIZE - REFER TO STRUCTURAL CALCULATIONS
 BACK FILL MATERIAL - ASPHALT BY OTHERS
 MINIMUM GROUND BEARING PRESSURE - 95kN/M² (TO BE CONFIRMED BY OTHERS)

FIXINGS
 ALL FIXINGS SCREWS TO BE STAINLESS WITH THE EXCEPTION OF CHEMICAL ANCHORS WHICH ARE ZINC COATED STEEL c/w NYLON WASHERS

SETTING OUT DIMENSIONS TAKEN FROM
 TWINFIX SITE SURVEY

SETTING OUT DIMENSIONS
 CANOPY SETTING OUT DIMENSIONS ARE THE RESPONSIBILITY OF TWINFIX
 FOUNDATION SETTING OUT DIMENSIONS ARE THE RESPONSIBILITY OF TWINFIX

TOLERANCES
 UNLESS STATED OTHERWISE
 GENERAL BUILDING DIMENSIONS +/- 10mm
 SETTING OUT DIMENSIONS +/- 25mm
 FABRICATION DIMENSIONS +/- 2mm
 PRODUCTION DIMENSIONS +/- 2mm
 ALL TOLERANCES ARE NON-ACCUMULATIVE

GENERAL
 ALL DIMENSIONS IN MILLIMETERS UNLESS STATED OTHERWISE.
 FOR WELDING STANDARDS REFER TO TWINFIX STANDARD FABRICATION FOLDER SHEET
 REFERENCES CMP-WS01 TO 06 INCLUSIVE (AVAILABLE ON REQUEST).
 DO NOT SCALE FROM THIS DRAWING.

NO.	DESCRIPTION OF REVISION	DATE	BY
ISSUED FOR APPROVAL			
TWINFIX			
TWINFIX LIMITED, 201 CAVENISH PLACE, BIRCHWOOD PARK, BIRCHWOOD WARRINGTON WA3 6WU TEL: 01925 811311 FAX: 01925 852955 WEB: www.twinfix.co.uk EMAIL: design@twinfix.co.uk			
<p>This drawing is a confidential communication and is the property of Twinfix Limited and is returnable on request. It must not be copied, loaned or communicated without the written consent of Twinfix Limited.</p>			
<p>CUSTOMER: WATKINSON COSGRAVE</p>			
<p>PROJECT: LA SAINTE UNION CATHOLIC SCHOOL</p>			
<p>DRAWING TITLE: CANOPY LAYOUT AND SECTION DETAILS</p>			
SCALE: A1	AS SHOWN	ISSUE DATE: 15.12.2018	DRAWN BY: HARRY ALCOCK
PROJECT No:	AREA No. (S)	DWG No.	REV No.
19709	-1	GA-01	-

Appendix E
Tree Protection Notice

Generic Tree Protection Notice
(BS5837: 2012):

La Sainte Union School
Highgate Road
London
NW5 1RP

Notice to be clearly shown on site
AT ALL TIMES



**TREE PROTECTION AREA
KEEP OUT !**

(TOWN & COUNTRY PLANNING ACT 1990)
TREES ENCLOSED BY THIS FENCE ARE PROTECTED BY
PLANNING CONDITIONS AND/OR ARE THE SUBJECTS OF A
TREE PRESERVATION ORDER.
CONTRAVENTION OF A TREE PRESERVATION ORDER MAY
LEAD TO CRIMINAL PROSECUTION

ANY INCURSION INTO THE PROTECTED AREA MUST BE
WITH THE WRITTEN PERMISSION OF THE LOCAL
PLANNING AUTHORITY



**PROTECTIVE FENCING. THIS
FENCING MUST BE
MAINTAINED IN ACCORDANCE
WITH THE APPROVED PLANS
AND DRAWINGS FOR THIS
DEVELOPMENT.**

Appendix F
Tree Protection Fencing
Specification

Tree Protection Fencing as outlined in
Diagram 2(BS5837: 2012):

Applicable for:

La Sainte Union School
Highgate Road
London
NW5 1RP

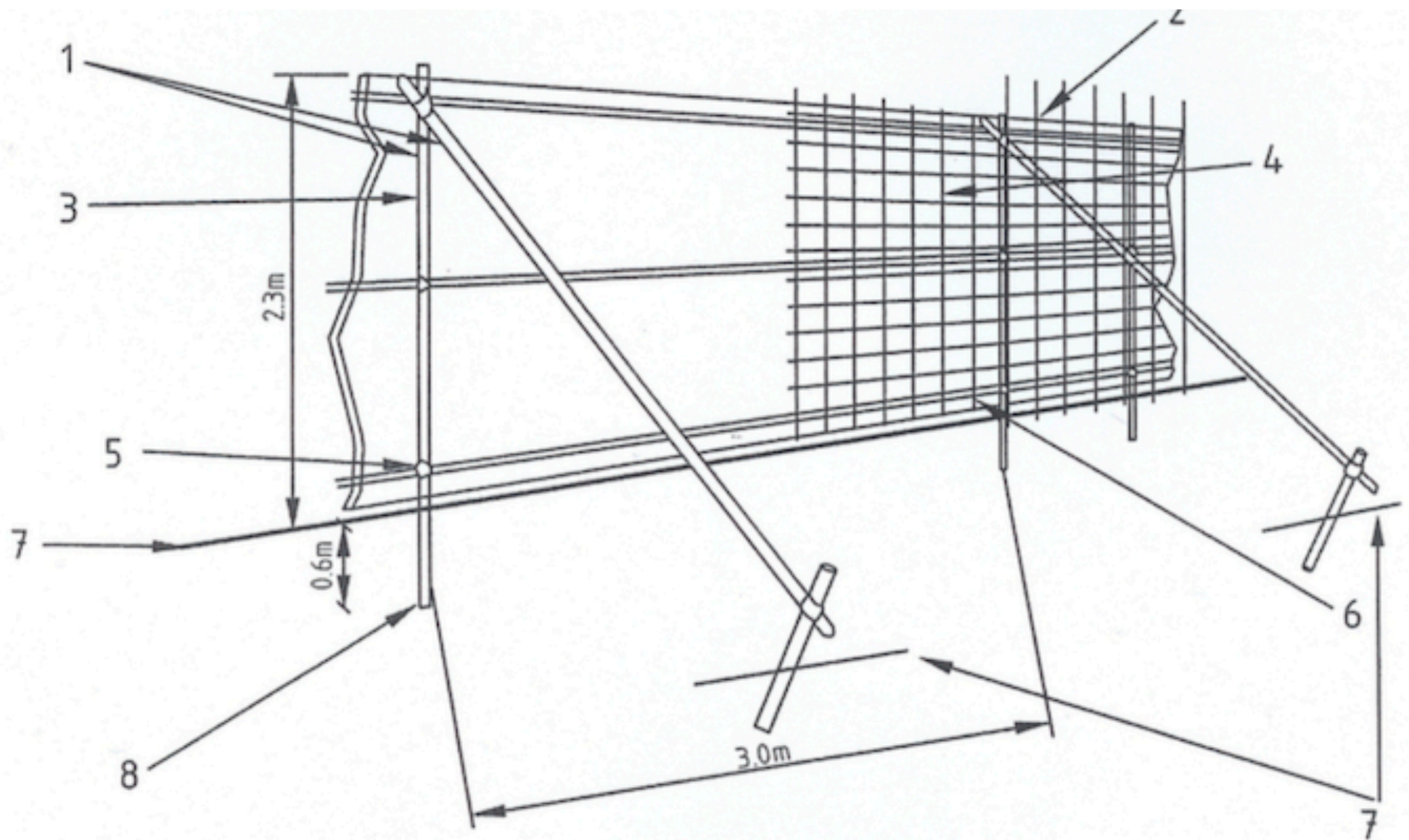

- 1 Standard scaffold poles
- 2 Uprights to be driven into the ground
- 3 Panels secured to uprights with wire ties and, where necessary, standard scaffold clamps
- 4 Weldmesh wired to the uprights and horizontals

- 5 Standard clamps
- 6 Wire twisted and secured on inside face of fencing to avoid easy dismantling
- 7 Ground level
- 8 Approx. 0.6m driven into the ground

Appendix G: References

1. *Arboricultural Practice Note 12: Driveways Close to Trees (APN12)* as provided by the Arboricultural Advisory and Information Service (2007)
2. *BS5837: British Standard: Trees in relation to construction - Recommendations*, British Standard (2012)
3. *Principles of Tree Hazard Assessment and Management*, Lonsdale, D. (Department for Transport, Local Government and the Regions, 1999)
4. *The Body Language of Trees*, Mattheck, C. and Breloer, H. (HMSO, 1994)
5. *Trees in Britain*, Philips, R. (Pan Books, 1978).
6. *Diagnosis of Ill Health in Trees*, Strouts, R. and Winter, (TSO, 1994)
7. *NJUG Guidelines for the Planning, Installation and Maintenance of Utility Apparatus in Proximity to Trees (Issue 2)*, (November 2007)