

**NOTE;**

glass panels cantilever 300mm above the top of the posts with no top rail to reduce the visual impact on the skyline when seen from street level

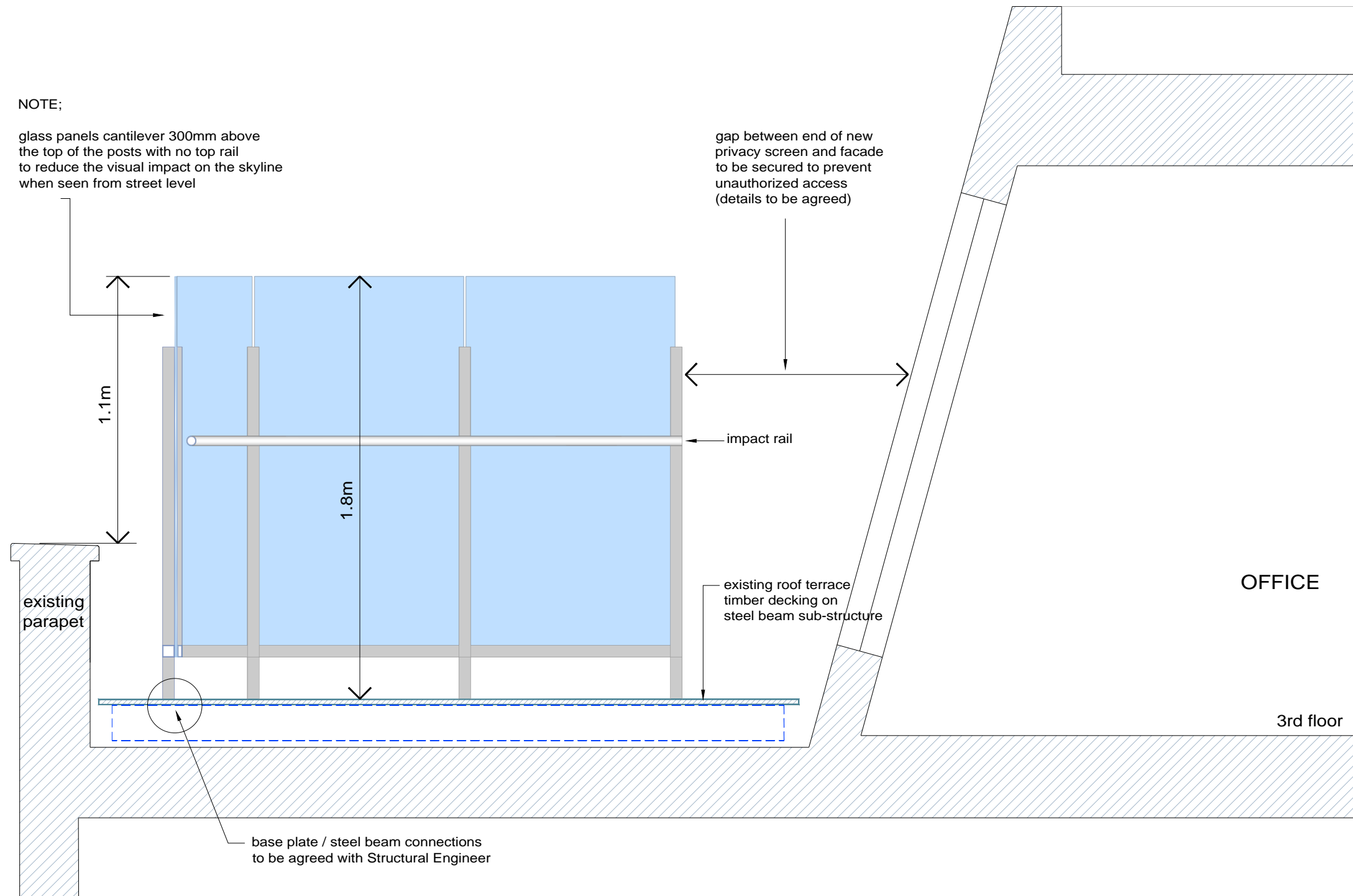

**DETAIL SECTION D-D**  
1:20 @ A3

**PROPOSED GLASS PRIVACY SCREEN - OUTLINE SPECIFICATIONS**  
(detail specifications to be agreed with supplier and Structural Engineer)

1.8m high (from roof terrace)

1.5m high box-section mild-steel posts @ 900mm ctrs  
with base plates and bolted connections to existing steel beam sub-frame  
capping pieces to posts and rails to secure the glass panels  
all steel components to be painted dark grey

12mm laminated glass with white PVB interlayer

40mm dia. stainless-steel guardrail to brace the glass panels against wind deflection and minimise accidental impact and/or abrasion damage

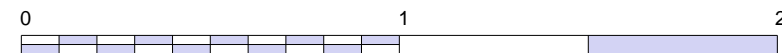

SCALE BAR IN METRES  
1:20 @ A3

Notes:

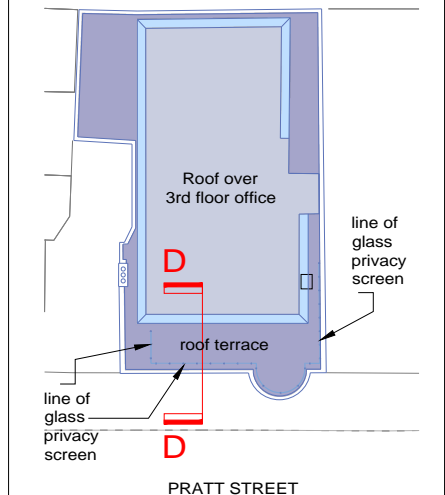

ORIENTATION PLAN  
1:500

0 10 20  
SCALE BAR IN METRES  
1:500 @ A3

rev	description	date
client		
Bosem LLP		
project		
Livery House, 7-9 Pratt Street, Camden NW1 0AE Proposed glass privacy screen to existing roof terrace		
drawing		
DETAIL SECTION D-D - PROPOSED		
computer file	PROJECT CAD	plot date
		11-01-2019
project number	17-147	scale
		1:20 @ A3
drawing number	P16	rev
		issue status
		PLANNING

**spirit**  
architecture & design ltd

121 meyers road tufnell park london n19 4py uk  
tel: +44 (0)20 7272 1367  
e: studio@spirit-architects.co.uk  
w: spirit-architects.london

This drawing is to be read in conjunction with all related drawings. Do not scale from this drawing. All dimensions must be checked and verified on site before commencing any work or producing shop drawings. The originator should be notified immediately of any discrepancy. This drawing is copyright and remains the property of Spirit - Architecture & Design Ltd.