

N.B. Elevations shown flattened for clarity.

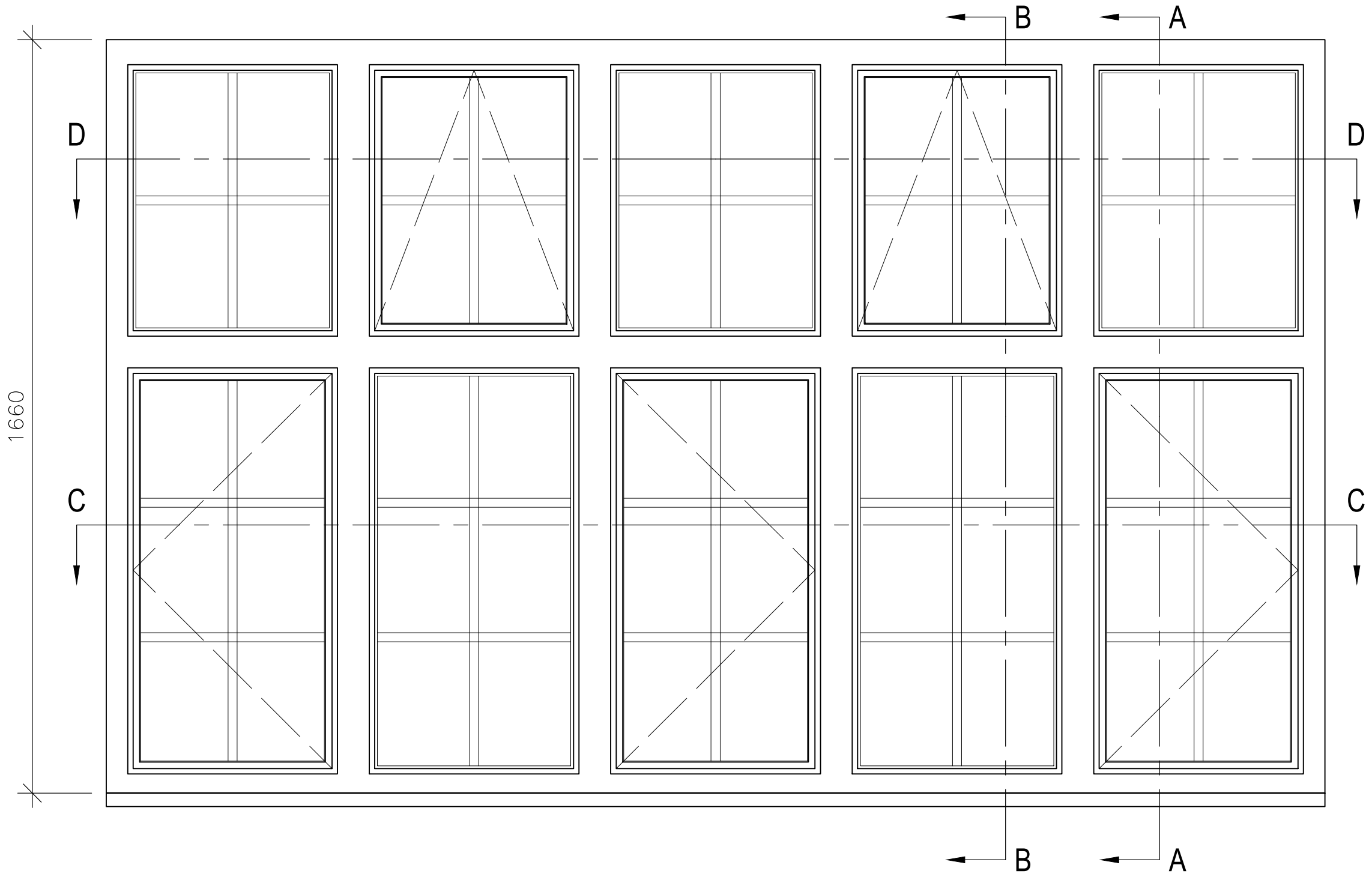

Internal Elevation

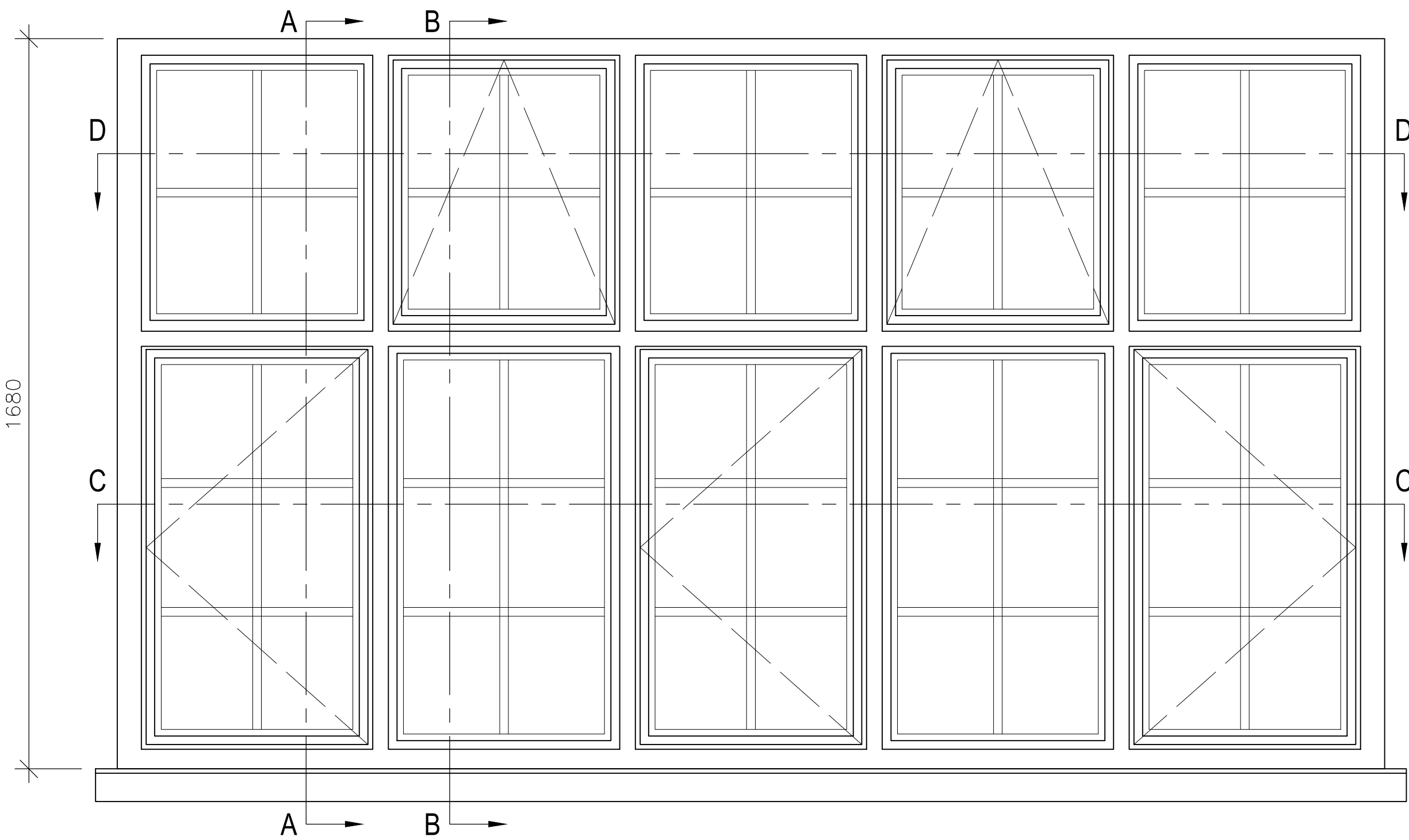

External Elevation

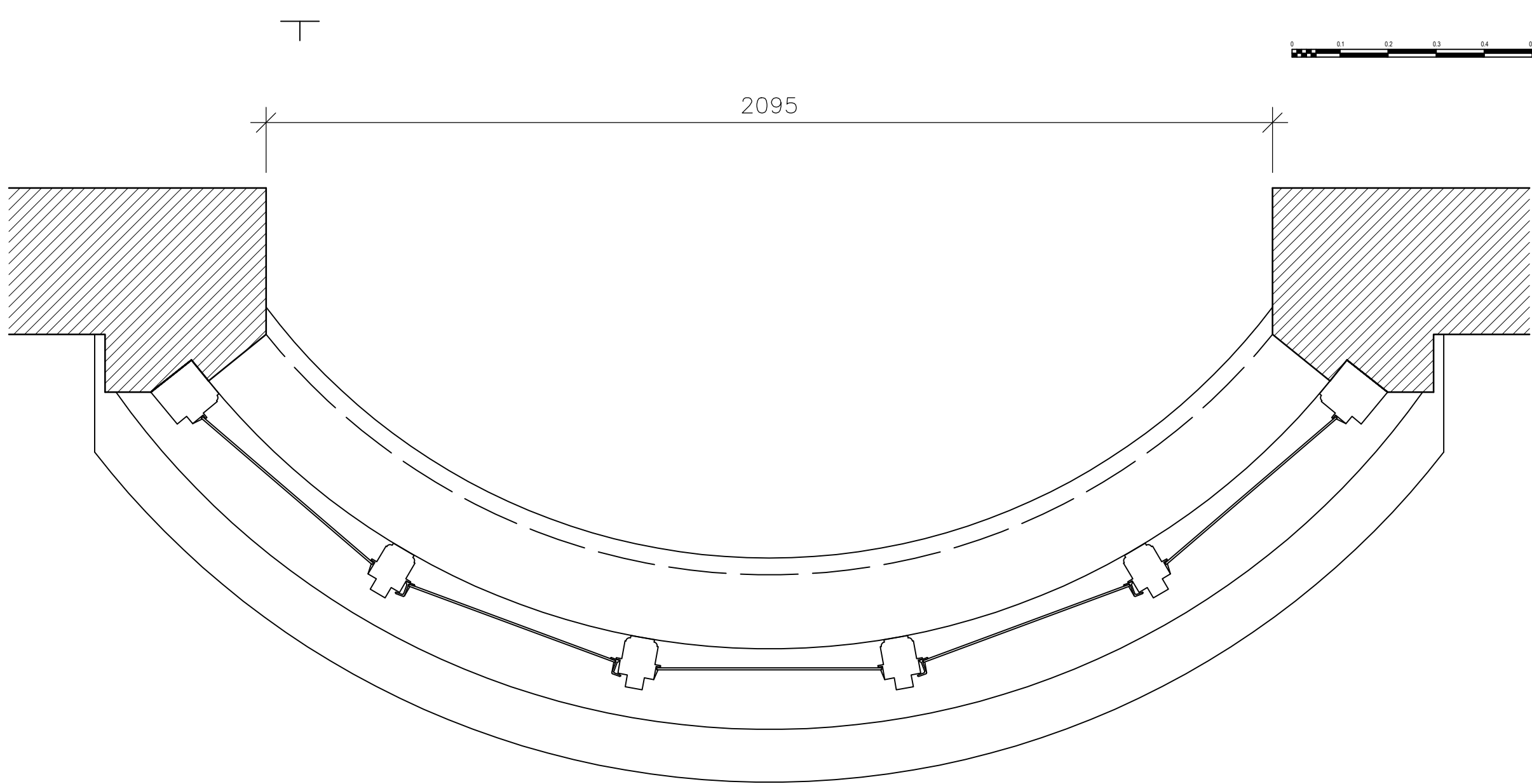

Section D-D

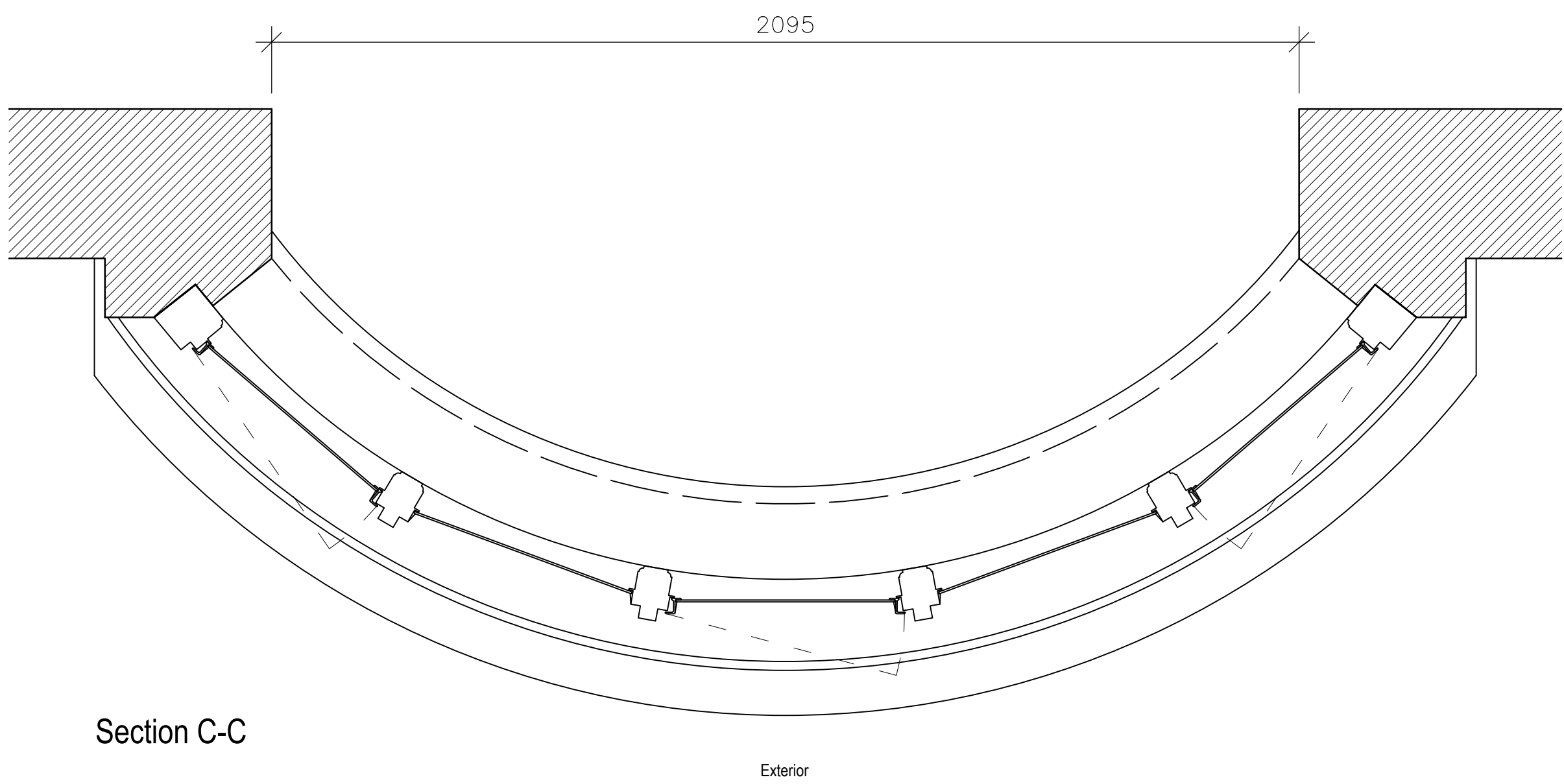

Section C-C

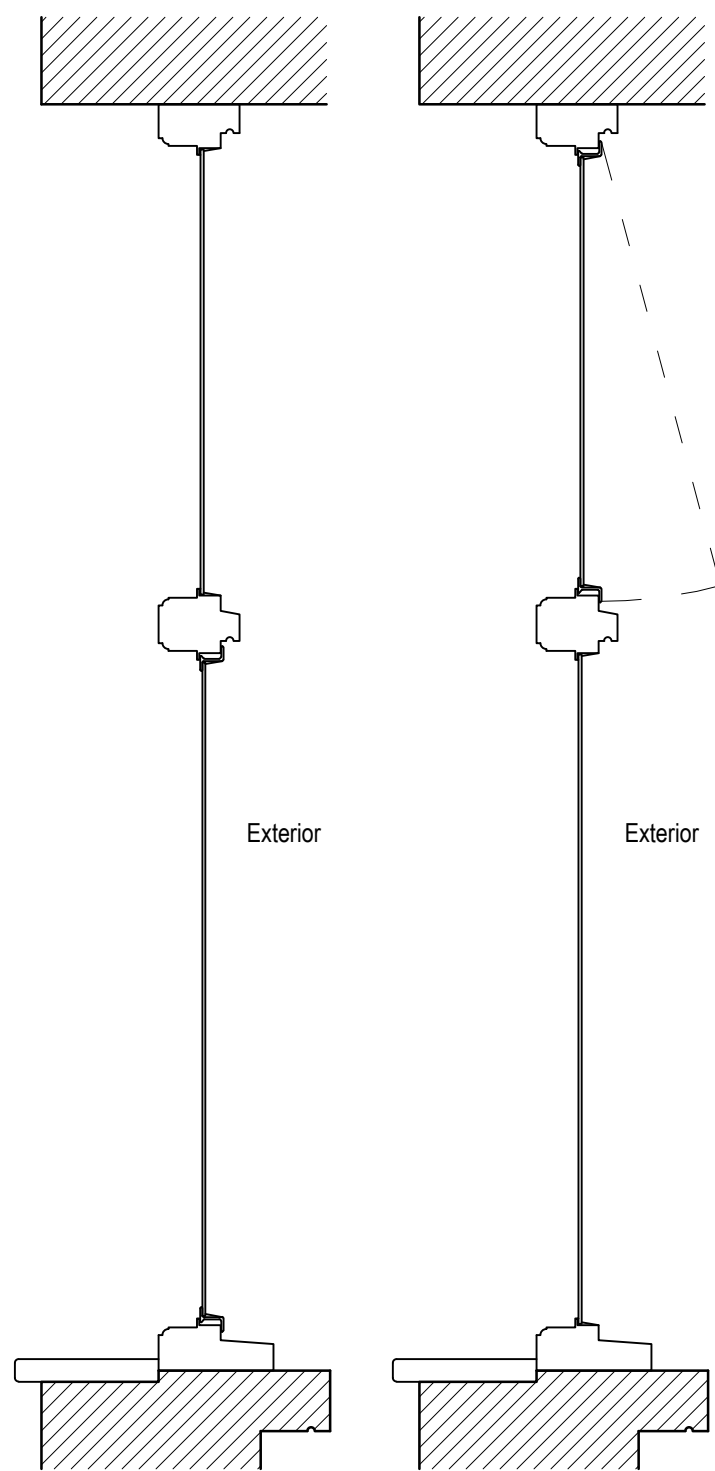

Section A-A

Section B-B

NOTES:
Report all discrepancies, errors and omissions
Do not scale from this drawing.
Verify all dimensions on site before commencing any work or preparing shop drawings.
All materials, components and workmanship are to comply with all the relevant British Standards, Codes of Practice, and appropriate manufacturers recommendations that from time to time shall apply.
For all specialist work, see relevant drawings.
This drawing and design are copyright of PELLINGS LLP

Rev	Date	Description	Name

Pellings

Pellings LLP
Northside House Mount Pleasant Barnet EN4 9EB
t 020 8441 8500 f 020 8441 4616 e barnet@pellings.co.uk
www.pellings.co.uk
Architecture & Planning ■ Building Surveying ■ Project Management ■
Cost Consultancy ■ CDM Co-ordination

CLIENT LONDON BOROUGH OF CAMDEN			
PROJECT 415 FINCHLEY ROAD LONDON NW3 6HJ			
TITLE Existing Typical Window Details Type W8 415B Kitchen Bay			
DATE	10/01/19	SCALE	1:10 @A1
DRAWN	MV		

DRAWING No. 510|061|208 | -