

Do Not Scale.
All Figured Dimensions To Be Checked On Site Prior To Construction.
All Copyright Reserved.

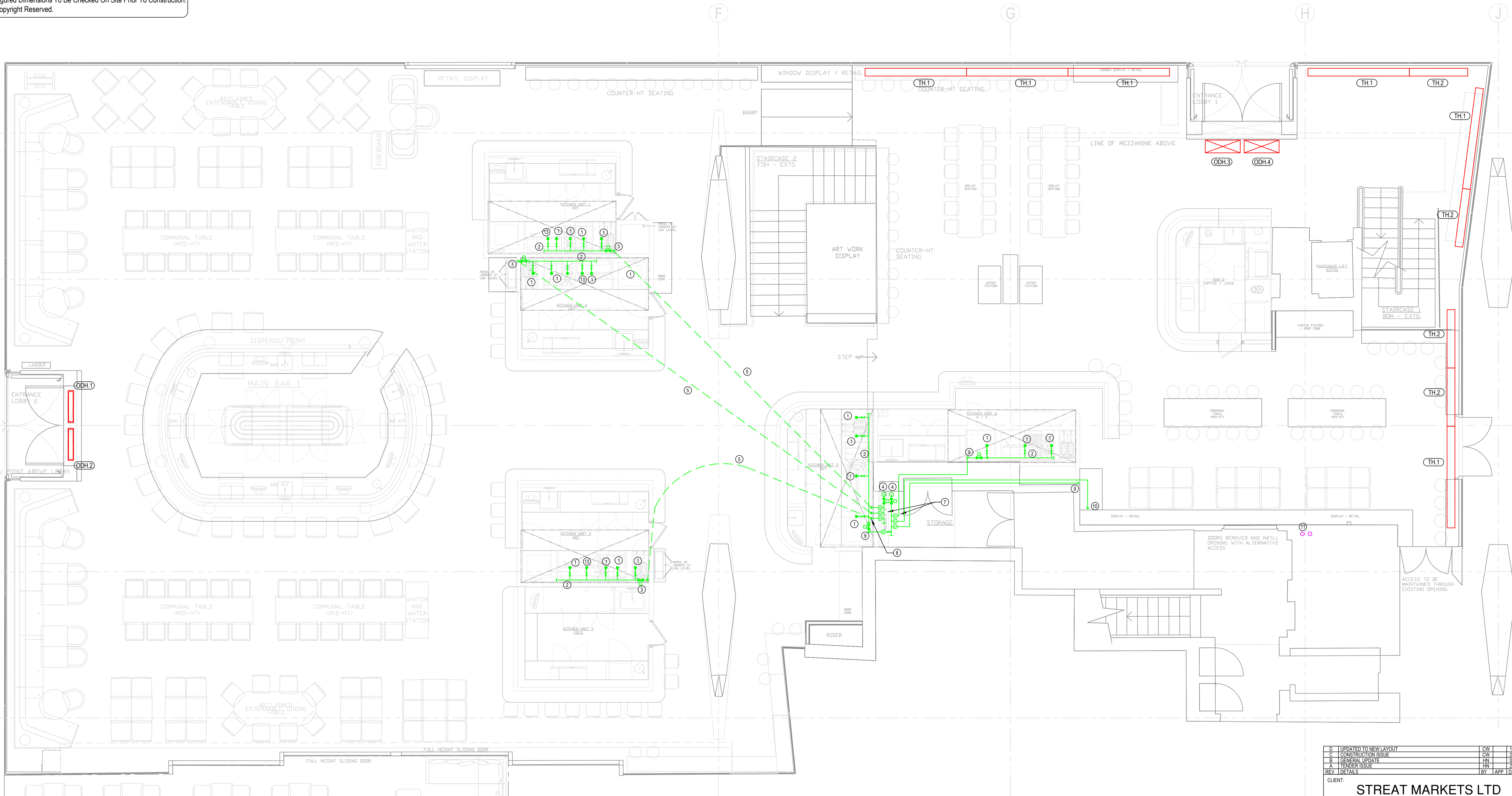

GENERAL NOTES:
1. ALL SERVICES/ROUTES THROUGHOUT BUILDING TO BE FULLY CO-ORDINATED ON SITE.
2. DRAWING TO BE READ IN CONJUNCTION WITH MECHANICAL INSTALLATION SPECIFICATION AND ALL OTHER RELEVANT DRAWINGS.

- LEGEND:**
- ① 220 GAS WITH IV FOR CONNECTION TO KITCHEN APPLIANCE BY OTHERS
 - ② 420 GAS MANIFOLD
 - ③ 420 GAS RISE FROM FLOOR VOID TO LOW LEVEL WITH IV AND SOLENOID VALVE
 - ④ 500 GAS RISE FROM BELOW TO LOW LEVEL MANIFOLD C/W SOLENOID VALVE
 - ⑤ 400 GAS PIPE IN CORRUGATED TRACPIPE, RUNS IN FLOOR VOID
 - ⑥ 400 GAS PIPE IN CORRUGATED TRACPIPE, RUNS IN FLOOR VOID
 - ⑦ 420 GAS FROM MANIFOLD C/W IV AND CHECK METERS
 - ⑧ 420 GAS CHANGE TO 400 TRACK PIPE AND DROPS TO FLOOR VOID
 - ⑨ 420 GAS AT LOW LEVEL WITH IV AND SOLENOID VALVE
 - ⑩ 420 GAS RISE TO ABOVE
 - ⑪ 320 LTHWICHW F&R FROM BELOW RISE TO ABOVE
 - ⑫ 420 GAS PIPEWORK ROUTE THRU LANDLORD DEMISE TO BE CONFIRMED
 - ⑬ 220 GAS WITH IV - (SPARE CONNECTION)

- PLANT SCHEDULE: GROUND FLOOR**
- ODH.1 & ODH.2
TURNBULL & SCOTT MODEL RDH-6000, 6kW, 1ph ELECTRICAL HEATING.
HEATER SIZE - 800x120x210h
DOOR CURTAIN TO BE SUPPORTED FROM LOBBY CONSTRUCTION
- ODH.3 & ODH.4
RAZOR MODEL ACR MINI 6, 6kW, 1ph ELECTRICAL HEATING.
HEATER SIZE - 930x340x1400h
- TH.1
ELECTRICAL TRENCH HEATING - KATHERM NE
TRENCH WIDTH 207mm
TRENCH HEIGHT 150mm
TRENCH LENGTH 1950mm
DUTY 980W
- TH.2
ELECTRICAL TRENCH HEATING - KATHERM NE
TRENCH WIDTH 207mm
TRENCH HEIGHT 150mm
TRENCH LENGTH 1550mm
DUTY 680W

D	UPDATED TO NEW LAYOUT	CW	19/02/2019
C	CONSTRUCTION ISSUE	CW	24/07/2019
B	GENERAL UPDATE	HN	07/12/2018
A	TENDER ISSUE	HN	28/07/2018
REV	DETAILS	BY	APP DATE

CLIENT: **STREET MARKETS LTD**

PROJECT: **CENTRE POINT, LINK BUILD. W1**

DRAWING TITLE: **GROUND FLOOR LEVEL 0 HEATING, COOLING & GAS**

DRAWN BY: H.NISIC	APPROVED BY:	DATE: SEP'18
PROJECT No.: L2171	DRAWING No.: M014	SCALE: 1:50



LEHDING SERVICES DESIGN LTD
Unit 10, 10 Redlands Crescent, Laine, Co. Antrim, N. Ireland, BT40 1TF. Tel: +44(0) 2838 271 123.
Global House, Ashley Avenue, Epsom, London, KT18 5AD. Tel: +44(0) 1372 253 207.
Web: www.lehding.co.uk Email: info@lehding.co.uk