

1:50

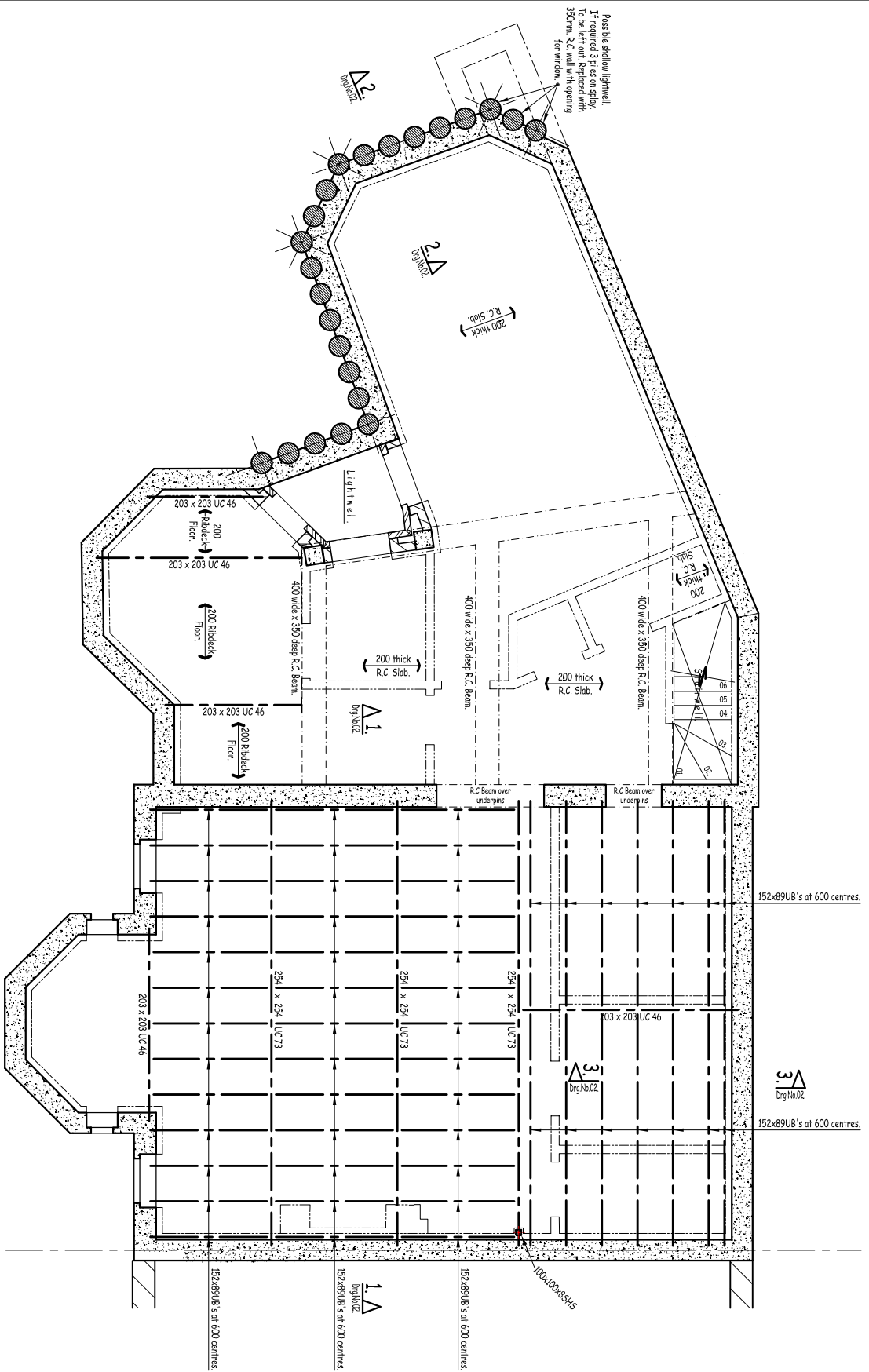

1:50



Proposed Basement Plan Showing Ground Floor Structure.

Scale 1:50 (or A1)

Notes

1. For sections see drawing number 17102 / 02

Rev	Details	Date
D	Lightwells removed.	20.11.18
C	Updated to show support to existing concrete ground floor.	24.09.18
B	Lightwell revised.	14.05.18
A	Updated.	07.11.17

**V & R**  
**VINCENT & RYMILL**  
 Consulting Civil & Structural Engineers  
 Lakeside Country Club,  
 Wharf Road, Fintley Green,  
 Camberley, Surrey GU16 6PT  
 Telephone: 01252 824242  
 Fax: 01252 839889  
 Email: info@vincenrymill.co.uk

20 Well Road,  
London NW3 1LH

Basement Plan Showing  
Ground Floor Structure

Scale at A1	Date	Job No	Dwg No	Rev
1:50	Oct 2017	17J02	03	D